

FINAL SURVEY	DATE
SURVEYED	BY
PLANNED	
FIELD	
NOTE BOOK	
AREAS CHECKED	
NO.	

ORIGINAL SURVEY	DATE
SURVEYED	BY
PLANNED	
FIELD	
NOTE BOOK	
AREAS CHECKED	
NO.	

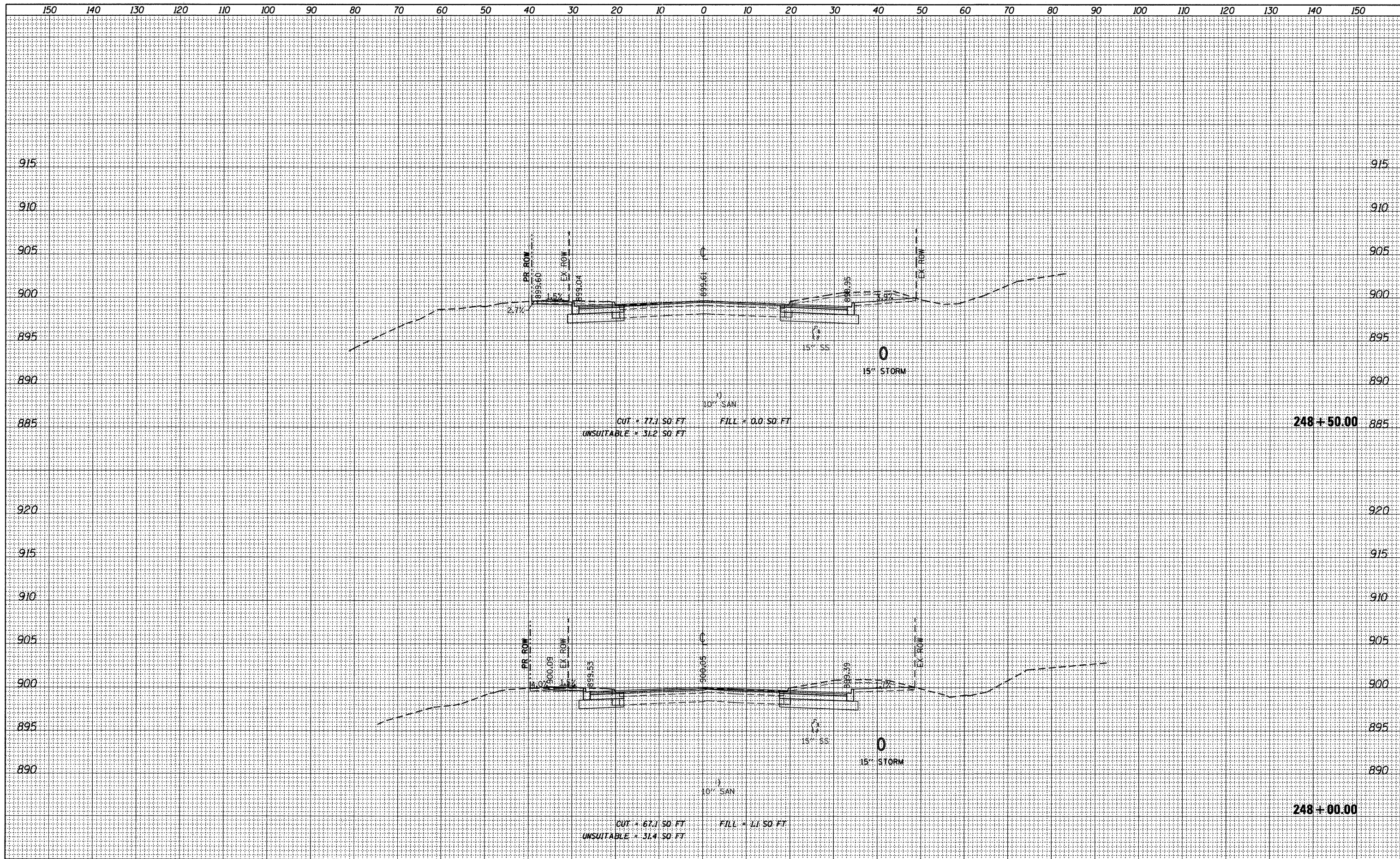

FILE NAME = F:\396-064 Pingree Road\CADD_Sheets\ldot Form\163519_Congress.dgn	USER NAME = cesario	DESIGNED <i>BD</i>	REVISED -	STATE OF ILLINOIS DEPARTMENT OF TRANSPORTATION	CONGRESS PARKWAY CROSS SECTIONS 1"=10' HORIZ. SCALE: 1"=5' VERT.	F.A.U. RTE. 126	SECTION 95-00090-01-FP	COUNTY MCHENRY	TOTAL SHEETS 92	SHEET NO. 86	
PLOT SCALE = 10.0000' / IN.	CHECKED <i>BD</i>	DATE 08-29-2011	REVISED -			SHEET NO. 86 OF 92 SHEETS		STA. 248+00.00 TO STA. 248+50.00		CONTRACT NO. 63519	
PLOT DATE = 9/14/2011			REVISED -			ILLINOIS FED. AID PROJECT					