

FINAL SURVEY	SURVEYED	DATE
NOTE BOOK	PLOTTED	BY
NO.	DATE	
	AREAS	
	CHECKED	

ORIGINAL SURVEY	SURVEYED	DATE
NOTE BOOK	PLOTTED	BY
NO.	DATE	
	AREAS	
	CHECKED	

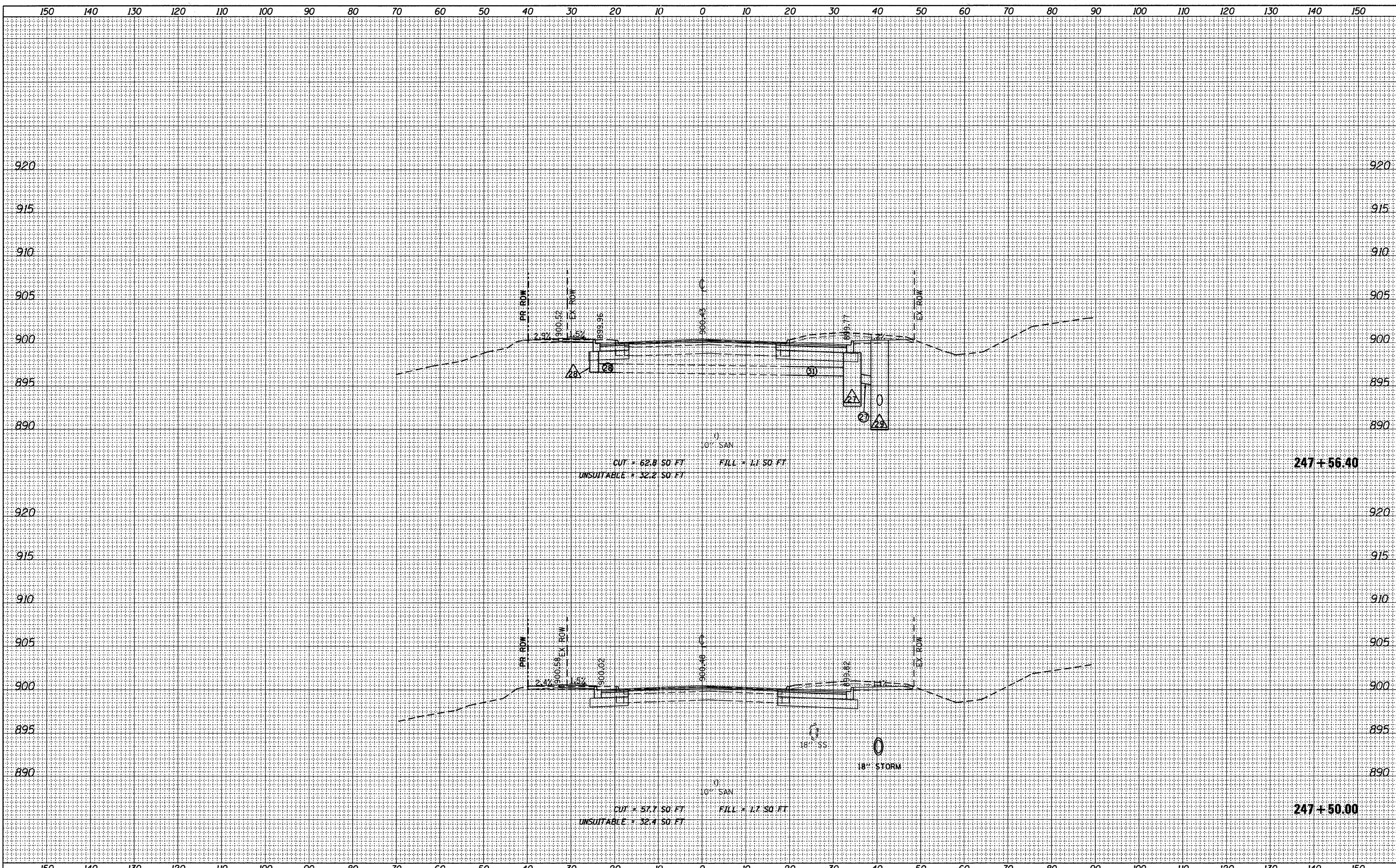

FILE NAME = F:\396-064 Pingree Road\CADD_Sheets\1.dwg	USER NAME = cesario	DESIGNED <i>BD</i>	REVISED -	<b>STATE OF ILLINOIS</b> <b>DEPARTMENT OF TRANSPORTATION</b> <b>CONGRESS PARKWAY CROSS SECTIONS</b> 1"=10' HORIZ. SCALE: 1"=5' VERT. SHEET NO. 85 OF 92 SHEETS STA. 247+50.00 TO STA. 247+56.40	F.A.J. RTE. 126	SECTION 95-00090-01-FP	COUNTY MCHENRY	TOTAL SHEETS 92	SHEET NO. 85
	PLOT SCALE = 10.0000' / IN.	DRAWN <i>JPS</i>	REVISED -		CONTRACT NO. 63519				
	PLOT DATE = 9/14/2011	CHECKED <i>BD</i>	REVISED -		ILLINOIS FED. AID PROJECT				
		DATE <i>08-29-2011</i>	REVISED -						