

FINAL SURVEY	DATE
SURVEYED	BY
PLOTTED	
NOTE BOOK	
NO.	

ORIGINAL SURVEY	DATE
SURVEYED	BY
PLOTTED	
NOTE BOOK	
NO.	

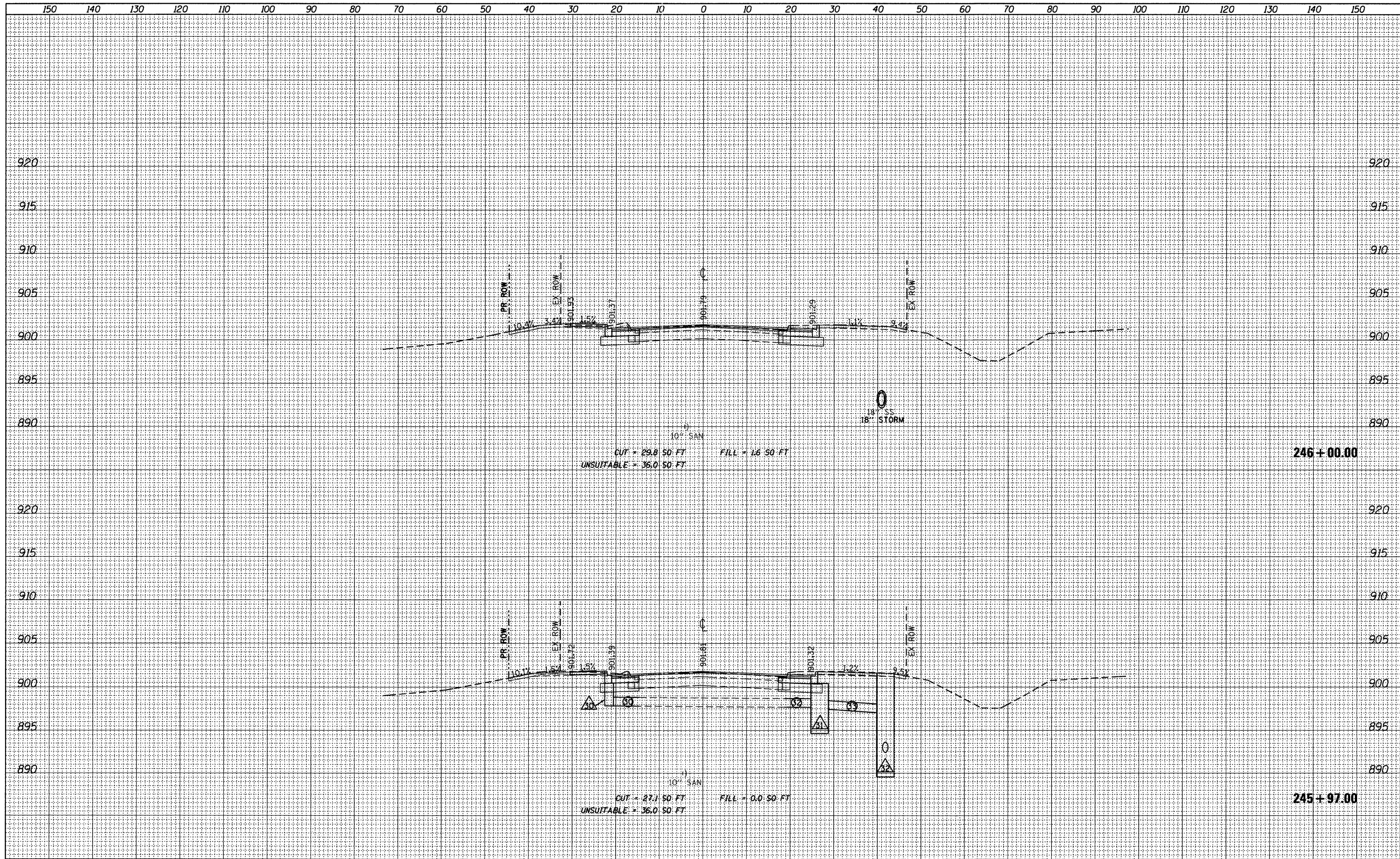

FILE NAME = F:\396-064 Pingree Road\CADD_Sheets\ldot Format\163519_Congress.dgn
 PLOT SCALE = 10.0000' / IN.
 PLOT DATE = 9/14/2011

USER NAME = cesario
 DESIGNED *BD*
 DRAWN *JPS*
 CHECKED *BD*
 DATE *08-29-2011*

REVISED -
 REVISED -
 REVISED -
 REVISED -

**STATE OF ILLINOIS
 DEPARTMENT OF TRANSPORTATION**

CONGRESS PARKWAY CROSS SECTIONS
 1"=10' HORIZ.
 SCALE: 1"=5' VERT. SHEET NO. 83 OF 92 SHEETS STA. 245+97.00 TO STA. 246+00.00

F.A.J. RTE.	SECTION	COUNTY	TOTAL SHEETS	SHEET NO.
126	95-00090-01-FP	MCHENRY	92	83
CONTRACT NO. 63519			ILLINOIS FED. AID PROJECT	