

FINAL SURVEY	SURVEYED	DATE
NOTE BOOK	PLOTTED	BY
NO.	PLATE	
	AREAS	
	CHECKED	

ORIGINAL SURVEY	SURVEYED	DATE
NOTE BOOK	PLOTTED	BY
NO.	PLATE	
	AREAS	
	CHECKED	

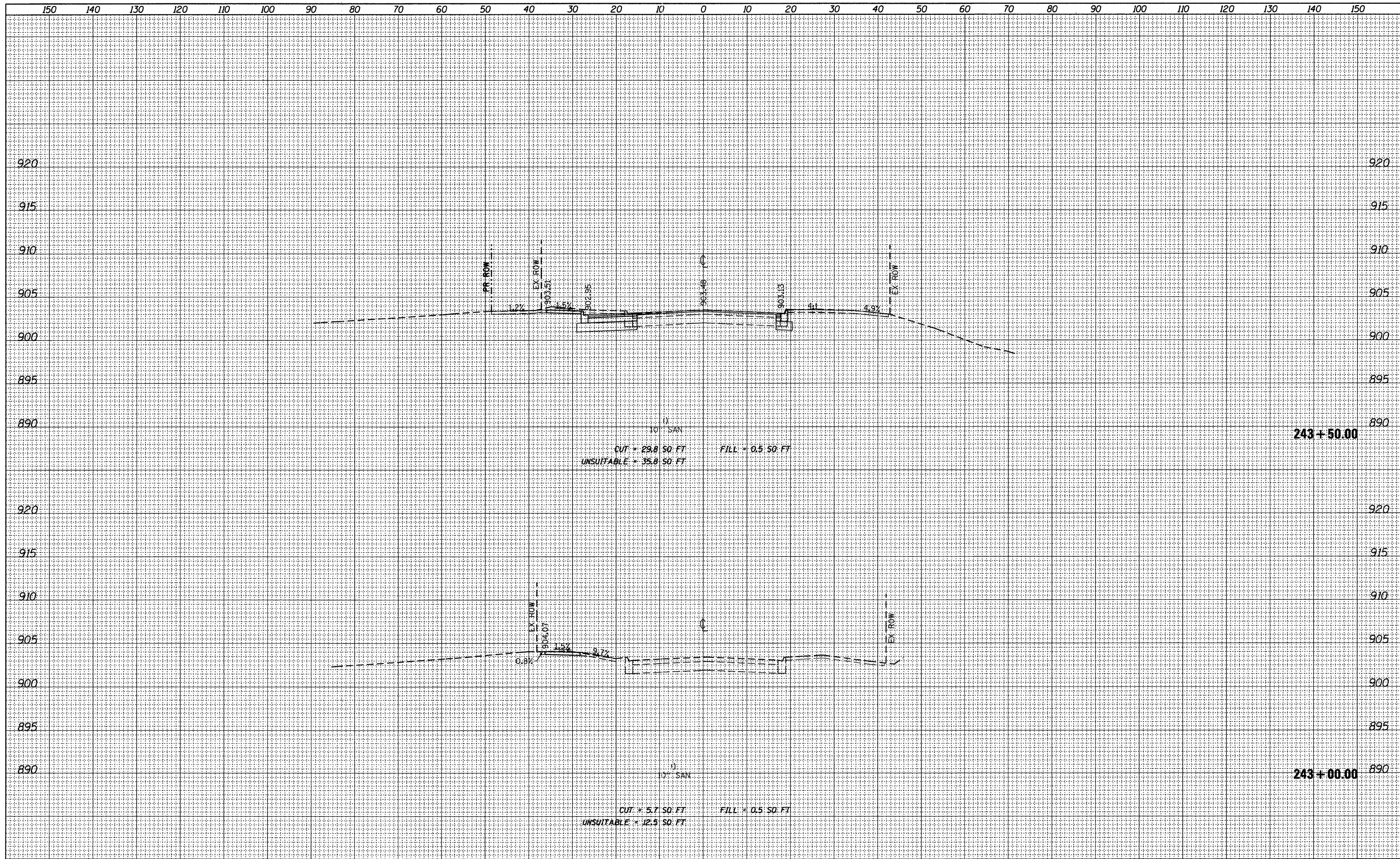

FILE NAME = F:\396-064 Pingree Road\CADD_Sheets\ldot Format\163519_Congress.dgn	USER NAME = cesario	DESIGNED <i>BD</i>	REVISED -	STATE OF ILLINOIS DEPARTMENT OF TRANSPORTATION	CONGRESS PARKWAY CROSS SECTIONS 1"=10' HORIZ. SCALE: 1"=5' VERT. SHEET NO. 80 OF 92 SHEETS STA. 243+00.00 TO STA. 243+50.00	F.A.U. RTE. 126	SECTION 95-00090-01-FP	COUNTY MCHENRY	TOTAL SHEETS 92	SHEET NO. 80
PLOT SCALE = 10.0000' / IN.	CHECKED <i>BD</i>	DATE 08-29-2011	REVISED -			CONTRACT NO. 63519				
PLOT DATE = 9/14/2011	DATE 08-29-2011	REVISED -	ILLINOIS FED. AID PROJECT							