

DATE	
BY	
SURVEYED	
PLOTTED	
TEMPLATE	
NOTE BOOK	
NO.	
AREAS CHECKED	

DATE	
BY	
SURVEYED	
PLOTTED	
TEMPLATE	
NOTE BOOK	
NO.	
AREAS CHECKED	

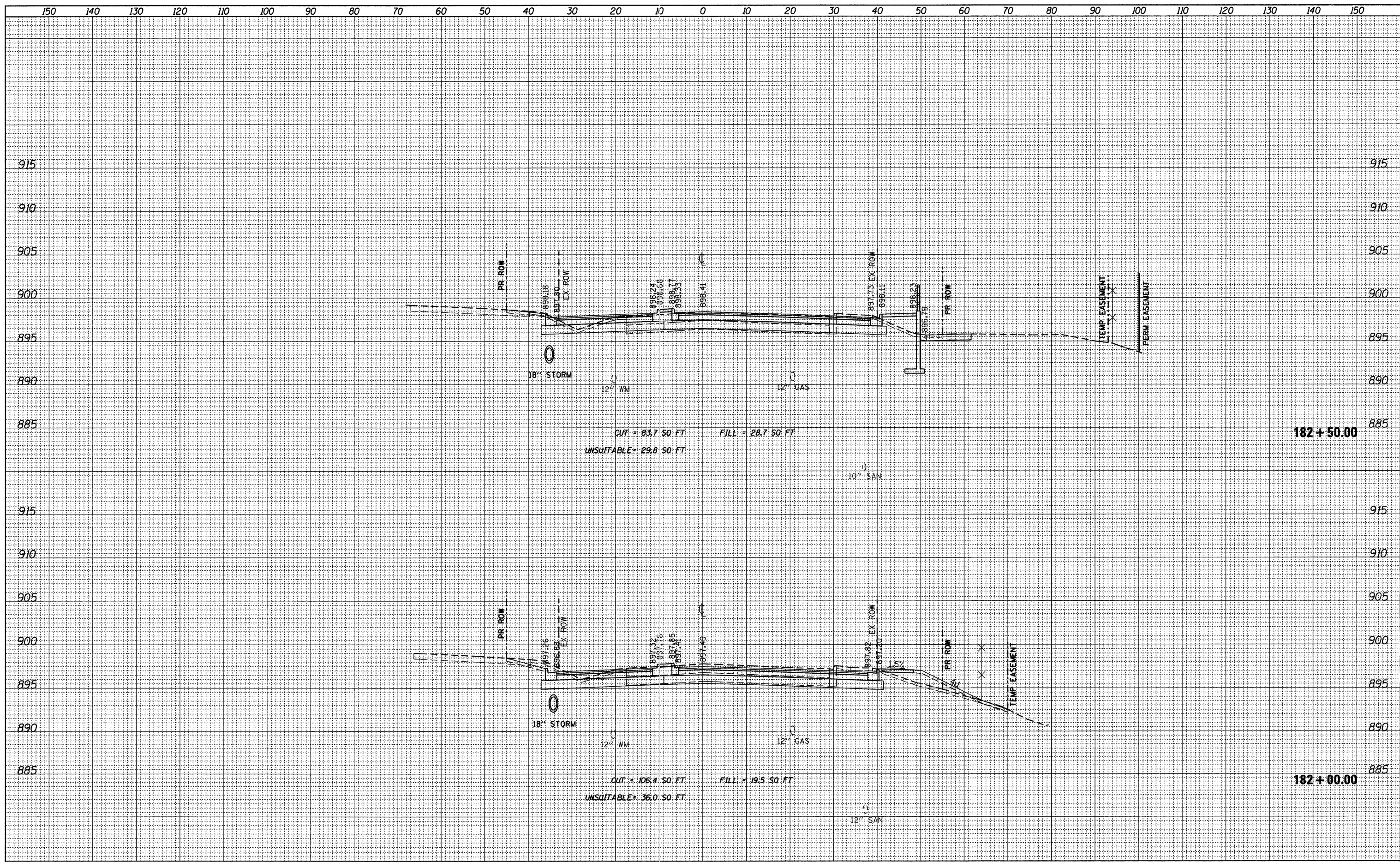

FILE NAME = F:\396-064 Pingree Road\CADD\Sheets\1dot Form\AD163519_Pingree.dgn	USER NAME = cesario	DESIGNED BPD	REVISED -	STATE OF ILLINOIS DEPARTMENT OF TRANSPORTATION	PINGREE ROAD CROSS SECTIONS	F.A.U. RTE. 126	SECTION 95-00090-01-FP	COUNTY MCHENRY	TOTAL SHEETS 92	SHEET NO. 70		
PLOT SCALE = 10.0005' / IN.	CHECKED BPD	REVISED -	SCALE: 1"=5' VERT.			SHEET NO. 70 OF 92 SHEETS	STA. 182+00.00 TO STA. 182+50.00	CONTRACT NO. 63519		ILLINOIS FED. AID PROJECT		
PLOT DATE = 9/14/2011	DATE 08-29-2011	REVISED -										