

| | | |
|--------------|---------------|------|
| FINAL SURVEY | SURVEYED | DATE |
| NOTE BOOK | TEMPLATE | BY |
| NO. | AREAS CHECKED | |

| | | |
|-----------------|---------------|------|
| ORIGINAL SURVEY | SURVEYED | DATE |
| NOTE BOOK | TEMPLATE | BY |
| NO. | AREAS CHECKED | |

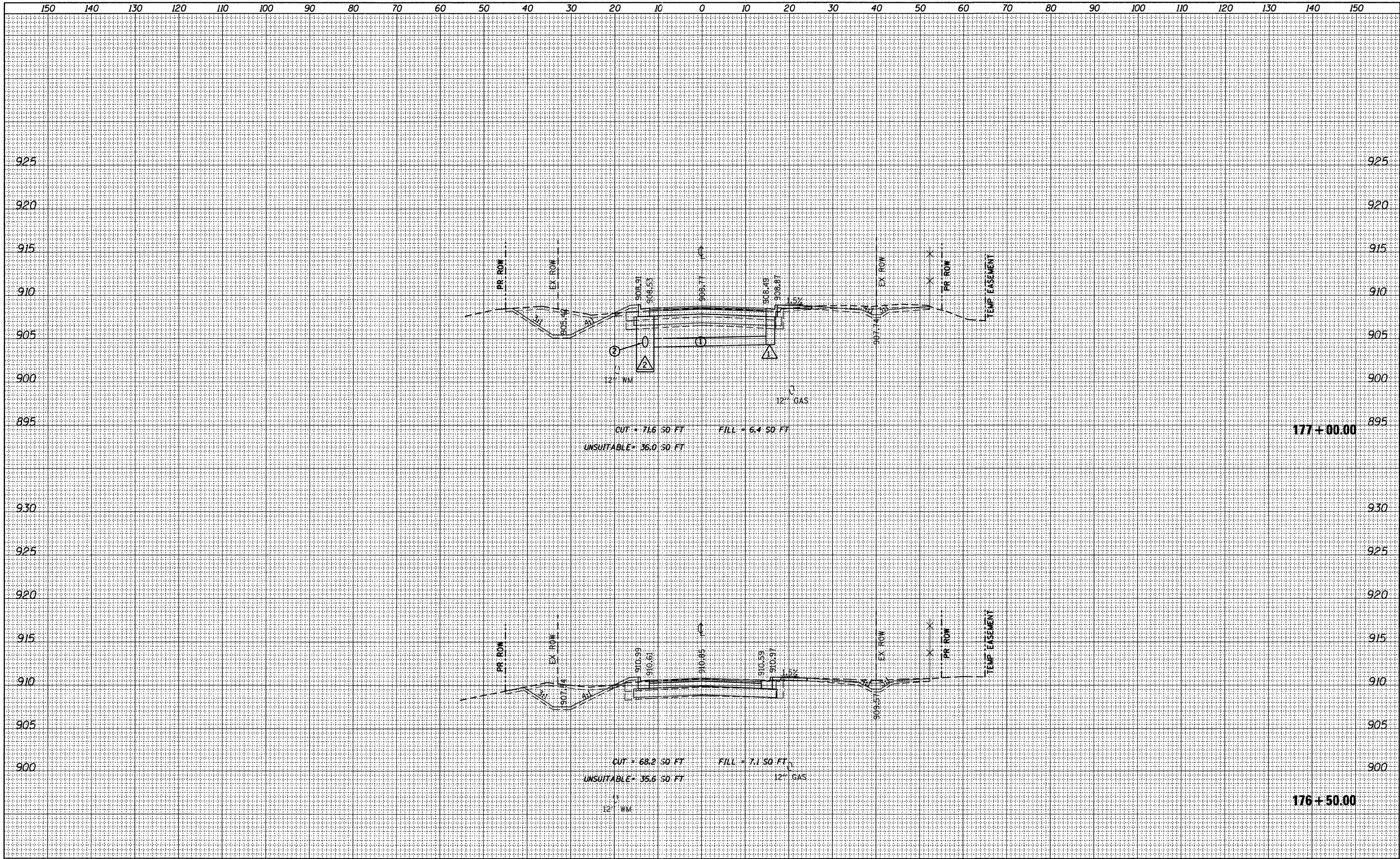

FILE NAME = F:\396-064 Pingree Road\CADD\Sheets\I.dwt
 USER NAME = cesario
 DESIGNED BPD
 DRAWN JPS
 CHECKED BPD
 DATE 08-29-2011

DESIGNED BPD
 DRAWN JPS
 CHECKED BPD
 DATE 08-29-2011

REVISED -
 REVISED -
 REVISED -
 REVISED -

**STATE OF ILLINOIS
 DEPARTMENT OF TRANSPORTATION**

PINGREE ROAD CROSS SECTIONS
 1"=10' HORIZ.
 SCALE: 1"=5' VERT. SHEET NO. 62 OF 92 SHEETS STA. 176+50.00 TO STA. 177+00.00

| F.A.U. RTE. | SECTION | COUNTY | TOTAL SHEETS | SHEET NO. |
|--------------------|----------------|---------|---------------------------|-----------|
| 126 | 95-00090-01-FP | MCHENRY | 92 | 62 |
| CONTRACT NO. 63519 | | | ILLINOIS FED. AID PROJECT | |