

**SEDIMENT AND EROSION CONTROL NOTES**

1. SOIL DISTURBANCE SHALL BE CONDUCTED IN SUCH A MANNER AS TO MINIMIZE EROSION. SOIL STABILIZATION MEASURES SHOWN SHALL CONSIDER THE TIME OF YEAR, SITE CONDITIONS, AND THE USE OF TEMPORARY OR PERMANENT MEASURES. SOIL EROSION AND SEDIMENT CONTROL FEATURES SHALL BE CONSTRUCTED PRIOR TO THE COMMENCEMENT OF SOIL DISTURBANCE.
2. THE CONSTRUCTION LIMITS WILL BE STAKED BY THE ENGINEER PRIOR TO COMMENCING CONSTRUCTION. THE CONSTRUCTION LIMITS MAY BE ADJUSTED BY THE ENGINEER TO PRESERVE TREES AND NO ADDITIONAL COMPENSATION WILL BE PAID TO THE CONTRACTOR FOR CHANGED CONSTRUCTION LIMITS.
3. EARTH STOCKPILES SHALL BE TEMPORARILY SEEDED IF THEY ARE TO REMAIN UNUSED FOR MORE THAN FOURTEEN DAYS. PERIMETER EROSION BARRIER SHALL SURROUND THE STOCKPILE.
4. PERIMETER EROSION BARRIER SHALL BE ERECTED ADJACENT TO THE CONSTRUCTION LIMITS. THE RESIDENT ENGINEER SHALL HAVE FINAL DETERMINATION OF THE PLACEMENT AND LOCATION OF THE PERIMETER EROSION BARRIER.

5. AS CONSTRUCTION PROCEEDS THE CONTRACTOR SHALL INSTITUTE THE FOLLOWING AS DIRECTED BY THE ENGINEER:  
PLACE TEMPORARY EROSION CONTROL FACILITIES AT LOCATIONS SHOWN ON THE PLANS AND AT LOCATIONS DIRECTED BY THE ENGINEER.  
TEMPORARILY SEED ERODIBLE BARE EARTH ON A WEEKLY BASIS TO MINIMIZE THE AMOUNT OF ERODIBLE SURFACE AREA WITHIN THE CONTRACT LIMITS.  
BUILD NECESSARY EMBANKMENT AT CULVERT LOCATIONS AND THEN EXCAVATE AND PLACE CULVERT. CONTINUE BUILDING UP THE EMBANKMENT TO THE PROPOSED GRADE WHILE AT THE SAME TIME PLACING PERMANENT EROSION CONTROL SUCH AS RIPRAP, DITCH LINING AND CONDUCT FINAL SHAPING TO THE SLOPES.
6. WITHIN THE CONSTRUCTION LIMITS, AREAS OF WHICH MAY BE SUSCEPTIBLE TO EROSION AS DETERMINED BY THE ENGINEER SHALL REMAIN UNDISTURBED UNTIL FULL SCALE CONSTRUCTION IS UNDERWAY.
7. DITCH CHECK INSTALLATION SHALL OCCUR IMMEDIATELY UPON DITCHES BEING DISTURBED AND SHALL NOT BE PROLONGED UNTIL DITCHES ARE FINAL GRADED.
8. DISTURBED AREAS SHALL BE PERMANENTLY SEEDED OR SODDED IMMEDIATELY AFTER GRADING. IF NOT, THEY SHALL BE TEMPORARILY SEEDED WITHIN 14 CALENDAR DAYS FROM DISTURBANCE OR RE-DISTURBANCE.

9. SEDIMENT COLLECTED DURING CONSTRUCTION AND MAINTENANCE OF THE VARIOUS TEMPORARY EROSION CONTROL SYSTEMS SHALL BE DISPOSED OF ON SITE ON A REGULAR BASIS AS DIRECTED BY THE ENGINEER. THIS COST SHALL BE INCLUDED IN THE COST OF THE EROSION CONTROL PAY ITEM.
10. SEDIMENT OR SOIL REACHING AN IMPROVED PUBLIC RIGHT-OF-WAY, STREET, ALLEY OR PARKING AREA SHALL BE REMOVED BY SCRAPING OR STREET CLEANING AS ACCUMULATIONS WARRANT AND TRANSPORTED TO A CONTROLLED SEDIMENT DISPOSAL AREA ON SITE. THIS COST SHALL NOT BE PAID FOR SEPARATELY.
11. DURING DE-WATERING OPERATIONS, DISCHARGES SHALL BE PUMPED INTO SEDIMENT BASINS OR SILT TRAPS. DE-WATERING DIRECTLY INTO FIELD TILES OR STORMWATER STRUCTURES IS PROHIBITED.
12. TEMPORARY EROSION CONTROL SEEDING SHALL BE APPLIED AT A RATE OF 100LBS/ACRE.
13. THE TEMPORARY EROSION CONTROL SYSTEM SHALL BE REMOVED WITHIN 30 DAYS AFTER FINAL STABILIZATION OR AS DIRECTED BY THE ENGINEER. THE COST OF REMOVAL SHALL BE INCLUDED IN THE COST OF THE ITEM.
14. ALL EROSION CONTROL ITEMS SHALL FOLLOW THE STORMWATER POLLUTION PREVENTION PLAN AND BE CONSTRUCTED AS SHOWN ON THE PLANS, STANDARDS, AS DESCRIBED IN THE SPECIAL PROVISIONS AND AS DIRECTED BY THE ENGINEER.
15. THE EROSION CONTROL PRODUCTS FURNISHED SHALL BE SPECIFICALLY RECOMMENDED BY THE MANUFACTURER FOR THE USE SPECIFIED IN THE EROSION CONTROL PLAN. PRIOR TO APPROVAL AND USE, THE CONTRACTOR SHALL SUBMIT TO THE ENGINEER CERTIFICATION BY THE PRODUCER STATING THE INTENDED USE OF THE PRODUCT AND THAT THE PHYSICAL PROPERTIES REQUIRED FOR THIS APPLICATION ARE MET OR EXCEEDED. THE CONTRACTOR SHALL PROVIDE MANUFACTURER INSTALLATION PROCEDURES TO THE ENGINEER.
16. AREAS OR EMBANKMENTS HAVING SLOPES GREATER THAN OR EQUAL TO 3H: 1V SHALL BE STABILIZED WITH SOD, MAT, OR BLANKET IN COMBINATION WITH SEEDING.
17. ALL STORM SEWERS THAT ARE OR WILL BE FUNCTIONING DURING CONSTRUCTION SHALL BE PROTECTED BY AN APPROPRIATE SEDIMENT CONTROL MEASURE (INLET AND PIPE PROTECTION).
18. A STABILIZED MAT OF AGGREGATE UNDERLAIN WITH FILTER CLOTH OR OTHER APPROPRIATE MEASURE SHALL BE LOCATED AT ANY POINT WHERE TRAFFIC WILL BE ENTERING OR LEAVING A CONSTRUCTION SITE TO OR FROM A PUBLIC RIGHT-OF-WAY, STREET, ALLEY OR PARKING AREA.
19. THE EROSION CONTROL MEASURES INDICATED ON THE PLANS ARE THE MINIMUM REQUIREMENTS. ADDITIONAL MEASURES MAY BE REQUIRED, AS DIRECTED BY THE ENGINEER OR GOVERNING AGENCY.
20. ALL ITEMS SHALL BE CONSTRUCTED AS SHOWN ON STANDARD 280001, THE PLAN DETAILS, AND AS DIRECTED BY THE ENGINEER. MAINTENANCE AND CLEANING OF THE EROSION CONTROL ITEMS SHALL BE INCLUDED IN THE RESPECTIVE EROSION CONTROL PAY ITEM. FAILURE TO MAINTAIN ANY EROSION CONTROL PAY ITEM AS DIRECTED BY THE ENGINEER WILL REQUIRE THE ENGINEER TO FILE AN INCIDENT OF NON-COMPLIANCE (ION) WITH THE ILLINOIS EPA.
21. CONSTRUCTION EQUIPMENT SHALL BE STORED, FUELED AND WASHED ONLY AT DESIGNATED LOCATIONS. ALL NECESSARY MEASURES SHALL BE TAKEN TO CONTAIN ANY FUEL AND OTHER POLLUTANT IN ACCORDANCE WITH EPA WATER QUALITY REGULATIONS. LEAKING EQUIPMENT OR SUPPLIES SHALL BE IMMEDIATELY REPAIRED OR REMOVED FROM THE SITE.
22. SEE CROSS SECTIONS FOR GRADING, SEEDING, AND SODDING LIMITS.
23. AREA OF DISTURBANCE FOR ENTIRE PROJECT = 5.6 ac.

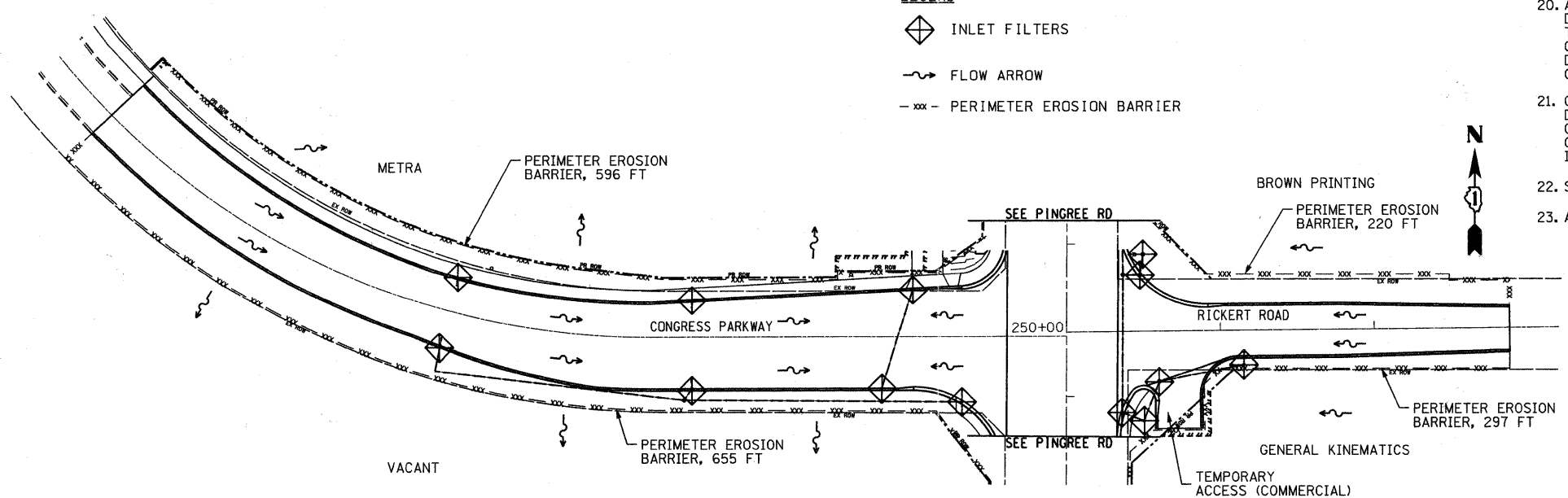
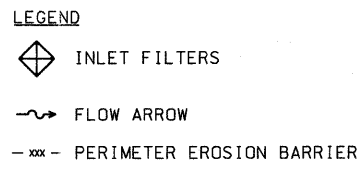
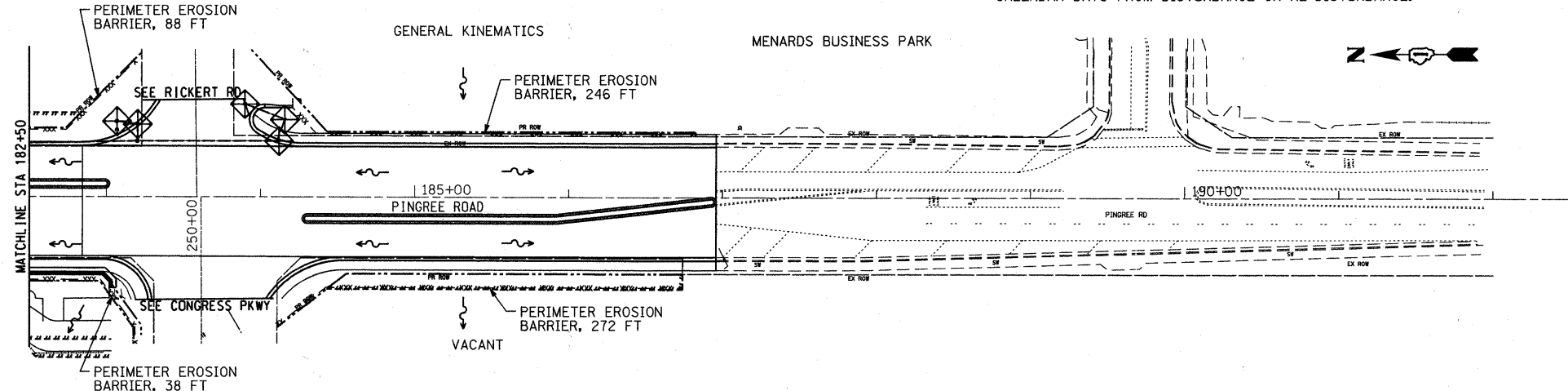

FILE NAME =	USER NAME = daly	DESIGNED - BD	REVISED -	<b>STATE OF ILLINOIS DEPARTMENT OF TRANSPORTATION</b>	<b>PINGREE ROAD RECONSTRUCTION EROSION AND SEDIMENT CONTROL</b>			F.A.U. RTE. 126	SECTION 95-00090-01-PP	COUNTY McHENRY	TOTAL SHEETS 92	SHEET NO. 27
F:\396-064 Pingree Road\CADD\Sheets\126	Format\0163519-sht-eros.dgn	DRAWN - DC	REVISED -		SCALE: 1"=50'	SHEET NO. 27 OF 92 SHEETS	STA.	TO STA.	CONTRACT NO. 63519			
PLOT SCALE = 50,000 / IN.	CHECKED - BD	REVISOR -	REVISED -		ILLINOIS FED. AID PROJECT							
PLOT DATE = 8/26/2011	DATE - 08-29-2011	REVISOR -	REVISED -									