

F.A.U. RTE.	SECTION	COUNTY	TOTAL SHEETS	SHEET NO.
126	95-00090-01-FP	McHENRY	92	1

CONTRACT NO. 63519

STATE OF ILLINOIS
DEPARTMENT OF TRANSPORTATION
DIVISION OF HIGHWAYS

PLANS FOR PROPOSED FEDERAL AID HIGHWAY

F.A.U. ROUTE 126 (PINGREE ROAD)
FROM U.P.R.R. TO CONGRESS PARKWAY
SECTION 95-00090-01-FP
PROJECT M-9003(661)
JOB C-91-647-10
ROAD RECONSTRUCTION
McHENRY COUNTY

FOR INDEX OF SHEETS, SEE SHEET NO. 2

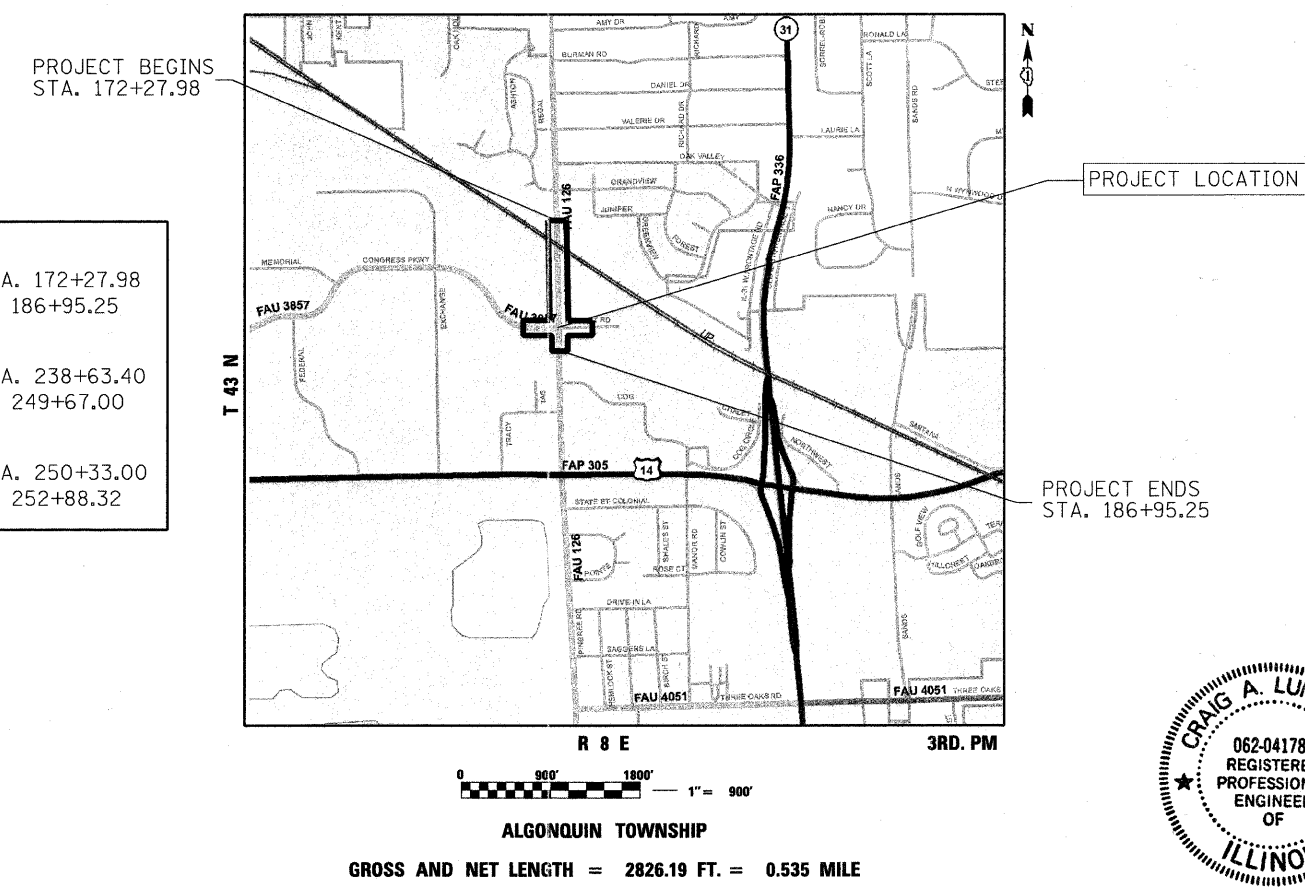
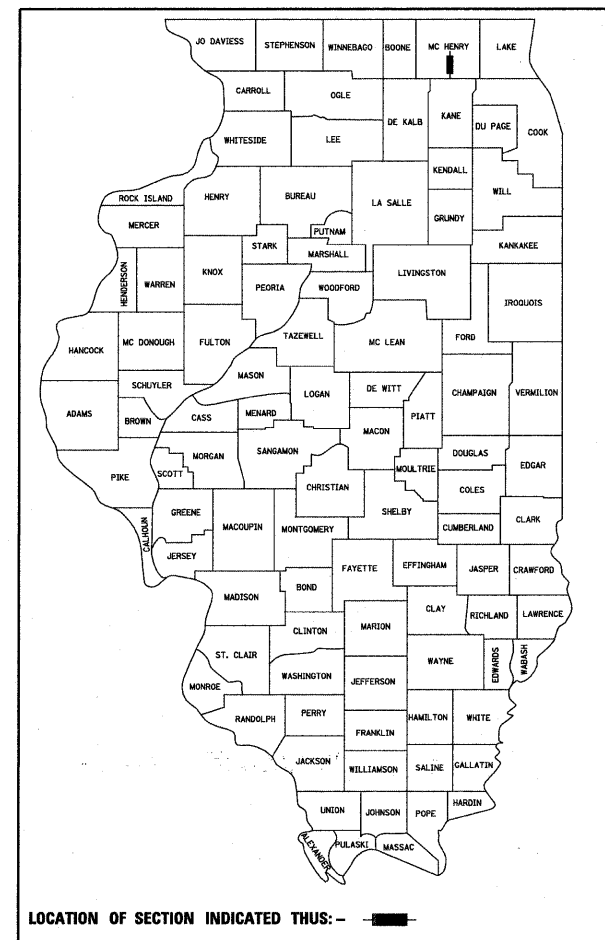

PINGREE ROAD:
PROJECT BEGINS: STA. 172+27.98
PROJECT ENDS: STA. 186+95.25

CONGRESS PARKWAY:
PROJECT BEGINS: STA. 238+63.40
PROJECT ENDS: STA. 249+67.00

RICKERT ROAD:
PROJECT BEGINS: STA. 250+33.00
PROJECT ENDS: STA. 252+88.32

DESIGN DESIGNATION

PINGREE ROAD - COLLECTOR
ADT PINGREE ROAD: 11,300 (2002)
ADT PINGREE ROAD: 18,500 (2025)
POSTED SPEED LIMIT PINGREE ROAD: 35 MPH
DESIGN SPEED LIMIT PINGREE ROAD: 35 MPH

PROJECT LOCATED IN:

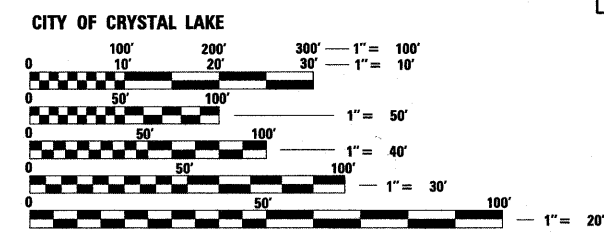

FULL SIZE PLANS HAVE BEEN PREPARED USING STANDARD ENGINEERING SCALES. REDUCED SIZED PLANS WILL NOT CONFORM TO STANDARD SCALES. IN MAKING MEASUREMENTS ON REDUCED PLANS, THE ABOVE SCALES MAY BE USED.

J.U.L.I.E.
JOINT UTILITY LOCATION INFORMATION FOR EXCAVATION
1-800-892-0123
OR 811

CONTRACT NO. 63519

CONSULTING ENGINEERS, SCIENTISTS & LAND SURVEYORS

B Bollinger, Lach & Associates, Inc.
333 PIERCE ROAD SUITE 200 ITASCA, IL 60143
P(630) 438 6400 F(630) 438 6444 www.bollingerlach.com
ITASCA * CHICAGO * ALGONQUIN * LAKE GENEVA * SOUTH BEND * INDIANAPOLIS

Craig A. Lukowicz
CRAIG A. LUKOWICZ
ILLINOIS REGISTERED PROFESSIONAL ENGINEER NO. 062-041788
MY LICENSE EXPIRES ON 11-30-11.

DATE 8/29/11

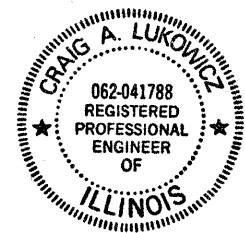

STATE OF ILLINOIS
DEPARTMENT OF TRANSPORTATION
DIVISION OF HIGHWAYS

APPROVED Aug. 29 20 11
Gail D. Mearns
CITY OF CRYSTAL LAKE

PASSED SEPTEMBER 20 11
Christina M. ...
DISTRICT ONE ENGINEER OF LOCAL ROADS & STREETS

RELEASING FOR BID
BASED ON LIMITED
REVIEW SEPTEMBER 13 20 11
Diana M. O'Keefe
DEPUTY DIRECTOR OF HIGHWAYS, REGION ONE ENGINEER

**PRINTED BY THE AUTHORITY
OF THE STATE OF ILLINOIS**

PROGRAM AND OFFICE ENGINEER: CHARLES F. RIDDLE, P.E. - (847)-705-4406 SCHAUMBURG, IL