

ROUTE	SECTION	COUNTY	TOTAL SHEETS	SHEET NUMBER
FAI 290	2011-061-BR	COOK & DUPAGE	29	2

Contract 60P79

DuPAGE COUNTY COOK COUNTY
R 11 E R 11 E

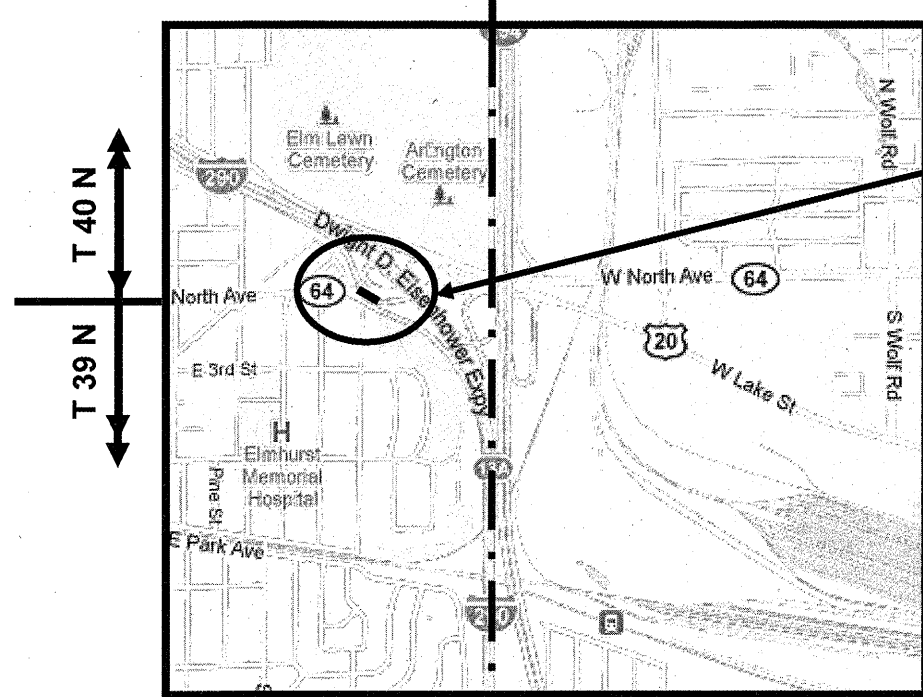

LOCATION 1: SN 022-0015
I-290 RAMP A-OVER IL 64 (NORTH AVE.), ONE MILE WEST OF I-290.

TRAFFIC DATA:

I-290: SPEED LIMIT = 55 MPH
2002 ADT = 23,400
IL 64 (NORTH AVE.): SPEED LIMIT = 45 MPH
2009 ADT = 31,700

VILLAGE OF ELMHURST
YORK TOWNSHIP
DuPAGE COUNTY

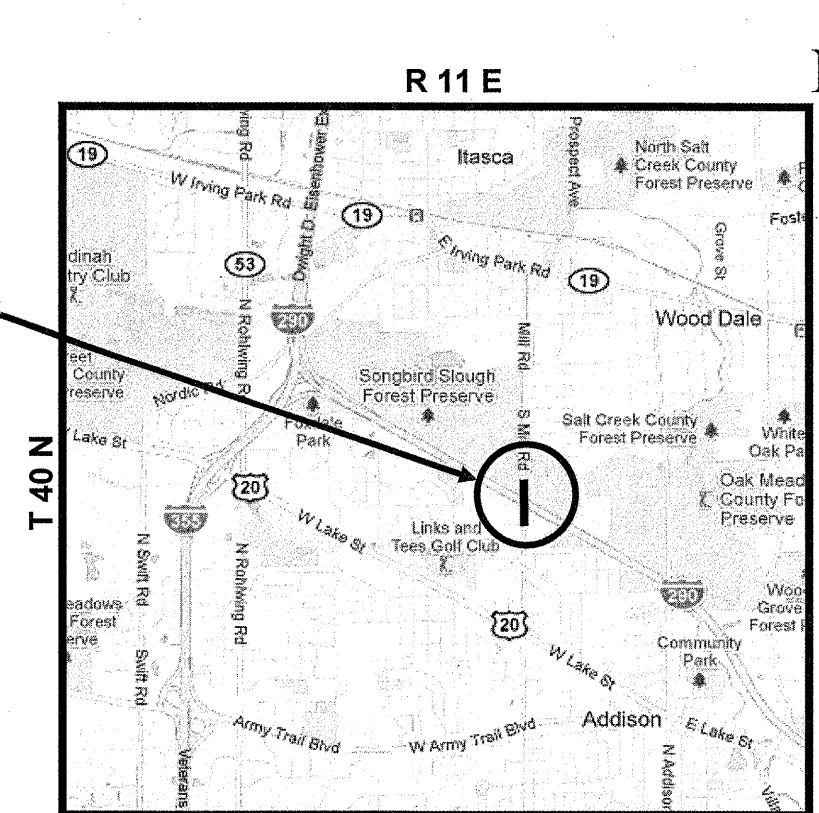

LOCATION 2: SN 022-0109
MILL ROAD OVER I-290, 2.6 MILES WEST OF IL 83.

TRAFFIC DATA:

MILL ROAD: SPEED LIMIT = 25 MPH
2008 ADT = 1,350
I-290: SPEED LIMIT = 55 MPH
2009 ADT = 155,800

VILLAGE OF ADDISON
ADDISON TOWNSHIP
DuPAGE COUNTY

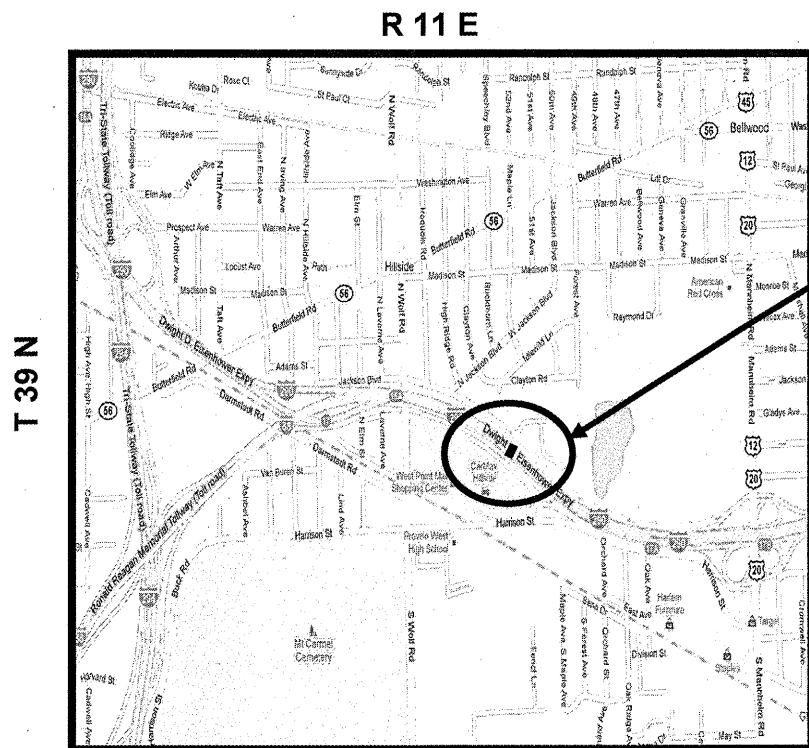

LOCATION 3: SN 016-0986
I-290 OVER HILLSIDE ROAD, 0.7 MILE WEST US 12.

TRAFFIC DATA:

I-290: SPEED LIMIT = 55 MPH
2009 ADT = 206,800
HILLSIDE DR: SPEED LIMIT = 40 MPH
2009 ADT = 206,800

VILLAGE OF HILLSIDE
PROVISO TOWNSHIP
COOK COUNTY

ILLINOIS DEPARTMENT OF
TRANSPORTATION

LOCATION MAPS