

PROJECT BEGINS
STA. 88+25.00

PROJECT ENDS
STA. 91+75.00

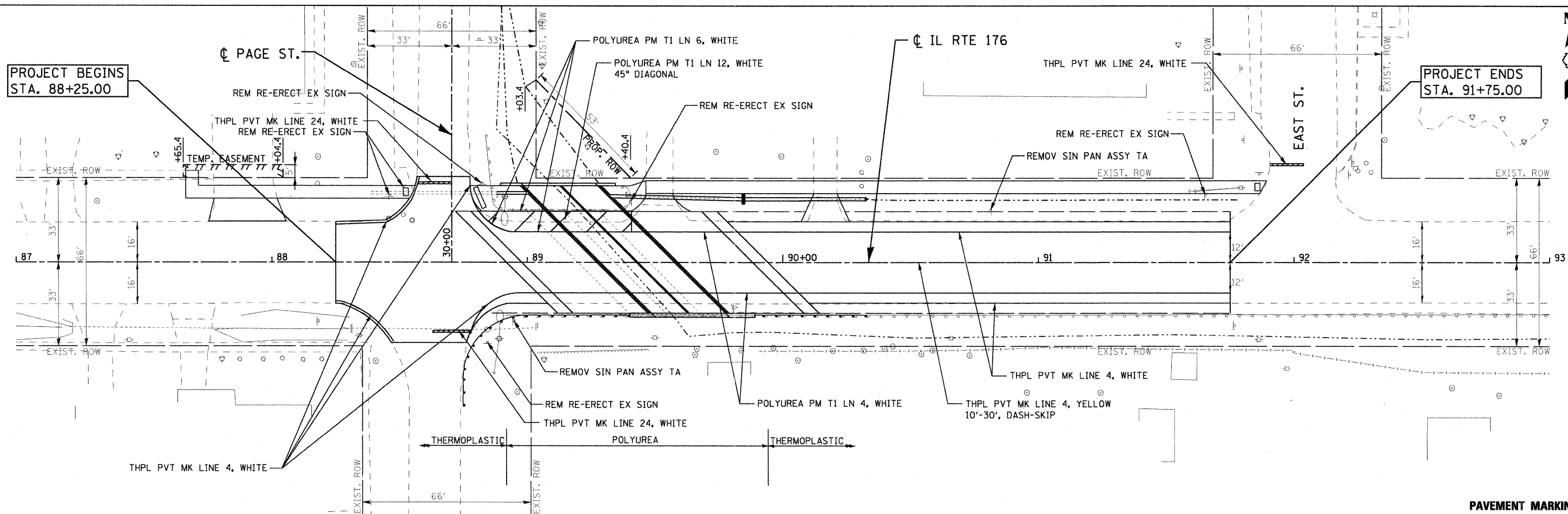

PAVEMENT MARKING

PROJECT BEGINS
STA. 88+25.00

PROJECT ENDS
STA. 91+75.00

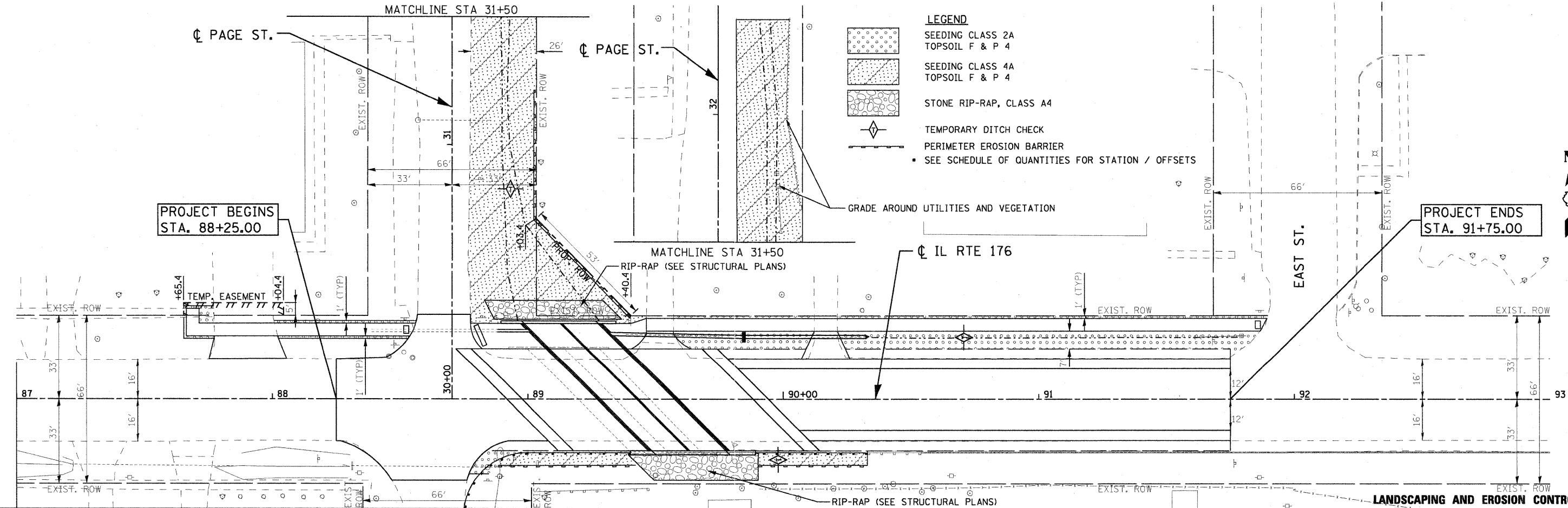

LANDSCAPING AND EROSION CONTROL

- LEGEND**
- SEEDING CLASS 2A
TOPSOIL F & P 4
 - SEEDING CLASS 4A
TOPSOIL F & P 4
 - STONE RIP-RAP, CLASS A4
 - TEMPORARY DITCH CHECK
 - PERIMETER EROSION BARRIER
 - SEE SCHEDULE OF QUANTITIES FOR STATION / OFFSETS

FILE NAME = G:\pwr\met\2021\533\02\CA000\Cvt1\Sh\A\1160W54-12\hnt-PM\landErc.dgn



USER NAME = 2PIEND	DESIGNED - DLP	REVISED -
PLOT SCALE = 20.00' / 1" IN.	DRAWN - ENTRAN	REVISED -
PLOT DATE = 8/31/2011	CHECKED - TMH	REVISED -
	DATE - 04/07/11	REVISED -

STATE OF ILLINOIS
DEPARTMENT OF TRANSPORTATION

FAP ROUTE 533 (IL RTE 176) OVER DRAINAGE DITCH (EAST OF IL RTE 23)
PAVEMENT MARKING, LANDSCAPING, AND EROSION CONTROL

SCALE: 1" = 20' SHEET NO. OF SHEETS STA. TO STA.

F.A.P. RTE. 533	SECTION 119-T-1	COUNTY McHENRY	TOTAL SHEETS 40	SHEET NO. 15
IL ROUTE 176		CONTRACT NO. 60M54		
FED. ROAD DIST. NO.		ILLINOIS FED. AID PROJECT		