

| UTILITY OWNERS | |
|----------------|---------------|
| COMED | = ELECTRIC |
| COMCAST | = CABLE TV |
| AT&T | = TELEPHONE |
| AT&T | = FIBER OPTIC |
| NICOR | = GAS |
| AMERICAN | = WATER |
| ENBRIDGE | = PIPELINE |

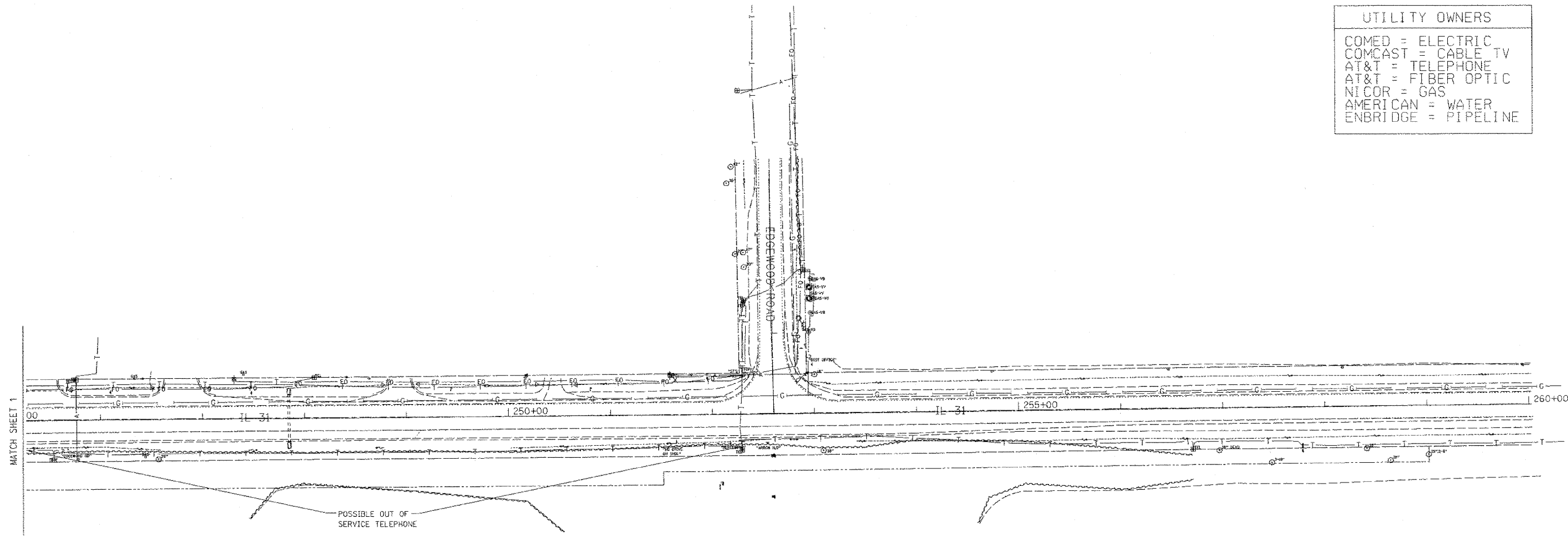

| | |
|---------------|----------------|
| — A — A — | AERIAL UTILITY |
| — — — — | UNKNOWN |
| — CTV — CTV — | CABLE TV |
| — T — T — | TELEPHONE |
| — G — G — | GAS |
| — E — E — | ELECTRIC |
| — W — W — | WATER |
| — FO — FO — | FIBER OPTIC |
| — — — — | SEWER |
| ⊕ | TBE TEST HOLE |

Utilities shown on these plans as depicted in the legend have been investigated by Cardno TBE in accordance with SUE Industry Standards. All other information shown has been provided to Cardno TBE by others. TBE's SUE field investigation was performed 11/18/10 through 11/30/10. Changes to utilities after these dates may have been made and therefore may result in variances from this plan. Consideration should be given to updating this plan if deemed advisable prior to final design and construction.

ALL UTILITIES SHOWN QUALITY LEVEL "B" UNLESS NOTED OTHERWISE.



TBE Job No. 1109510423
SUE Plan Page: 2 of 2

| |
|--|
| Utility Quality Level "A" : Test Hole |
| Utility Quality Level "B" : Designating |
| Utility Quality Level "C" : Research with Survey |
| Utility Quality Level "D" : Records Research |

| | |
|---------------------|---------|
| DESIGNED <i>ER</i> | REVISED |
| DRAWN <i>KLC</i> | REVISED |
| CHECKED | REVISED |
| DATE <i>1/04/11</i> | REVISED |

STATE OF ILLINOIS
DEPARTMENT OF TRANSPORTATION

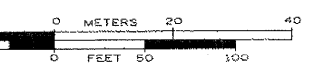

Ames Road to Edgewood Road
Prairie Grove, IL

| F.A. RTE. | SECTION | COUNTY | TOTAL SHEETS | SHEET NO. |
|--|------------|---------|--------------------|-----------|
| 336 | 2010-049-N | McHenry | 60 | 28 |
| FED. ROAD DIST. NO. 1 ILLINOIS DOT Project No. | | | Contract No. 60L25 | |