

F.A.P. RTE.	SECTION	COUNTY	TOTAL SHEETS	SHEET NO.
729	34Z-4	VERMILION	285	126
STA. 91+501.26		TO STA. 20+977.36		
FED. ROAD DIST. NO.		ILLINOIS FED. AID PROJECT		

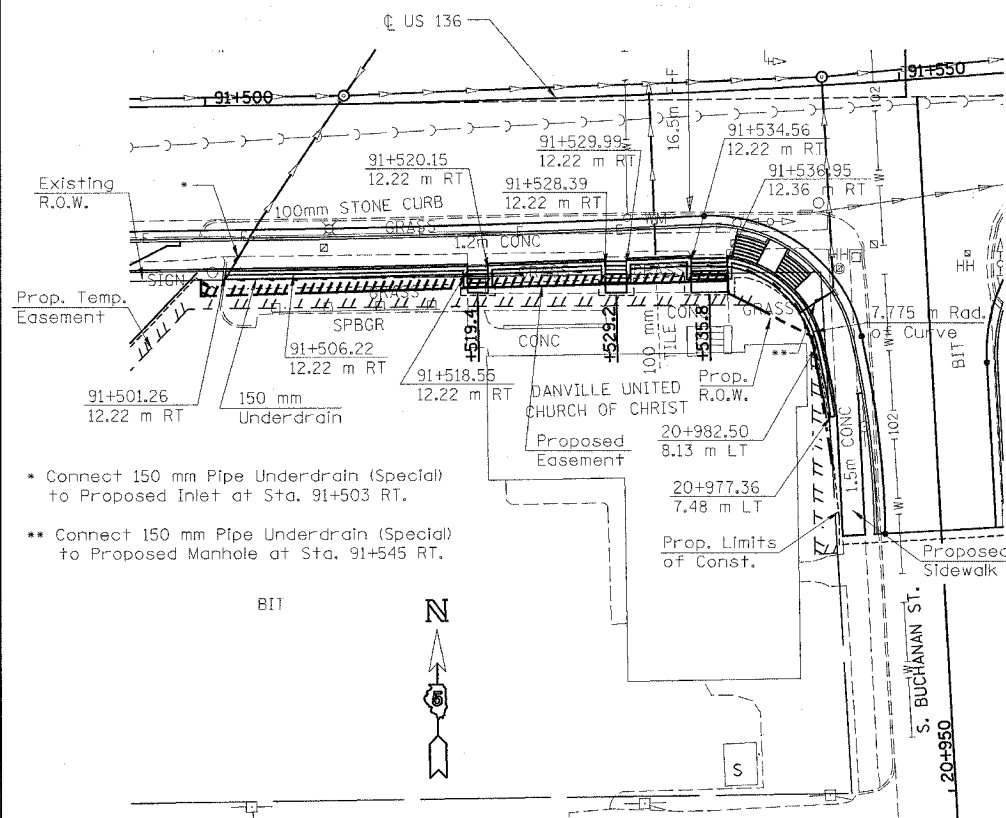

- * Connect 150 mm Pipe Underdrain (Special) to Proposed Inlet at Sta. 91+503 RT.
- ** Connect 150 mm Pipe Underdrain (Special) to Proposed Manhole at Sta. 91+545 RT.

PLAN
SCALE: 1:250

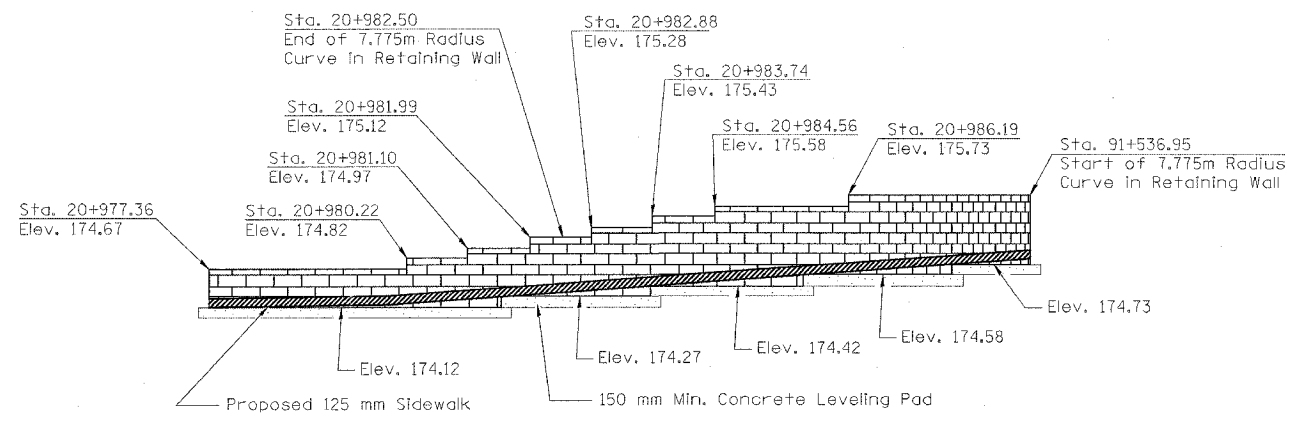

ELEVATION
SCALE: 1:50
(Looking Southwest From S Buchanan Street)

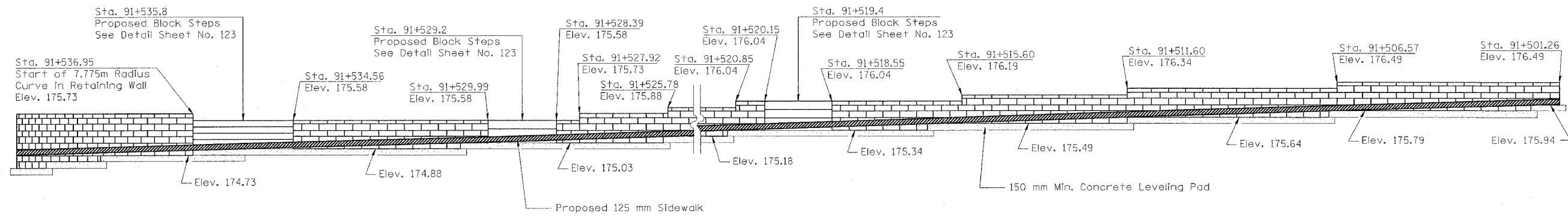

ELEVATION
SCALE: 1:50
(Looking From US 136)

- NOTES**
- Offsets Refer to the Distance from Roadway to the Back Face of the Lowest Block of the Retaining Wall at the Given Station.
 - Refer to Sheet for Typical Cross-Section of the Block Retaining Wall.

REVISIONS		ILLINOIS DEPARTMENT OF TRANSPORTATION BLOCK RETAINING WALL DETAILS U.S. ROUTE 136
NAME	DATE	
		SCALE --- DATE 5/03 DRAWN BY MTH CHECKED BY KRG