

DATE	
BY	
REVISIONS	
NO.	
DATE	
BY	
REVISIONS	
NO.	
DATE	
BY	
REVISIONS	
NO.	

**CMT**  
 CONSULTING ENGINEERS  
 License No. 01-000783  
 6500 W. 111th St. N.E.  
 Minneapolis, MN 55438  
 (763) 835-1100

DATE	
BY	
REVISIONS	
NO.	
DATE	
BY	
REVISIONS	
NO.	
DATE	
BY	
REVISIONS	
NO.	

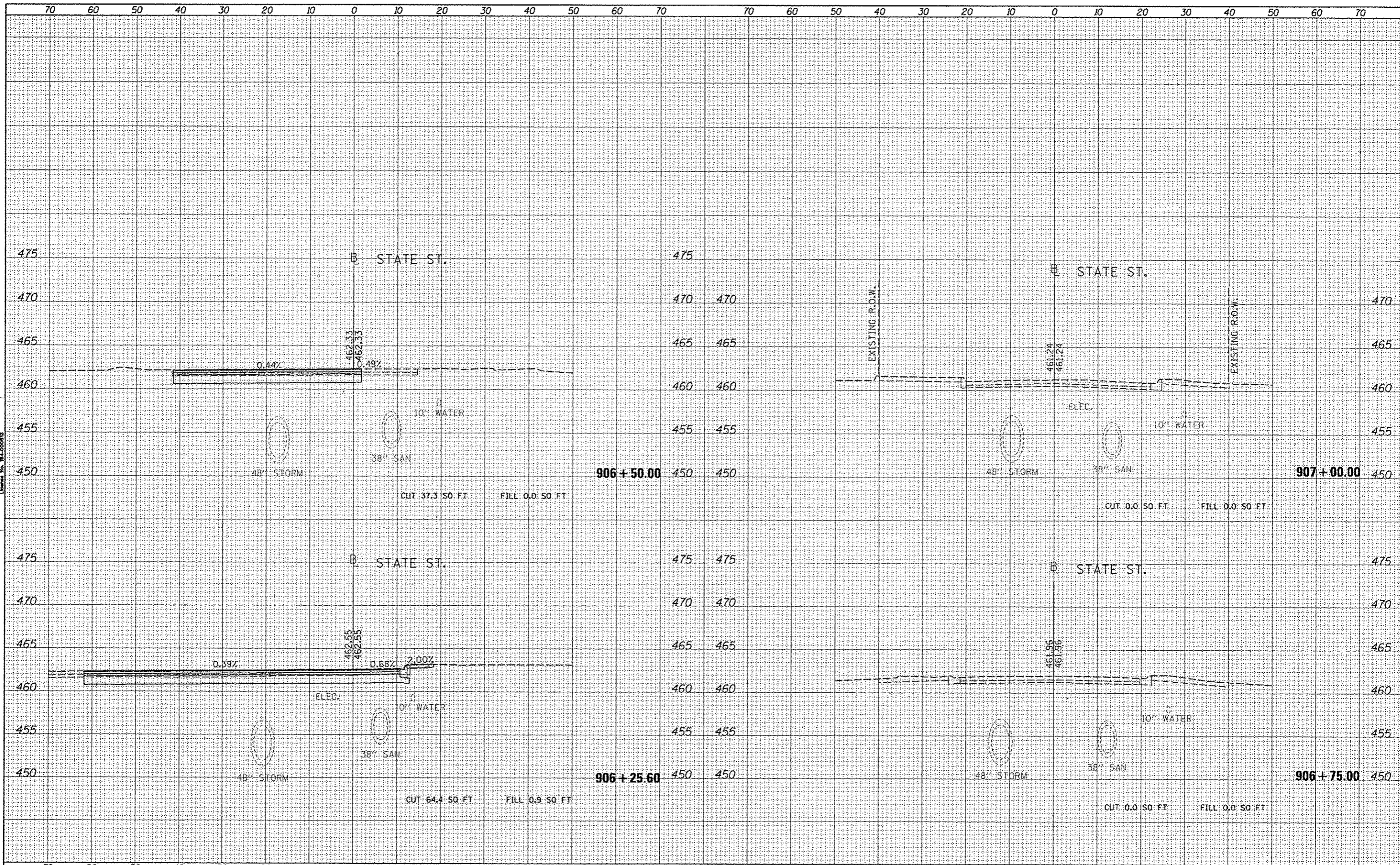

FILE NAME	USER NAME	DESIGNED	REVISED	<b>STATE OF ILLINOIS</b> <b>DEPARTMENT OF TRANSPORTATION</b>	<b>STATE STREET</b> <b>CROSS SECTIONS</b>	F.A.U. RTE.	SECTION	COUNTY	TOTAL SHEETS	SHEET NO.
ca\pwwork\do_not_delete\dms73328\041010150	kovan01511	- RMM/EMM	-			12-00356-01-PV	PEORIA	519	500	
	shx:xxah1025.dgn	- RJE	-			CONTRACT NO. 89626		ILLINOIS FED. AID PROJECT TIC-50931581		
	PLOT SCALE = 20.0000' / 1"	CHECKED - E.JH	REVISED -			SCALE: N/A	SHEET OF SHEETS	STA. TO STA.		
	PLOT DATE = 07/23/2012	DATE - 7/18/12	REVISED -							