

| | |
|---------------|--|
| DATE | |
| BY | |
| SKETCHED | |
| FINAL SURVEY | |
| NOTE BOOK | |
| AREAS | |
| AREAS CHECKED | |

Copyright © 2012
CMT
 CONSULTING ENGINEERS
 License No. 01-000000



| | |
|---------------|--|
| DATE | |
| BY | |
| SKETCHED | |
| FINAL SURVEY | |
| NOTE BOOK | |
| AREAS | |
| AREAS CHECKED | |

FILE NAME *
 USER NAME = kovan01511
 DESIGNED - RMM/EMM
 DRAWN - RJE
 CHECKED - EJM
 DATE - 7/18/12

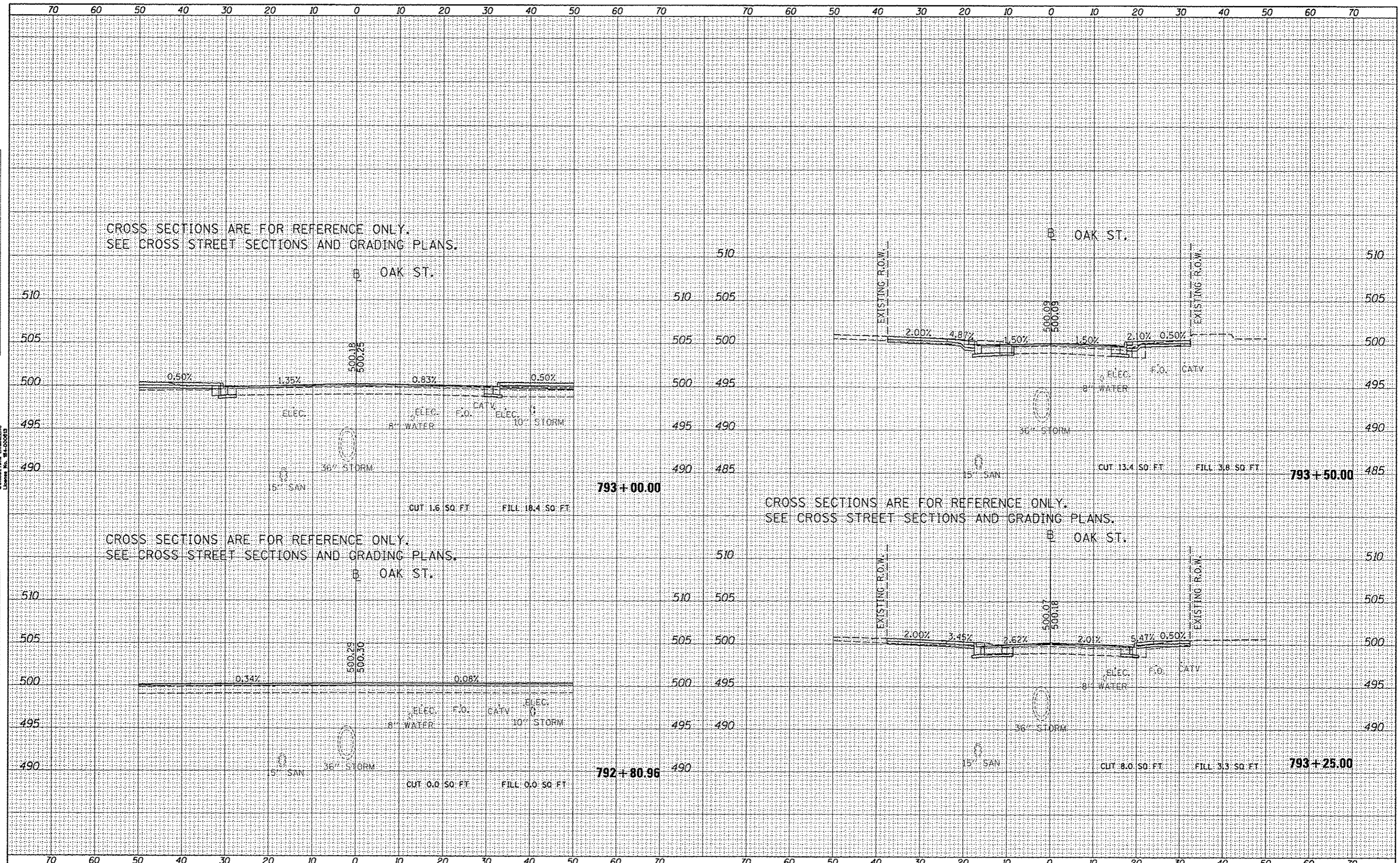

CROSS SECTIONS ARE FOR REFERENCE ONLY.
 SEE CROSS STREET SECTIONS AND GRADING PLANS.

CROSS SECTIONS ARE FOR REFERENCE ONLY.
 SEE CROSS STREET SECTIONS AND GRADING PLANS.

793+00.00

792+80.96

793+50.00

793+25.00

STATE OF ILLINOIS
 DEPARTMENT OF TRANSPORTATION

OAK STREET
 CROSS SECTIONS

SCALE: N/A SHEET OF SHEETS STA. TO STA.

| | | | | |
|--------------------|----------------|--------|--|-----------|
| F.A.U. RTE. | SECTION | COUNTY | TOTAL SHEETS | SHEET NO. |
| 12 | 12-00356-01-PV | PEORIA | 519 | 479 |
| CONTRACT NO. 89626 | | | [ILLINOIS] FED. AID PROJECT TIC-50931581 | |