

ELM STREET AND SW MEYER INTERSECTION NORTH SIDEWALK RAMP GRADES					
POINT NO.	STATION	OFFSET	SIDE	ELEVATION	LOCATION
EM100	747+54.38	31.95	LT	501.54	SW
EM101	747+54.38	23.95	LT	501.38	SW
EM102	747+59.38	31.95	LT	501.48	SW
EM103	747+59.38	23.95	LT	501.32	SW
EM104	747+61.38	31.95	LT	501.44	SW
EM105	747+61.38	23.95	LT	501.28	SW
EM106	747+70.00	33.39	LT	501.46	SW
EM107	747+70.00	25.39	LT	501.30	SW
EM108	747+78.08	34.73	LT	501.50	SW
EM109	747+78.08	26.73	LT	501.34	SW
EM110	747+80.08	34.72	LT	501.54	SW
EM111	747+80.08	26.72	LT	501.38	SW
EM112	747+85.08	34.67	LT	501.43	SW
EM113	747+85.08	26.67	LT	501.27	SW

5 0 5 10

LEGEND

JEFFERSON AVENUE AND ELM STREET SIDEWALK GRADING POINT NUMBER

AW101 474.23

POINT ELEVATION

EOP	= EDGE OF PAVEMENT
BOC	=BACK OF CURB
SW	=SIDEWALK
TOC	=TOP OF CURB
CW	=CROSSWALK

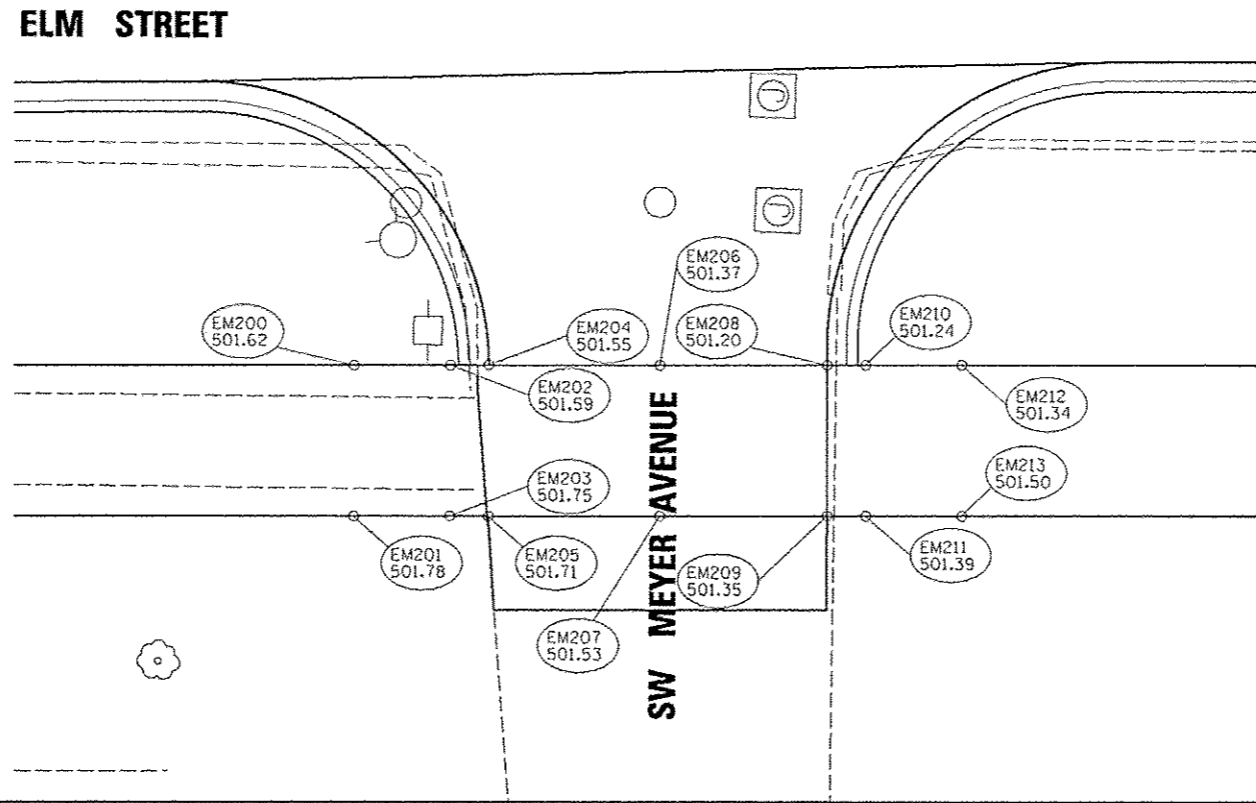

ELM STREET AND SW MEYER INTERSECTION SOUTH SIDEWALK RAMP GRADES					
POINT NO.	STATION	OFFSET	SIDE	ELEVATION	LOCATION
EM200	747+54.12	27.00	RT	501.62	SW
EM201	747+54.09	35.00	RT	501.78	SW
EM202	747+59.12	27.00	RT	501.59	SW
EM203	747+59.09	35.00	RT	501.75	SW
EM204	747+61.12	27.00	RT	501.55	SW
EM205	747+61.09	35.00	RT	501.71	SW
EM206	747+70.00	27.00	RT	501.37	SW
EM207	747+70.00	35.00	RT	501.53	SW
EM208	747+78.73	27.00	RT	501.20	SW
EM209	747+78.73	35.00	RT	501.35	SW
EM210	747+80.73	27.00	RT	501.24	SW
EM211	747+80.73	35.00	RT	501.39	SW
EM212	747+85.73	27.00	RT	501.34	SW
EM213	747+85.73	35.00	RT	501.50	SW

