

ADAMS & STATE STREET INTERSECTION SOUTHWEST SIDEWALK RAMP GRADES					
POINT NO	STATION	OFFSET	SIDE	ELEVATION	LOCATION
STS100	158+32.26	17.58	LT	497.70	TOC
STS101	158+32.84	17.58	LT	497.24	TOC
STS102	158+32.84	16.00	LT	497.25	EOP
STS103	158+40.84	16.00	LT	497.23	EOP
STS104	158+40.84	17.58	LT	497.22	TOC
STS105	158+41.42	17.58	LT	497.67	TOC
STS106	158+41.42	23.58	LT	497.40	SW
STS107	158+32.26	23.58	LT	497.43	SW
STS108	158+32.83	35.51	LT	497.55	SW
STS109	158+40.84	35.51	LT	497.52	SW

STATE STREET

ADAMS & STATE STREET INTERSECTION NORTHWEST SIDEWALK RAMP GRADES					
POINT NO	STATION	OFFSET	SIDE	ELEVATION	LOCATION
STS200	159+04.34	23.58	LT	497.20	SW
STS201	159+04.26	17.58	LT	497.49	TOC
STS202	159+04.84	17.58	LT	496.99	TOC
STS203	159+04.84	16.00	LT	497.00	EOP
STS204	159+12.84	16.00	LT	496.97	EOP
STS205	159+12.84	17.58	LT	496.96	TOC
STS206	159+13.42	17.58	LT	497.46	TOC
STS207	159+12.84	23.58	LT	497.17	SW
STS208	159+04.84	35.53	LT	497.32	SW
STS209	159+12.84	35.53	LT	497.29	SW

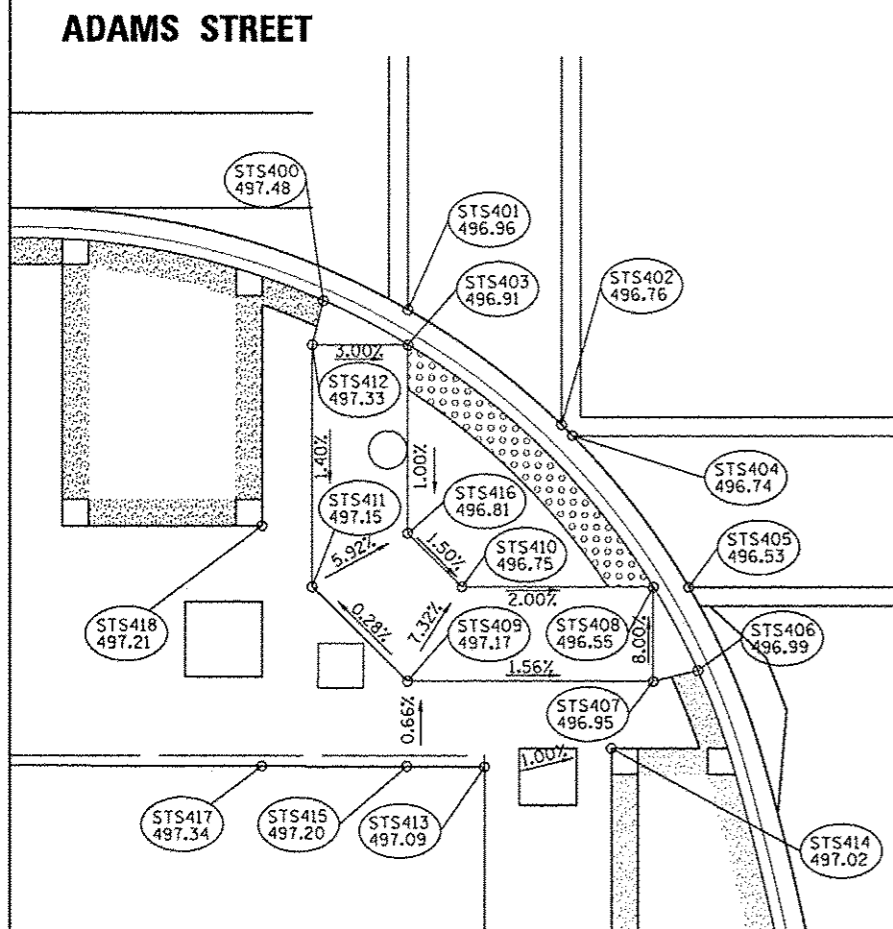
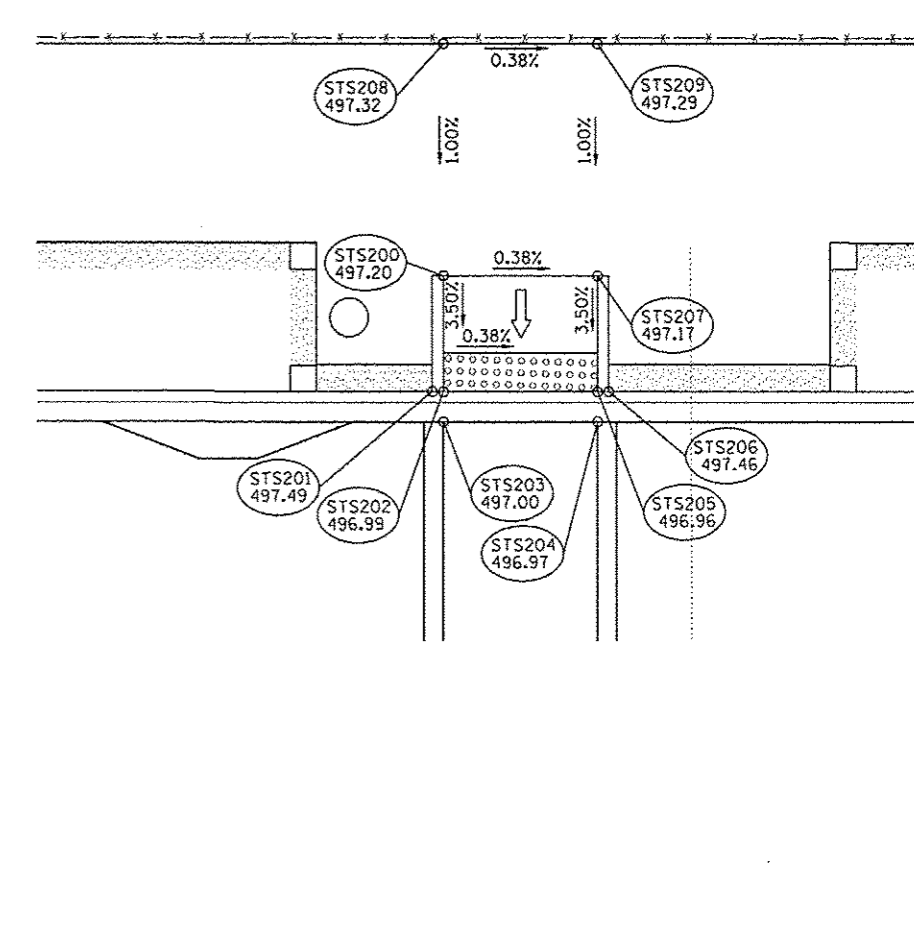

ADAMS & STATE STREET INTERSECTION SOUTHEAST SIDEWALK RAMP GRADES					
POINT NO	STATION	OFFSET	SIDE	ELEVATION	LOCATION
STS400	158+28.43	15.88	RT	497.48	TOC
STS401	158+32.86	16.35	RT	496.96	EOP
STS402	158+40.86	22.42	RT	496.76	EOP
STS403	158+32.86	18.19	RT	496.91	EOP
STS404	158+41.44	23.00	RT	496.74	EOP
STS405	158+47.51	31.00	RT	496.53	EOP
STS406	158+47.59	35.43	RT	496.99	TOC
STS407	158+45.68	36.00	RT	496.95	SW
STS408	158+45.67	31.00	RT	496.55	TOC
STS409	158+32.86	36.01	RT	497.17	SW
STS410	158+35.69	31.01	RT	496.75	SW
STS411	158+27.86	31.01	RT	497.15	SW
STS412	158+27.86	18.19	RT	497.33	SW
STS413	158+36.87	40.57	RT	497.08	SW
STS414	158+43.49	39.58	RT	497.02	SW
STS415	158+32.86	40.56	RT	497.20	SW
STS416	158+32.86	28.18	RT	496.81	SW
STS417	158+25.23	40.54	RT	497.34	SW
STS418	158+25.23	27.79	RT	497.21	SW

STATE STREET

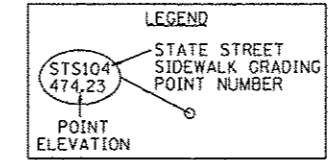

ADAMS & STATE STREET INTERSECTION NORTHEAST SIDEWALK RAMP GRADES					
POINT NO	STATION	OFFSET	SIDE	ELEVATION	LOCATION
STS300	159+17.41	17.59	RT	497.22	TOC
STS301	159+12.86	17.84	RT	496.71	EOP
STS302	159+12.86	19.63	RT	496.69	TOC
STS303	159+04.86	22.37	RT	496.57	EOP
STS304	159+03.91	22.98	RT	496.55	EOP
STS305	158+94.14	31.00	RT	496.29	EOP
STS306	158+92.97	34.63	RT	496.62	SW
STS307	158+96.42	31.00	RT	496.33	TOC
STS308	158+96.42	36.00	RT	496.65	SW
STS309	159+10.03	31.00	RT	496.61	SW
STS310	159+12.86	36.00	RT	496.90	SW
STS311	159+17.86	31.00	RT	496.50	SW
STS312	159+17.86	19.63	RT	497.10	SW
STS313	159+06.12	39.63	RT	496.85	SW
STS314	159+20.66	27.79	RT	497.00	SW
STS315	159+12.86	28.18	RT	496.65	SW
STS316	159+16.40	39.54	RT	497.00	SW
STS317	159+21.40	34.54	RT	497.00	SW

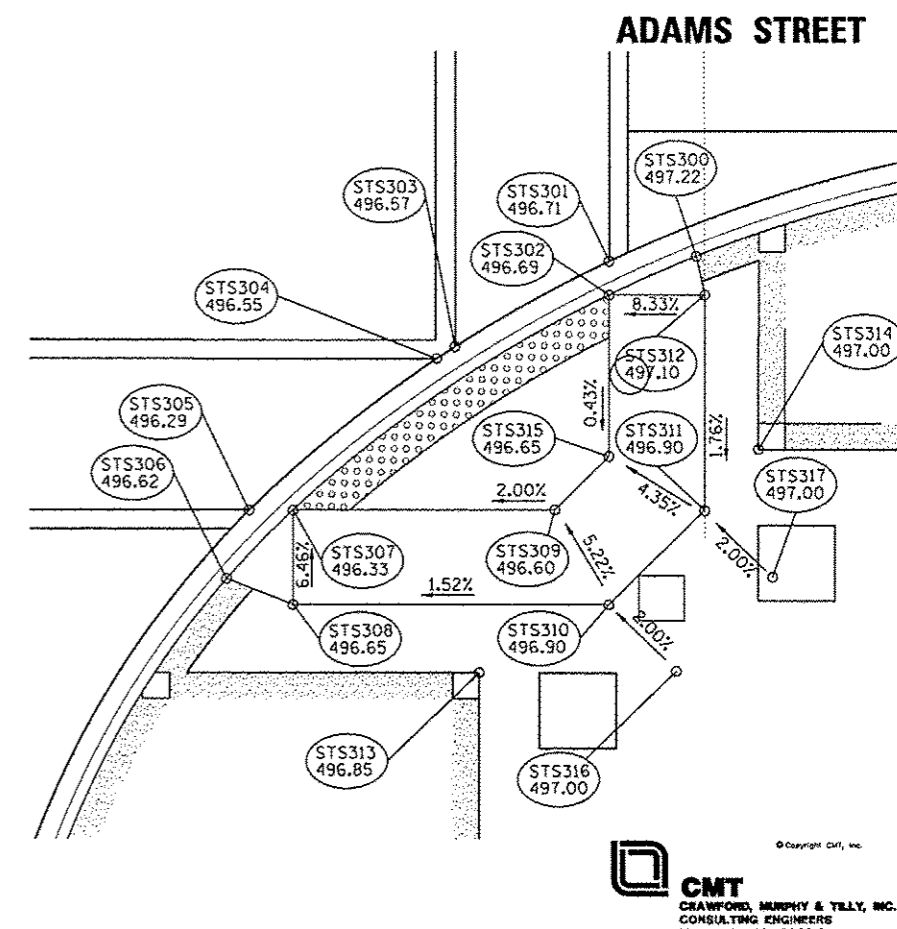

FILE NAME =	USER NAME = manak01390	DESIGNED = RMM/EMM	REVISED =
or\pwise\work\do_no_delete\dm\73320\04	PLT159-rt-ramp_detail.06.dgn	DRAWN = RJE	REVISED =
	PLT SCALE = 1/8"=1'-0"	CHECKED = EJH	REVISED =
	PLT DATE = 07/23/2012	DATE = 7/18/12	REVISED =

STATE OF ILLINOIS
DEPARTMENT OF TRANSPORTATION

ADAMS STREET AND STATE STREET SIDEWALK RAMP DETAIL			
SCALE: 1"=5'	SHEET NO. OF SHEETS	STA. TO STA.	

F.A.U. RTE.	SECTION	COUNTY	TOTAL SHEETS	SHEET NO.
	12-00356-01-PV	PEORIA	519	396
CONTRACT NO. 89626				
[ILLINOIS] FED. AID PROJECT YIG-50931581				

