

- 823 STA. 799+43.67, 13.6' RT.
INLET TY G-1
RIM = 488.79
INV (NE) = 485.85
- 824 STA. 799+45.03, 3.5' RT.
MH, TY A, 7' DIA., TY-1 F, CL
RIM = 488.91
INV (NE) = 485.70
INV (SW) = 485.79
INV (NW) = 478.62 (EX.)
INV (SE) = 478.62 (EX.)
- 825 STA. 799+44.96, 11.6' LT.
INLET TY G-1
RIM = 488.75
INV (SW) = 485.81
INV (N) = 486.25
- 294 STA. 799+77.66, 21.4' RT.
INLET, TY B, TY-1 F, CL
RIM = 486.72
INV (SW) = 484.50 (EX.)
INV (E) = 484.50 (EX.)

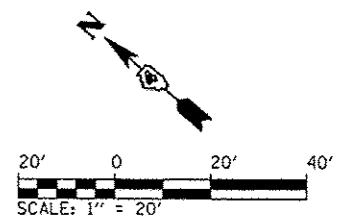
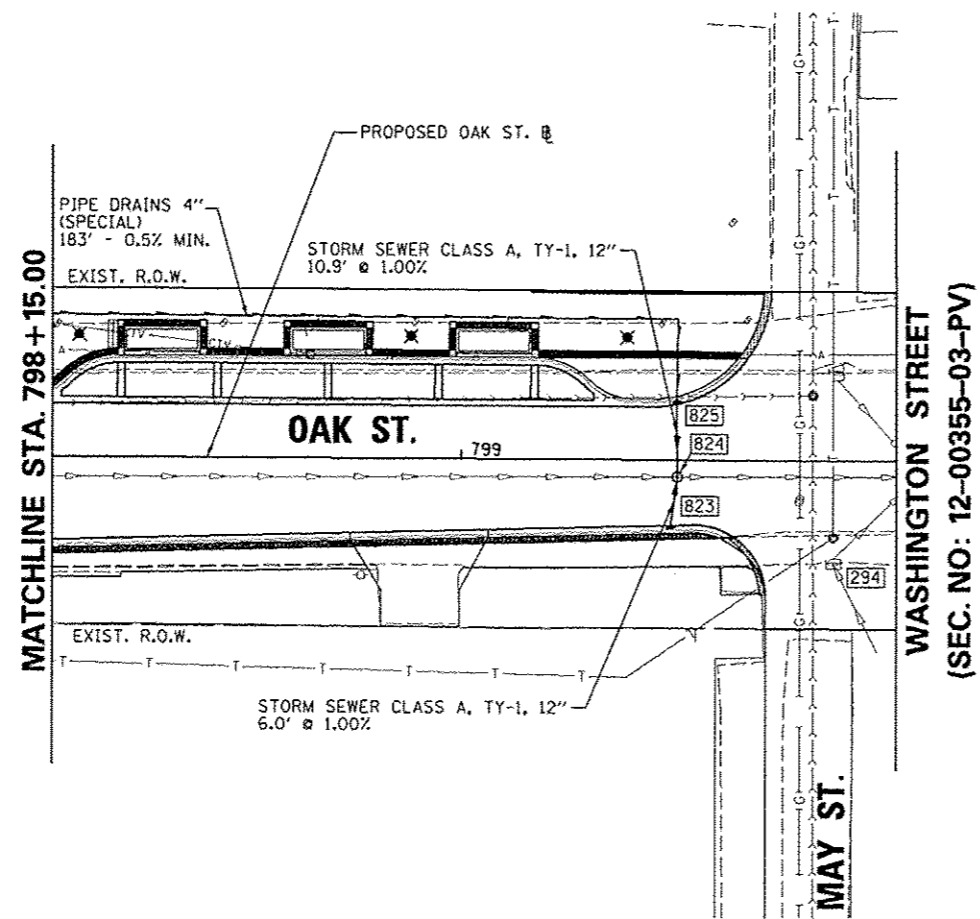

PLAN	DATE
REVISIONS	BY
NO.	
DATE	
BY	
REVISIONS	
NO.	
DATE	
BY	

PROFILE	DATE
REVISIONS	BY
NO.	
DATE	
BY	
REVISIONS	
NO.	
DATE	
BY	

CMT
CRAWFORD, MURPHY & TILLY, INC.
CONSULTING ENGINEERS
License No. 184-000813

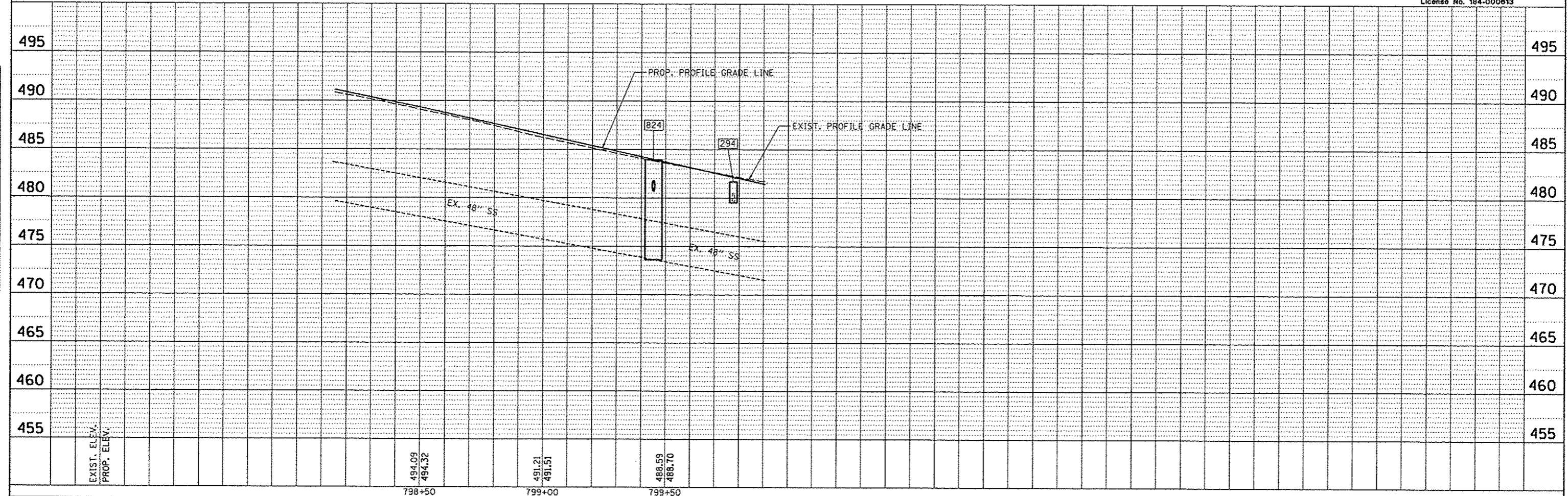

FILE NAME *	USER NAME * kaven0101	DESIGNED - RMM	REVISED -	STATE OF ILLINOIS DEPARTMENT OF TRANSPORTATION	OAK STREET DRAINAGE PLAN AND PROFILE	F.A.U. R.T.E.	SECTION	COUNTY	TOTAL SHEETS	SHEET NO.	
o:\pwise_work\do_not_delete\des\73472\0410	B155-shr-drain-prpl07.dgn	DRAWN - RJE	REVISED -			12	12-00356-01-PV	PEORIA	519	232	
	PLOT SCALE * 3/4" = 1' / in.	CHECKED - EJM	REVISED -			CONTRACT NO. 089626					
	PLOT DATE * 07/23/2012	DATE - 7/18/12	REVISED -			ILLINOIS FED. AID PROJECT TIG-5093458					