



PIPE NUMBER	FROM STRUCTURE	DEPTH	U/S INVERT	TO STRUCTURE	DEPTH	D/S INVERT	AVERAGE DEPTH	CLASS TYPE	DIAM.	LENGTH	SLOPE	CLSM
530	708	3.4	498.95	710	4.1	498.30	3.7	STORM SEWER (WATER MAIN REQUIREMENTS)	12	117.5	0.55%	36
531	710	4.2	498.20	711	4.1	498.00	4.1	STORM SEWER (WATER MAIN REQUIREMENTS)	12	38.5	0.52%	3
357	714	3.3	498.50	714A	4.1	498.00	3.7	STORM SEWERS, CLASS A, TYPE 2	12	10.0	5.00%	3
534	712	3.4	498.45	712A	4.0	498.35	3.7	STORM SEWER (WATER MAIN REQUIREMENTS)	12	9.0	1.11%	3
534A	712A	4.1	498.25	711	4.1	498.00	4.1	STORM SEWER (WATER MAIN REQUIREMENTS)	12	27.0	0.93%	9
639	713	3.0	498.75	712	3.3	498.55	3.1	STORM SEWER (WATER MAIN REQUIREMENTS)	12	23.0	0.87%	6
359A	716A	2.8	499.15	717A	3.2	498.90	3.0	STORM SEWER (WATER MAIN REQUIREMENTS)	12	50.0	0.50%	12
536B	717A	3.5	498.80	717	4.0	498.28	3.7	STORM SEWERS, CLASS A, TYPE 2	12	77.0	0.68%	24
359	716	3.0	498.90	717	3.6	498.70	3.3	STORM SEWER (WATER MAIN REQUIREMENTS)	12	43.5	0.46%	12
539	717	4.1	498.18	720	3.9	497.68	4.0	STORM SEWERS, CLASS A, TYPE 2	12	141.5	0.35%	48
219	719	2.7	498.35	720	3.4	498.10	3.1	STORM SEWER (WATER MAIN REQUIREMENTS)	12	45.0	0.56%	11
219A	719A	2.4	499.35	719	2.6	498.45	2.5	STORM SEWERS, CLASS A, TYPE 1	12	90.1	1.00%	
540	720	4.0	497.58	722A	4.1	497.15	4.0	STORM SEWERS, CLASS A, TYPE 1	12	101.0	0.43%	34
222	724	3.1	497.50	725	4.4	496.70	3.7	STORM SEWERS, CLASS A, TYPE 1	12	4.0	20.00%	1
224	726	3.4	497.40	727	3.5	497.20	3.4	STORM SEWER (WATER MAIN REQUIREMENTS)	15	28.5	0.70%	8

STRUCTURE NUMBER	STA	OFFSET	TYPE	RIM	INVERTS								
					N	NE	E	SE	S	SW	W	NW	
710	245+00.00	11.33	RT	DRYWELL, TYPE G-1, 4' DIA.	502.39			498.20			498.30		
711	245+39.00	27.68	RT	DRYWELL, 4' DIA, SPECIAL FR & GR	502.10	496.4 EX.		498.00				498.00	
712	246+39.95	12.23	RT	INLETS TYPE G-1	501.82		498.55						498.45
712A	246+28.56	18.35	RT	MAN TA 4 DIA T1F CL	502.40				498.35			498.25	
713	246+40.00	13.63	LT	INLETS TYPE G-1	501.72						498.75		
714	245+70.20	25.33	LT	DRYWELL, TYPE G-1, 4' DIA.	501.77			498.50					
714A	245+80.80	16.19	LT	MAN TA 6 DIA T1F CL	502.13			494.1 EX.		492.9 EX.	489.8 EX.	498.00	490.5 EX.
716	247+55.00	25.33	LT	INLETS TYPE G-1	501.90				498.90				
716A	246+50.00	25.33	LT	INLETS TYPE G-1	501.92			499.15					
717	247+55.00	20.33	RT	INLETS TYPE G-1	502.28		498.18				498.28		498.70
717A	246+75.00	20.33	RT	INLETS TYPE G-1	502.13		498.90						498.90
719	249+15.00	25.33	LT	INLETS TYPE G-1	501.08					498.35	498.45		
719A	248+25.00	30.36	LT	INLETS TYPE A, T1F OL	501.73			499.35					
720	249+00.00	20.33	RT	DRYWELL, TYPE G-1, 4' DIA.	501.54	498.10	497.58				497.68		
722A	250+00.70	27.97	RT	MAN TA 5 DIA T1F CL	500.73			497.1 EX.	497.4 EX.		497.15		
723	745+94.14	14.27	RT	DRYWELL, TYPE G-1, 4' DIA.	500.43				498.00				497.9 EX.
724	745+95.00	9.63	LT	INLETS TYPE G-1	500.60	497.50							
725	745+91.24	16.57	LT	MAN TA 6 DIA T1F CL	501.06				496.5 EX.	496.70		496.6 EX.	
726	249+96.07	45.69	LT	INLETS TYPE G-1	500.75		497.40						
727	250+27.60	45.84	LT	DRYWELL, TYPE G-1, 4' DIA.	500.69				496.9 EX.		497.20		

DATE: \_\_\_\_\_  
 BY: \_\_\_\_\_  
 PLAN: \_\_\_\_\_  
 NOTE BOOK NO. \_\_\_\_\_  
 DATE FILE NAME: \_\_\_\_\_

DATE: \_\_\_\_\_  
 BY: \_\_\_\_\_  
 PROFILE: \_\_\_\_\_  
 NOTE BOOK NO. \_\_\_\_\_  
 DATE FILE NAME: \_\_\_\_\_

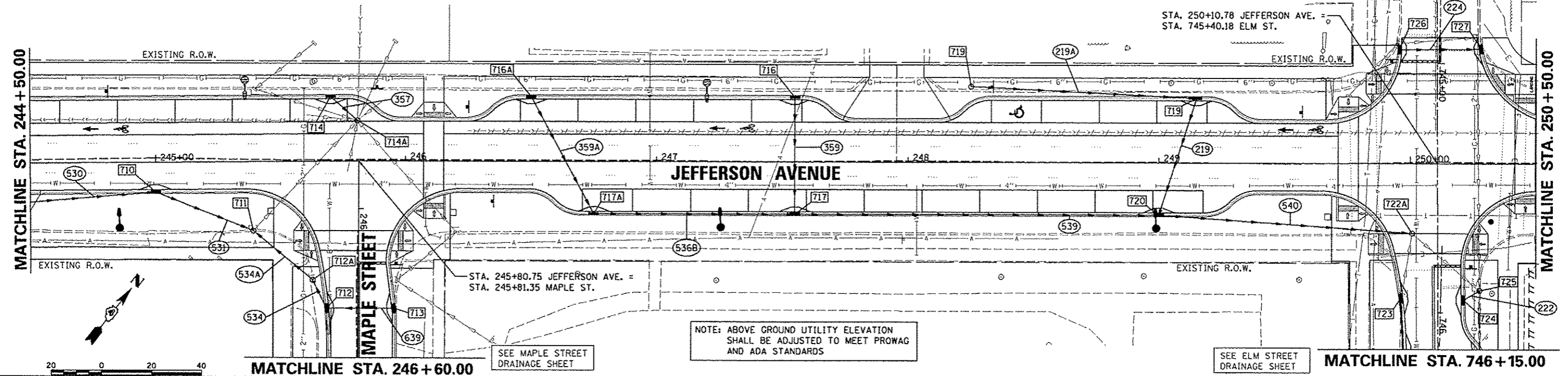

NOTE: ABOVE GROUND UTILITY ELEVATION SHALL BE ADJUSTED TO MEET PROWAG AND ADA STANDARDS

SEE MAPLE STREET DRAINAGE SHEET

SEE ELM STREET DRAINAGE SHEET

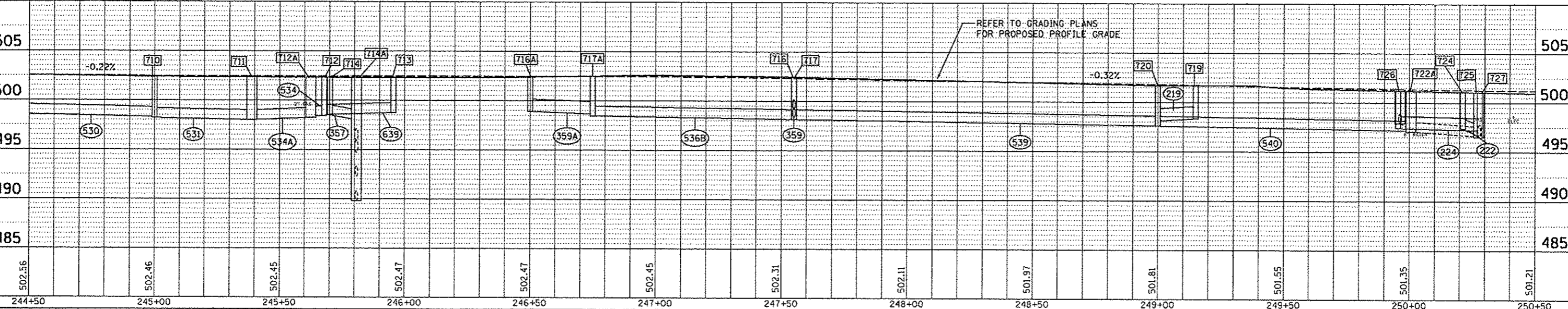

REFER TO GRADING PLANS FOR PROPOSED PROFILE GRADE