

DATE	
BY	
PLAN	
NO. _____	
DATE	
BY	
PROFILE	
NO. _____	
DATE	
BY	

DATE	
BY	
PLAN	
NO. _____	
DATE	
BY	
PROFILE	
NO. _____	
DATE	
BY	

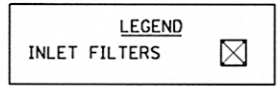
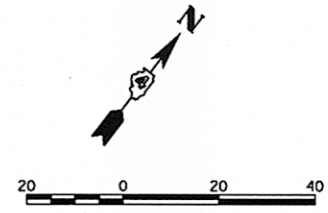
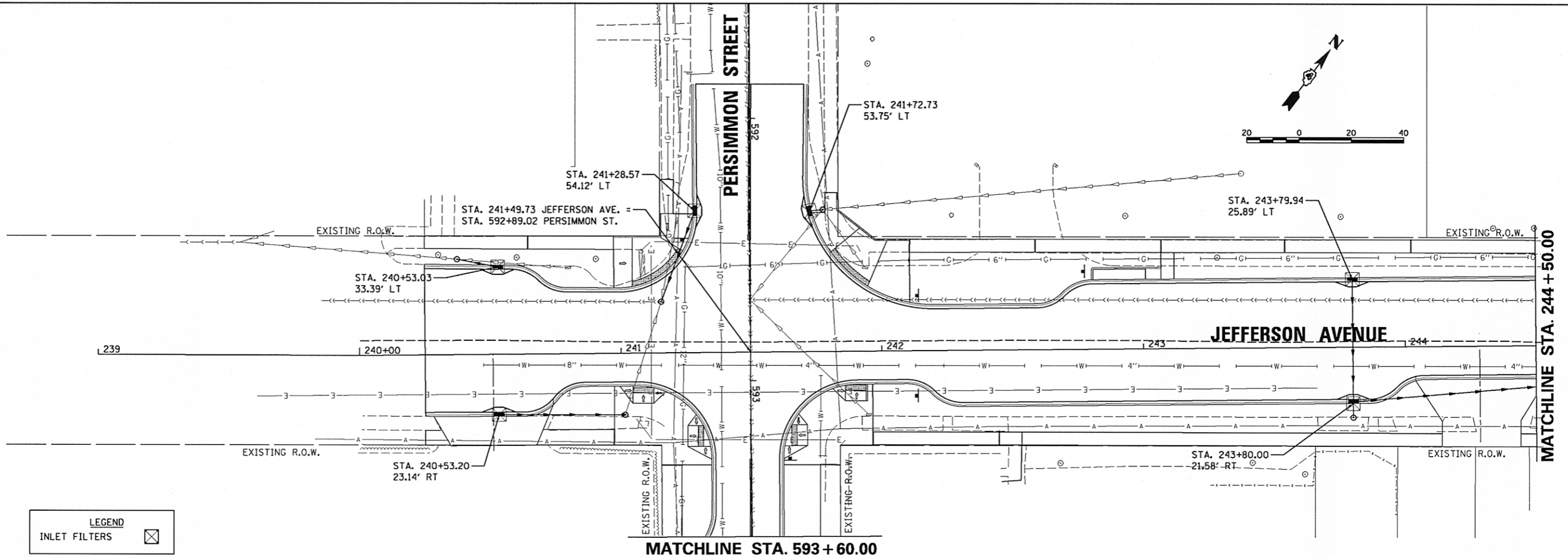

- NOTES:**
1. INLET FILTERS SHALL BE PROVIDED AT ALL EXISTING STORM SEWER STRUCTURE LOCATIONS.
 2. SEE STORM WATER POLLUTION PREVENTION PLAN AND PROVISIONS OF THE NPDES PERMIT ILR10 FOR DUST CONTROL CLEANING OF PAVEMENT REQUIREMENTS.

SEE PERSIMMON STREET
 EROSION CONTROL PLAN

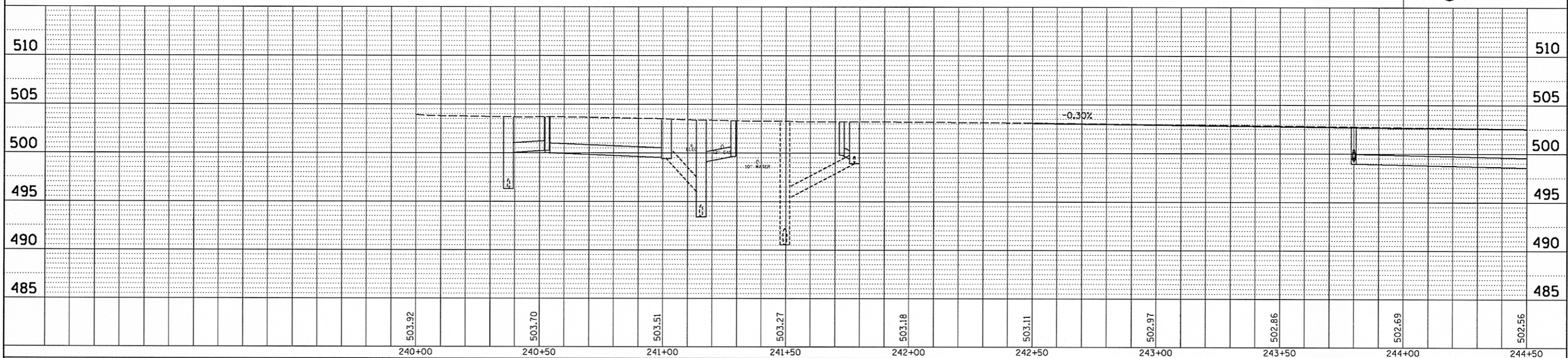

FILE NAME =	USER NAME = kovan01511	DESIGNED - VLK	REVISED -	STATE OF ILLINOIS DEPARTMENT OF TRANSPORTATION	JEFFERSON AVENUE EROSION CONTROL PLAN			F.A.U. RTE.	SECTION	COUNTY	TOTAL SHEETS	SHEET NO.
cr\pwise_work\do_not_delete\dms73308\0410	0155-shr-eros006.dgn	DRAWN - RLA	REVISED -		12-00356-01-PV	PEORIA	519	195				
PLLOT SCALE = 3/4" = 1' / in.		CHECKED - KNB	REVISED -		CONTRACT NO. 89626							
PLLOT DATE = 07/23/2012		DATE - 7/18/12	REVISED -		ILLINOIS FED. AID PROJECT TIG-5093(158)							