

NOTES:

1. STAGE I AND STAGE II OF COMMERCIAL ST. NEED TO BE CONSTRUCTED DURING STAGE I CONSTRUCTION ON STATE ST.
2. ACCESS TO THE WTVP STORAGE LOT AND ADJACENT PARKING LOT WEST OF OAK ST. NEEDS TO BE MAINTAINED THROUGHOUT BOTH STAGES OF CONSTRUCTION.
3. STAGE II OF OAK ST INTERSECTION NEED TO BE CONSTRUCTED HALF AT A TIME TO MAINTAIN TRAFFIC FLOW.

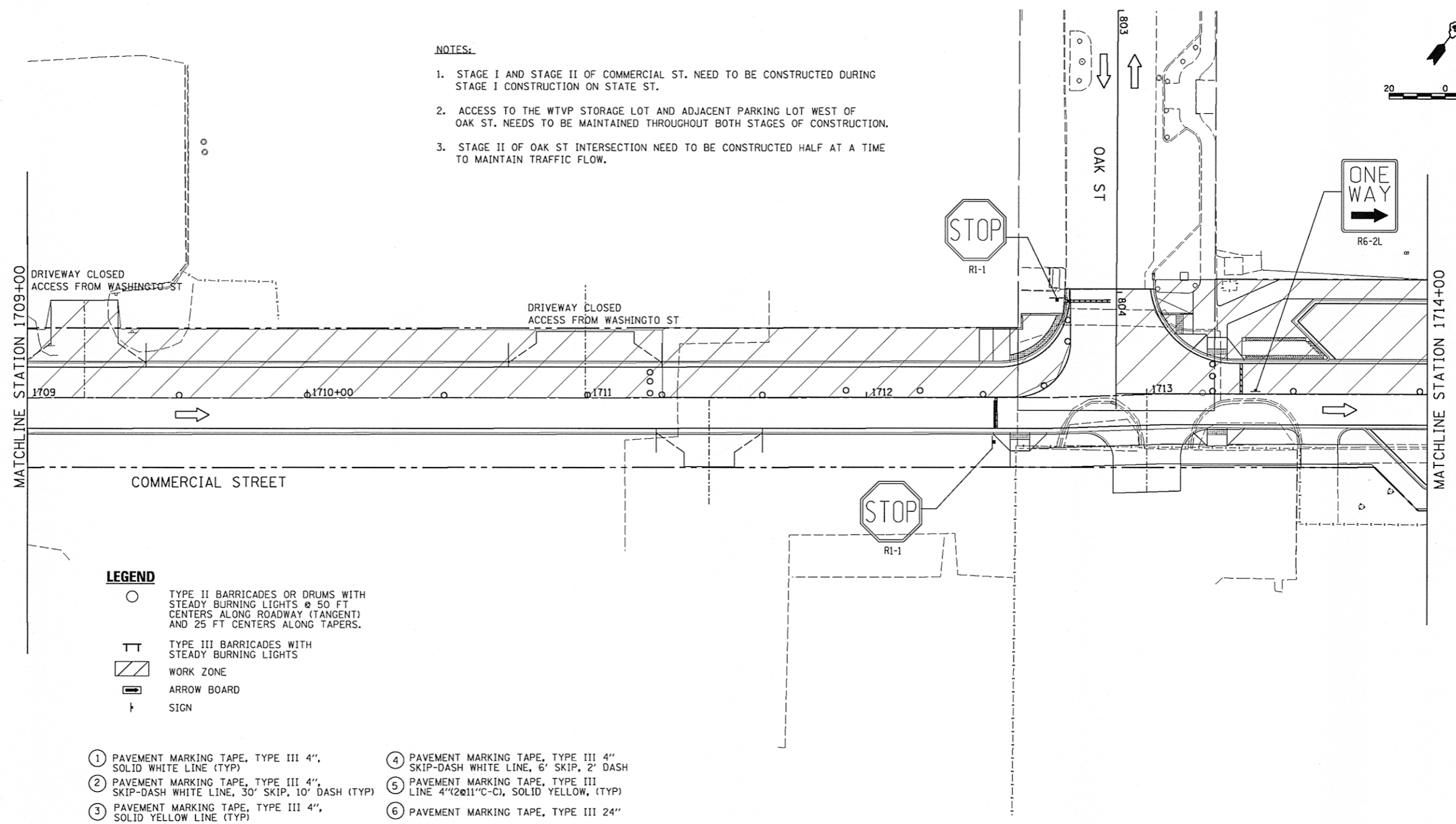

LEGEND

- TYPE II BARRICADES OR DRUMS WITH STEADY BURNING LIGHTS @ 50 FT CENTERS ALONG ROADWAY (TANGENT) AND 25 FT CENTERS ALONG TAPERS.
- ⊥ TYPE III BARRICADES WITH STEADY BURNING LIGHTS
- ▨ WORK ZONE
- ➡ ARROW BOARD
- ⊥ SIGN

- ① PAVEMENT MARKING TAPE, TYPE III 4", SOLID WHITE LINE (TYP)
- ② PAVEMENT MARKING TAPE, TYPE III 4", SKIP-DASH WHITE LINE, 30' SKIP, 10' DASH (TYP)
- ③ PAVEMENT MARKING TAPE, TYPE III 4", SOLID YELLOW LINE (TYP)
- ④ PAVEMENT MARKING TAPE, TYPE III 4", SKIP-DASH WHITE LINE, 6' SKIP, 2' DASH
- ⑤ PAVEMENT MARKING TAPE, TYPE III LINE 4"(2@11"C-C), SOLID YELLOW, (TYP)
- ⑥ PAVEMENT MARKING TAPE, TYPE III 24"

850 North Main Street, Morton, IL 61550
 309.321.8141 voice, 309.321.8142 fax
 www.mps-ll.com

MILLENNIA PROFESSIONAL SERVICES

FILE NAME =	USER NAME = kovan01511	DESIGNED - TVN	REVISED -
al\pwise_work\do_not_delete\dms\98379\04\01\0155-shv-STG215.dgn		DRAWN - TVN	REVISED -
		CHECKED - RPD	REVISED -
		DATE - 7/18/12	REVISED -

**STATE OF ILLINOIS
 DEPARTMENT OF TRANSPORTATION**

**COMMERCIAL STREET - STAGE II
 SUGGESTED STAGES OF CONSTRUCTION & TRAFFIC CONTROL PLAN
 STAGE- II**

SCALE: 1"=20' SHEET NO. OF SHEETS STA. 1709+00 TO STA. 1714+00

F.A.U. RTE.	SECTION	COUNTY	TOTAL SHEETS	SHEET NO.
663	12-00356-01-PV	PEORIA	519	188
CONTRACT NO. 89626			ILLINOIS FED. AID PROJECT TIG-5093158	

STG215