

BORN PAINT

MATCHLINE STA. 1714 + 00.00

MATCHLINE STA. 1716 + 70.23

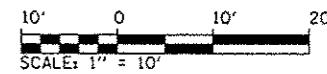
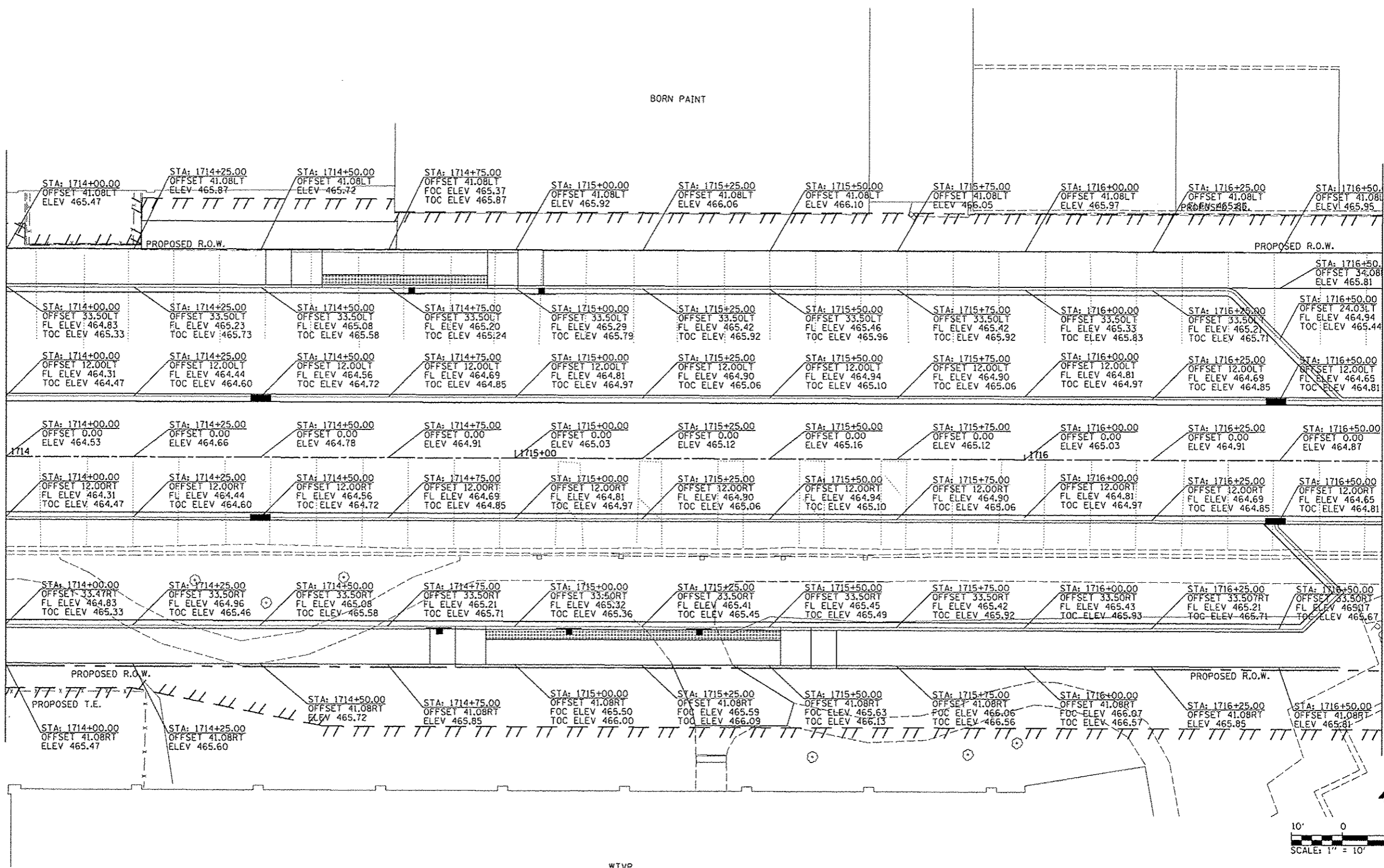

NOTE: SEE SIDEWALK RAMP DETAILS FOR ADDITIONAL SPOT GRADES



FILE NAME * or\piso_work\do_not_delete\des75322\04	USER NAME * kovan0101 010159-shr-elev-384.dgn	DESIGNED - MCH	REVISED -	STATE OF ILLINOIS DEPARTMENT OF TRANSPORTATION	COMMERCIAL STREET GRADING PLANS			F.A.U. RTE. 213	SECTION 12-00356-01-PV	COUNTY PEORIA	TOTAL SHEETS 519	SHEET NO. 135
PLOT SCALE * 20,0000' / 1"	CHECKED - JES	REVISOR -	REVISOR -		SCALE: 1"=10'	SHEET NO. OF SHEETS	STA. 1714+00 TO STA. 1716+70.23	CONTRACT NO. 89626		[ILLINOIS] FED. AID PROJECT TIG-50934581		
PLOT DATE * 07/23/2012	DATE - 7/18/12	REVISOR -	REVISOR -									