

SEE SIDEWALK RAMP
DETAILS FOR GRADING
BEHIND THE CURB

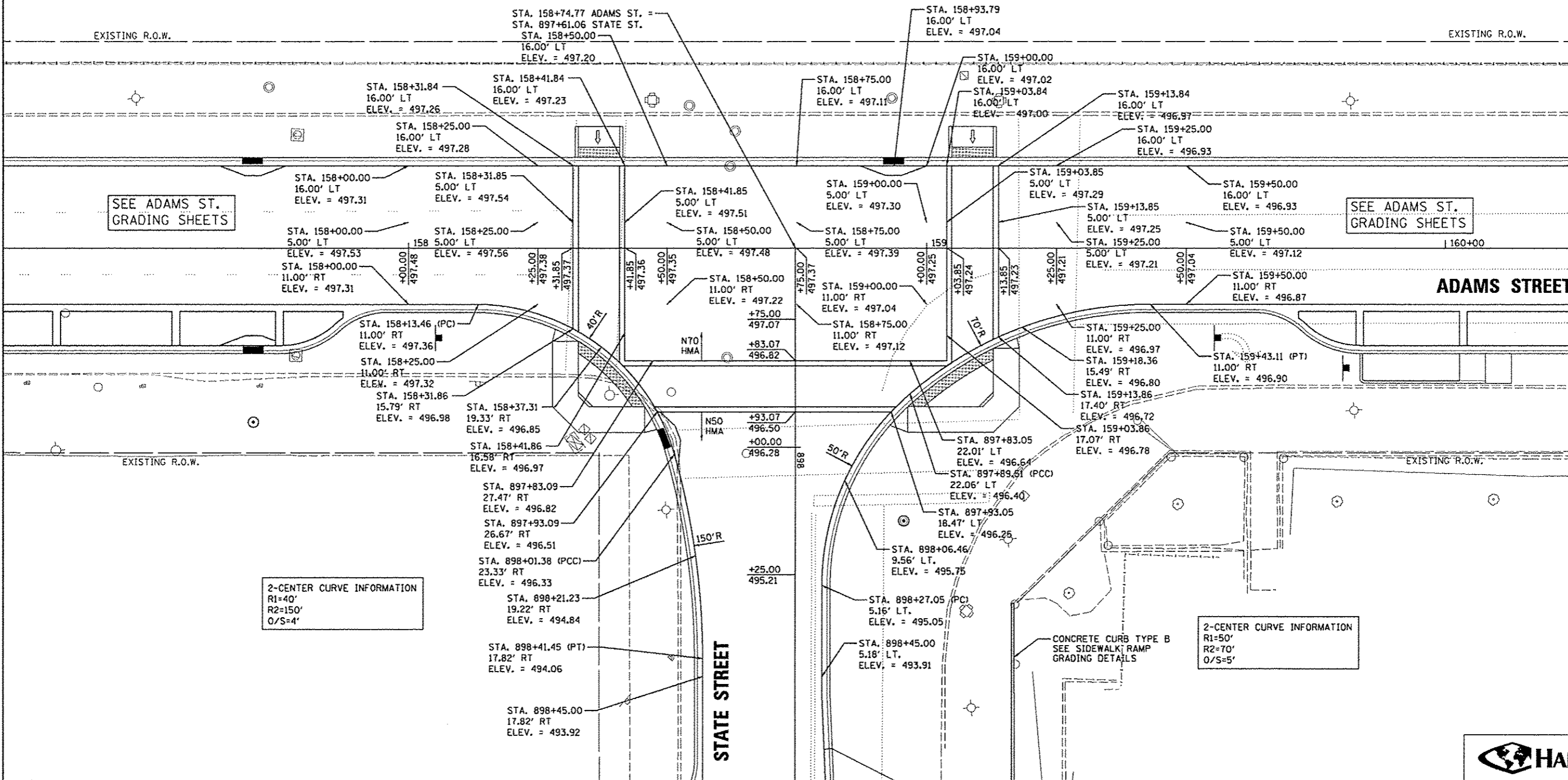
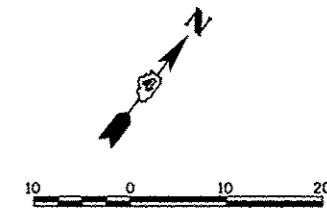

SEE ADAMS ST.
GRADING SHEETS

SEE ADAMS ST.
GRADING SHEETS

2-CENTER CURVE INFORMATION
R1=40'
R2=150'
O/S=4'

2-CENTER CURVE INFORMATION
R1=50'
R2=70'
O/S=5'

CONCRETE CURB TYPE B
SEE SIDEWALK RAMP
GRADING DETAILS

FILE NAME =	USER NAME = mans01310	DESIGNED - MPB	REVISED -
a:\pwise_work\do_no_delata\dms73308\04\BL0155-ah-intersec014.dgn		DRAWN - RLA	REVISED -
		CHECKED - KNB	REVISED -
		DATE - 7/18/12	REVISED -

**STATE OF ILLINOIS
DEPARTMENT OF TRANSPORTATION**

**ADAMS STREET AND STATE STREET
INTERSECTION DETAIL**

SCALE: 1"=10' SHEET NO. OF SHEETS STA. TO STA.

F.A.U. RTE.	SECTION	COUNTY	TOTAL SHEETS	SHEET NO.
	12-00356-01-PV	PEORIA	519	112
ILLINOIS FED. AID PROJECT			CONTRACT NO. 89626	
TIG-50931581				

