

SEE SIDEWALK RAMP
DETAILS FOR GRADING
BEHIND THE CURB

SEE ADAMS ST.
GRADING SHEETS

SEE ADAMS ST.
GRADING SHEETS

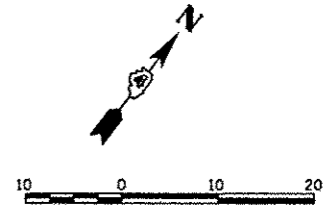

2-CENTER CURVE INFORMATION
R1 = 30'
R2 = 200'
O/S = 2'

2-CENTER CURVE INFORMATION
R1 = 30'
R2 = 150'
O/S = 3'

CONCRETE CURB TYPE B
SEE SIDEWALK RAMP
GRADING DETAILS AND SIDE
STREET TYPICAL SECTIONS

STA. 698+00.00
10.07' RT
ELEV. = 598.96

STA. 698+04.51 (PT)
10.00' RT
ELEV. = 498.75

STA. 698+10.00
10.00' RT
ELEV. = 498.49

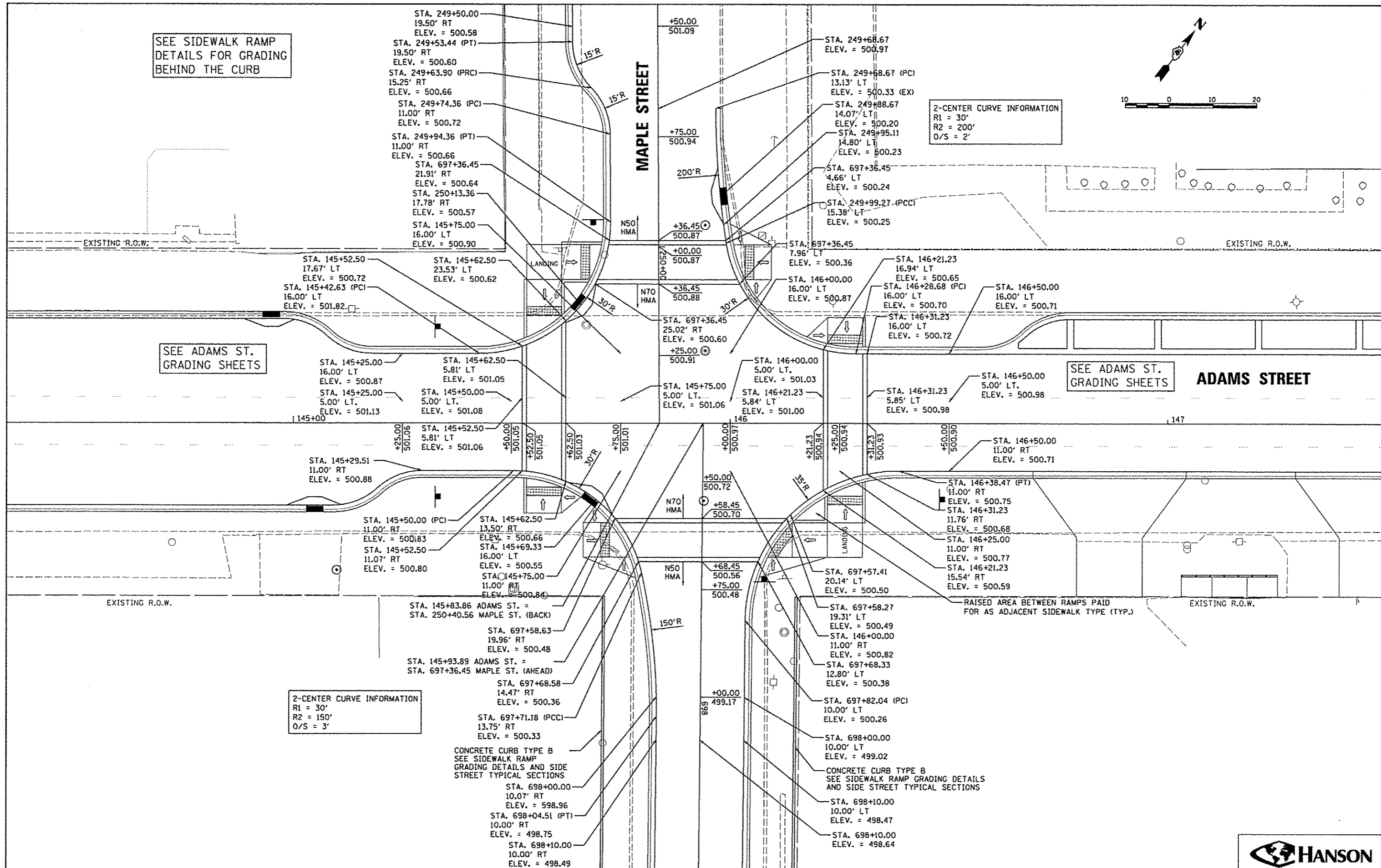

FILE NAME *	USER NAME = monk01290	DESIGNED = MPB	REVISED =
ca:\pwise_work\do_not_delete\dms73280\042\8155\ht-inters0811.dgn		DRAWN = RLA	REVISED =
		CHECKED = KNB	REVISED =
		DATE = 7/18/12	REVISED =

PLT SCALE = 20,000 / 1" = 100'	
PLT DATE = 07/23/2012	

STATE OF ILLINOIS
DEPARTMENT OF TRANSPORTATION

ADAMS STREET AND MAPLE STREET INTERSECTION DETAIL	
SCALE: 1"=10'	SHEET NO. OF SHEETS STA. TO STA.

F.A.U. RTE.	SECTION	COUNTY	TOTAL SHEETS	SHEET NO.
	12-00356-01-PV	PEORIA	519	109
ILLINOIS FED. AID PROJECT			CONTRACT NO. 89626	
TIC-3033(158)				

