

SEE JEFFERSON AVENUE  
PAVEMENT MARKING PLAN

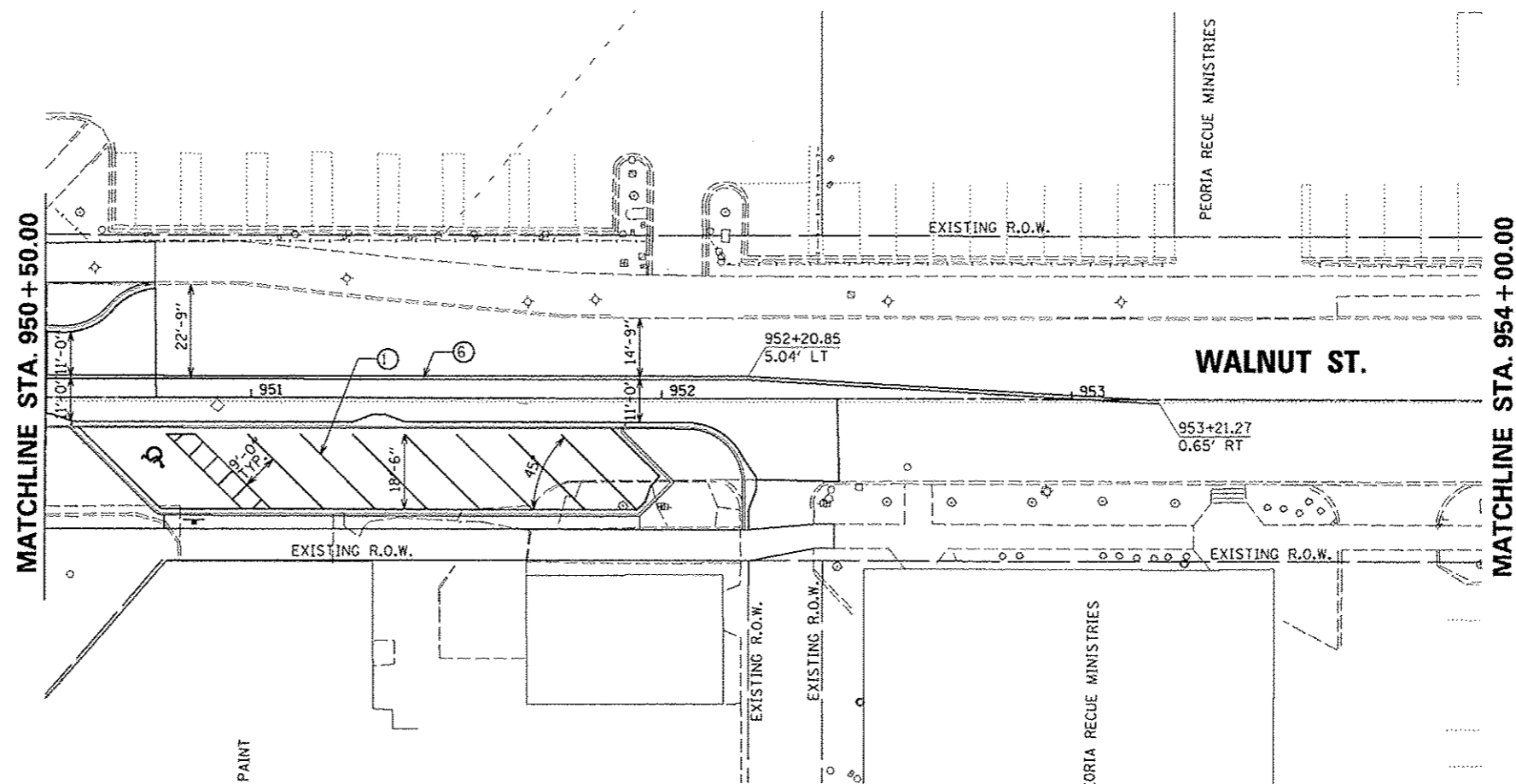

SEE ADAMS STREET  
PAVEMENT MARKING PLAN

- ① WHITE THERMOPLASTIC PAVEMENT MARKING LINE - 8" SOLID
- ② WHITE PREFORMED THERMOPLASTIC PAVEMENT MARKING LINE - 8" SOLID
- ③ WHITE THERMOPLASTIC PAVEMENT MARKING LINE - 12" (ON 45° ANGLE, 20' CTC)
- ④ PREFORMED THERMOPLASTIC PAVEMENT MARKING, LETTERS (6' HEIGHT) AND SYMBOLS (FOR LEFT AND RIGHT TURN LANE ONE ARROW 20' FROM FRONT OF STORAGE AND ONE ARROW 20' AT BACK OF STORAGE)
- ⑤ WHITE THERMOPLASTIC PAVEMENT MARKING LINE - 8" (2' LONG, 6' GAP)
- ⑥ DOUBLE YELLOW THERMOPLASTIC PAVEMENT MARKING LINE - 4" SOLID, 4" GAP
- ⑦ WHITE PREFORMED PLASTIC PAVEMENT MARKING, TYPE B - INLAID - 10' LONG, 30' GAP - 4"
- ⑧ WHITE THERMOPLASTIC PAVEMENT MARKING LINE - 10' LONG, 30' GAP - 4"
- ⑨ WHITE PREFORMED THERMOPLASTIC STOP BAR PAVEMENT MARKING LINE - 24" SOLID

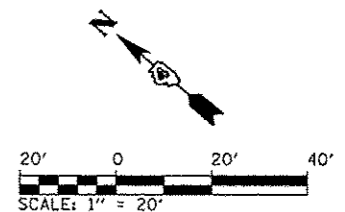

FILE NAME =	USER NAME = manak01010	DESIGNED - JES	REVISED -	<b>STATE OF ILLINOIS DEPARTMENT OF TRANSPORTATION</b>	<b>WALNUT STREET PAVEMENT MARKING PLANS</b>				F.A.U. RTE.	SECTION	COUNTY	TOTAL SHEETS	SHEET NO.	
o:\pwise_work\do_not_delete\dms75322\DA	010159-strt-pmk-301.dgn	DRAWN - LNF	REVISED -		SCALE: 1"=20'	SHEET NO.	OF	SHEETS	STA. 950+00	TO STA. 954+00	12-00356-01-PV	PEORIA	519	107
	PLOT SCALE = 39.49999 1/1 in.	CHECKED - MCH	REVISED -											
	PLOT DATE = 07/23/2012	DATE - 7/18/12	REVISED -											
CONTRACT NO. 089626														
ILLINOIS FED. AID PROJECT T10-69331581														