

DATE	5/11/12
BY	BT
PROJECT	CONTRACT NO. 0559
NO. 1 BOOK	ALIGNMENT CHECKED
NO. 2 BOOK	GRADES CHECKED
NO. 3 BOOK	PLAN CHECKED
NO. 4 BOOK	AS-BUILT
NO. 5 BOOK	CONTRACT ADMINISTRATION

DATE	5/11/12
BY	BT
PROJECT	CONTRACT NO. 0559
NO. 1 BOOK	ALIGNMENT CHECKED
NO. 2 BOOK	GRADES CHECKED
NO. 3 BOOK	PLAN CHECKED
NO. 4 BOOK	AS-BUILT
NO. 5 BOOK	CONTRACT ADMINISTRATION

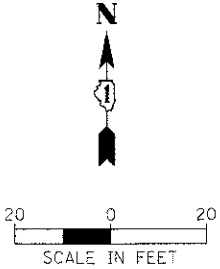
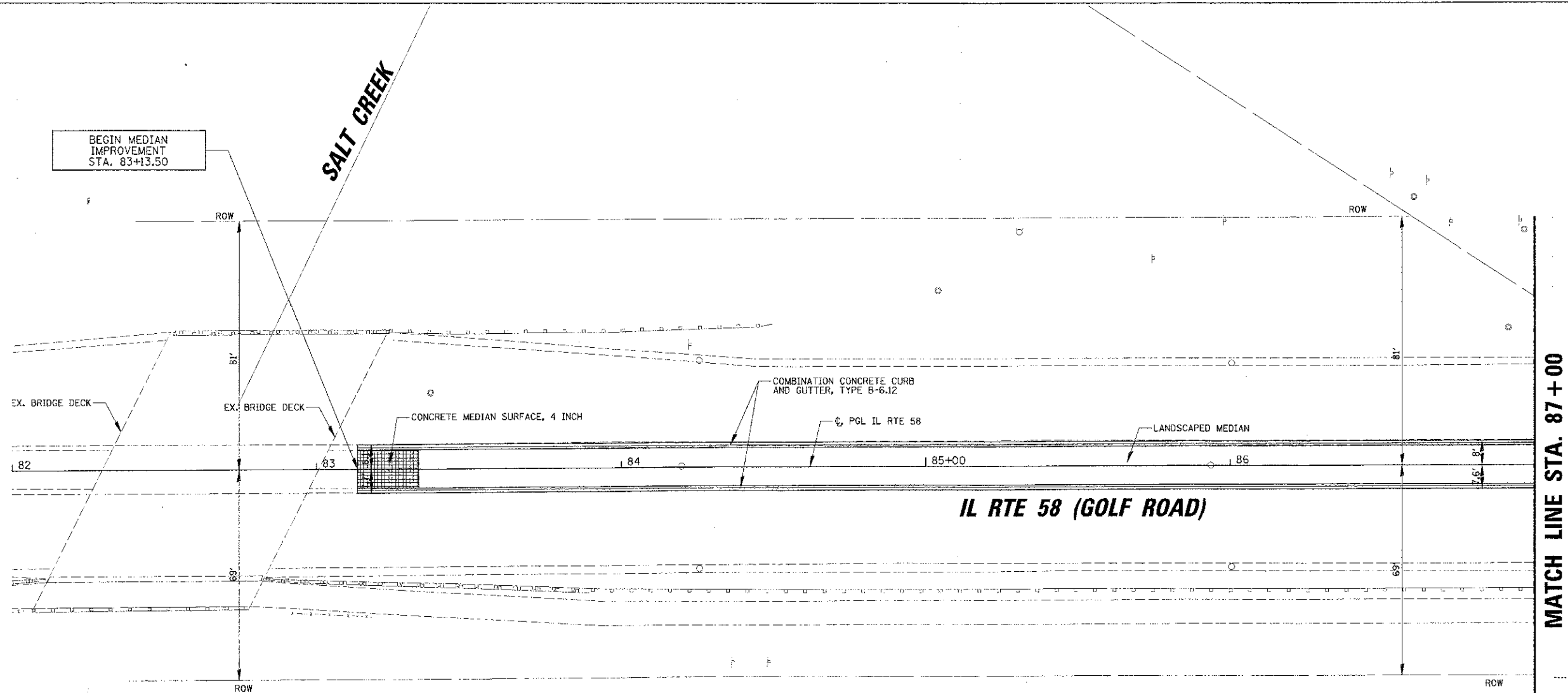

MATCH LINE STA. 87+00

REVERSE-PITCHED CURB & GUTTER TABLE

EB/WB	STA	OFFSET	STA	OFFSET
EB	83+13	7.7' RT	88+98	7.6' RT
WB	83+13	8.1' LT	88+98	8.0' RT

- LEGEND**
- PR CONSTRUCTION LIMITS
 - PROFILE GRADE LINE
 - EXISTING ROW
 - PROPOSED ROW
 - ||||| TEMPORARY EASEMENT
 - [Cross-hatched] PCC BASE CRSE W/O PAVEMENT OVERLAY
 - [Diagonal lines] PAVEMENT OVERLAY
 - [Dashed] SIDEWALK RAMPS
 - [Dotted] DETECTABLE WARNINGS
 - [Solid] DEPRESSED CURB

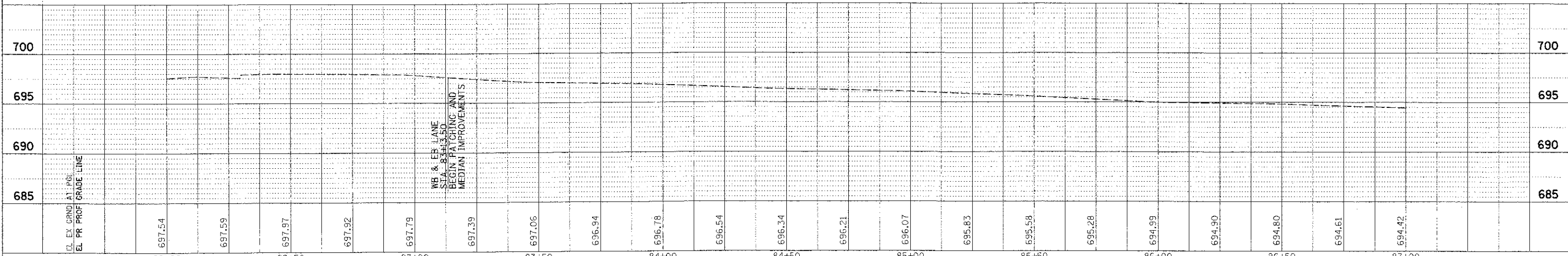

FILE NAME =	USER NAME = inverdu-or	DESIGNED - B.L.L.	REVISED -	STATE OF ILLINOIS DEPARTMENT OF TRANSPORTATION	IL RTE 58 (GOLF ROAD) AND NEW WILKE ROAD IMPROVEMENTS PROPOSED ROADWAY AND PROFILE IL RTE 58 (GOLF ROAD)			F.A.P. RTE. 0559	SECTION 00-00078-00-CH	COUNTY COOK	TOTAL SHEETS 116	SHEET NO. 25
SCALE: 20H, 5V	PLOT SCALE = 2"	DRAWN - PMM	REVISED -		SCALE: 20H, 5V	SHEET NO. 1 OF 10 SHEETS	STA. 83+13.5 TO STA. 87+00	CONTRACT NO. 83735				
DATE = 8/06/12	PLCT DATE = 8/30/2012	CHECKED - JGS	REVISED -		FED. ROAD DIST. NO. ILLINOIS FED. AID PROJECT							
		DATE = 8/06/12	REVISED -									