

ALIGNMENT POINTS				
STATION	OFFSET	NORTHING (Y)	EASTING (X)	DESCRIPTION
80+00.00	C	1,961,479.22	1,072,009.57	POT
102+88.34	C	1,961,544.81	1,074,296.96	PC
496+00.00	C	1,961,136.57	1,074,010.98	POT
500+00.00	C	1,961,536.56	1,074,009.43	POT
500+00.00	C	1,961,536.54	1,074,008.74	POT
516+93.09	C	1,963,229.62	1,074,004.39	POT
200+00.00	C	1,961,554.59	1,075,308.39	POT
204+90.04	C	1,961,105.75	1,075,341.03	POT

CONTROL POINTS					
STATION	OFFSET	NORTHING (Y)	EASTING (X)	DESCRIPTION	
6913	80+44.64	37.47 RT	1,961,443.05	1,072,055.26	CP-IP
6912	86+37.00	0.71 LT	1,961,498.18	1,072,646.28	CP-PK
224	100+69.80	47.35 RT	1,961,491.21	1,074,079.88	CP
4009	501+64.26	41.55 RT	1,961,700.91	1,074,049.87	CP-IP

ELEVATION BENCHMARKS			
DATUM: NGVD OF 1929			
NO.	DESCRIPTION	ELEV.	
BM3	S.W. BOLT HYD. ON N.W. CORNER OF NEW WILKE RD AND CHATEAU DR. (AUTUMN CHASE) ON WEST R.O.W. OPPOSITE KFC #5540 NEW WILKE RD.	696.85	
	STA. 913+44, 33.5' RT		

PGL POINTS - LEFT					
STATION	OFFSET	NORTHING (Y)	EASTING (X)	DESCRIPTION	
L1	91+00.00	C	1,961,518.74	1,073,108.88	POT
L2	93+79.99	C	1,961,533.76	1,073,388.47	POT
L3	101+00.08	C	1,961,554.40	1,074,108.26	POT
L4	102+88.43	C	1,961,559.27	1,074,646.85	PC

PGL POINTS - RIGHT					
STATION	OFFSET	NORTHING (Y)	EASTING (X)	DESCRIPTION	
R1	91+00.00	C	1,961,503.07	1,073,109.33	POT
R2	91+33.26	C	1,961,503.70	1,073,142.59	POT
R3	92+32.78	C	1,961,506.55	1,073,242.07	POT
R4	93+22.82	C	1,961,506.88	1,073,332.10	POT
R5	95+12.89	C	1,961,507.58	1,073,522.17	POT
R6	102+88.76	C	1,961,529.82	1,074,297.72	POT

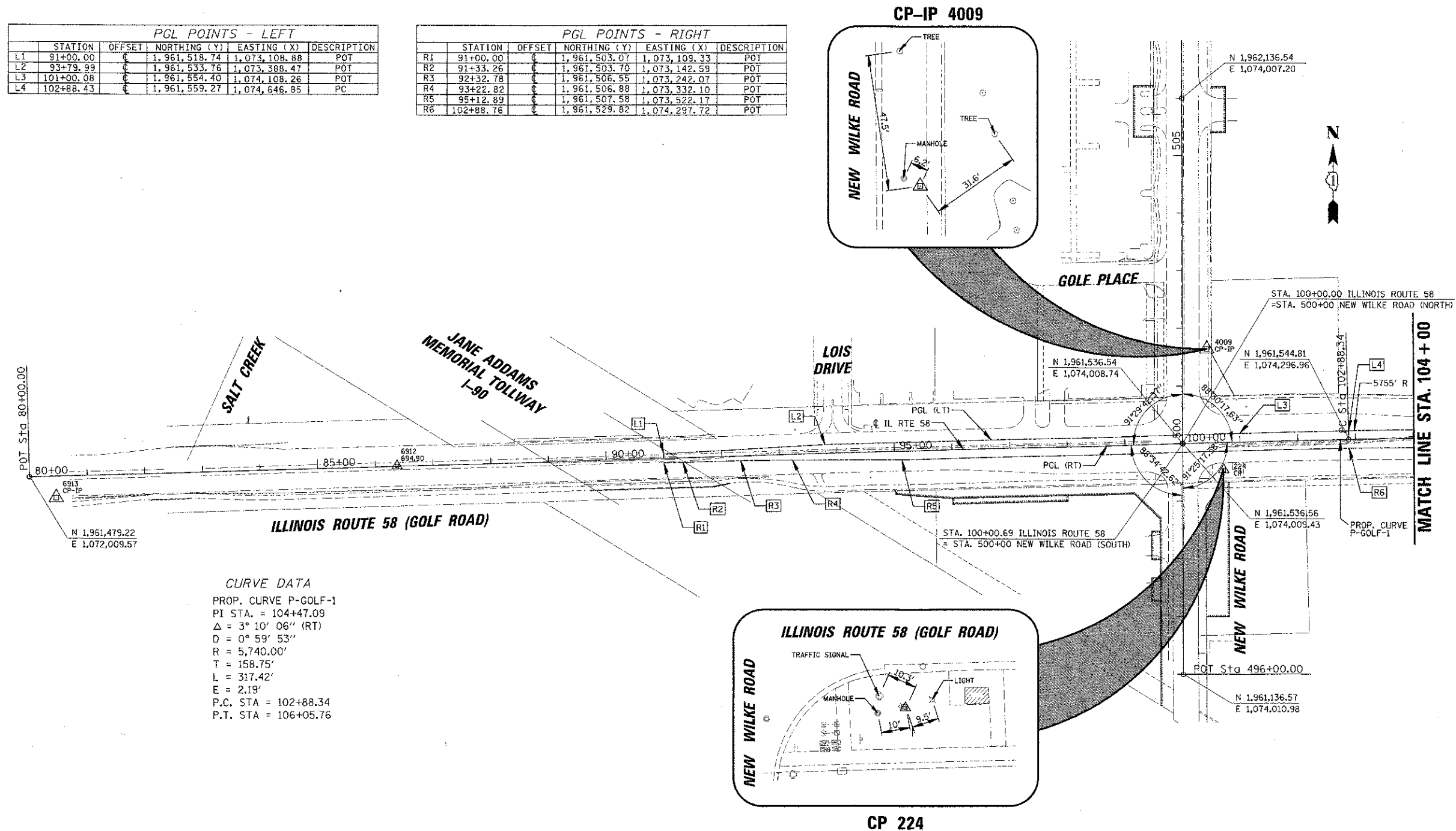

CURVE DATA
 PROP. CURVE P-GOLF-1
 PI STA. = 104+47.09
 $\Delta = 3^{\circ} 10' 06''$ (RT)
 $D = 0^{\circ} 59' 53''$
 $R = 5,740.00'$
 $T = 158.75'$
 $L = 317.42'$
 $E = 2.19'$
 P.C. STA = 102+88.34
 P.T. STA = 106+05.76