

DATE	
BY	
FINAL SURVEY	
NOTE BOOK	
NO.	

DATE	
BY	
ORIGINAL SURVEY	
NOTE BOOK	
NO.	

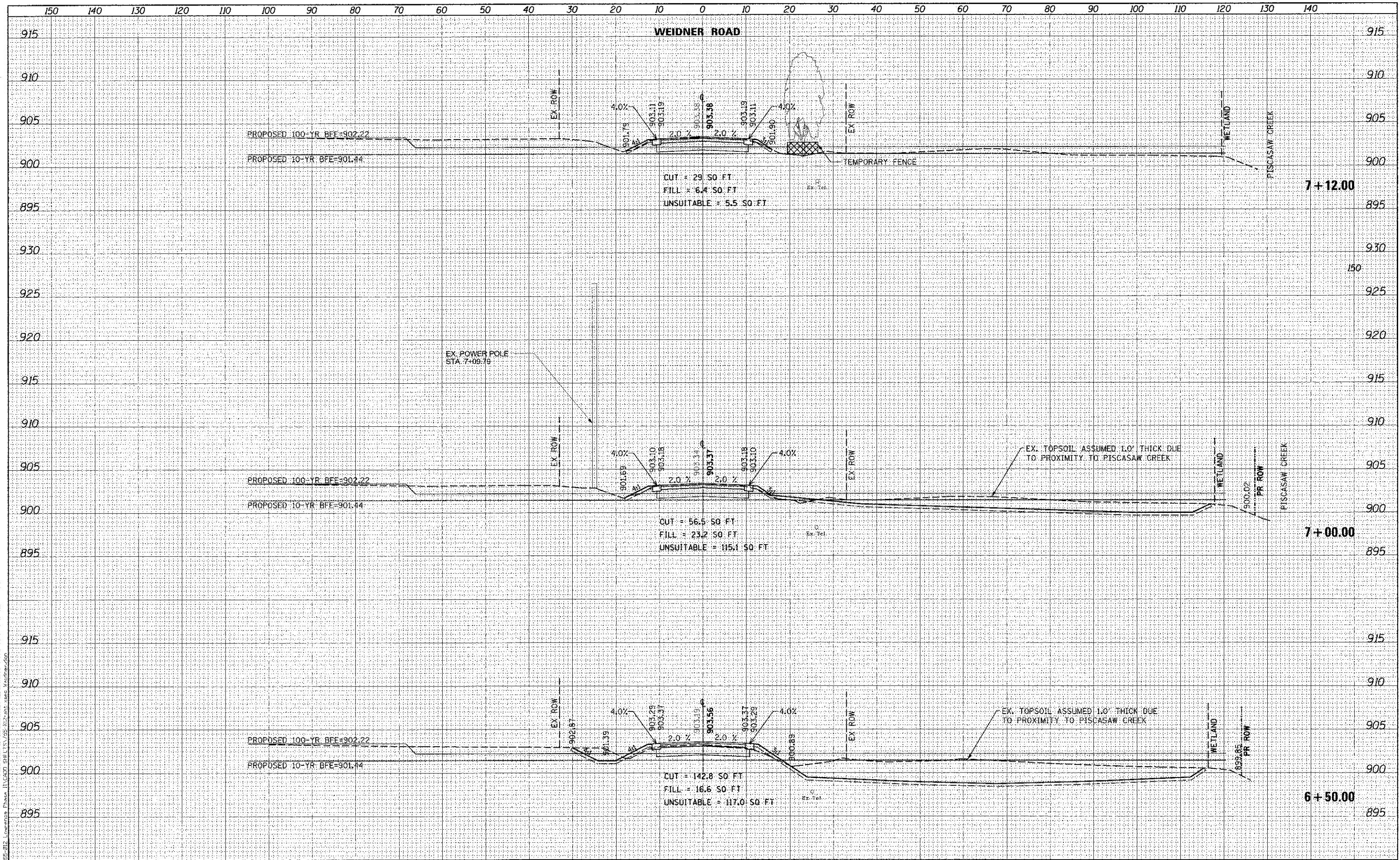

Bollinger, Lach & Associates, Inc.
ITASCA, ILLINOIS

USER NAME = gellinger	DESIGNED - GJE	REVISED -
PLOT SCALE = 18.0000 "/>		

DRAWN - GJE	REVISED -
CHECKED - CRF	REVISED -
DATE - 08/17/12	REVISED -

MCHENRY COUNTY
DIVISION OF TRANSPORTATION

LAWRENCE ROAD BRIDGE OVER PISCASAW CREEK
WEIDNER ROAD CROSS SECTION

1"=5' VT
SCALE: 1"=10' HZ

SHEET NO. 87 OF 87 SHEETS | STA. 6+50.00 TO STA. 7+12.00

F.A.S. RTE. 0028	SECTION 08-00355-01-BR	COUNTY	TOTAL SHEETS 87	SHEET NO. 87
CONTRACT NO. 63694			ILLINOIS FED. AID PROJECT	