

Notes:  
 See Sheet 14 of 33 for Sections C-C and D-D.  
 $a_1(E)$ ,  $a_1(E)$ ,  $a_7(E)$  and  $a_8(E)$  bar spacings measured along  $\text{C.R.}$   
 See Sheets 16 & 33 of 33 for connection details to bridge rail  
 for Impact Attenuators.

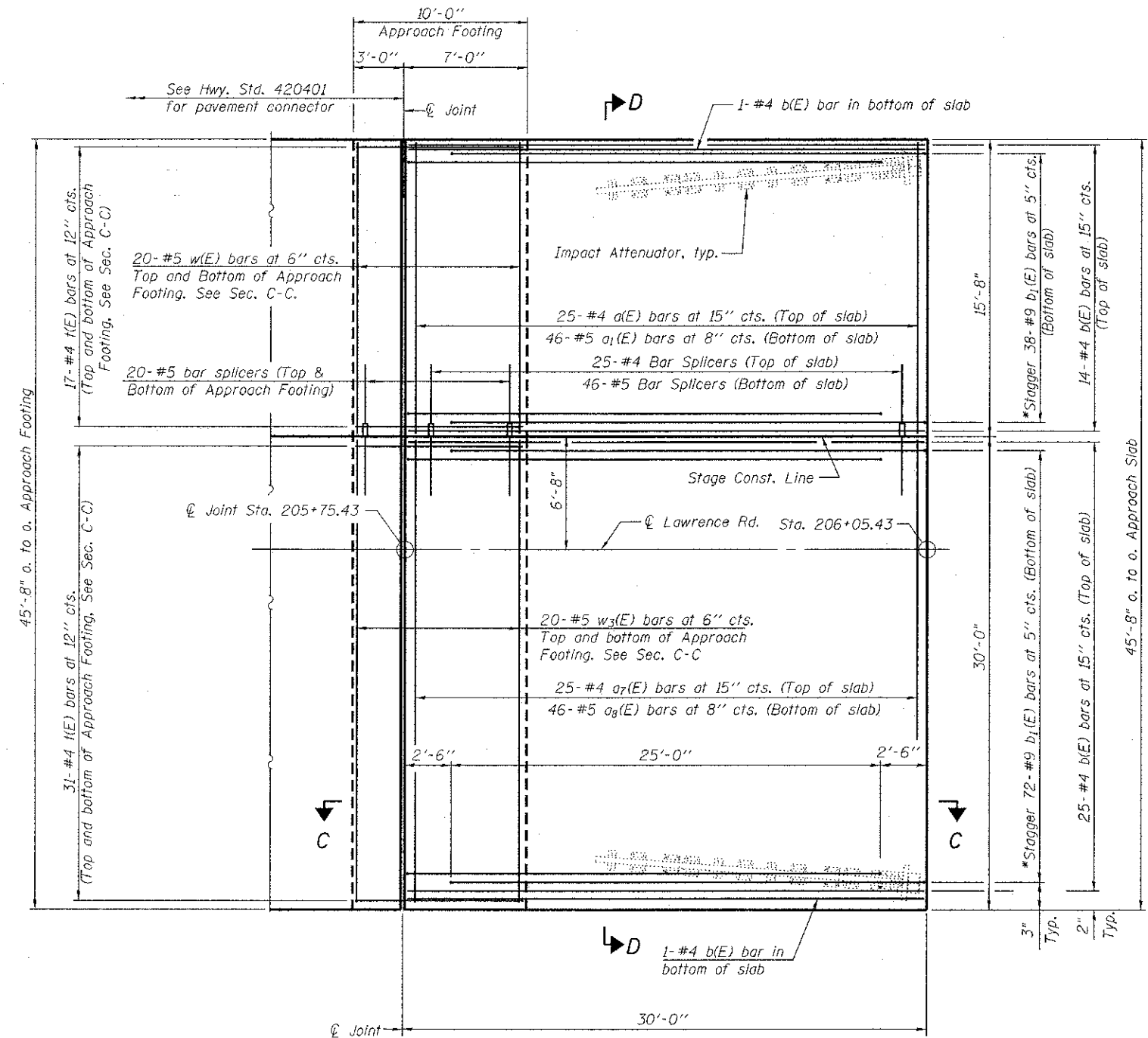

PLAN

\* Tilt #9 b<sub>1</sub>(E) bars as required to maintain clearance.

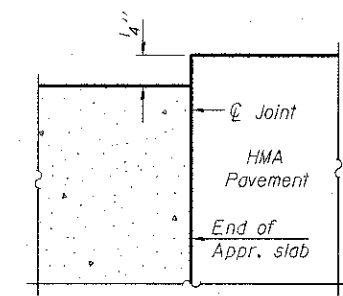

FLEXIBLE PAVEMENT  
 DETAIL A

FILE NAME: s:\1755-012 Lawrence phase 1\cadd sheets\structural\06162014-08-01.dwg

<b>Bollinger, Lach &amp; Associates, Inc.</b> ITASCA, ILLINOIS	USER NAME = gonzo	DESIGNED JMT	REVISED -	<b>McHENRY COUNTY</b> <b>DIVISION OF TRANSPORTATION</b> <b>LAWRENCE ROAD BRIDGE OVER PISCASAW CREEK</b>	<b>WEST BRIDGE APPROACH SLAB DETAILS</b> <b>STRUCTURE NO. 056-3184</b>	F.A.S. RTE.	SECTION	COUNTY	TOTAL SHEETS	SHEET NO.
	PLOT SCALE =	CHECKED JJI	REVISED -			0028	08-00355-01-BR	McHENRY	87	44
	PLOT DATE = 8/16/2012	DRAWN GM	REVISED -			CONTRACT NO. 63694				
		CHECKED JJI	REVISED -			ILLINOIS FED. AID PROJECT				

(Sheet 1 of 3)

SHEET NO. 12 OF 33 SHEETS