

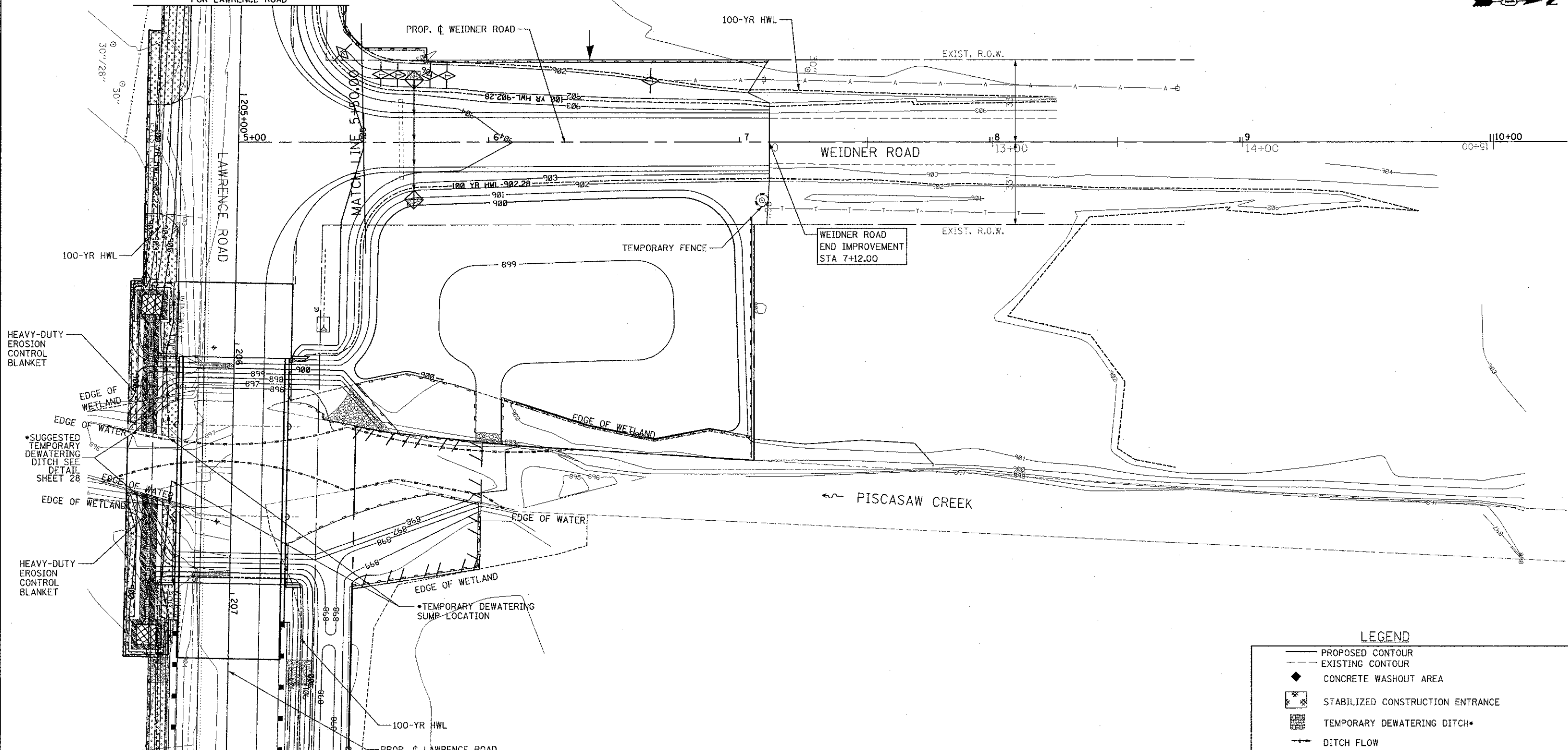

SEE SHEET 26
FOR LAWRENCE ROAD



SEE SHEET 26
FOR LAWRENCE ROAD

GENERAL NOTES:

- ALL DISTURBED AREAS AND WORK AREAS MUST BE ISOLATED FROM CHANNEL FLOWS AT ALL TIMES. EXACT MEANS AND METHODS SHOULD BE DISCUSSED DURING A SCHEDULED PRECONSTRUCTION MEETING. THE MLCSWCD MUST BE IN AGREEMENT WITH OVERALL EXACT METHOD OF DIVERSION/ISOLATION PRIOR TO THE COMMENCEMENT OF CONSTRUCTION.
- THE SUGGESTED SITE DEWATERING SHALL ONLY OCCUR TO PROVIDE A DRY CONSTRUCTION AREA IF NECESSARY, AND WILL BE TEMPORARY ONLY. NO ADDITIONAL DEWATERING SHALL BE AUTHORIZED UNLESS SOIL EROSION AND SEDIMENT CONTROL MEASURES ARE APPROVED BY MLCSWCD.
- ALL COMPENSATORY STORAGE SHALL BE OPERATIONAL PRIOR TO PLACEMENT OF FILL, STRUCTURES, OR OTHER MATERIALS IN THE REGULATORY FLOODPLAIN. GRADING SHALL BE DONE IN SUCH A MANNER THAT EXISTING FLOODPLAIN STORAGE IS MAINTAINED AT ALL TIMES.
- MATERIALS & EQUIPMENT, INCLUDING TOPSOIL STOCKPILES, MAY NOT BE STORED WITHIN THE LIMITS OF THE FLOODPLAIN.
- ALL SEDIMENT & EROSION CONTROL MEASURES SHALL BE IN PLACE & VERIFIED BY THE ENGINEER PRIOR TO START OF CONSTRUCTION.
- ALL IN-STREAM WORK, SUCH AS THE REMOVAL OF ACCUMULATED SEDIMENTS, AND DEMOLITION WORK, SUCH AS THE REMOVAL OF EXISTING STRUCTURES, SHALL BE CLEARLY LABELED ON THE CONSTRUCTION DRAWINGS.
- TREE PROTECTION FENCE SHALL BE PAID FOR AS TEMPORARY FENCE. MAXIMUM PAY LIMIT MEASURED AS 8' DIAMETER DRIP LINE FROM CENTER OF TREE OR AS DETERMINED BY ENGINEER. SEE DETAIL SHEET 30.

NOTE: TEMPORARY DITCH CHECKS SHALL BE CONSTRUCTED OF EITHER ROLLED EXCELSIOR OR APPROVED EQUAL, OR AGGREGATE PLACED ON FILTER FABRIC.

LEGEND

- PROPOSED CONTOUR
 - - - EXISTING CONTOUR
 - ◆ CONCRETE WASHOUT AREA
 - ▣ STABILIZED CONSTRUCTION ENTRANCE
 - ▤ TEMPORARY DEWATERING DITCH*
 - DITCH FLOW
 - PERIMETER EROSION BARRIER
 - ▣ TEMPORARY EROSION CONTROL SEEDING
 - ▣ EROSION CONTROL BLANKET
 - ▣ HEAVY-DUTY EROSION CONTROL BLANKET (AS INDICATED)
 - ◇ TEMPORARY DITCH CHECK
 - - - TURBIDITY CURTAIN
 - ◇ INLET AND PIPE PROTECTION
 - TEMPORARY BYPASS PUMP PIPE*
 - ▣ CLASS A4 RIPRAP
 - ▣ SEDIMENT CONTAINMENT FILTER BAG*
- *ITEMS TO BE INCIDENTAL TO DEWATERING

FILE NAME = X:\1755-812-Lawrence Phase II\CAD00_SHEET\1755-812-ph1\eroc02\kx.dwg

Bollinger, Lach & Associates, Inc.
ITASCA, ILLINOIS

USER NAME = gollwanger	DESIGNED - GJE	REVISED -
PLOT SCALE = 20.0000' / 1" =	DRAWN - GJE	REVISED -
PLOT DATE = 8/16/2012	CHECKED - CF	REVISED -
	DATE - 08/17/12	REVISED -

**MCHENRY COUNTY
DIVISION OF TRANSPORTATION**

**LAWRENCE ROAD BRIDGE OVER PISCASAW CREEK
WEIDNER ROAD EROSION AND SEDIMENT CONTROL - STAGE 2**

SCALE: 1"=20' SHEET NO. 27 OF 87 SHEETS STA. TO STA.

F.A.S. RTE.	SECTION	COUNTY	TOTAL SHEETS	SHEET NO.
0028	08-00355-01-BR	MCHENRY	87	27
			CONTRACT NO. 63694	
ILLINOIS FED. AID PROJECT				