

EXIST. CURVE 1  
 PI STA. =121+25.09  
 $\Delta$  =40° 44' 02" (LT)  
 D =6° 58' 26"  
 R =821.57'  
 T =305.00'  
 L =584.09'  
 E =54.79'  
 e = 6.0%  
 T.R. = 75  
 S.E. RUN = 96  
 P.C. STA. =118+20.09  
 P.T. STA. =124+04.18  
 ATTAIN SE STA 116+59.33 TO STA 118+30.33  
 REMOVE SE STA 123+61.94 TO STA 125+32.94

OLDIL1			
CONTROL POINT	STATION	COORDINATES	
		NORTHING	EASTING
P.O.T	107+40.87	649805.06	1146740.97
P.O.T	118+20.09	650716.14	1147319.46
T.C.	118+20.09	650716.14	1147319.46
P.I.	121+25.09	650973.62	1147482.95
C.T.	124+04.18	651275.41	1147438.81
P.O.T	124+04.18	651275.41	1147438.81
P.O.T	130+05.20	651870.10	1147351.83

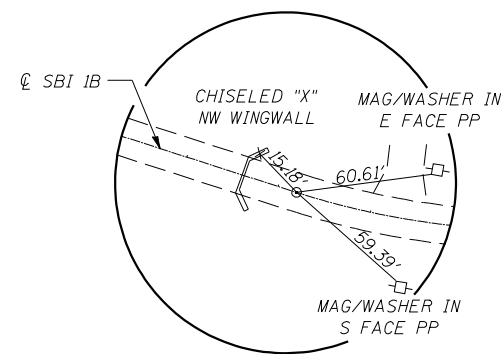

**PC STA 118+20.09**  
**MAG NAIL WITH WASHER**

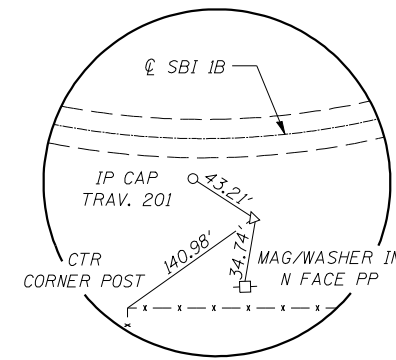

**PI STA 121+25.09**  
**IP WITH CAP**

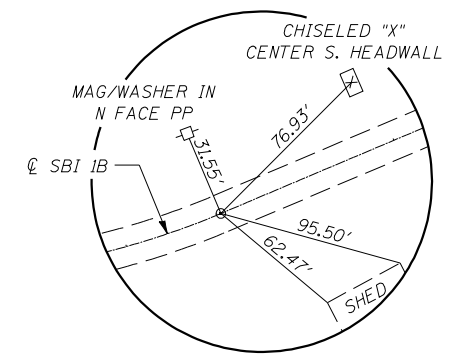

**PT STA 124+04.18**  
**MAG NAIL WITH WASHER**

BENCH MARK: CHISELED SQUARE ON THE NORTHWEST WINGWALL OF CULVERT, STA. 113+11.36, 24.38' RT., ELEV. 401.70