

DATE	
BY	
FINAL SURVEY	
SURVEYED	
PLOTTED	
TEMPLATE	
NOTE BOOK	
AREAS	
CHECKED	
NO.	

DATE	
BY	
ORIGINAL SURVEY	
SURVEYED	
PLOTTED	
TEMPLATE	
NOTE BOOK	
AREAS	
CHECKED	
NO.	

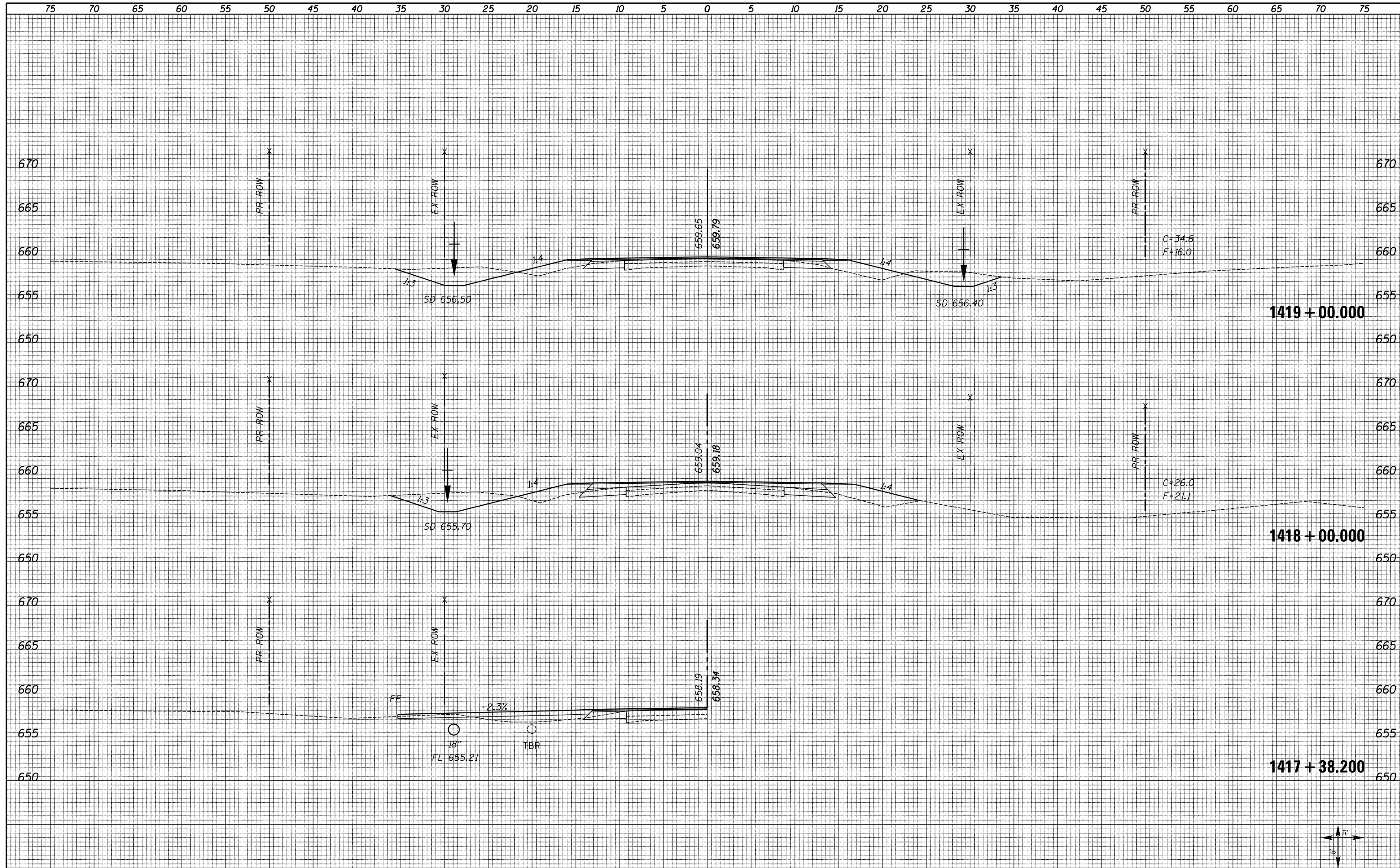

FILE NAME = XS_SHEETS-NEW.dgn	USER NAME = notel	DESIGNED -	REVISÉ -	STATE OF ILLINOIS DEPARTMENT OF TRANSPORTATION	FAS 1597 (IL 96) CROSS SECTIONS		F.A.S. RTE. 1597	SECTION 14 (W, RS-7)	COUNTY ADAMS/PIKE	TOTAL SHEETS 152	SHEET NO. 139	
	PLOT SCALE = 10.0000' / in.	CHECKED -	REVISÉ -		SCALE: SHOWN	SHEET NO. 64 OF 72 SHEETS	STA. 1417+38.200	STA. 1419+00.000	CONTRACT NO. 72781			
	PLOT DATE = 8/16/2013	DATE -	REVISÉ -		ILLINOIS FED. AID PROJECT							