

F.A.U. RTE.	SECTION	COUNTY	TOTAL SHEETS	SHEET NO.
668	28R-1	SANGAMON	354	275
STA. 6+437.500 TO STA. 6+437.500				
FED. ROAD DIST. NO. 6		ILLINOIS	FED. AID PROJECT	
CONTRACT NO. 72501				

FINAL SURVEY	DATE
SURVEYED	
NOTED	
AREAS	
CHECKED	
NO.	

ORIGINAL SURVEY	DATE
SURVEYED	
NOTED	
AREAS	
CHECKED	
NO.	

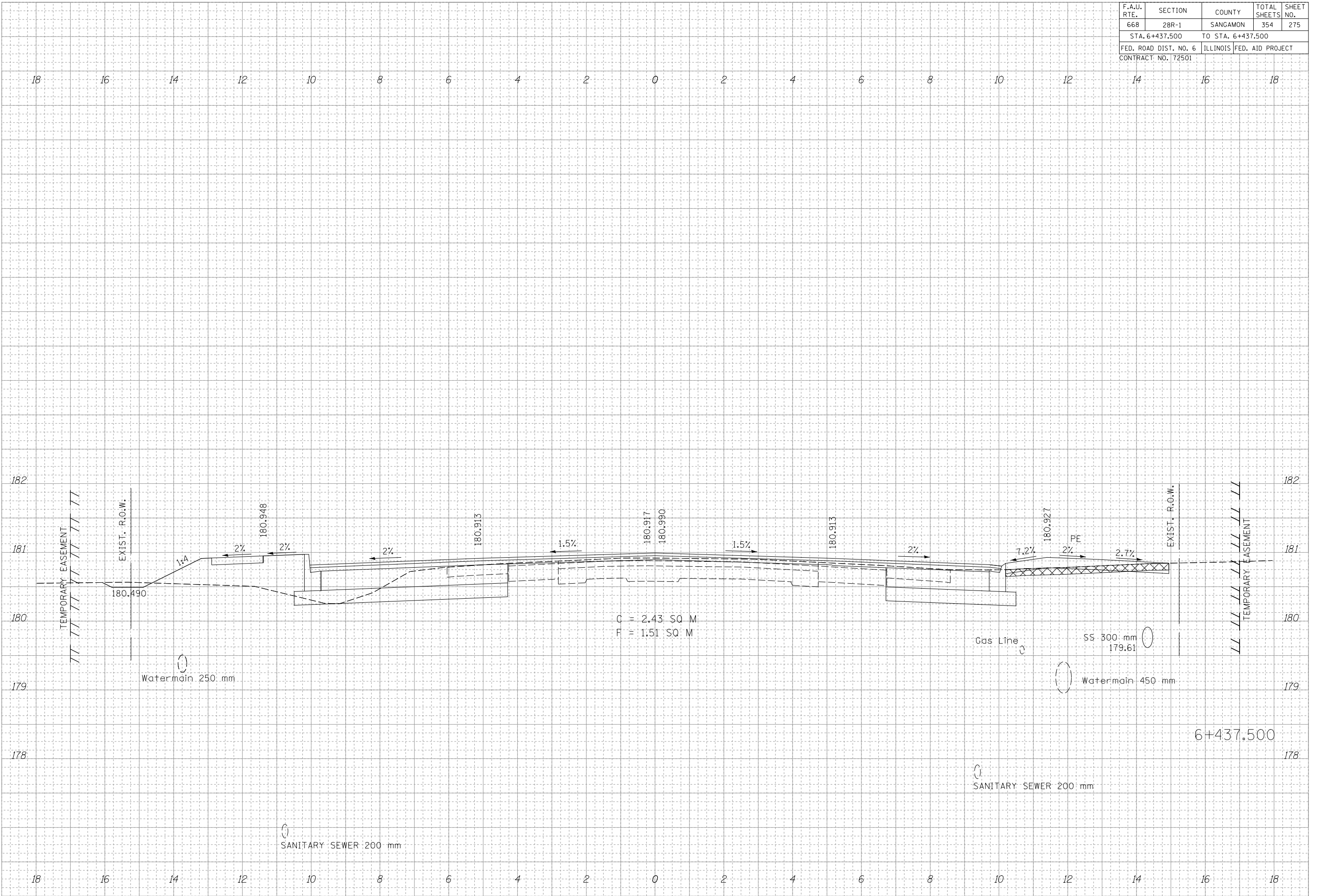

$C = 2.43 \text{ SQ M}$
 $F = 1.51 \text{ SQ M}$