

F.A.P. RTE.	SECTION	COUNTY	TOTAL SHEETS	SHEET NO.
668	28R-1	SANGAMON	354	110
STA. 6+437.5		TO STA. 6+562		
FED. ROAD DIST. NO.		ILLINOIS	FED. AID PROJECT	
CONTRACT NO. 72501				

FINAL SURVEY NO.	DATE
SURVEYED	BY
PLOTTED	
NOTE BOOK	
TEMPLATE	
AREAS	
CHECKED	

MATCH LINE STA. 6+615.0
SEE SHEET 109

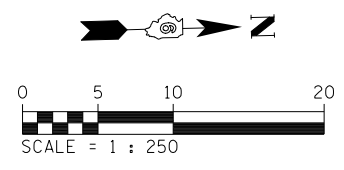
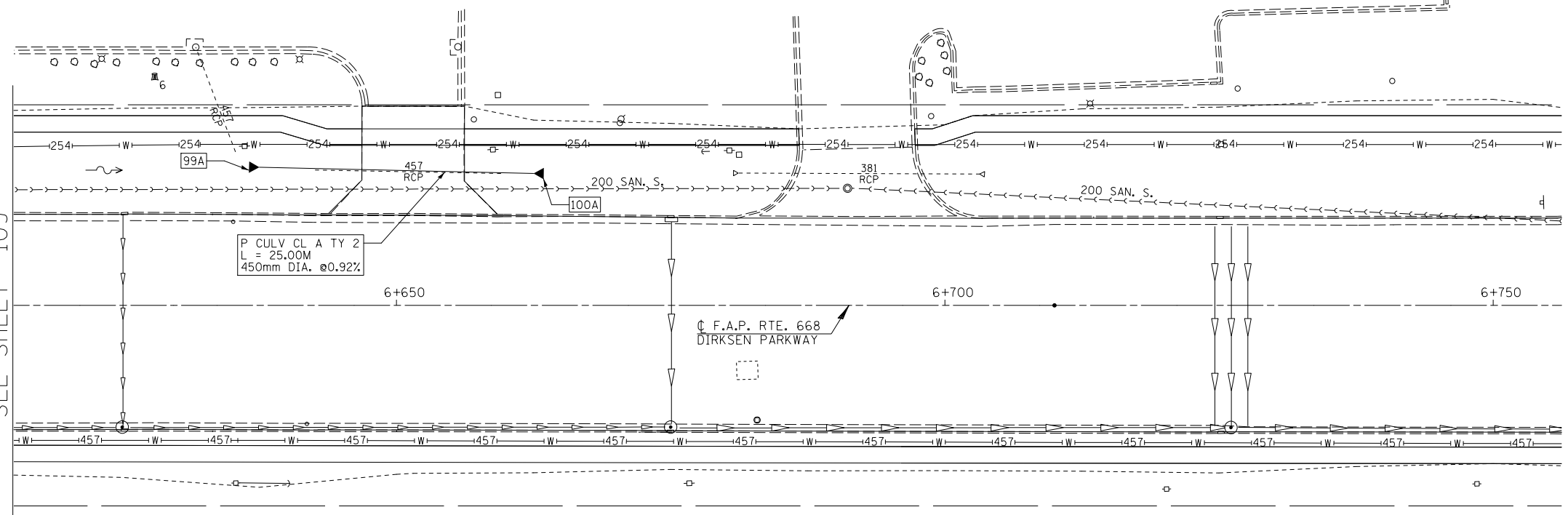

99A STA. 6+637.50; 12.58m LT. PRC FLARED END SECTION 450mm DIA. INV. EL.=178.67 N

100A STA. 6+662.50; 12.03m LT. PRC FLARED END SECTION 450mm DIA. INV. EL.=178.44 S

ILLINOIS DEPARTMENT OF TRANSPORTATION
DRAINAGE PLANS
DIRKSEN PARKWAY - LT
STA. 6+437.5 TO STA. 6+562
DRAWN BY: GE
DATE: 06/2013
CHECKED BY: FML

ORIGINAL SURVEY NO.	DATE
SURVEYED	BY
PLOTTED	
NOTE BOOK	
TEMPLATE	
AREAS	
CHECKED	

