

**PARTIAL FRAMING PLAN**

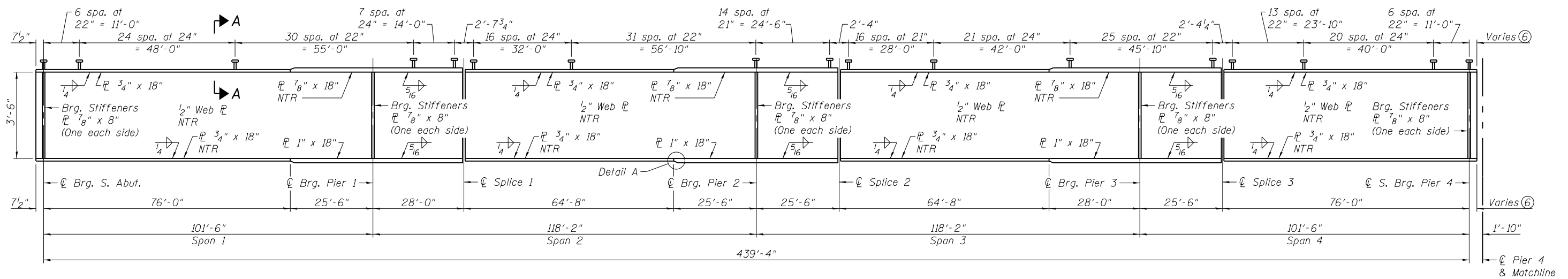

**PARTIAL GIRDER ELEVATION**

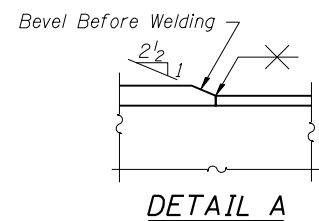

- Notes:
- Load carrying components designated "NTR" shall conform to the Impact Testing Requirement, Zone 2.
  - All diaphragms shall be installed as steel is erected and secured with erection pins and bolts except as otherwise noted. Individual diaphragms at supports may be temporarily disconnected to install bearing anchor rods.
  - For Section A-A, see sheet 30 of 62.
  - For splice details, see sheet 31 of 62.
  - For diaphragm details, see sheets 31 and 32 of 62.
  - For Girder End Treatment Detail, see sheet 30 of 62.
  - For girder coating requirements, see General Notes on sheet 2 of 62 and Special Provisions.

USER NAME =	DESIGNED - SJN	REVISED
PLOT SCALE =	CHECKED - JAD	REVISED
PLOT DATE =	DRAWN - SJN	REVISED
	CHECKED - JAD	REVISED

F.A.P. RTE.	SECTION	COUNTY	TOTAL SHEETS	SHEET NO.
626	(44-B-1)BR	KNOX	122	58
CONTRACT NO. 68759				
ILLINOIS FED. AID PROJECT				