

WEST EDGE OF SHOULDER

| Location | Station | Offset | Theoretical Grade Elevations |
|-------------------------|------------|--------|------------------------------|
| S. End North Appr. Slab | 1973+55.66 | -16.00 | 560.17 |
| A3 | 1973+65.66 | -16.00 | 560.12 |
| A4 | 1973+75.66 | -16.00 | 560.07 |
| N. End North Appr. Slab | 1973+85.66 | -16.00 | 560.02 |

WEST EDGE OF PAVEMENT

| Location | Station | Offset | Theoretical Grade Elevations |
|-------------------------|------------|--------|------------------------------|
| S. End North Appr. Slab | 1973+52.42 | -12.00 | 560.27 |
| A3 | 1973+62.42 | -12.00 | 560.22 |
| A4 | 1973+72.42 | -12.00 | 560.17 |
| N. End North Appr. Slab | 1973+82.42 | -12.00 | 560.12 |

☉ ROADWAY, P.G.L., & STAGE CONST. JOINT

| Location | Station | Offset | Theoretical Grade Elevations |
|-------------------------|------------|--------|------------------------------|
| S. End North Appr. Slab | 1973+42.70 | 0.00 | 560.50 |
| A3 | 1973+52.70 | 0.00 | 560.45 |
| A4 | 1973+62.70 | 0.00 | 560.40 |
| N. End North Appr. Slab | 1973+72.70 | 0.00 | 560.35 |

EAST EDGE OF PAVEMENT

| Location | Station | Offset | Theoretical Grade Elevations |
|-------------------------|------------|--------|------------------------------|
| S. End North Appr. Slab | 1973+32.98 | 12.00 | 560.36 |
| A3 | 1973+42.98 | 12.00 | 560.31 |
| A4 | 1973+52.98 | 12.00 | 560.26 |
| N. End North Appr. Slab | 1973+62.98 | 12.00 | 560.21 |

EAST EDGE OF SHOULDER

| Location | Station | Offset | Theoretical Grade Elevations |
|-------------------------|------------|--------|------------------------------|
| S. End North Appr. Slab | 1973+29.74 | 16.00 | 560.30 |
| A3 | 1973+39.74 | 16.00 | 560.25 |
| A4 | 1973+49.74 | 16.00 | 560.20 |
| N. End North Appr. Slab | 1973+59.74 | 16.00 | 560.15 |

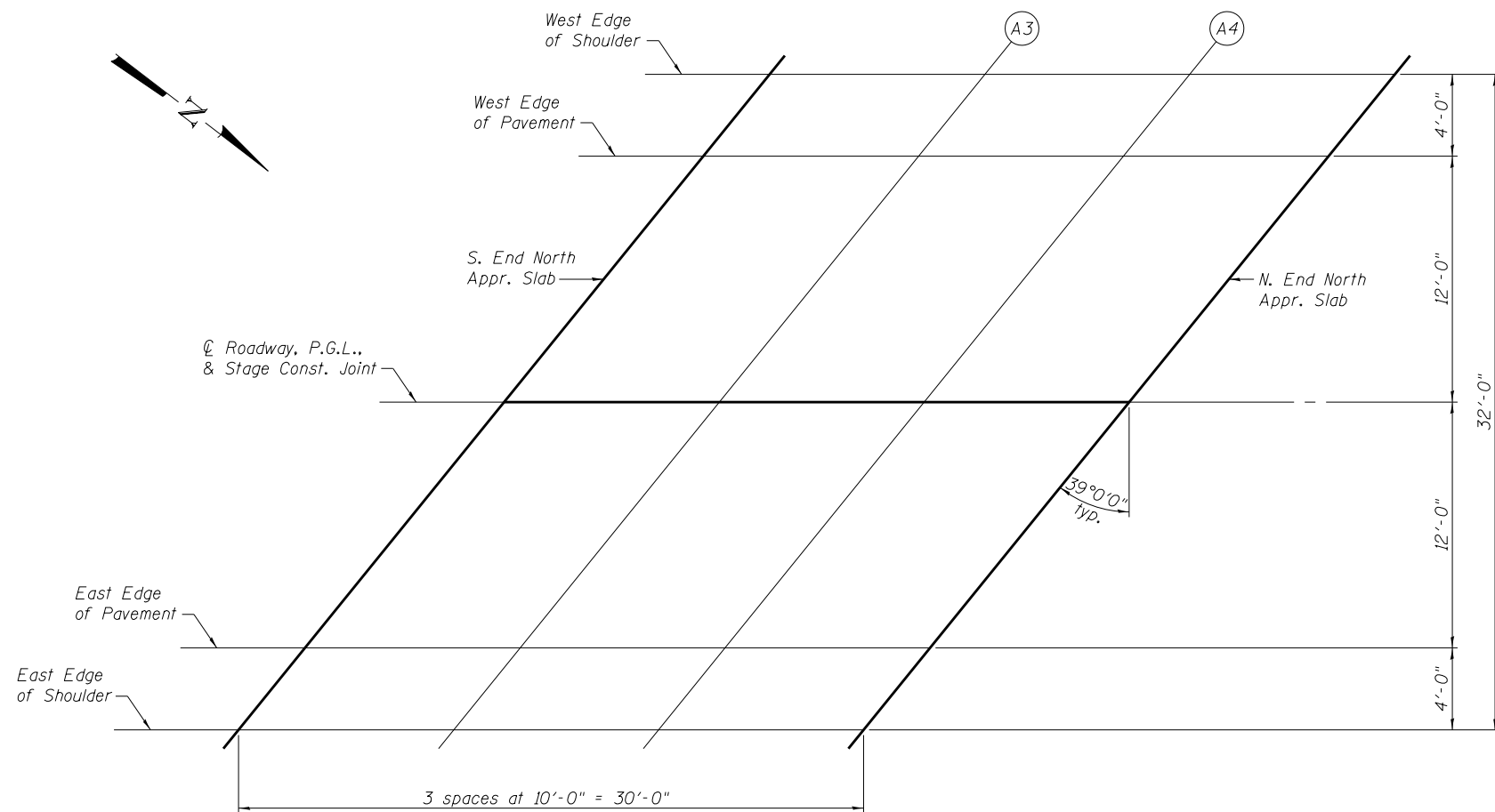

PLAN