

**STAGE 2 BRIDGE TYPICAL SECTION – PPC DECK BEAM SPANS**  
(LOOKING NORTH AT STRUCTURE)  
FOR INFORMATION ONLY

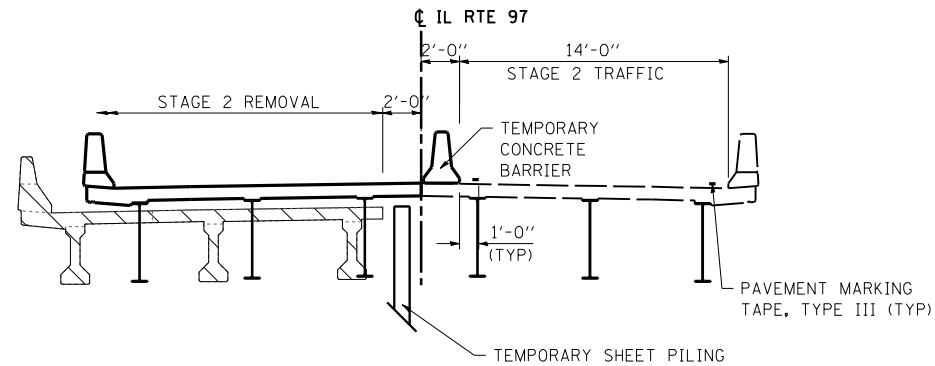

**STAGE 2 BRIDGE TYPICAL SECTION – PPC I-BEAM SPANS**  
(LOOKING NORTH AT STRUCTURE)  
FOR INFORMATION ONLY

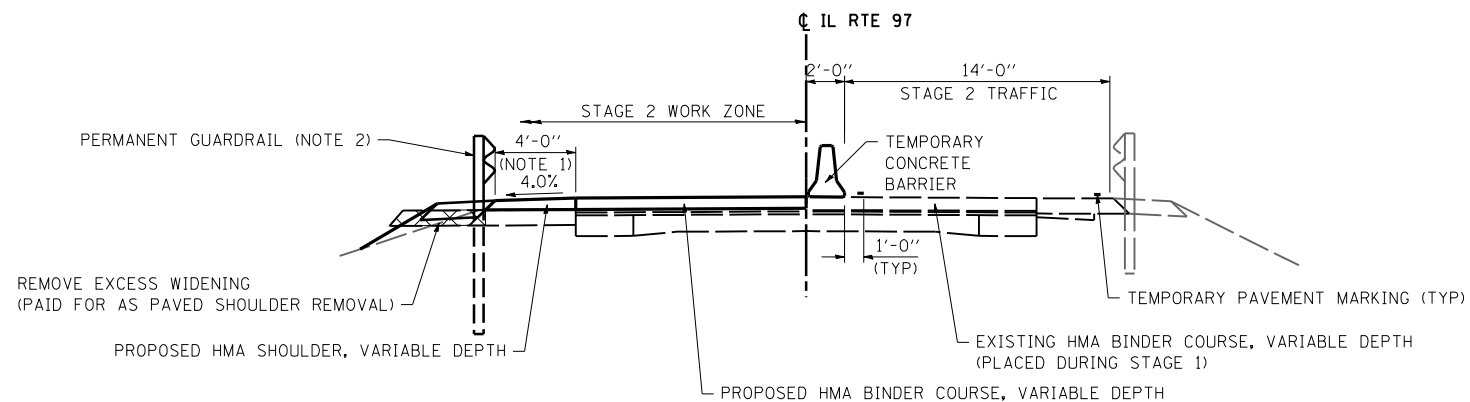

**STAGE 2 CONSTRUCTION TYPICAL SECTION**  
(SOUTH OF STRUCTURE, LOOKING NORTH)

**SUGGESTED STAGE 2 & 3 CONSTRUCTION**

SUGGESTED STAGE 2

1. UTILIZING TRAFFIC CONTROL AND PROTECTION, STANDARD 701321, DIRECT TRAFFIC TO THE RT LANE OF IL ROUTE 97.
2. REMOVE THE LT SIDE OF THE EXISTING STRUCTURE.
3. CONSTRUCT THE LT SIDE OF THE BRIDGE AND BRIDGE APPROACH PAVEMENT.
4. PERFORM HMA SURFACE REMOVAL & BUTT JOINT AND CONSTRUCT THE PROPOSED VARIABLE DEPTH HMA BINDER COURSE ON THE LT SIDE OF IL ROUTE 97, FROM STA. 1961+54 TO STA. 1964+50 AND FROM STA. 1973+80 TO STA. 1976+71.
5. CONSTRUCT TEMPORARY RAMPS AT STA. 1964+50 AND STA. 1973+80.
6. INSTALL GUARDRAIL, HMA SHOULDERS, AND EROS CONTROL AGG ON LT SIDE OF IL ROUTE 97 AND COMPLETE DRAINAGE AND GRADING IMPROVEMENTS.

SUGGESTED STAGE 3

1. UTILIZING TRAFFIC CONTROL AND PROTECTION, STANDARD 701306, COMPLETE HMA SURFACE REMOVAL & BUTT JOINT FOR THE RT AND LT LANES (AND AT HMA BASE COURSE WIDENING AS SHOWN ON THE REMOVAL PLAN SHEET) OF IL ROUTE 97 FROM STA. 1958+80 TO STA. 1961+54 AND STA. 1976+71 TO STA. 1980+25.
2. CONSTRUCT TEMPORARY RAMP AT STA. 1958+80 AND STA. 1980+25 IF RE-OPENED TO TRAFFIC PRIOR TO PLACING ASPHALT.
3. CONSTRUCT THE PROPOSED HMA SURFACE COURSE FOR THE RT AND LT LANES OF IL ROUTE 97 FROM STA. 1958+80 TO STA. 1964+50 AND STA. 1973+80 TO STA. 1980+25.
4. CONSTRUCT FINAL HMA SHOULDER LIFTS AND EROSION CONTROL AGGREGATE ON BOTH SIDES OF IL ROUTE 97.
5. CONSTRUCT PROPOSED ENTRANCES AND ALL REMAINING IMPROVEMENTS.

**ADDITIONAL NOTES**

- NOTE 1: HMA SHOULDER, VARIABLE DEPTH SHALL BE BUILT WIDE ENOUGH TO SUPPORT THE FINAL WIDTH SHOWN ON THE TYPICAL SECTIONS.
- NOTE 2: THE PERMANENT GUARDRAIL SHALL BE BUILT TALL ENOUGH TO MEET THE HEIGHT REQUIREMENTS LISTED ON HWY STD 630001 AFTER SURFACE COURSE HAS BEEN PLACED.

FILE NAME = D468759-sht-staging.dgn	USER NAME = default	DESIGNED - RGV	REVISED -	<b>STATE OF ILLINOIS DEPARTMENT OF TRANSPORTATION</b>	<b>STAGE 2 TYPICAL SECTIONS &amp; STAGING NOTES</b>		F.A.P. RTE.	SECTION	COUNTY	TOTAL SHEETS	SHEET NO.
	PLOT TIME = 8:52:26 AM	DRAWN - RGV	REVISED -				626	(44-B-1) BR	KNOX	122	24
PLOT SCALE = 100.0000' / IN.	CHECKED - BPS	REVISED -	REVISED -	SCALE: SHEET 3 OF 6 SHEETS STA. TO STA.		ILLINOIS FED. AID PROJECT					
PLOT DATE = 8/9/2013	DATE -	REVISED -	REVISED -	CONTRACT NO. 68759							