

STATE OF ILLINOIS  
DEPARTMENT OF TRANSPORTATION

PROJECT NO.	SECTION	COUNTY	TOTAL SHEETS	SHEET NO.
F.A. 100	BR & BR-1	GRUNDY	644	15

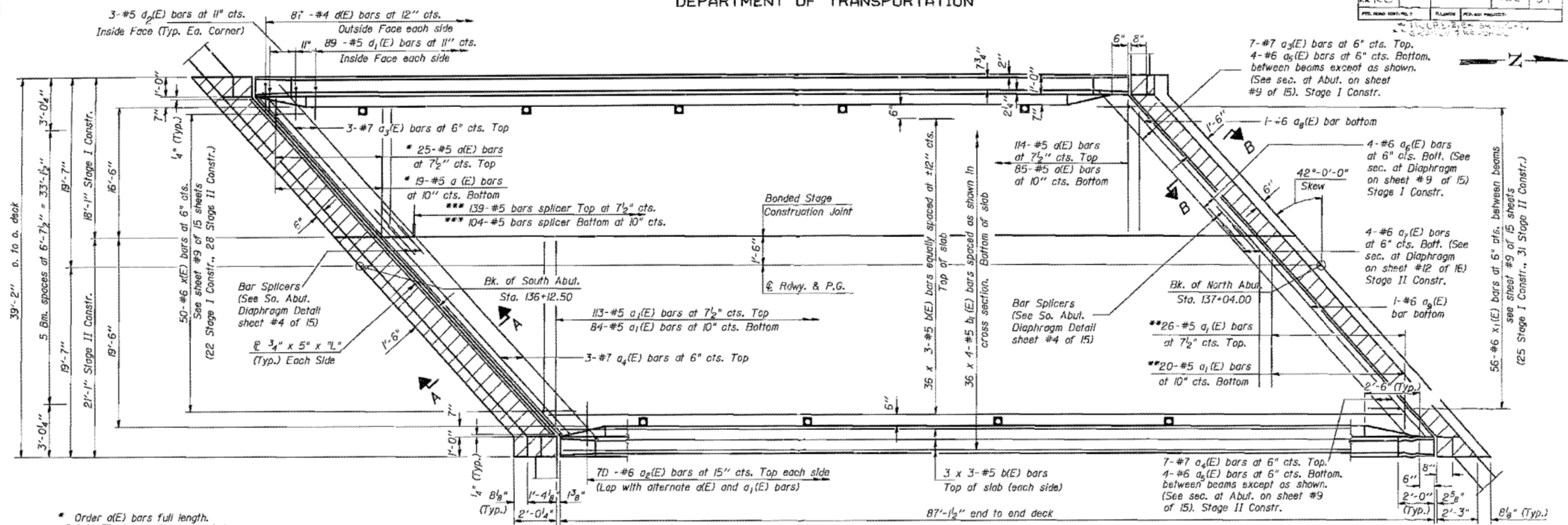

\* Order a(E) bars full length. Cut to fit skew and use remainder of bars in opposite end Stage I Constr.  
 \*\* Order a<sub>1</sub>(E) bars full length. Cut to fit skew and use remainder of bars in opposite end Stage II Constr.

Min. Bar Lap  
#5 bar - 1'-9"

DIMENSION "L"

Stage I constr. = 22'-11 1/2"  
 Stage II Constr. = 27'-0"

\*\*\* Bar splicers lapped with a(E) & a<sub>1</sub>(E) bars shall be tied with double the number of ties normally used.

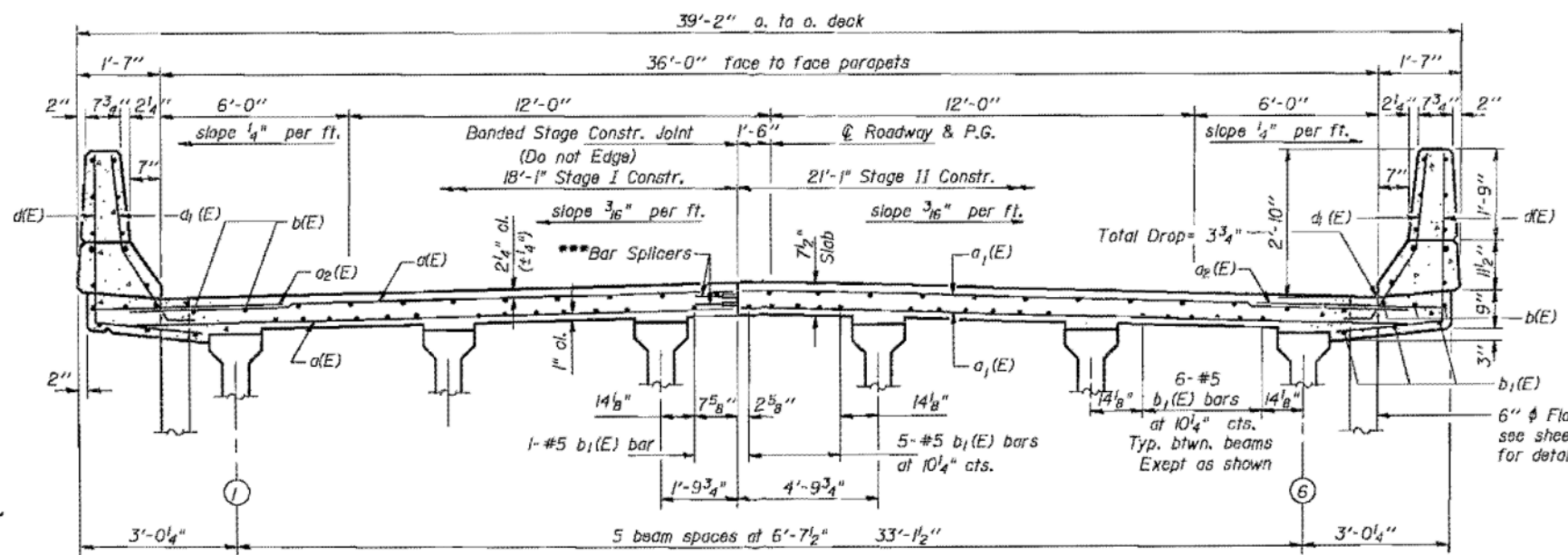

Notes: See sheet #8 of 15 for superstructure details and Bill of Material.  
 See Sheet #9 of 15 for Section A-A and Section B-B.  
 Reinforcement bars designated (E) shall be epoxy coated.  
 Bars indicated thus 20 x 3-#5 etc. indicates 20 lines of bars with 3 lengths per line.  
 See sheet #5 of 15 sheets for bar splicer details.  
 Hatched area to be poured after superstructure forms have been removed.  
 Quantity of "Class X Concrete Superstructure" billed with superstructure, see sheet #8 of 15.

**FOR INFORMATION ONLY**

**SUPERSTRUCTURE**  
**F.A. RT. 100 SEC. 110BR**  
**GRUNDY COUNTY**  
**STA. 136+58.25**

**CROSS SECTION**  
(Looking North)

DESIGNED	VECTOR VELTZ	EXAMINED	May 22 1982
CHECKED	Eva Lowery	PASSED	James J. Kasper
DRAWN	Rita Williams	APPROVED	Director of Highways
CHECKED	V.V. EFG pmp		

FILE NAME	USER NAME	DESIGNED	REVISED
V:\3195\66883 (South Section)\CADD Sheets\0366883-shr-exstruct-6.dgn	bdecaene	-	-
PLOT SCALE = 2.0000' / in.		CHECKED	REVISED
		-	-
SHT.PLAN	PLOT DATE = 8/6/2013	DATE	REVISED
		7/15/2013	-

STATE OF ILLINOIS  
DEPARTMENT OF TRANSPORTATION

IL. RTE. 47  
EXISTING BRIDGE PLANS

SCALE: N/A	SHEET 6 OF 23 SHEETS	STA. N/A TO STA. N/A	F.A.P. RTE. 326	SECTION (110R, BR & BR-1)	COUNTY GRUNDY	TOTAL SHEETS 644	SHEET NO. 404
------------	----------------------	----------------------	-----------------	---------------------------	---------------	------------------	---------------

CONTRACT NO. 66883  
ILLINOIS FED. AID PROJECT