

TRAFFIC SIGNAL LEGEND

- CONTROLLER AND CABINET
- DOUBLE HANDHOLE
- HANDHOLE
- SERVICE INSTALLATION
- SIGNAL HEAD WITH BACKPLATE
- SIGNAL POST
- MAST ARM ASSEMBLY AND POLE, STEEL
- COMBINATION MAST ARM ASSEMBLY AND POLE, STEEL WITH LUMINAIRE, SODIUM VAPOR, 400 WATT
- CONDUIT: "T" TRENCH, "P" PUSHED
- DETECTOR LOOP
- LIGHT DETECTOR
- CONFIRMATION BEACON
- PEDESTRIAN SIGNAL HEAD
- PEDESTRIAN PUSH BUTTON

SCHEDULE OF POLE/MAST ARM ASSEMBLIES

LOCATION	LENGTH	TYPE
A	68.0'	S. COMB. MAA. & POLE
B	52.0'	S. COMB. MAA. & POLE
C	74.0'	S. COMB. MAA. & POLE
D	54.0'	S. COMB. MAA. & POLE
E	16.0'	SIGNAL POST
F	10.0'	SIGNAL POST
G	16.0'	SIGNAL POST
H	16.0'	SIGNAL POST

SCHEDULE OF SIGNAL HEAD QUANTITIES

LOCATION	ITEM	UNIT	QUANTITY
2, 3, 6, 10, 11	SH, 1F, 3S, MAM	EACH	5
5, 13, 14	SH, 1F, 4S, MAM	EACH	3
1, 9, 12	SH, 1F, 5S, MAM	EACH	3
8, 17	SH, 1F, 3S, BM	EACH	2
4	SH, 1F, 4S, BM	EACH	1
7, 15, 16	SH, 1F, 5S, BM	EACH	3

MAST ARM AND POST LOCATIONS		
LETTER	STATION	OFFSET
A	6044+93	66.1' LT
B	6046+00	64.0' LT
C	6046+25	71.3' RT
D	6044+93	74.3' RT
E	6046+09	60.0' LT
F	6046+00	66.4' RT
G	6045+85	75.9' RT
H	6044+85	63.7' RT

NOTE: LOCATIONS OF TRAFFIC SIGNAL POSTS AND MAST ARM ASSEMBLIES MAY BE CHANGED IN THE FIELD AS NECESSARY TO AVOID UTILITIES. THE NEW LOCATIONS SHALL BE COORDINATED WITH THE ENGINEER AND APPROVED BY THE DISTRICT TRAFFIC SIGNAL SECTION TO ENSURE THE NEW LOCATIONS MEET OPERATIONAL OFFSET/CLEAR ZONE REQUIREMENTS AND MAINTAIN PROPER POSITION OF SIGNAL HEADS IN RELATION TO THE TRAVELED LANES.

NOTIFY THE TRAFFIC SIGNAL SECTION AT (815) 434-8506 72 HOURS IN ADVANCE TO REDESIGN THE DETECTOR LOOPS, IF POSSIBLE, TO AVOID CONSTRUCTION JOINTS.

FOR THE LOCATION OF MAST ARM "B" IN THE NORTHWEST QUADRANT SPLIT THE DIFFERENCE BETWEEN THE SANITARY SEWER AND THE WATERMAIN. IF POSSIBLE, MAINTAIN A 6FT DISTANCE FROM THE FACE OF THE FOUNDATION TO THE CURB.

FOR THE LOCATION OF SIGNAL POST "H" IN THE NORTHWEST QUADRANT THERE IS A WATERMAIN IN THE AREA SO PLACE THE SIGNAL POST NO CLOSER THAN 4FT TO THE CURB BUT NO FURTHER THAN 6FT WHILE AVOIDING CONFLICT WITH THE WATERMAIN.

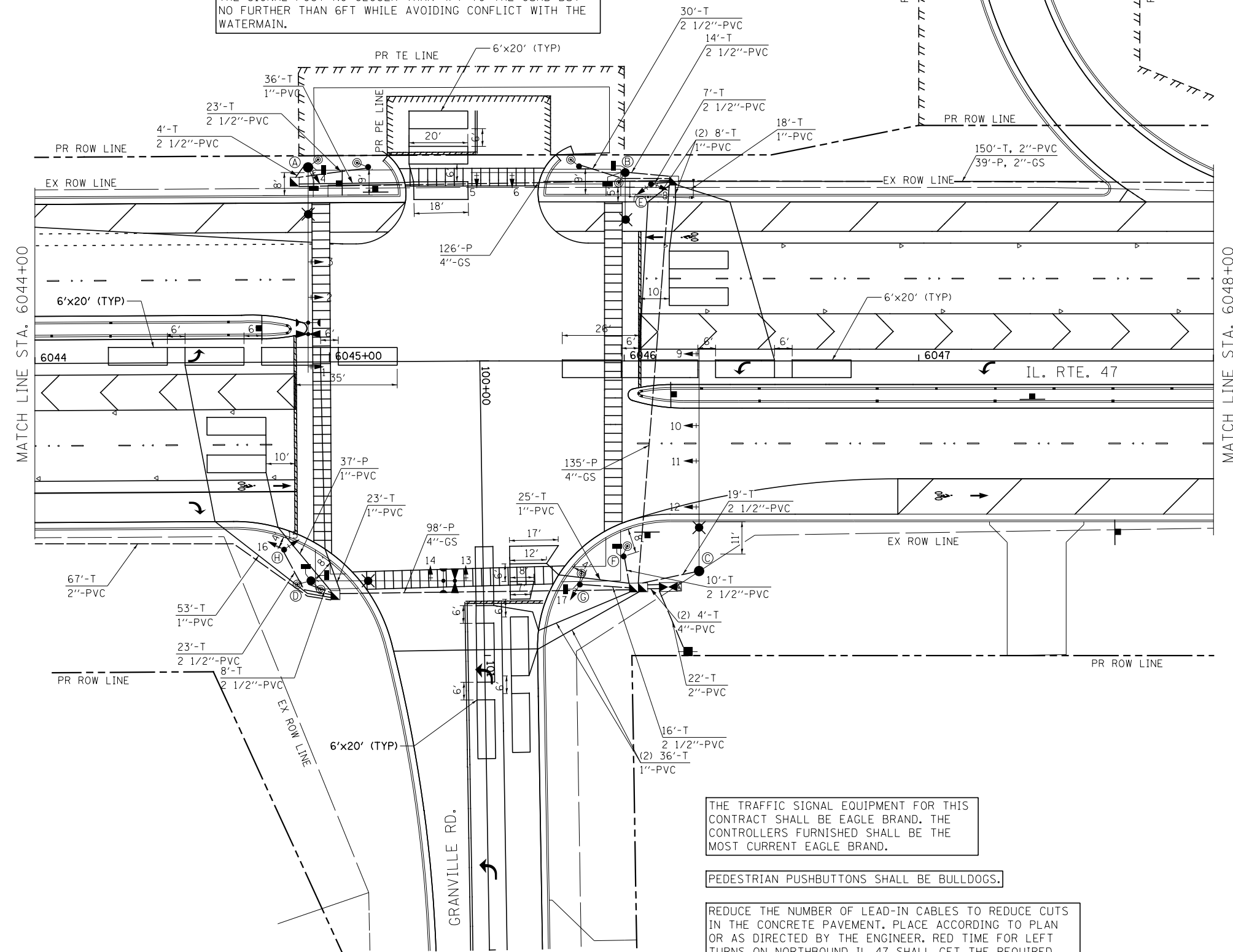

THE TRAFFIC SIGNAL EQUIPMENT FOR THIS CONTRACT SHALL BE EAGLE BRAND. THE CONTROLLERS FURNISHED SHALL BE THE MOST CURRENT EAGLE BRAND.

PEDESTRIAN PUSHBUTTONS SHALL BE BULLDOGS.

REDUCE THE NUMBER OF LEAD-IN CABLES TO REDUCE CUTS IN THE CONCRETE PAVEMENT. PLACE ACCORDING TO PLAN OR AS DIRECTED BY THE ENGINEER. RED TIME FOR LEFT TURNS ON NORTHBOUND IL 47 SHALL GET THE REQUIRED MUTCD RED TIME + ONE SECOND TO ACCOMMODATE U-TURNS.

THE EMERGENCY VEHICLE PRE-EMPTION EQUIPMENT SHALL BE COMPLETELY COMPATIBLE WITH ALL COMPONENTS OF THE EQUIPMENT CURRENTLY USED BY THE CITY OF MORRIS. THE CITY CURRENTLY USES TOMAR EQUIPMENT.

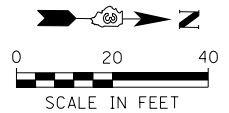

FILE NAME =	USER NAME = bdecreane	DESIGNED - AS
V:\3195\66883 (South Section)\CADD Sheets\0366883-sht-ts-11.dgn		DRAWN - AS
	PLOT SCALE = 40.0000' / in.	CHECKED - ST
SHT_PLAN	PLOT DATE = 8/6/2013	DATE - 7/15/2013



STATE OF ILLINOIS
DEPARTMENT OF TRANSPORTATION

IL. RTE. 47 AT GRANVILLE RD.
PROPOSED TRAFFIC SIGNAL MODERNIZATION

SCALE: 1"=20' SHEET NO. 2 OF 20 SHEETS STA. 6044+00 TO STA. 6048+00

F.A.P. RTE.	SECTION	COUNTY	TOTAL SHEETS	SHEET NO.
326	(110)R, BR & BR-1	GRUNDY	644	279
CONTRACT NO. 66B83				
ILLINOIS FED. AID PROJECT				