

1. ALL TRAFFIC CONTROL DEVICES SHALL BE FURNISHED, ERECTED AND MAINTAINED BY THE CONTRACTOR.
2. ALL SIGNS NOT ATTACHED TO BARRICADES SHALL BE POST MOUNTED.
3. TYPE III BARRICADES AND ROAD CLOSURE SIGNS SHALL BE POSITIONED AS SHOWN, IN ACCORDANCE WITH HIGHWAY STANDARD 701901 AND AS DIRECTED BY THE ENGINEER.
4. TYPE A LOW INTENSITY FLASHING WARNING LIGHTS SHALL BE USED ON EACH SIGN IN ADVANCE OF THE WORK DURING HOURS OF DARKNESS.
5. ALL WARNING SIGNS SHALL BE A MINIMUM OF 48" x 48" AND HAVE A BLACK LEGEND AND BORDER ON A FLUORESCENT ORANGE REFLECTORIZED BACKGROUND.
6. THE CONTRACTOR SHALL MAINTAIN ACCESS TO ENTRANCES AT ALL TIMES.
7. ALL TYPE III BARRICADES UTILIZED FOR ROAD CLOSURES SHALL HAVE A LOW INTENSITY FLASHING LIGHT MOUNTED ON TOP OF EACH BARRICADE.
8. EXACT LOCATION OF ALL WARNING SIGNS AND BARRICADES SHALL BE STAKED IN THE FIELD FOR APPROVAL BY THE ENGINEER PRIOR TO INSTALLATION.
9. COVER CONFLICTING SIGNS, EXISTING DIRECTIONAL ARROWS MUST BE COVERED. THE CONTRACTOR SHALL NOT DRILL INTO THE FACE OF ANY EXISTING DIRECTIONAL/CONFLICTING SIGNS TO BE COVERED.

- 1 W20-3(O)-48 (ROAD CLOSED AHEAD)
- 2 W20-3(O)-48 (ROAD CLOSED 500 FT)
- 3 TYPE III BARRICADES W/ R-11-2-4830 (ROAD CLOSED) SIGN AND TYPE A LOW INTENSITY FLASHING LIGHTS
- 4 TYPE III BARRICADES W/ R-11-4-4830 (ROAD CLOSED TO THRU TRAFFIC) SIGN AND TYPE A LOW INTENSITY FLASHING LIGHTS
- 5 M4-8(O) (DETOUR) BLACK LETTERS ON FLUORESCENT ORANGE BACKGROUND
- 6 M1-4 (IL 115)
- 7 M5-1(R) (ADVANCED RIGHT TURN ARROW) BLACK LETTERS/FLUORESCENT ORANGE
- 8 M5-1(L) (ADVANCED LEFT TURN ARROW) BLACK LETTERS/FLUORESCENT ORANGE
- 9 M6-1(R) (RIGHT TURN ARROW) BLACK LETTERS/FLUORESCENT ORANGE
- 10 M6-1(L) (LEFT TURN ARROW) BLACK LETTERS/FLUORESCENT ORANGE
- 11 M6-3 (STRAIGHT ARROW) BLACK LETTERS/FLUORESCENT ORANGE
- 12 M4-8(O) (END DETOUR) BLACK LETTERS/FLUORESCENT ORANGE
- 13 M3-2 (EAST)
- 14 M3-4 (WEST)
- 15 W20-3(O)-48 (DETOUR AHEAD)
- 16 TEMPORARY INFORMATION SIGN

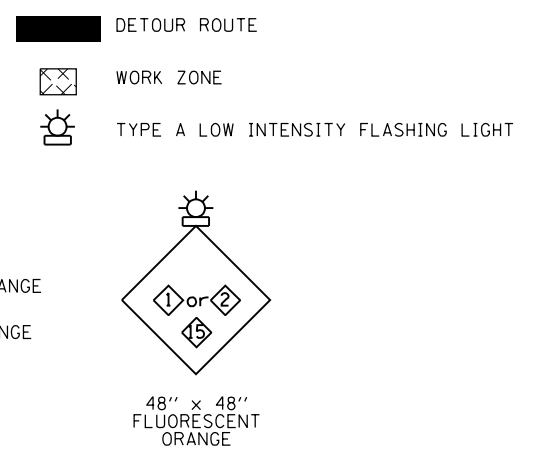

FILE NAME =	USER NAME = duncanbd	DESIGNED -	REVISED -	STATE OF ILLINOIS DEPARTMENT OF TRANSPORTATION	DETOUR PLAN			F.A.S. RTE.	SECTION	COUNTY	TOTAL SHEETS	SHEET NO.	
	et:\pw\work\p1dot\duncanbd\dms68355\EP04404-sh1-detour.dgn	DRAWN -	REVISED -		SCALE: NTS	SHEET NO. 1 OF 1 SHEETS	STA.	TO STA.	1323	102 BR	KANKAKEE	53	15
	PLOT SCALE = 100.0000' / in.	CHECKED -	REVISED -					CONTRACT NO. 66B66			ILLINOIS FED. AID PROJECT		
	PLOT DATE = 8/12/2013	DATE -	REVISED -										