

DATE	
BY	
DESIGNED	
DRAWN	
CHECKED	
DATE	
FILE NAME	
NO.	

DATE	
BY	
DESIGNED	
DRAWN	
CHECKED	
DATE	
FILE NAME	
NO.	

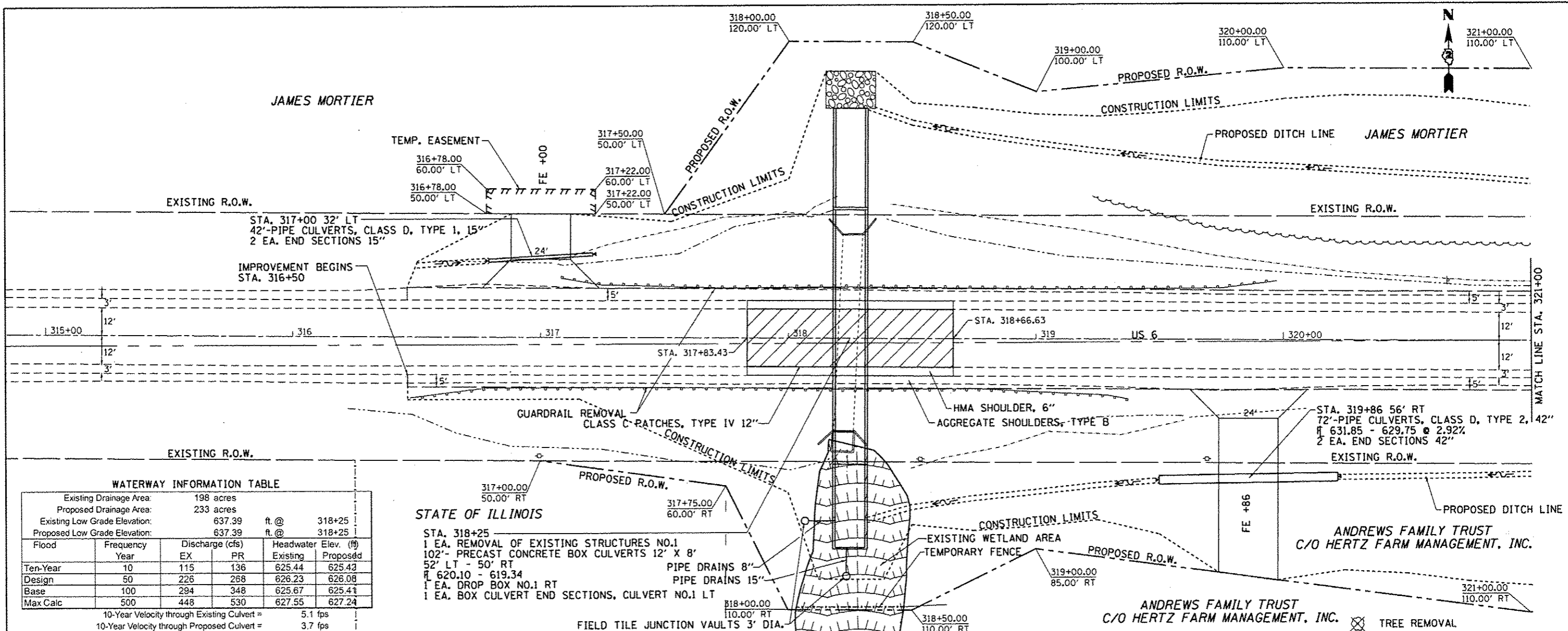

WATERWAY INFORMATION TABLE

Existing Drainage Area: 198 acres					
Proposed Drainage Area: 233 acres					
Existing Low Grade Elevation: 637.39 ft. @ 318+25					
Proposed Low Grade Elevation: 637.39 ft. @ 318+25					
Flood Year	Frequency	Discharge (cfs)	Headwater Elev. (ft)		
		EX	PR	Existing	Proposed
Ten-Year	10	115	136	625.44	625.43
Design	50	226	268	626.23	626.08
Base	100	294	348	625.67	625.41
Max Calc	500	448	530	627.55	627.24
10-Year Velocity through Existing Culvert =				5.1 fps	
10-Year Velocity through Proposed Culvert =				3.7 fps	

STATE OF ILLINOIS

STA. 318+25
 1 EA. REMOVAL OF EXISTING STRUCTURES NO.1
 102'- PRECAST CONCRETE BOX CULVERTS 12' X 8'
 52' LT - 50' RT
 # 620.10 - 619.34
 1 EA. DROP BOX NO.1 RT
 1 EA. BOX CULVERT END SECTIONS, CULVERT NO.1 LT
 PIPE DRAINS 8"
 PIPE DRAINS 15"
 FIELD TILE JUNCTION VAULTS 3' DIA.

STA. 316+50 to 321+00
 EARTH EX. = 5,383.7 CU.YDS.
 EMB. = 779.0 CU.YDS.
 WASTE = 3,258.8 CU.YDS.

