

General Notes:

1. Reinforcement bars designated (E) shall be epoxy coated.
2. All exposed concrete edges shall be bevelled $\frac{3}{4}$ ".
3. Removal of the existing retaining wall and Construction of the proposed retaining wall shall be accomplished in accordance with the special provision for CONSTRUCTION VIBRATION AND MONITORING.
4. The geocomposite wall drain shall be constructed according to section 591 of The Standard Specifications. The contractor shall insure that the bottom, sides and the top of edges are protected from soil entering or sealing the drain while placing the pervious fabric side of the drain towards the soil. Geocomposite wall drain shall be installed in stages as the excavation proceeds downward. Splicing should be minimized following proper splice practices to insure no long term soil contamination.
5. The anticipated deflection at the top of wall during construction is estimated to be $\frac{3}{8}$ ". The concrete facing thickness is to be adjusted accordingly.
6. The Contractor is responsible for the design and performance of the lagging using no less than a 3 inch nominal rough-sawn thickness and timber with a minimum allowable bending stress of 1000 p.s.i.
7. Existing retaining wall shall remain in place until timber lagging is completed in the proposed retaining wall.

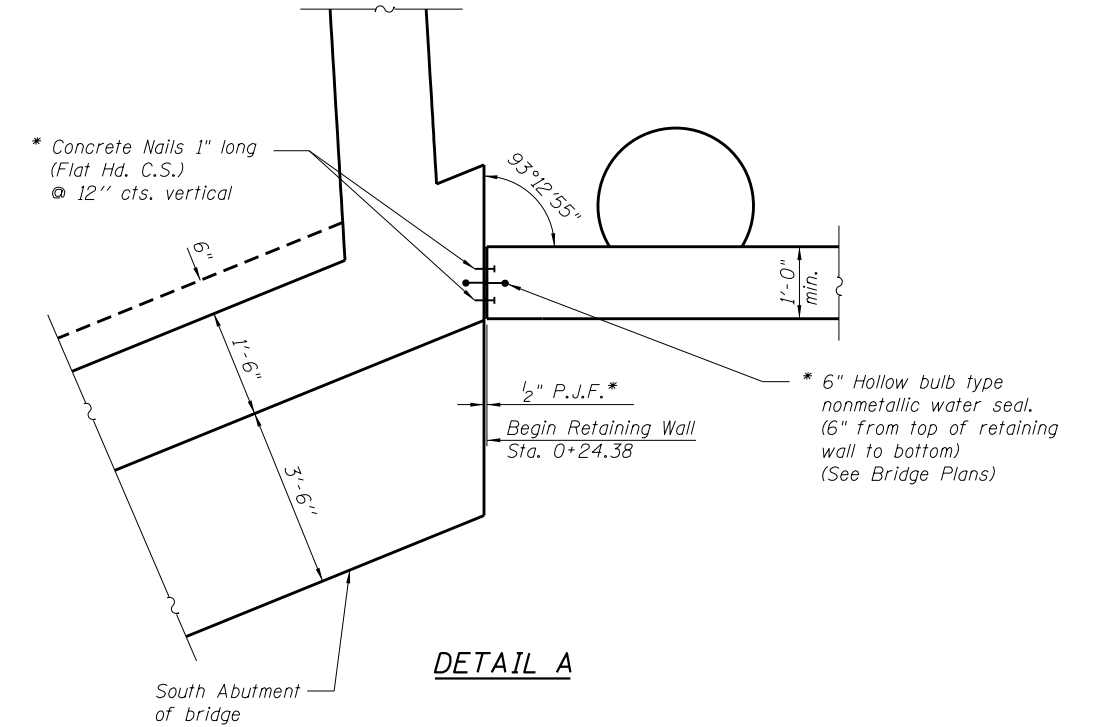

DETAIL A

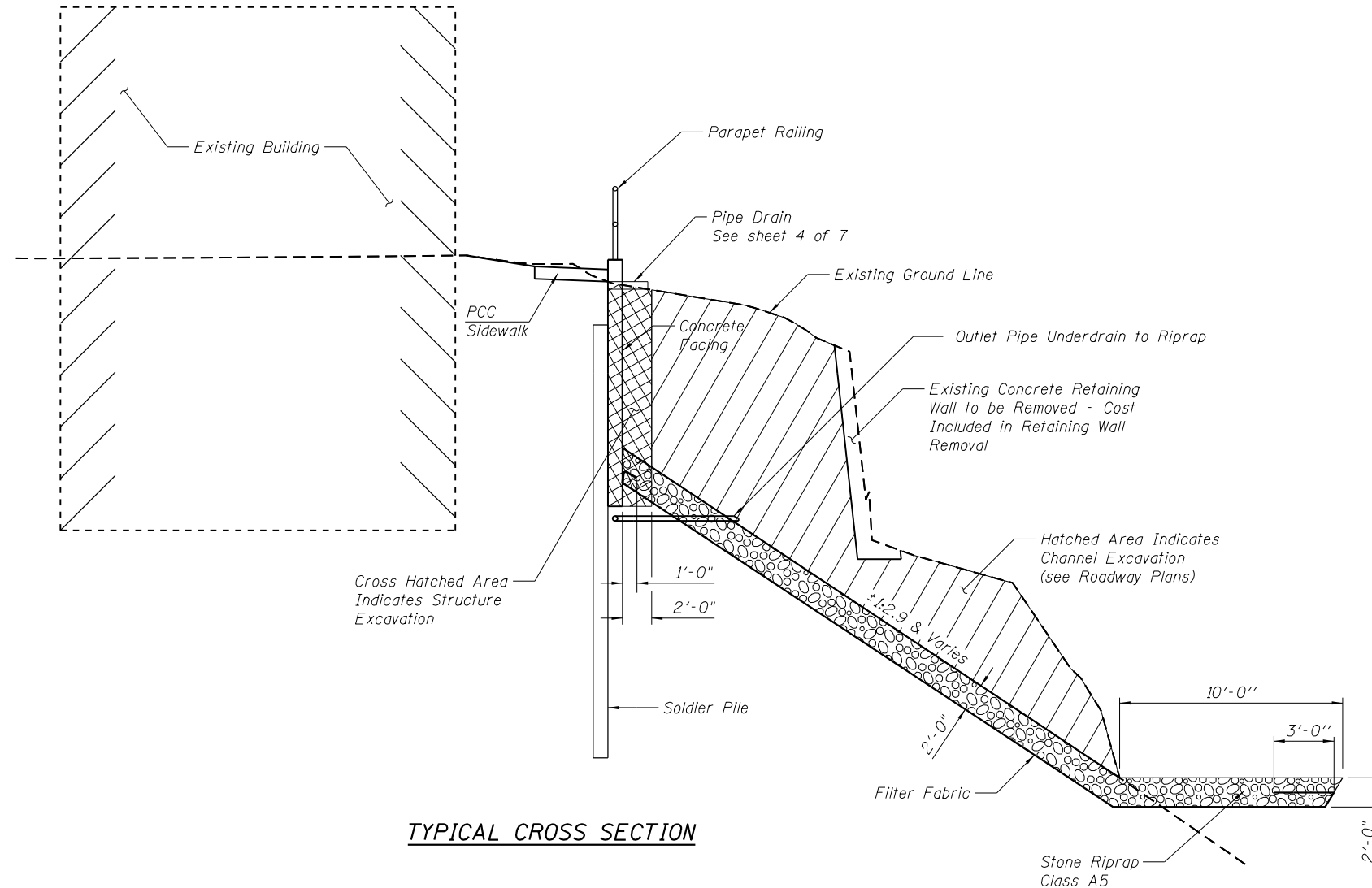

TYPICAL CROSS SECTION

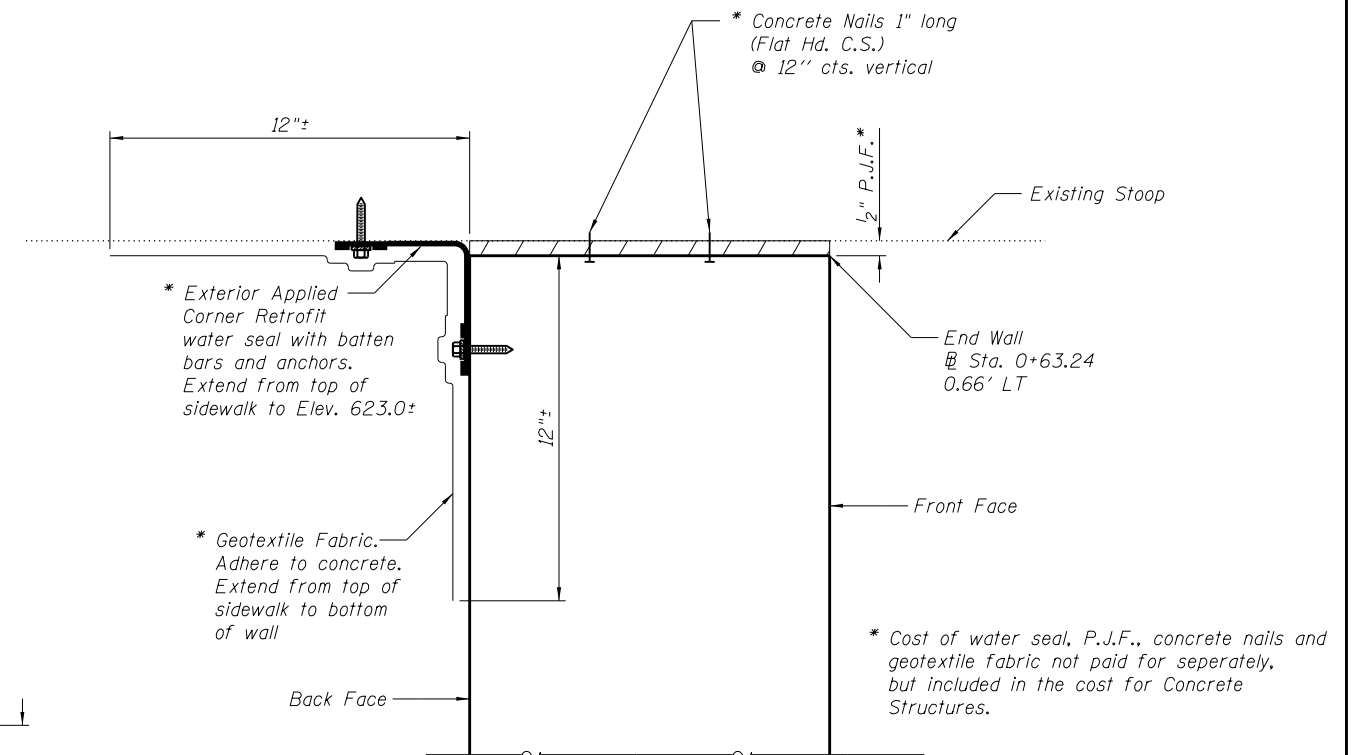

DETAIL B

FILE NAME = Z64E08-002-General Notes.dgn
 MODEL = Default
 PLOT DRIVER = VBA_IIDOT_PDF_11x17.pltcfgr



USER NAME =	DESIGNED -	REVISED
	CHECKED -	REVISED
PLOT SCALE =	DRAWN -	REVISED
PLOT DATE =	CHECKED -	REVISED

**STATE OF ILLINOIS
DEPARTMENT OF TRANSPORTATION**

**GENERAL NOTES, CROSS SECTION
RETAINING WALL #1**

SHEET NO. 2 OF 7 SHEETS

F.A.P. RTE.	SECTION	COUNTY	TOTAL SHEETS	SHEET NO.
308	103BR-4	JO DAVIESS	159	112
CONTRACT NO. 64E08				

ILLINOIS FED. AID PROJECT