

Drawing file: W:\projects\Maywood\5652-119 - 5th ave resurfacing\01_COVER.dwg Aug 26, 2025 - 1:35pm
FEDERAL AID PROGRAM DESIGN ENGINEER: CARMEN E. RAMOS, P.E., SCHAUMBURG, IL

11-07-2025 LETTING ITEM 103

FOR INDEX OF SHEETS, SEE SHEET NO. 2
FOR INDEX OF HIGHWAY STANDARDS, SEE SHEET NO. 2

FUNCTIONAL CLASSIFICATION
MAJOR COLLECTOR

TRAFFIC DATA
ADT (2019) = 3,300
ADT (2050) = 4,000

POSTED SPEED LIMIT
5TH AVENUE = 25 MPH

DESIGN SPEED LIMIT
5TH AVENUE = 25 MPH

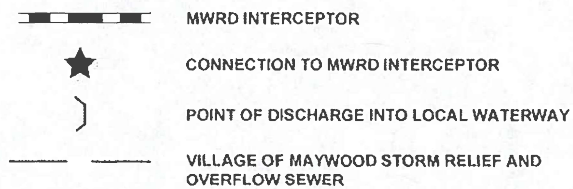

◆ Civil Engineers 9933 Roosevelt Road
◆ Municipal Consultants Westchester, IL 60154-2780
◆ Established 1911 Phone: 708-865-0300
www.ehancock.com

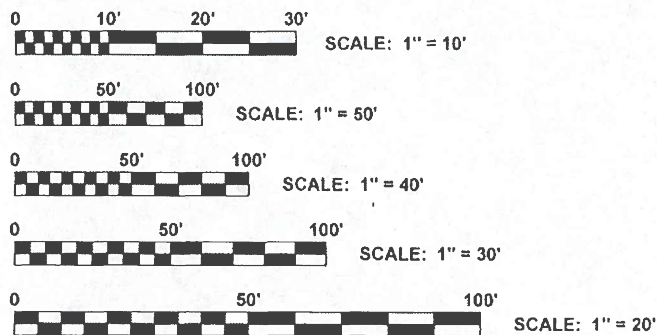

FULL SIZE PLANS HAVE BEEN PREPARED USING STANDARD
ENGINEERING SCALES. REDUCED SIZED PLANS WILL NOT
CONFORM TO STANDARD SCALES. IN MAKING MEASUREMENTS
ON REDUCED PLANS, THE ABOVE SCALES MAY BE USED.

J.U.L.I.E.
JOINT UTILITY LOCATION INFORMATION FOR EXCAVATION
1-800-892-0123
OR 811

CONTRACT NO. 61L75

STATE OF ILLINOIS

DEPARTMENT OF TRANSPORTATION

PLANS FOR PROPOSED FEDERAL AID HIGHWAY

FAU 2742 (5TH AVENUE)
HARRISON STREET TO QUINCY STREET
RESURFACING
SECTION NO.: 24-00145-00-RS
PROJECT NO.: 38K7 (409)
VILLAGE OF MAYWOOD
COOK COUNTY

C-91-122-25

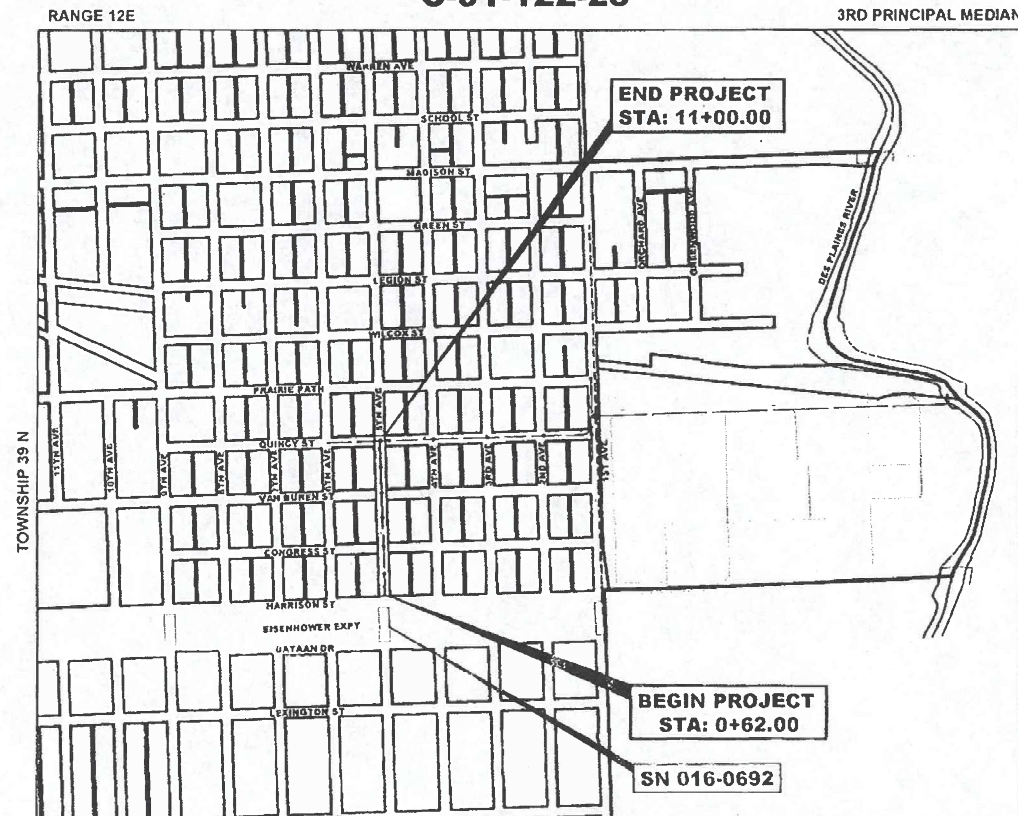

SECTION 14, TOWNSHIP 39, RANGE 12
PROVISO TOWNSHIP
LOCATION MAP
NOT TO SCALE

GROSS LENGTH OF IMPROVEMENT = 1,038 FT = 0.197 MI
NET LENGTH OF IMPROVEMENT = 1,038 FT = 0.197 MI



LOCATION OF SECTION
INDICATED THUS: —

TO THE BEST OF MY KNOWLEDGE AND BELIEF, THE DRAINAGE OF SURFACE
WATER WILL NOT BE CHANGED BY THE PROPOSED DEVELOPMENT. IF ANY
DRAINAGE PATTERNS WILL BE CHANGED, REASONABLE PROVISIONS HAVE
BEEN MADE FOR THE COLLECTION AND DIVERSION OF SUCH SURFACE
WATERS IN TO THE PUBLIC AREA, OR DRAINS APPROVED FOR THE USE BY
THE USE BY THE MUNICIPAL ENGINEER, AND THAT SUCH SURFACE WATERS
ARE PLANNED FOR IN ACCORDANCE WITH GENERALLY ACCEPTED
ENGINEERING PRACTICES SO AS TO REDUCE THE LIKELIHOOD OF
DAMAGES TO ADJOINING PROPERTIES.



SIGNED: *Andrew J. Barnett*
DATE: 08/25/2025 LICENSE EXPIRES: 11-30-25

STATE OF ILLINOIS	
ILLINOIS DEPARTMENT OF TRANSPORTATION	
DIVISION OF HIGHWAYS	
APPROVED August 28, 2025	20 25
VILLAGE OF MAYWOOD, PRESIDENT	
PASSED SEPT 3, 2025	20 25
DISTRICT 1 ENGINEER OF LOCAL ROADS & STREETS	
RELEASING FOR BID BASED ON LIMITED REVIEW	9/3 20 25
REGIONAL ENGINEER	

PRINTED BY THE AUTHORITY
OF THE STATE OF ILLINOIS

GENERAL NOTES

1. ANY REFERENCE TO STANDARDS THROUGHOUT THE PLANS OR SPECIAL PROVISIONS SHALL BE INTERPRETED TO BE THE LATEST STANDARD OF THE ILLINOIS DEPARTMENT OF TRANSPORTATION AS SHOWN ON THE INDEX OF SHEETS IN THE PLANS. ALL CONSTRUCTION SHALL BE DONE IN ACCORDANCE WITH THE "STANDARD SPECIFICATIONS FOR ROAD AND BRIDGE CONSTRUCTION" ADOPTED JANUARY 1, 2022. THE LATEST EDITION OF THE "ILLINOIS MANUAL ON UNIFORM TRAFFIC CONTROL DEVICES FOR STREETS AND HIGHWAYS," "THE STANDARD SPECIFICATIONS FOR WATER AND SEWER MAIN CONSTRUCTION IN ILLINOIS" 8TH EDITION, AND THE "DETAILS" IN THE PLANS AND THE "SPECIAL PROVISIONS" INCLUDED IN THE CONTRACT DOCUMENTS. VILLAGE OF MELROSE PARK MUNICIPAL CODE, VILLAGE OF MAYWOOD MUNICIPAL CODE, THE METROPOLITAN WATER RECLAMATION DISTRICT OF GREATER CHICAGO (MWRD) WATERSHED MANAGEMENT ORDINANCE AND TECHNICAL GUIDANCE MANUAL. IN CASE OF CONFLICT BETWEEN THE APPLICABLE ORDINANCES NOTED, THE MORE STRINGENT SHALL TAKE PRECEDENCE AND SHALL CONTROL ALL CONSTRUCTION.
2. BEFORE STARTING ANY EXCAVATION, THE CONTRACTOR SHALL CALL "JULIE" AT 811 FOR FIELD LOCATIONS OF BURIED ELECTRICAL, TELEPHONE AND GAS FACILITIES. (48 HOURS NOTIFICATION IS REQUIRED).
3. THE LOCATIONS OF THE UNDERGROUND UTILITIES IF SHOWN ON THE PLANS HAVE BEEN OBTAINED BY FIELD SURVEYS AND SEARCHES OF AVAILABLE RECORDS. THE VILLAGE OF MAYWOOD, THE ILLINOIS DEPARTMENT OF TRANSPORTATION AND/OR OTHER OFFICES AND AGENCIES ASSOCIATED WITH THE DEVELOPMENT OF THESE PLANS DO NOT GUARANTEE THEIR ACCURACY OR COMPLETENESS. THE CONTRACTOR SHALLL BE REQUIRED TO VERIFY THE EXACT LOCATION OF EACH FACILITY WITH THE UTILITY COMPANY, AND SHALL TAKE DUE CARE IN ALL PHASES OF THE CONSTRUCTION TO PROTECT ANY SUCH FACILITIES WHICH MAY BE AFFECTED BY THE WORK. ANY DAMAGE TO EXISTING UTILITIES DURING CONSTRUCTION ACTIVITIES SHALL BE REPAIRED OR REPLACED TO THE SATISFACTION OF THE ENGINEER.
4. THE CONTRACTOR SHALL COORDINATE CONSTRUCTION ACTIVITIES WITH UTILITY COMPANIES, THE VILLAGE OF MAYWOOD.
5. ON ALL IMPROVEMENTS, THE FRAMES AND LIDS OF EXISTING CATCH BASINS, INLETS, MANHOLES, AND VALVE VAULTS WHICH ARE TO BE ABANDONED DUE TO CONSTRUCTION OF THIS IMPROVEMENT ARE TO REMAIN THE PROPERTY OF THE VILLAGE HAVING JURISDICTION AND BE SALVAGED. THE CONTRACTOR SHALL DELIVER FRAMES AND LIDS TO THE PUBLIC WORKS YARD OF THE VILLAGE HAVING JURISDICTION, EXACT LOCATION TO BE PROVIDED.
6. THE WORD "WATER", "SANITARY", OR "STORM" SHALL BE CAST INTO THE LID OF EACH RESPECTIVE MANHOLE OR VALVE VAULT
7. THE CONTRACTOR SHALL CONDUCT OPERATIONS AS TO MAINTAIN AT ALL TIMES FLOW THROUGH EXISTING STORM AND SANITARY SEWER SYSTEMS. THE CONTRACTOR SHALL ALSO PROVIDE AND MAINTAIN AN EFFICIENT PUMPING PLANT IF NECESSARY AND A TEMPORARY OUTLET AND BE PREPARED AT ALL TIMES TO DISPOSE OF THE WATER COLLECTED IN A SAFE MANNER WITHOUT DAMAGE OF ANY KIND TO ADJACENT PROPERTIES. THE ENDS OF EXISTING DRAINAGE LINES THAT ARE NOT TO BE INCORPORATED INTO THE PROJECT SHALL BE SEALED AS SPECIFIED IN THE SPECIAL PROVISIONS. EXISTING STRUCTURES ARE TO BE INSPECTED BEFORE CONSTRUCTION STARTS - ANY ACCUMULATION OF MATERIAL IN THE STRUCTURE DUE TO CONSTRUCTION OPERATIONS SHALL BE REMOVED BY THE CONTRACTOR.
8. CONTRACTOR SHALL TAKE PRECAUTION BY PRESERVING EXISTING TREES WITHIN THE RIGHT OF WAY. IF ANY DAMAGE OCCURS, TREE SHALL BE REPLACED IN KIND PER ARTICLE 201.07 REPAIR OR REPLACEMENT OF EXISTING PLANT MATERIAL REQUIREMENTS STATED HEREIN.
9. WHEN REMOVING PAVEMENT AND/OR OTHER STRUCTURES, THE CONTRACTOR SHALL NOT USE ANY TYPE OF CONCRETE BREAKERS SUCH AS DROP HAMMERS, THAT MIGHT DAMAGE UNDERGROUND PUBLIC OR PRIVATE UTILITIES.
10. THE CONTRACTOR SHALL SAW CUT ASPHALT PAVEMENT AS INDICATED ON THE PLANS TO SEPARATE THE EXISTING PAVEMENT TO BE REMOVED BY APPROVED MEANS OR AN APPROVED CONCRETE SAW TO A DEPTH AS DIRECTED BY THE ENGINEER. SUITABLE GUIDELINES OR DEVICES SHALL BE USED TO ASSURE CUTTING A NEAT, STRAIGHT LINE AS SHOWN ON THE PLANS. CARE SHALL BE TAKEN BY THE CONTRACTOR AS NOT TO DAMAGE THE REMAINING PAVEMENT DIRECTLY ADJACENT TO THE PAVEMENT TO BE REMOVED. ANY DAMAGE TO THE EXISTING PAVEMENT RESULTING FROM PAVEMENT REMOVAL OPERATIONS SHALL BE REPAIRED TO THE SATISFACTION OF THE ENGINEER.
11. THE CONTRACTOR WILL NOT BE ALLOWED TO SET UP A YARD OR FIELD OFFICE ON STATE OR VILLAGE PROPERTY WITHOUT WRITTEN PERMISSION FROM THE ENGINEER.
12. A BUTT JOINT WILL BE INSTALLED AT THE ENDS OF ALL RESURFACING (WHERE RESURFACING MEETS EXISTING PAVEMENT) IN ACCORDANCE WITH THE "BUTT JOINT AND HMA TAPER DETAILS" SHEET INCLUDED IN THE PLANS, UNLESS OTHERWISE SPECIFIED.
13. WHEN MILLED PAVEMENT IS OPEN TO TRAFFIC THE MAXIMUM GRADE DIFFERENTIAL BETWEEN PASSES OF THE MILLING MACHINE SHALL NOT EXCEED 1½ INCHES (40 MM) WHERE THE SPEED LIMIT IS 45 MPH (80 KM/H) OR LESS AND 1 INCH (25 MM) WHERE THE SPEED LIMIT IS GREATER THAN 45 MPH (80 KM/H). WITH WRITTEN APPROVAL FROM THE ENGINEER, A MAXIMUM GRADE DIFFERENTIAL OF 3 INCHES (75 MM) MAY BE ALLOWED IF THE EDGE OF THE MILLING IS SLOPED A MINIMUM 1:3 (V:H).
14. THE CONTRACTOR WILL BE REQUIRED TO SCHEDULE THEIR OPERATIONS SO THAT NO SECTIONS OF PAVEMENT ALONG THE CENTERLINE WILL HAVE A COLD JOINT OVERNIGHT.
15. LOCATIONS OF PATCHES ON PLANS ARE APPROXIMATE. EXACT LOCATIONS WILL BE DETERMINED IN THE FIELD BY ENGINEER. PATCHES LOCATED WITHIN THE THROUGH LANES SHALL BE MADE ACCESSIBLE TO TRAFFIC AT THE END OF EACH WORK DAY.
16. PAVEMENT PATCHING SHALL BE STAGED TO MAINTAIN TWO-WAY TRAFFIC AT ALL TIMES.
17. THE CONTRACTOR SHALL MAINTAIN ACCESS FOR EMERGENCY VEHICLES AND GARBAGE TRUCKS AT ALL TIMES. IF THE GARBAGE TRUCKS ARE NOT ABLE TO HAVE ACCESS TO ALL OF THE PROPERTIES WITHIN THE PROJECT LIMITS, THEN THE CONTRACTOR SHALL PLACE ANY GARBAGE THAT IS AFFECTED IN A LOCATION WHERE THE GARBAGE TRUCKS CAN PICK IT UP. THE CONTRACTOR SHALL RETURN THE GARBAGE CANS TO THE PARKWAY OF THE RESPECTIVE PROPERTY BY THE END OF THE DAY.
18. THE CONTRACTOR SHALL TAKE PRECAUTIONS SO AS NOT TO DAMAGE EXISTING SIDEWALKS, DRIVEWAYS, AND PAVEMENTS OUTSIDE THE LIMITS OF RESTORATION. THE GENERAL LIMITS OF RESTORATION ARE SHOWN ON THE PLANS. THE ENGINEER WILL MARK OUT THE EXACT LIMITS OF REMOVAL FOR THESE ITEMS PRIOR TO THE COMMENCEMENT OF WORK. THE CONTRACTOR SHALL RESTORE ANY DAMAGE TO SIDEWALKS, DRIVEWAYS, AND PAVEMENTS OUTSIDE OF THESE LIMITS TO THE SATISFACTION OF THE ENGINEER.
19. THE CONTRACTOR SHALL CONTACT THE D1 TRAFFIC CONTROL SUPERVISOR VIA EMAIL AT KALPANA.KANNAN-HOSADURGA@ILLINOIS.GOV A MINIMUM OF 72 HOURS IN ADVANCE OF BEGINNING WORK.
20. TWO (2) WEEKS PRIOR TO THE PLACEMENT OF PAVEMENT MARKINGS, THE ENGINEER SHALL CONTACT THE AREA TRAFFIC FIELD ENGINEER (EMAD ALHUSEINI VIA EMAIL AT EMAD.ALHUSSEINI@ILLINOIS.GOV

INDEX OF SHEETS

SHEET NO.	DESCRIPTION
1	COVER SHEET
2	INDEX OF SHEETS, GENERAL NOTES AND IDOT HIGHWAY STANDARDS
3	M,W,R,D,G,C. GENERAL NOTES
4	M,W,R,D,G,C. ROUTE OUTLET MAP
5-8	SUMMARY OF QUANTITIES
9	EXISTING AND PROPOSED TYPICAL SECTIONS
10-12	RESURFACING AND PAVEMENT MARKING PLAN
13	EROSION CONTROL PLAN
14	JOB SPECIFIC DETAILS
15	PCC SIDEWALK CONSTRUCTION DETAIL - COOK COUNTY
16	ADA RAMP DETAILS (5TH AVENUE AND HARRISON STREET)
17	DETAILS FOR FRAME AND LIDS ADJUSTMENT WITH MILLING (BD-8)
18	BUTT JOINT AND HMA TAPER DETAILS (BD-32)
19	TRAFFIC CONTROL AND PROTECTION FOR SIDE ROADS, INTERSECTIONS, AND DRIVEWAYS (TC-10)
20	DISTRICT ONE TYPICAL PAVEMENT MARKINGS (TC-13)
21	SHORT TERM PAVEMENT MARKING LETTERS AND SYMBOLS (TC-16)
22	ARTERIAL ROAD INFORMATION SIGN (TC-22)

IDOT HIGHWAY STANDARDS

STANDARD NO.	DESCRIPTION
000001-08	STANDARD SYMBOLS, ABBREVIATIONS AND PATTERNS
280001-07	TEMPORARY EROSION CONTROL SYSTEMS
424001-12	PERPENDICULAR CURB RAMPS FOR SIDEWALKS
442101-09	CLASS B PATCHES
604001-05	FRAME AND LIDS, TYPE 1
701006-05	OFF ROAD OPERATION MARKERS, 2L, 2W 15' (4.5m) TO 24" (600mm) FROM PAVEMENT EDGE
701301-04	LANE CLOSURE, 2-LANE, 2-WAY, SHORT-TIME OPERATIONS
701311-03	LANE CLOSURE, 2-LANE, 2-WAY, MOVING OPERATIONS, DAY ONLY
701501-06	URBAN LANE CLOSURE, 2-LANE, 2-WAY, UNDIVIDED
701701-10	URBAN LANE CLOSURE, MULTILANE INTERSECTION
701801-06	SIDEWALK, CORNER, OR CROSSWALK CLOSURE
701901-10	TRAFFIC CONTROL DEVICES
780001-05	TYPICAL PAVEMENT MARKINGS

Drawing file: W:\projects_by_village\Maywood\56524159 - 5th ave resurfacing\index.dwg Sep 29, 2025 - 12:07pm



◆ Civil Engineers

◆ Municipal Consultants

◆ Established 1911

9938 Roosevelt Road

Westchester, IL 60154-2780

Phone: 708-646-0300

www.hancock.com

DESIGNED -	AB	REVISED -	9-16-25
DRAWN -	DMM, SA, LW, AJ	REVISED -	8-25-25
CHECKED -	XX	REVISED -	8-15-25
DATE -	5-28-25	REVISED -	7-15-25

STATE OF ILLINOIS

DEPARTMENT OF TRANSPORTATION

INDEX OF SHEETS, GENERAL NOTES, AND IDOT HIGHWAY STANDARDS

SCALE: NONE SHEET NO. 1 OF 1 SHEETS STA. - TO STA. -

MUN RTE.	SECTION	COUNTY	TOTAL SHEETS	SHEET NO.
2742	24-00145-00-RS	COOK	22	2
FIELD BOOK NO.:		CONTRACT NO. 61L75		
FED. ROAD DIST. NO. 1 ILLINOIS		FED. AID PROJECT		

Drawing file: W:\projects_by_village\Maywood\66624159 - 5th ave resurfacing\MWMD GENERAL NOTES.dwg Sep 16, 2025 -- 8:19am

M.W.R.D.G.C. GENERAL NOTES

A. REFERENCED SPECIFICATIONS

1. ALL CONSTRUCTION SHALL BE IN ACCORDANCE WITH THE APPLICABLE SECTIONS OF THE FOLLOWING, EXCEPT AS MODIFIED HEREIN OR ON THE PLANS:
- * STANDARD SPECIFICATIONS FOR ROAD AND BRIDGE CONSTRUCTION (LATEST EDITION), BY THE ILLINOIS DEPARTMENT OF TRANSPORTATION (IDOT SS) FOR ALL IMPROVEMENTS EXCEPT SANITARY SEWER AND WATER MAIN CONSTRUCTION;
 - * STANDARD SPECIFICATIONS FOR WATER AND SEWER MAIN CONSTRUCTION IN ILLINOIS, LATEST EDITION (SSWS) FOR SANITARY SEWER AND WATER MAIN CONSTRUCTION;
 - * VILLAGE OF MAYWOOD MUNICIPAL CODE;
 - * THE METROPOLITAN WATER RECLAMATION DISTRICT OF GREATER CHICAGO (MWRD) WATERSHED MANAGEMENT ORDINANCE AND TECHNICAL GUIDANCE MANUAL;
 - * IN CASE OF CONFLICT BETWEEN THE APPLICABLE ORDINANCES NOTED, THE MORE STRINGENT SHALL TAKE PRECEDENCE AND SHALL CONTROL ALL CONSTRUCTION.

B. NOTIFICATIONS

1. THE MWRD LOCAL SEWER SYSTEMS SECTION FIELD OFFICE MUST BE NOTIFIED AT LEAST TWO (2) WORKING DAYS PRIOR TO THE COMMENCEMENT OF ANY WORK (CALL 708-588-4055 OR SEND EMAIL NOTIFICATION WITH PROJECT NAME, LOCATION AND PERMIT NUMBER TO WMOJOBSTART@MWRD.ORG).
2. THE VILLAGE OF MAYWOOD ENGINEERING DEPARTMENT AND PUBLIC MUST BE NOTIFIED AT LEAST 24 HOURS PRIOR TO THE START OF CONSTRUCTION AND PRIOR TO EACH PHASE OF WORK. CONTRACTOR SHALL DETERMINE ITEMS REQUIRING INSPECTION PRIOR TO START OF CONSTRUCTION OR EACH WORK PHASE.
3. THE CONTRACTOR SHALL NOTIFY ALL UTILITY COMPANIES PRIOR TO BEGINNING CONSTRUCTION FOR THE EXACT LOCATIONS OF UTILITIES AND FOR THEIR PROTECTION DURING CONSTRUCTION. IF EXISTING UTILITIES ARE ENCOUNTERED THAT CONFLICT IN LOCATION WITH NEW CONSTRUCTION, IMMEDIATELY NOTIFY THE ENGINEER SO THAT THE CONFLICT CAN BE RESOLVED. CALL J.U.L.I.E. AT 1-800-892-0123.

C. GENERAL NOTES

1. ALL ELEVATIONS SHOWN ON PLANS REFERENCE THE NORTH AMERICAN VERTICAL DATUM OF 1988 (NAVD88). CONVERSION FACTOR IS 0 FT.
2. MWRD, THE MUNICIPALITY AND THE OWNER OR OWNER'S REPRESENTATIVE SHALL HAVE THE AUTHORITY TO INSPECT, APPROVE, AND REJECT THE CONSTRUCTION IMPROVEMENTS.
3. THE CONTRACTOR(S) SHALL INDEMNIFY THE OWNER, ENGINEER, MUNICIPALITY, MWRD, AND THEIR AGENTS, ETC., FROM ALL LIABILITY INVOLVED WITH THE CONSTRUCTION, INSTALLATION, OR TESTING OF THIS WORK ON THE PROJECT.
4. THE PROPOSED IMPROVEMENTS MUST BE CONSTRUCTED IN ACCORDANCE WITH THE ENGINEERING PLANS AS APPROVED BY MWRD AND THE MUNICIPALITY UNLESS CHANGES ARE APPROVED BY MWRD, THE MUNICIPALITY, OR AUTHORIZED AGENT. THE CONSTRUCTION DETAILS, AS PRESENTED ON THE PLANS, MUST BE FOLLOWED. PROPER CONSTRUCTION TECHNIQUES MUST BE FOLLOWED ON THE IMPROVEMENTS INDICATED ON THE PLANS.
5. THE LOCATION OF VARIOUS UNDERGROUND UTILITIES WHICH ARE SHOWN ON THE PLANS ARE FOR INFORMATION ONLY AND REPRESENT THE BEST KNOWLEDGE OF THE ENGINEER. VERIFY LOCATIONS AND ELEVATIONS PRIOR TO BEGINNING THE CONSTRUCTION OPERATIONS.
6. ANY EXISTING PAVEMENT, SIDEWALK, DRIVEWAY, ETC., DAMAGED DURING CONSTRUCTION OPERATIONS AND NOT CALLED FOR TO BE REMOVED SHALL BE REPLACED AT THE EXPENSE OF THE CONTRACTOR.
7. MATERIAL AND COMPACTION TESTING SHALL BE PERFORMED IN ACCORDANCE WITH THE REQUIREMENTS OF THE MUNICIPALITY, MWRD, AND OWNER.
8. THE UNDERGROUND CONTRACTOR SHALL MAKE ALL NECESSARY ARRANGEMENTS TO NOTIFY ALL INSPECTION AGENCIES.
9. ALL NEW AND EXISTING UTILITY STRUCTURES ON SITE AND IN AREAS DISTURBED DURING CONSTRUCTION SHALL BE ADJUSTED TO FINISH GRADE PRIOR TO FINAL INSPECTION.
10. RECORD DRAWINGS SHALL BE KEPT BY THE CONTRACTOR AND SUBMITTED TO THE ENGINEER AS SOON AS UNDERGROUND IMPROVEMENTS ARE COMPLETED. FINAL PAYMENTS TO THE CONTRACTOR SHALL BE HELD UNTIL THEY ARE RECEIVED. ANY CHANGES IN LENGTH, LOCATION OR ALIGNMENT SHALL BE SHOWN IN RED. ALL WYES OR BENDS SHALL BE LOCATED FROM THE DOWNSTREAM MANHOLE. ALL VALVES, B-BOXES, TEES OR BENDS SHALL BE TIED TO A FIRE HYDRANT.

D. SANITARY SEWER

1. THE CONTRACTOR SHALL TAKE MEASURES TO PREVENT ANY POLLUTED WATER, SUCH AS GROUND AND SURFACE WATER, FROM ENTERING THE EXISTING SANITARY SEWERS.
2. A WATER-TIGHT PLUG SHALL BE INSTALLED IN THE DOWNSTREAM SEWER PIPE AT THE POINT OF SEWER CONNECTION PRIOR TO COMMENCING ANY SEWER CONSTRUCTION. THE PLUG SHALL REMAIN IN PLACE UNTIL REMOVAL IS AUTHORIZED BY THE MUNICIPALITY AND/OR MWRD AFTER THE SEWERS HAVE BEEN TESTED AND ACCEPTED.
3. DISCHARGING ANY UNPOLLUTED WATER INTO THE SANITARY SEWER SYSTEM FOR THE PURPOSE OF SEWER FLUSHING OF LINES FOR THE DEFLECTION TEST SHALL BE PROHIBITED WITHOUT PRIOR APPROVAL FROM THE MUNICIPALITY OR MWRD.
4. ALL SANITARY SEWER CONSTRUCTION SHALL BE IN ACCORDANCE WITH THE STANDARD SPECIFICATIONS FOR WATER AND SEWER MAIN CONSTRUCTION IN ILLINOIS (LATEST EDITION).
5. ALL FLOOR DRAINS SHALL DISCHARGE TO THE SANITARY SEWER SYSTEM.
6. ALL DOWNSPOUTS AND FOOTING DRAINS SHALL DISCHARGE TO THE STORM SEWER SYSTEM.
7. ALL SANITARY SEWER PIPE MATERIALS AND JOINTS (AND STORM SEWER PIPE MATERIALS AND JOINTS IN A COMBINED SEWER AREA) SHALL CONFORM TO THE FOLLOWING:

PIPE MATERIAL	PIPE SPECIFICATIONS	JOINT SPECIFICATIONS
VITRIFIED CLAY PIPE	ASTM C-700	ASTM C-425
REINFORCED CONCRETE SEWER PIPE	ASTM C-76	ASTM C-443
CAST IRON SOIL PIPE	ASTM A-74	ASTM C-564
DUCTILE IRON PIPE	ANSI A21.51	ANSI A21.11
POLYVINYL CHLORIDE (PVC) PIPE 6-INCH TO 15-INCH DIAMETER SDR 26 18-INCH TO 27-INCH DIAMETER F/DY=46	ASTM D-3034 ASTM F-679	ASTM D-3212 ASTM D-3212
HIGH DENSITY POLYETHYLENE (HDPE)	ASTM D-3350 ASTM D-3035	ASTM D-3261,F-2620 (HEAT FUSION) ASTM D-3212,F-477 (GASKETED)
WATER MAIN QUALITY PVC 4-INCH TO 36-INCH 4-INCH TO 12-INCH 14-INCH TO 48-INCH	ASTM D-2241 AWWA C900 AWWA C905	ASTM D-3139 ASTM D-3139 ASTM D-3139

THE FOLLOWING MATERIALS ARE ALLOWED ON A QUALIFIED BASIS SUBJECT TO DISTRICT REVIEW AND APPROVAL PRIOR TO PERMIT ISSUANCE. A SPECIAL CONDITION WILL BE ADDED TO THE PERMIT WHEN THE PIPE MATERIAL BELOW IS USED FOR SEWER CONSTRUCTION OR A CONNECTION IS MADE.

PIPE MATERIAL	PIPE SPECIFICATIONS	JOINT SPECIFICATIONS
POLYPROPYLENE (PP) PIPE		
12-INCH TO 24-INCH DOUBLE WALL	ASTM F-2736	D-3212, F-477
30-INCH TO 60-INCH TRIPLE WALL	ASTM F-2764	D3212, F-477

8. ALL SANITARY SEWER CONSTRUCTION (AND STORM SEWER CONSTRUCTION IN COMBINED SEWER AREAS), REQUIRES STONE BEDDING WITH STONE ¼ " TO 1" IN SIZE, WITH MINIMUM BEDDING THICKNESS EQUAL TO ¼ THE OUTSIDE DIAMETER OF THE SEWER PIPE, BUT NOT LESS THAN FOUR (4) INCHES NOR MORE THAN EIGHT (8) INCHES. MATERIAL SHALL BE CA-7, CA-11 OR CA-13 AND SHALL BE EXTENDED AT LEAST 12" ABOVE THE TOP OF THE PIPE WHEN USING PVC.
9. NON-SHEAR FLEXIBLE-TYPE COUPLINGS SHALL BE USED IN THE CONNECTION OF SEWER PIPES OF DISSIMILAR PIPE MATERIALS.
10. ALL MANHOLES SHALL BE PROVIDED WITH BOLTED, WATERTIGHT COVERS. SANITARY LIDS SHALL BE CONSTRUCTED WITH A CONCEALED PICKHOLE AND WATERTIGHT GASKET WITH THE WORD "SANITARY" CAST INTO THE LID.
11. WHEN CONNECTING TO AN EXISTING SEWER MAIN BY MEANS OTHER THAN AN EXISTING WYE, TEE, OR AN EXISTING MANHOLE, ONE OF THE FOLLOWING METHODS SHALL BE USED:
- a) A CIRCULAR SAW-CUT OF SEWER MAIN BY PROPER TOOLS ("SEWER-TAP" MACHINE) AND PROPER INSTALLATION OF HUBWYE SADDLE OR HUB-TEE SADDLE.
 - b) REMOVE AN ENTIRE SECTION OF PIPE (BREAKING ONLY THE TOP OF ONE BELL) AND REPLACE WITH A WYE OR TEE BRANCH SECTION.
 - c) WITH PIPE CUTTER, NEATLY AND ACCURATELY CUT OUT DESIRED LENGTH OF PIPE FOR INSERTION OF PROPER FITTING, USING "BAND SEAL" COUPLINGS TO HOLD IT FIRMLY IN PLACE.
12. WHENEVER A SANITARY/COMBINED SEWER CROSSES UNDER A WATERMAIN, THE MINIMUM VERTICAL DISTANCE FROM THE TOP OF THE SEWER TO THE BOTTOM OF THE WATERMAIN SHALL BE 18 INCHES. FURTHERMORE, A MINIMUM HORIZONTAL DISTANCE OF 10 FEET BETWEEN SANITARY/COMBINED SEWERS AND WATERMAINS SHALL BE MAINTAINED UNLESS: THE SEWER IS LAID IN A SEPARATE TRENCH, KEEPING A MINIMUM 18" VERTICAL SEPARATION; OR THE SEWER IS LAID IN THE SAME TRENCH WITH THE WATERMAIN LOCATED AT THE OPPOSITE SIDE ON A BENCH OF UNDISTURBED EARTH, KEEPING A MINIMUM 18" VERTICAL SEPARATION. IF EITHER THE VERTICAL OR HORIZONTAL DISTANCES DESCRIBED CANNOT BE MAINTAINED, OR THE SEWER CROSSES ABOVE THE WATER MAIN, THE SEWER SHALL BE CONSTRUCTED TO WATER MAIN STANDARDS OR IT SHALL BE ENCASED WITH A WATER MAIN QUALITY CARRIER PIPE WITH THE ENDS SEALED.
13. ALL EXISTING SEPTIC SYSTEMS SHALL BE ABANDONED. ABANDONED TANKS SHALL BE FILLED WITH GRANULAR MATERIAL OR REMOVED.
14. ALL SANITARY MANHOLES, (AND STORM MANHOLES IN COMBINED SEWER AREAS), SHALL HAVE A MINIMUM INSIDE DIAMETER OF 48 INCHES, AND SHALL BE CAST IN PLACE OR PRE-CAST REINFORCED CONCRETE.
15. ALL SANITARY MANHOLES, (AND STORM MANHOLES IN COMBINED SEWER AREAS), SHALL HAVE PRECAST "RUBBER BOOTS" THAT CONFORM TO ASTM C-923 FOR ALL PIPE CONNECTIONS. PRECAST SECTIONS SHALL CONSIST OF MODIFIED GROOVE TONGUE AND RUBBER GASKET TYPE JOINTS.
16. ALL ABANDONED SANITARY SEWERS SHALL BE PLUGGED AT BOTH ENDS WITH AT LEAST 2 FEET LONG NON-SHRINK CONCRETE OR MORTAR PLUG.
17. EXCEPT FOR FOUNDATION/FOOTING DRAINS PROVIDED TO PROTECT BUILDINGS, OR PERFORATED PIPES ASSOCIATED WITH VOLUME CONTROL FACILITIES, DRAIN TILES/FIELD TILES/UNDERDRAINS/PERFORATED PIPES ARE NOT ALLOWED TO BE CONNECTED TO OR TRIBUTARY TO COMBINED SEWERS, SANITARY SEWERS, OR STORM SEWERS TRIBUTARY TO COMBINED SEWERS IN COMBINED SEWER AREAS. CONSTRUCTION OF NEW FACILITIES OF THIS TYPE IS PROHIBITED; AND ALL EXISTING DRAIN TILES AND PERFORATED PIPES ENCOUNTERED WITHIN THE PROJECT AREA SHALL BE PLUGGED OR REMOVED, AND SHALL NOT BE CONNECTED TO COMBINED SEWERS, SANITARY SEWERS, OR STORM SEWERS TRIBUTARY TO COMBINED SEWERS.
18. A BACKFLOW PREVENTER IS REQUIRED FOR ALL DETENTION BASINS TRIBUTARY TO COMBINED SEWERS. REQUIRED BACKFLOW PREVENTERS SHALL BE INSPECTED AND EXERCISED ANNUALLY BY THE PROPERTY OWNER TO ENSURE PROPER OPERATION, AND ANY NECESSARY MAINTENANCES SHALL BE PERFORMED TO ENSURE FUNCTIONALITY. IN THE EVENT OF A SEWER SURCHARGE INTO AN OPEN DETENTION BASIN TRIBUTARY TO COMBINED SEWERS, THE PERMITTEE SHALL ENSURE THAT CLEAN UP AND WASH OUT OF SEWAGE TAKES PLACE WITHIN 48 HOURS OF THE STORM EVENT.

E. EROSION AND SEDIMENT CONTROL

1. THE CONTRACTOR SHALL INSTALL THE EROSION AND SEDIMENT CONTROL DEVICES AS SHOWN ON THE APPROVED EROSION AND SEDIMENT CONTROL PLAN.
2. EROSION AND SEDIMENT CONTROL PRACTICES SHALL BE FUNCTIONAL PRIOR TO HYDROLOGIC DISTURBANCE OF THE SITE.
3. ALL DESIGN CRITERIA, SPECIFICATIONS, AND INSTALLATION OF EROSION AND SEDIMENT CONTROL PRACTICES SHALL BE IN ACCORDANCE WITH THE ILLINOIS URBAN MANUAL.
4. A COPY OF THE APPROVED EROSION AND SEDIMENT CONTROL PLAN SHALL BE MAINTAINED ON THE SITE AT ALL TIMES.
5. INSPECTIONS AND DOCUMENTATION SHALL BE PERFORMED, AT A MINIMUM:
- a) UPON COMPLETION OF INITIAL EROSION AND SEDIMENT CONTROL MEASURES, PRIOR TO ANY SOIL DISTURBANCE.
 - b) ONCE EVERY SEVEN (7) CALENDAR DAYS AND WITHIN 24 HOURS OF THE END OF A STORM EVENT WITH GREATER THAN 0.5 INCH OF RAINFALL OR LIQUID EQUIVALENT PRECIPITATION.
6. SOIL DISTURBANCE SHALL BE CONDUCTED IN SUCH A MANNER AS TO MINIMIZE EROSION. IF STRIPPING, CLEARING, GRADING, OR LANDSCAPING ARE TO BE DONE IN PHASES, THE CO-PERMITTEE SHALL PLAN FOR APPROPRIATE SOIL EROSION AND SEDIMENT CONTROL MEASURES.
7. A STABILIZED MAT OF CRUSHED STONE MEETING THE STANDARDS OF THE ILLINOIS URBAN MANUAL SHALL BE INSTALLED AT ANY POINT WHERE TRAFFIC WILL BE ENTERING OR LEAVING A CONSTRUCTION SITE. SEDIMENT OR SOIL REACHING AN IMPROVED PUBLIC RIGHT-OF-WAY, STREET, ALLEY OR PARKING AREA SHALL BE REMOVED BY SCRAPING OR STREET CLEANING AS ACCUMULATIONS WARRANT AND TRANSPORTED TO A CONTROLLED SEDIMENT DISPOSAL AREA.
8. CONCRETE WASHOUT FACILITIES SHALL BE CONSTRUCTED IN ACCORDANCE WITH THE ILLINOIS URBAN MANUAL AND SHALL BE INSTALLED PRIOR TO ANY ON SITE CONSTRUCTION ACTIVITIES INVOLVING CONCRETE.
9. MORTAR WASHOUT FACILITIES SHALL BE CONSTRUCTED IN ADDITION TO CONCRETE WASHOUT FACILITIES FOR ANY BRICK AND MORTAR BUILDING ENVELOPE CONSTRUCTION ACTIVITIES.
10. TEMPORARY DIVERSIONS SHALL BE CONSTRUCTED AS NECESSARY TO DIRECT ALL RUNOFF FROM HYDROLOGICALLY DISTURBED AREAS TO AN APPROPRIATE SEDIMENT TRAP OR BASIN. VOLUME CONTROL FACILITIES SHALL NOT BE USED AS TEMPORARY SEDIMENT BASINS.
11. DISTURBED AREAS OF THE SITE WHERE CONSTRUCTION ACTIVITIES HAVE TEMPORARILY OR PERMANENTLY CEASED SHALL BE STABILIZED WITH TEMPORARY OR PERMANENT MEASURES WITHIN SEVEN (7) DAYS.
12. ALL FLOOD PROTECTION AREAS AND VOLUME CONTROL FACILITIES SHALL, AT A MINIMUM, BE PROTECTED WITH A DOUBLE-ROW OF SILT FENCE (OR EQUIVALENT).
13. VOLUME CONTROL FACILITIES SHALL NOT BE CONSTRUCTED UNTIL ALL OF THE CONTRIBUTING DRAINAGE AREA HAS BEEN STABILIZED.
14. SOIL STOCKPILES SHALL, AT A MINIMUM, BE PROTECTED WITH PERIMETER SEDIMENT CONTROLS. SOIL STOCKPILES SHALL NOT BE PLACED IN FLOOD PROTECTION AREAS OR THEIR BUFFERS.
15. EARTHEN EMBANKMENT SIDE SLOPES SHALL BE STABILIZED WITH APPROPRIATE EROSION CONTROL BLANKET.
16. STORM SEWERS THAT ARE OR WILL BE FUNCTIONING DURING CONSTRUCTION SHALL BE PROTECTED BY APPROPRIATE SEDIMENT CONTROL MEASURES.
17. THE CONTRACTOR SHALL EITHER REMOVE OR REPLACE ANY EXISTING DRAIN TILES AND INCORPORATE THEM INTO THE DRAINAGE PLAN FOR THE DEVELOPMENT. DRAIN TILES CANNOT BE TRIBUTARY TO A SANITARY OR COMBINED SEWER. DRAIN TILES ALLOWED IN COMBINED SEWER AREA FOR GREEN INFRASTRUCTURE PRACTICES.
18. IF DEWATERING SERVICES ARE USED, ADJOINING PROPERTIES AND DISCHARGE LOCATIONS SHALL BE PROTECTED FROM EROSION AND SEDIMENTATION. DEWATERING SYSTEMS SHOULD BE INSPECTED DAILY DURING OPERATIONAL PERIODS. THE SITE INSPECTOR MUST BE PRESENT AT THE COMMENCEMENT OF DEWATERING ACTIVITIES.
19. THE CONTRCTOR SHALL BE RESPONSIBLE FOR TRENCH DEWATERING AND EXCAVATION FOR THE INSTALLATION OF SANITARY SEWERS, STORM SEWERS, WATERMAINS AS WELL AS THEIR SERVICES AND OTHER APPURTENANCES. ANY TRENCH DEWATERING, WHICH CONTAINS SEDIMENT SHALL PASS THROUGH A SEDIMENT SETTLING POND OR EQUALLY EFFECTIVE SEDIMENT CONTROL DEVICE. ALTERNATIVES MAY INCLUDE DEWATERING INTO A SUMP PIT, FILTER BAG OR EXISTING VEGETATED UPSLOPE AREA. SEDIMENT LADEN WATERS SHALL NOT BE DISCHARGE TO WATERWAYS, FLOOD PROTECTION AREAS OR THE COMBINED SEWER SYSTEM.
20. ALL PERMANENT EROSION CONTROL PRACTICES SHALL BE INITIATED WITHIN SEVEN (7) DAYS FOLLOWING THE COMPLETION OF SOIL DISTURBING ACTIVITIES.
21. ALL EROSION AND SEDIMENT CONTROL MEASURES SHALL BE MAINTAINED AND REPAIRED AS NEEDED ON A YEAR-ROUND BASIS DURING CONSTRUCTION AND ANY PERIODS OF CONSTRUCTION SHUTDOWN UNTIL PERMANENT STABILIZATION IS ACHIEVED.
22. ALL TEMPORARY EROSION AND SEDIMENT CONTROL MEASURES SHALL BE REMOVED WITHIN THIRTY (30) DAYS AFTER PERMANENT SITE STABILIZATION.
23. THE EROSION AND SEDIMENT CONTROL MEASURES SHOWN ON THE PLANS ARE THE MINIMUM REQUIREMENTS. ADDITIONAL MEASURES MAY BE REQUIRED, AS DIRECTED BY THE ENGINEER, SITE INSPECTOR, OR MWRD.



HANCOCK
ENGINEERING

100+ Years of
Experience

- ◆ Civil Engineers
- ◆ Municipal Consultants
- ◆ Established 1911

9933 Roosevelt Road
Westchester, IL 60154-2780
Phone: 708-865-0300
www.hancock.com

DESIGNED -	AB
DRAWN -	DMM, SA, LW, AJ
CHECKED -	XX
DATE -	5-28-25

REVISED -	9-16-25
REVISED -	8-25-25
REVISED -	8-15-25
REVISED -	7-15-25

STATE OF ILLINOIS
DEPARTMENT OF TRANSPORTATION

M.W.R.D.G.C. GENERAL NOTES

SCALE: - SHEET NO. 1 OF 1 SHEETS STA. - TO STA. -

MUN RTE.	SECTION	COUNTY	TOTAL SHEETS	SHEET NO.
2742	24-00145-00-RS	COOK	22	3
FIELD BOOK NO. :		CONTRACT NO. 61L75		
FED. ROAD DIST. NO. 1		ILLINOIS	FED. AID PROJECT	

E.H.E. PROJECT NO. 565-24-15901

Drawing file: W:\projects_by_village\Maywood\56524-159 - 5th ave resurfacing\01_COVER.dwg Sep 16, 2025 - 9:19am

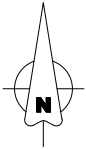

DISCHARGES TO DES PLAINES RIVER

- PROJECT LOCATION
ROUTE OUTLET MAP

PROJECT LOCATED IN
THE VILLAGE OF MAYWOOD

- MWRD INTERCEPTOR
- CONNECTION TO MWRD INTERCEPTOR
- VILLAGE OF MAYWOOD STORM RELIEF AND OVERFLOW SEWER

NOTE:
1. ALL SEWERS FROM PROJECT LOCATIONS TO DES PLAINES RIVER, MWRD INTERCEPTOR, OR TARP SYSTEM ARE OWNED AND MAINTAINED BY THE VILLAGE OF MAYWOOD.



HANCOCK
ENGINEERING

100+ Years of
Experience

- Civil Engineers
- Municipal Consultants
- Established 1911

9933 Roosevelt Road
Westchester, IL 60154-2780
Phone: 708-946-0300
www.hancock.com

DESIGNED -	AB	REVISED -	9-16-25
DRAWN -	DMM, SA, LW, AJ	REVISED -	8-25-25
CHECKED -	XX	REVISED -	8-15-25
DATE -	5-28-25	REVISED -	7-15-25

STATE OF ILLINOIS
DEPARTMENT OF TRANSPORTATION

M.W.R.D.G.C. ROUTE OUTLET MAP

SCALE: - SHEET NO. 1 OF 1 SHEETS STA. - TO STA. -

MUN. RTE.	SECTION	COUNTY	TOTAL SHEETS	SHEET NO.
2742	24-00145-00-RS	COOK	22	4
FIELD BOOK NO. :		CONTRACT NO. 61L75		
FED. ROAD DIST. NO. 1		ILLINOIS	FED. AID PROJECT	

Drawing file: W:\projects_by_village\Worwood\60241129 - 5th ave resurfacing\Summary of Quantities.dwg Sep 16, 2023 - 9:18am

SUMMARY OF QUANTITIES					Const. Type Code
					80% Federal/20% Local
SPLTY	Code No.	Description	Unit	Total Quantity	Resurfacing 005 Urban
*	20101100	TREE TRUNK PROTECTION	EACH	8	8
*	20101200	TREE ROOT PRUNING	EACH	8	8
	20800150	TRENCH BACKFILL	CU YD	60	60
	21101615	TOPSOIL FURNISH AND PLACE, 4"	SQ YD	200	200
	25200110	SODDING, SALT TOLERANT	SQ YD	200	200
	25200200	SUPPLEMENTAL WATERING	UNIT	10	10
	28000510	INLET FILTERS	EACH	18	18
	40600290	BITUMINOUS MATERIALS (TACK COAT)	POUND	3100	3100
	40600370	LONGITUDINAL JOINT SEALANT	FOOT	975	975
	40600400	MIXTURE FOR CRACKS, JOINTS, AND FLANGEWAYS	TON	20	20
	40600982	HOT-MIX ASPHALT SURFACE REMOVAL - BUTT JOINT	SQ YD	35	35
	40602978	HOT-MIX ASPHALT BINDER COURSE, IL-9.5,N50	TON	400	400
	40604060	HOT-MIX ASPHALT SURFACE COURSE, IL-9.5, MIX "D", N50	TON	525	525
	42101300	PROTECTIVE COAT	SQ YD	160	160
	42300300	PORTLAND CEMENT CONCRETE DRIVEWAY PAVEMENT, 7 INCH	SQ YD	10	10
	42400200	PORTLAND CEMENT CONCRETE SIDEWALK 5 INCH	SQ FT	1600	1600



100 Years of
Excellence
◆ CMI Engineers
◆ Municipal Consultants
◆ Established 1911

7733 Roosevelt Road
Westchester, IL 60154-2780
Phone: 708-445-0200
www.hancockeng.com

DESIGNED -	AB	REVISED -	9-16-25
DRAWN -	DMM, SA, LW, AJ	REVISED -	8-25-25
CHECKED -	XX	REVISED -	8-15-25
DATE -	5-28-25	REVISED -	7-15-25

STATE OF ILLINOIS
DEPARTMENT OF TRANSPORTATION

SUMMARY OF QUANTITIES

SCALE: -

SHEET NO. 1 OF 4 SHEETS

STA. -

TO STA. -

MUN RTE.	SECTION	COUNTY	TOTAL SHEETS	SHEET NO.
2742	24-00145-00-RS	COOK	22	5
FIELD BOOK NO. :		CONTRACT NO. 61L75		
FED. ROAD DIST. NO. 1 ILLINOIS FED. AID PROJECT				

E.H.E. PROJECT NO. 565-24-15901

Drawing file: W:\Projects_Ly_Village\Waywood\56524199 - 500 ave resurfacing\Summary of Quantities.dwg Sep 16, 2025 - 9:19am

SUMMARY OF QUANTITIES					Const. Type Code
					80% Federal/20% Local
SPLTY	Code No.	Description	Unit	Total Quantity	Resurfacing 005 Urban
	42400410	PORTLAND CEMENT CONCRETE SIDEWALK 8 INCH	SQ FT	500	500
	44000200	DRIVEWAY PAVEMENT REMOVAL	SQ YD	10	10
	44000500	COMBINATION CURB AND GUTTER REMOVAL	FOOT	150	150
	44000600	SIDEWALK REMOVAL	SQ FT	2150	2150
	44200929	CLASS B PATCHES, TYPE I, 8 INCH	SQ YD	120	120
	44200934	CLASS B PATCHES, TYPE II, 8 INCH	SQ YD	235	235
	44200942	CLASS B PATCHES, TYPE III, 8 INCH	SQ YD	235	235
	44200944	CLASS B PATCHES, TYPE IV, 8 INCH	SQ YD	120	120
	60266100	VALVE VAULTS TO BE RECONSTRUCTED	EACH	1	1
	60300305	FRAMES AND LIDS TO BE ADJUSTED	EACH	2	2
	60406000	FRAMES AND LIDS, TYPE 1, OPEN LID	EACH	1	1
	60406100	FRAMES AND LIDS, TYPE 1, CLOSED LID	EACH	1	1
	60604100	COMBINATION CONCRETE CURB AND GUTTER, TYPE B-6.12 (MODIFIED)	FOOT	150	150
	67100100	MOBILIZATION	LSUM	1	1
	70102620	TRAFFIC CONTROL AND PROTECTION, STANDARD 701501	LSUM	1	1
	70102635	TRAFFIC CONTROL AND PROTECTION, STANDARD 701701	LSUM	1	1



9933 Roosevelt Road
Westchester, IL 60154-2780
Phone: 708-565-0300
www.hancockeng.com

- ◆ Civil Engineers
- ◆ Municipal Consultants
- ◆ Established 1911

DESIGNED -	AB	REVISED -	9-16-25
DRAWN -	DMM, SA, LW, AJ	REVISED -	8-25-25
CHECKED -	XX	REVISED -	8-15-25
DATE -	5-28-25	REVISED -	7-15-25

STATE OF ILLINOIS
DEPARTMENT OF TRANSPORTATION

SUMMARY OF QUANTITIES

SCALE: - SHEET NO. 2 OF 4 SHEETS STA. - TO STA. -

MUN RTE.	SECTION	COUNTY	TOTAL SHEETS	SHEET NO.
2742	24-00145-00-RS	COOK	22	6
FIELD BOOK NO.:		CONTRACT NO. 61L75		
FED. ROAD DIST. NO. 1		ILLINOIS FED. AID PROJECT		

E.H.E. PROJECT NO. 565-24-15901

Drawing file: W:\projects_by_village\Wynwood\56524159 - 5th ave resurfacing\Summary of Quantities.dwg Oct 02, 2025 - 7:31am

SUMMARY OF QUANTITIES					Const. Type Code
					80% Federal/20% Local
SPLTY	Code No.	Description	Unit	Total Quantity	Resurfacing 005 Urban
	70102640	TRAFFIC CONTROL AND PROTECTION, STANDARD 701801	LSUM	1	1
	70300100	SHORT TERM PAVEMENT MARKING	FOOT	1700	1700
	70300150	SHORT TERM PAVEMENT MARKING REMOVAL	SQ FT	575	575
	70307210	TEMPORARY PAVEMENT MARKING - LINE 24" - TYPE IV TAPE	FOOT	150	150
*	78000100	THERMOPLASTIC PAVEMENT MARKING - LETTERS AND SYMBOLS	SQ FT	40	40
*	78000200	THERMOPLASTIC PAVEMENT MARKING - LINE 4"	FOOT	3100	3100
*	78000400	THERMOPLASTIC PAVEMENT MARKING - LINE 6"	FOOT	900	900
*	78000600	THERMOPLASTIC PAVEMENT MARKING - LINE 12"	FOOT	20	20
*	78000650	THERMOPLASTIC PAVEMENT MARKING - LINE 24"	FOOT	150	150
	X0326806	WASHOUT BASIN	LSUM	1	1
	X4240800	DETECTABLE WARNINGS (SPECIAL)	SQ FT	60	60
	X4401198	HOT-MIX ASPHALT SURFACE REMOVAL, VARIABLE DEPTH	SQ YD	4600	4600
	X6020399	CONNECTION TO EXISTING MANHOLE	EACH	1	1
	X6030310	FRAMES AND LIDS TO BE ADJUSTED (SPECIAL)	EACH	11	11
	XX006448	PVC COMBINED SEWER PIPE REPLACEMENT, 10"	FOOT	60	60
	X7200061	TEMPORARY INFORMATION SIGNING	SQ FT	51.4	51.4



HANCOCK
ENGINEERING

100% Vision of
Excellence
◆ Civil Engineers
◆ Municipal Consultants
◆ Established 1911

7733 Rockwell Road
Waukegan, IL 60156-2780
Phone: 708-445-0330
www.hancockeng.com

DESIGNED -	AB	REVISED -	9-16-25
DRAWN -	DMM, SA, LW, AJ	REVISED -	8-25-25
CHECKED -	XX	REVISED -	8-15-25
DATE -	5-28-25	REVISED -	7-15-25

STATE OF ILLINOIS
DEPARTMENT OF TRANSPORTATION

SUMMARY OF QUANTITIES

SCALE:- SHEET NO. 3 OF 4 SHEETS STA. - TO STA. -

MUN RTE.	SECTION	COUNTY	TOTAL SHEETS	SHEET NO.
2742	24-00145-00-RS	COOK	22	7
FIELD BOOK NO. :		CONTRACT NO. 61L75		
FED. ROAD DIST. NO. 1 ILLINOIS FED. AID PROJECT				
E.H.E. PROJECT NO. 365-24-15901				

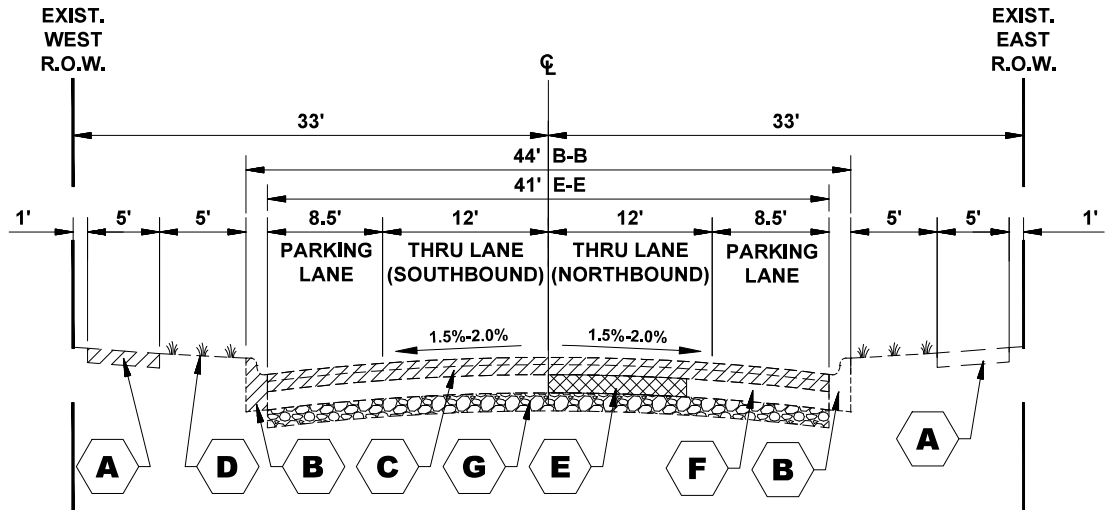

EXISTING TYPICAL SECTION

5TH AVENUE
(STATION 0+82 TO STATION 11+00)

TYPICAL SECTION LEGEND

EXISTING

- A** EXISTING PORTLAND CEMENT CONCRETE SIDEWALK, 5" AND INTERMITTENT REMOVAL (LOCATIONS TO BE DETERMINED BY ENGINEER)
- B** EXISTING COMBINATION CONCRETE CURB AND GUTTER, TYPE B-6.12 AND INTERMITTENT REMOVAL (LOCATIONS TO BE DETERMINED BY ENGINEER)
- C** HOT-MIX ASPHALT SURFACE REMOVAL, VARIABLE DEPTH
- D** GRASS PARKWAY
- E** REMOVAL FOR PAVEMENT PATCHING
- F** 8" PCC BASE COURSE
- G** AGGREGATE SUB BASE, 4"

LEGEND

- REMOVAL ITEMS
- REMOVAL FOR PAVEMENT PATCHING

HOT-MIX ASPHALT (HMA) MIXTURE REQUIREMENTS

MIXTURE TYPE	AIR VOIDS @ Ndes	QMP
5TH AVENUE		
HOT-MIX ASPHALT SURFACE COURSE, IL 9.5, MIX "D", N50, 2"	4% @ 50 Gyr.	LR 1030-2
HOT-MIX ASPHALT BINDER COURSE, IL-9.5, N50, 1.5"	4% @ 50 Gyr.	LR 1030-2
TEMPORARY PAVEMENT		
HOT-MIX ASPHALT SURFACE COURSE, IL-9.5, N50, 1.5"	4% @ 50 Gyr.	LR 1030-2
QMP DESIGNATION: QUALITY CONTROL/QUALITY ASSURANCE (QC/QA) PER LR 1030-2		

THE UNIT WEIGHT USED TO CALCULATE ALL HMA SURFACE MIXTURE QUANTITIES IS 112 LBS/SQ YD/IN.

THE "AC TYPE" FOR POLYMERIZED HMA MIXES SHALL BE "SBS/SBR PG 76-22" AND FOR NON-POLYMERIZED HMA THE "AC TYPE" SHALL BE "PG 64-22" UNLESS MODIFIED BY RECLAIMED MATERIALS SPECIFICATIONS.

THE LONGITUDINAL JOINT SEALANT SHALL BE PLACED ON THE HOT-MIX ASPHALT BINDER COURSE, IL-9.5, N50, 1.5"

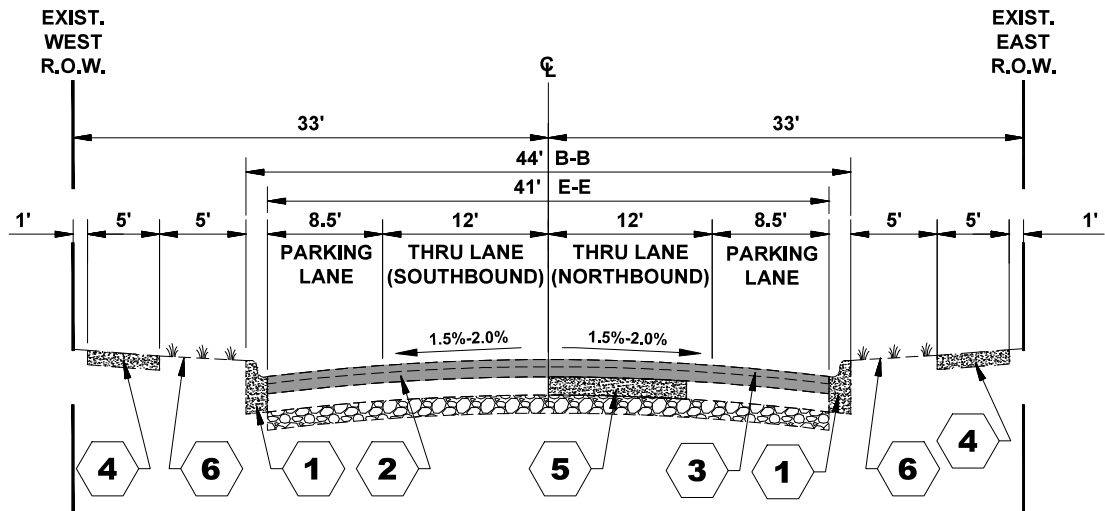

PROPOSED TYPICAL SECTION

5TH AVENUE
(STATION 0+82 TO STATION 11+00)

TYPICAL SECTION LEGEND

PROPOSED

- 1** PROPOSED INTERMITTENT COMBINATION CONCRETE CURB AND GUTTER, TYPE B-6.12 (MODIFIED) (LOCATIONS TO BE DETERMINED BY ENGINEER)
- 2** HOT-MIX ASPHALT BINDER COURSE, IL-9.5, N50
- 3** HOT-MIX ASPHALT SURFACE COURSE, IL-9.5, MIX D
- 4** PROPOSED INTERMITTENT PORTLAND CEMENT CONCRETE SIDEWALK, 5" (LOCATIONS TO BE DETERMINED BY ENGINEER)
- 5** CLASS B PATCHES, 8"
- 6** PROPOSED TOPSOIL FURNISH AND PLACE, 4" AND PROPOSED SODDING, SALT TOLERANT (LOCATIONS TO BE DETERMINED BY ENGINEER)

LEGEND

- PROPOSED CONCRETE
- PROPOSED HOT-MIX ASPHALT

Drawing file: W:\projects_by_village\Maywood\56524159 - 5th ave resurfacing\SITE\5th Ave Resurfacing.dwg Sep 16, 2025 - 9:22am

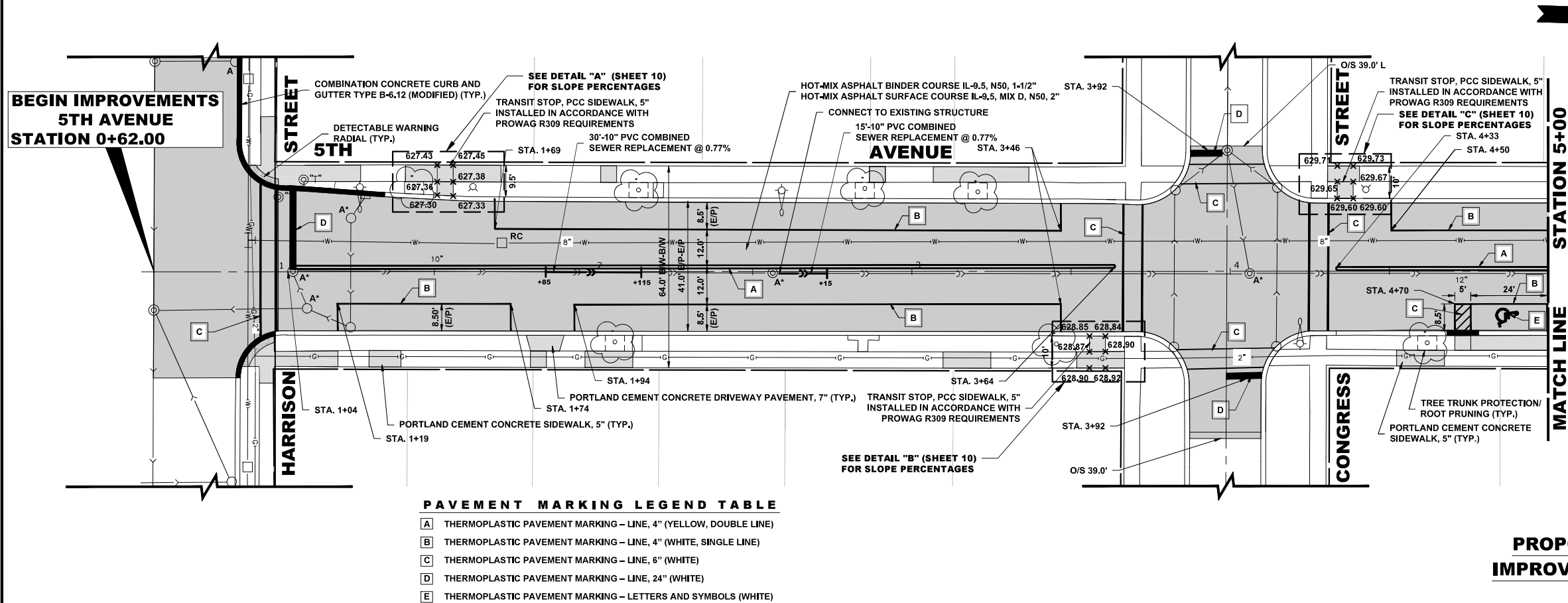
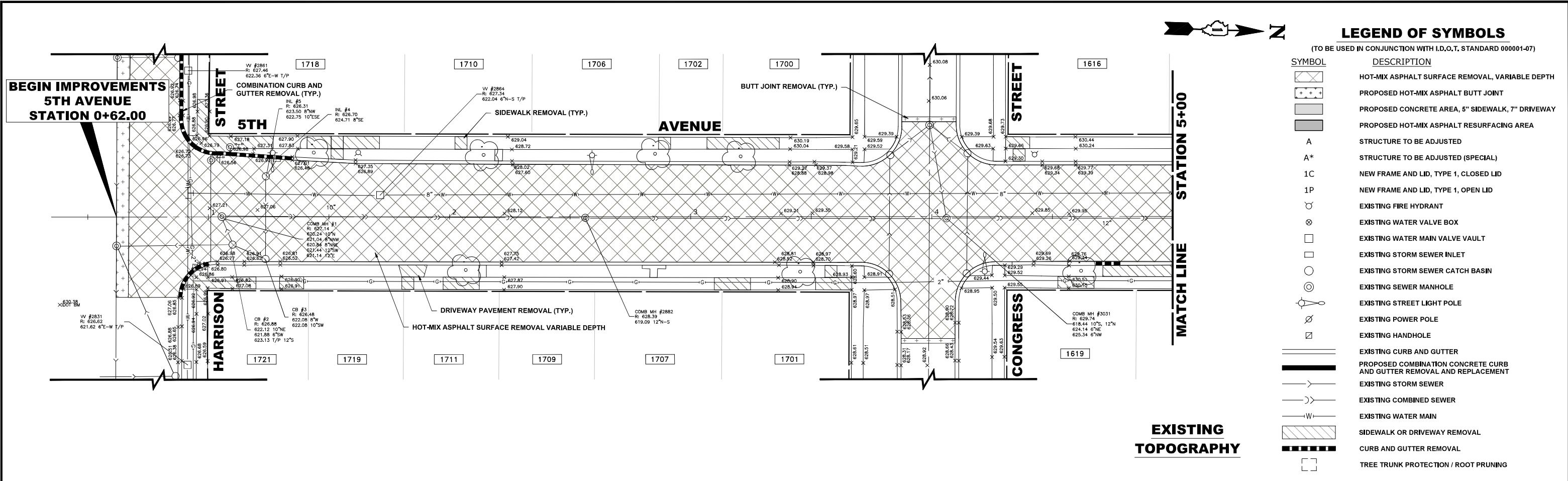

NOTES:

- PIPE CONNECTIONS TO HAVE PRECAST RUBBER BOOTS CONFORMING TO ASTM C-923.
- ALL ABANDONED COMBINED AND STORM SEWERS SHALL BE PLUGGED AT BOTH ENDS WITH A MINIMUM 2 FOOT LONG NON-SHRINK CONCRETE/ MORTAR PLUG.
- ANY ENCROACHMENT INTO COUNTY MAINLINE PAVEMENT FOR CURB AND GUTTER REPLACEMENT SHALL REQUIRE A MINIMUM DEPTH OF 4.0" OF HMA 6.0' AWAY FROM EDGE OF PAVEMENT
- I.D.O.T. DISTRICT 1 HMA MIX REQUIREMENTS TO BE FOLLOWED. THE HMA DEPTH AT 5TH AVENUE AND HARRISON STREET TO MATCH EXISTING COMPOSITION.

DETAIL "A"

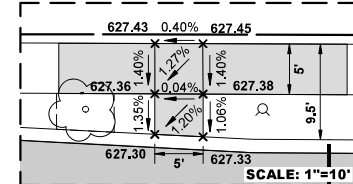

DETAIL "B"

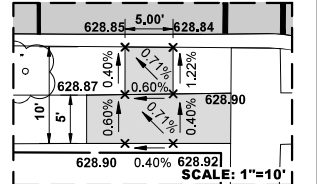

DETAIL "C"

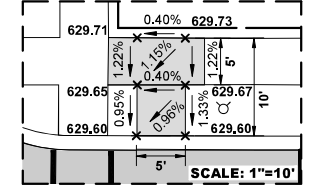

Drawing file: W:\Projects_by_Village\Maywood\56524159 - 5th ave resurfacing\SITE\5th Ave Resurfacing.dwg Sep 16, 2025 - 9:20am

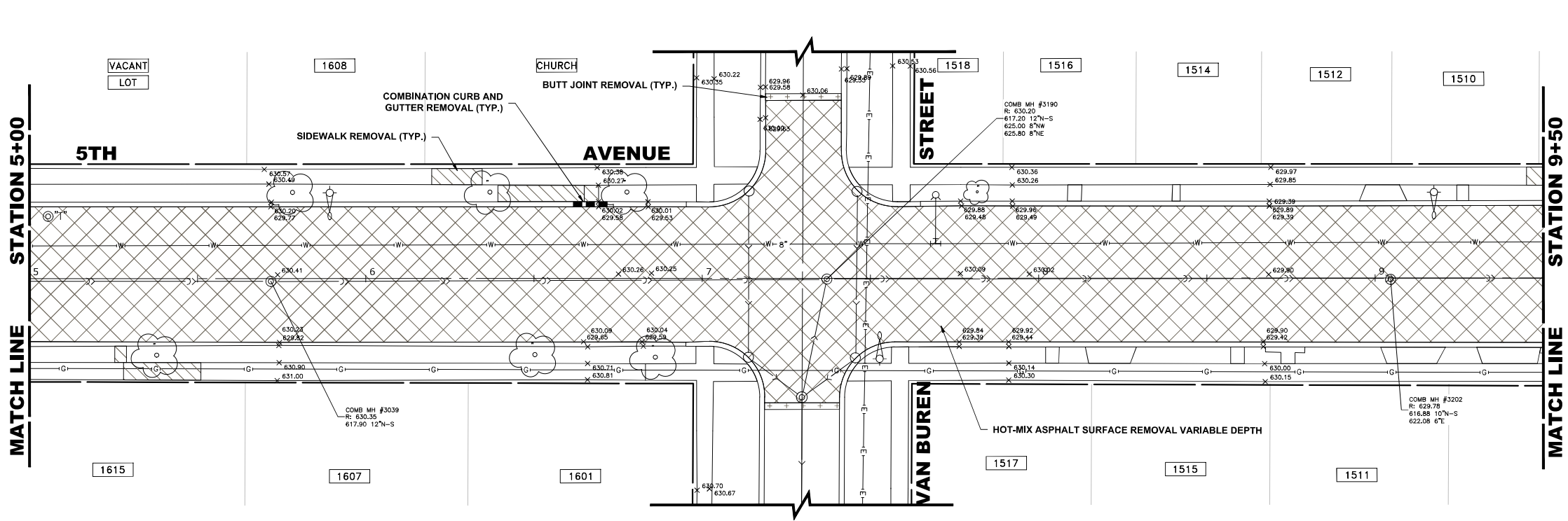

LEGEND OF SYMBOLS
(TO BE USED IN CONJUNCTION WITH I.D.O.T. STANDARD 000001-07)

SYMBOL	DESCRIPTION
	HOT-MIX ASPHALT SURFACE REMOVAL, VARIABLE DEPTH
	PROPOSED HOT-MIX ASPHALT BUTT JOINT
	PROPOSED CONCRETE AREA, 5" SIDEWALK, 7" DRIVEWAY
	PROPOSED HOT-MIX ASPHALT RESURFACING AREA
A	STRUCTURE TO BE ADJUSTED
A*	STRUCTURE TO BE ADJUSTED (SPECIAL)
1C	NEW FRAME AND LID, TYPE 1, CLOSED LID
1P	NEW FRAME AND LID, TYPE 1, OPEN LID
	EXISTING FIRE HYDRANT
	EXISTING WATER VALVE BOX
	EXISTING WATER MAIN VALVE VAULT
	EXISTING STORM SEWER INLET
	EXISTING STORM SEWER CATCH BASIN
	EXISTING SEWER MANHOLE
	EXISTING STREET LIGHT POLE
	EXISTING POWER POLE
	EXISTING HANDHOLE
	EXISTING CURB AND GUTTER
	PROPOSED COMBINATION CONCRETE CURB AND GUTTER REMOVAL AND REPLACEMENT
	EXISTING STORM SEWER
	EXISTING COMBINED SEWER
	EXISTING WATER MAIN
	SIDEWALK OR DRIVEWAY REMOVAL
	CURB AND GUTTER REMOVAL
	TREE TRUNK PROTECTION / ROOT PRUNING

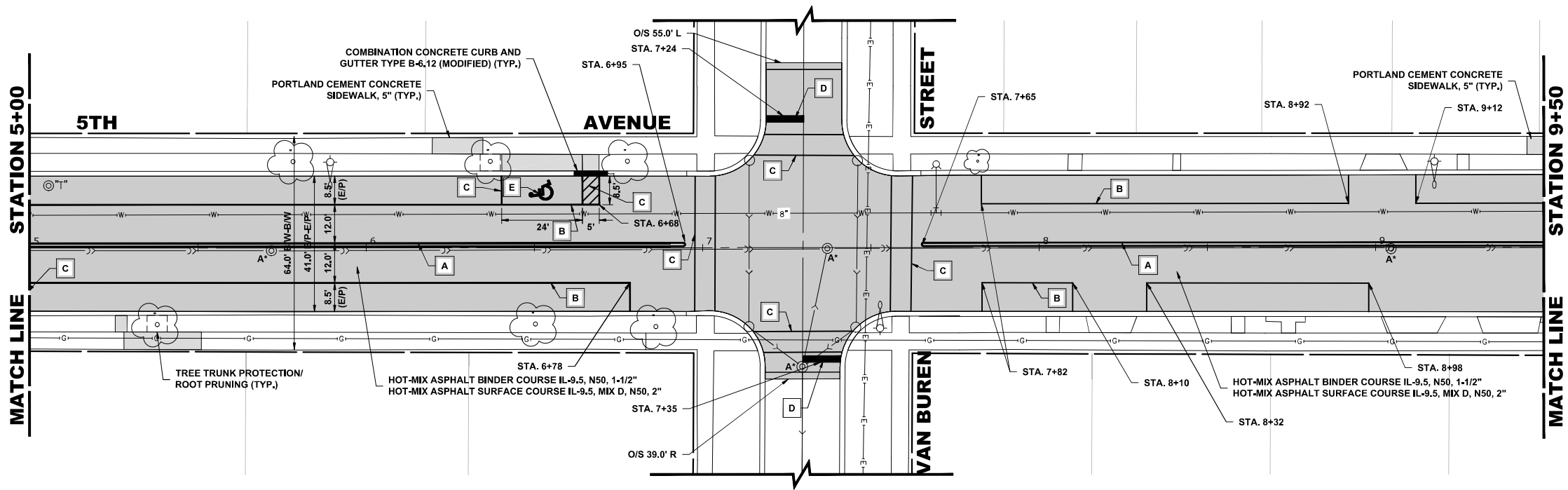

NOTES:

- PIPE CONNECTIONS TO HAVE PRECAST RUBBER BOOTS CONFORMING TO ASTM C-923.
- ALL ABANDONED COMBINED AND STORM SEWERS SHALL BE PLUGGED AT BOTH ENDS WITH A MINIMUM 2 FOOT LONG NON-SHRINK CONCRETE/ MORTAR PLUG.
- ANY ENCROACHMENT INTO COUNTY MAINLINE PAVEMENT FOR CURB AND GUTTER REPLACEMENT SHALL REQUIRE A MINIMUM DEPTH OF 4.0" OF HMA 6.0' AWAY FROM EDGE OF PAVEMENT
- I.D.O.T. DISTRICT 1 HMA MIX REQUIREMENTS TO BE FOLLOWED. THE HMA DEPTH AT 5TH AVENUE AND HARRISON STREET TO MATCH EXISITNG COMPOSITION.

PAVEMENT MARKING LEGEND TABLE

A	THERMOPLASTIC PAVEMENT MARKING - LINE, 4" (YELLOW, DOUBLE LINE)
B	THERMOPLASTIC PAVEMENT MARKING - LINE, 4" (WHITE, SINGLE LINE)
C	THERMOPLASTIC PAVEMENT MARKING - LINE, 6" (WHITE)
D	THERMOPLASTIC PAVEMENT MARKING - LINE, 24" (WHITE)
E	THERMOPLASTIC PAVEMENT MARKING - LETTERS AND SYMBOLS (WHITE)

HANCOCK ENGINEERING
100+ Years of Experience
Civil Engineers
Municipal Consultants
Established 1911

9933 Roosevelt Road
Westchester, IL 60184-2780
Phone: 708-665-0300
www.hancock.com

DESIGNED -	AB	REVISED -	9-16-25
DRAWN -	DMM, SA, LW, AJ	REVISED -	8-25-25
CHECKED -	XX	REVISED -	8-15-25
DATE -	5-28-25	REVISED -	7-15-25

STATE OF ILLINOIS
DEPARTMENT OF TRANSPORTATION

**5TH AVENUE
RESURFACING AND PAVEMENT MARKING PLAN**

SCALE: 1"=20'H SHEET NO. 2 OF 3 SHEETS STA. 5+00 TO STA. 9+50

MUN RTE.	SECTION	COUNTY	TOTAL SHEETS	SHEET NO.
2742	24-00145-00-RS	COOK	22	11
FIELD BOOK NO. :		CONTRACT NO. 61L75		
FED. ROAD DIST. NO. 1 ILLINOIS		FED. AID PROJECT		

E.H.E. PROJECT NO. 565-24-15901

Drawing file: W:\projects_by_village\Maywood\56524159 - 5th ave resurfacing\SITE\5th Ave Resurfacing.dwg Sep 16, 2025 - 9:20am

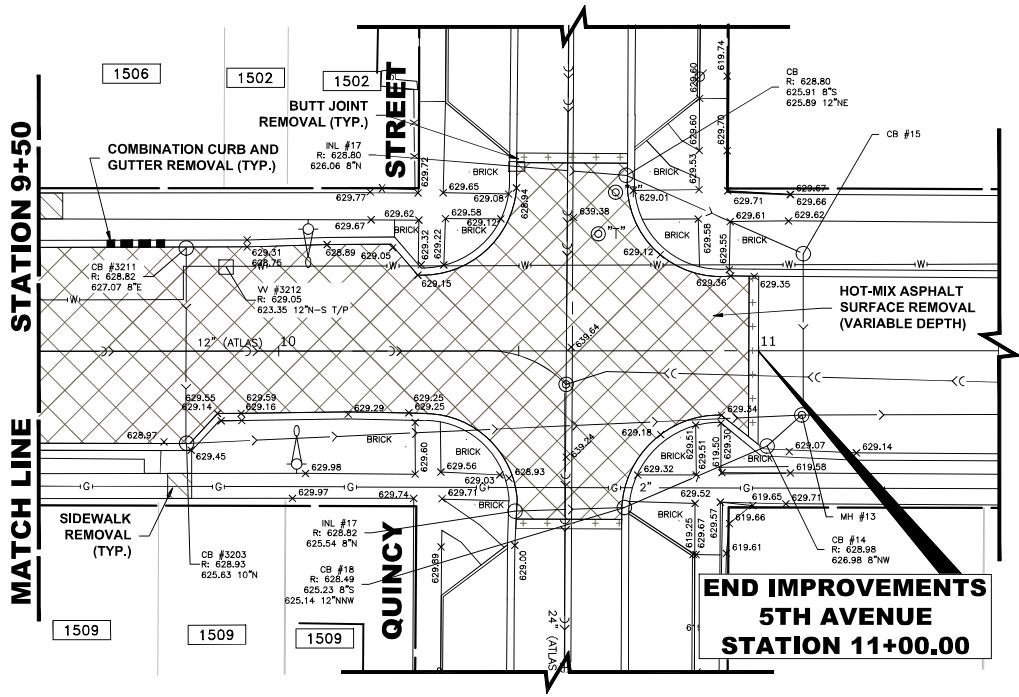

EXISTING
TOPOGRAPHY

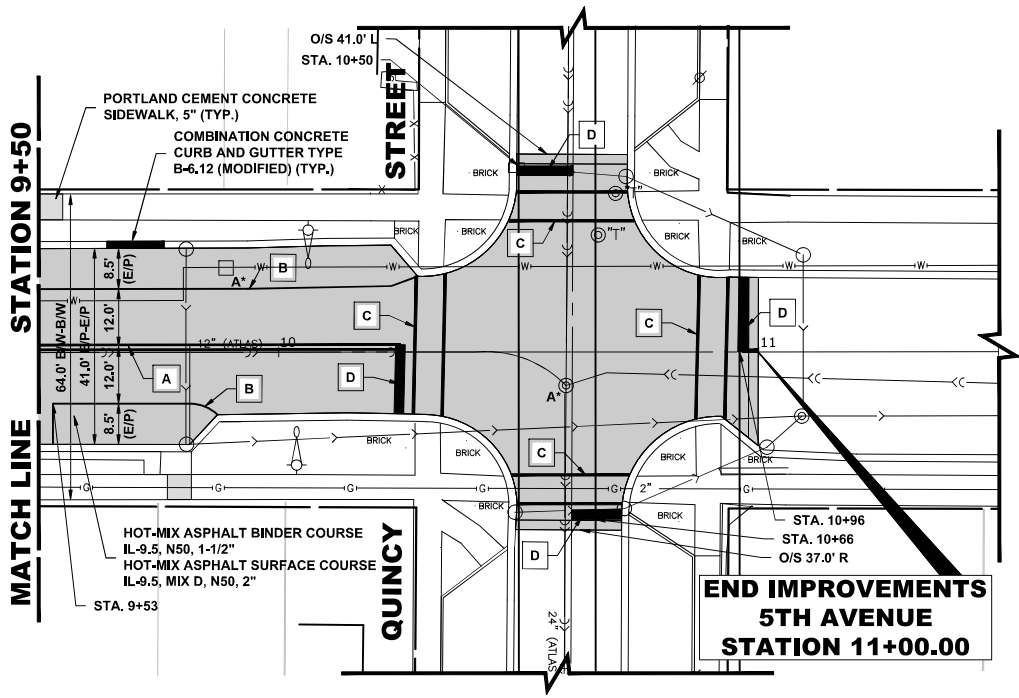

PROPOSED
IMPROVEMENT

LEGEND OF SYMBOLS

(TO BE USED IN CONJUNCTION WITH I.D.O.T. STANDARD 000001-07)

SYMBOL	DESCRIPTION
	HOT-MIX ASPHALT SURFACE REMOVAL, VARIABLE DEPTH
	PROPOSED HOT-MIX ASPHALT BUTT JOINT
	PROPOSED CONCRETE AREA, 5" SIDEWALK, 7" DRIVEWAY
	PROPOSED HOT-MIX ASPHALT RESURFACING AREA
A	STRUCTURE TO BE ADJUSTED
A*	STRUCTURE TO BE ADJUSTED (SPECIAL)
1C	NEW FRAME AND LID, TYPE 1, CLOSED LID
1P	NEW FRAME AND LID, TYPE 1, OPEN LID
	EXISTING FIRE HYDRANT
	EXISTING WATER VALVE BOX
	EXISTING WATER MAIN VALVE VAULT
	EXISTING STORM SEWER INLET
	EXISTING STORM SEWER CATCH BASIN
	EXISTING SEWER MANHOLE
	EXISTING STREET LIGHT POLE
	EXISTING POWER POLE
	EXISTING HANDHOLE
	EXISTING CURB AND GUTTER
	PROPOSED COMBINATION CONCRETE CURB AND GUTTER REMOVAL AND REPLACEMENT
	EXISTING STORM SEWER
	EXISTING COMBINED SEWER
	EXISTING WATER MAIN
	SIDEWALK OR DRIVEWAY REMOVAL
	CURB AND GUTTER REMOVAL
	TREE TRUNK PROTECTION / ROOT PRUNING

NOTES:

- PIPE CONNECTIONS TO HAVE PRECAST RUBBER BOOTS CONFORMING TO ASTM C-923.
- ALL ABANDONED COMBINED AND STORM SEWERS SHALL BE PLUGGED AT BOTH ENDS WITH A MINIMUM 2 FOOT LONG NON-SHRINK CONCRETE/ MORTAR PLUG.
- ANY ENCROACHMENT INTO COUNTY MAINLINE PAVEMENT FOR CURB AND GUTTER REPLACEMENT SHALL REQUIRE A MINIMUM DEPTH OF 4.0" OF HMA 6.0' AWAY FROM EDGE OF PAVEMENT
- I.D.O.T. DISTRICT 1 HMA MIX REQUIREMENTS TO BE FOLLOWED. THE HMA DEPTH AT 5TH AVENUE AND HARRISON STREET TO MATCH EXISITNG COMPOSITION.

PAVEMENT MARKING LEGEND TABLE

A	THERMOPLASTIC PAVEMENT MARKING – LINE, 4" (YELLOW, DOUBLE LINE)
B	THERMOPLASTIC PAVEMENT MARKING – LINE, 4" (WHITE, SINGLE LINE)
C	THERMOPLASTIC PAVEMENT MARKING – LINE, 6" (WHITE)
D	THERMOPLASTIC PAVEMENT MARKING – LINE, 24" (WHITE)
E	THERMOPLASTIC PAVEMENT MARKING – LETTERS AND SYMBOLS (WHITE)



◆ Civil Engineers
◆ Municipal Consultants
◆ Established 1911

9933 Roosevelt Road
Westchester, IL 60184-2780
Phone: 708-665-0300
www.hancock.com

DESIGNED -	AB	REVISED -	9-16-25
DRAWN -	DMM, SA, LW, AJ	REVISED -	8-25-25
CHECKED -	XX	REVISED -	8-15-25
DATE -	5-28-25	REVISED -	7-15-25

STATE OF ILLINOIS
DEPARTMENT OF TRANSPORTATION

5TH AVENUE RESURFACING AND PAVEMENT MARKING PLAN

SCALE: 1"=20'H SHEET NO. 3 OF 3 SHEETS STA. 9+50 TO STA. 11+00

MUN RTE.	SECTION	COUNTY	TOTAL SHEETS	SHEET NO.
2742	24-00145-00-RS	COOK	22	12
FIELD BOOK NO. :		CONTRACT NO. 61L75		
FED. ROAD DIST. NO. 1 ILLINOIS		FED. AID PROJECT		

E.H.E. PROJECT NO. 565-24-15901

Drawing file: W:\projects_by_village\Waywood\66624159 - 5th ave resurfacing\SITE\Erosion Control.dwg Sep 16, 2025 - 9:20am

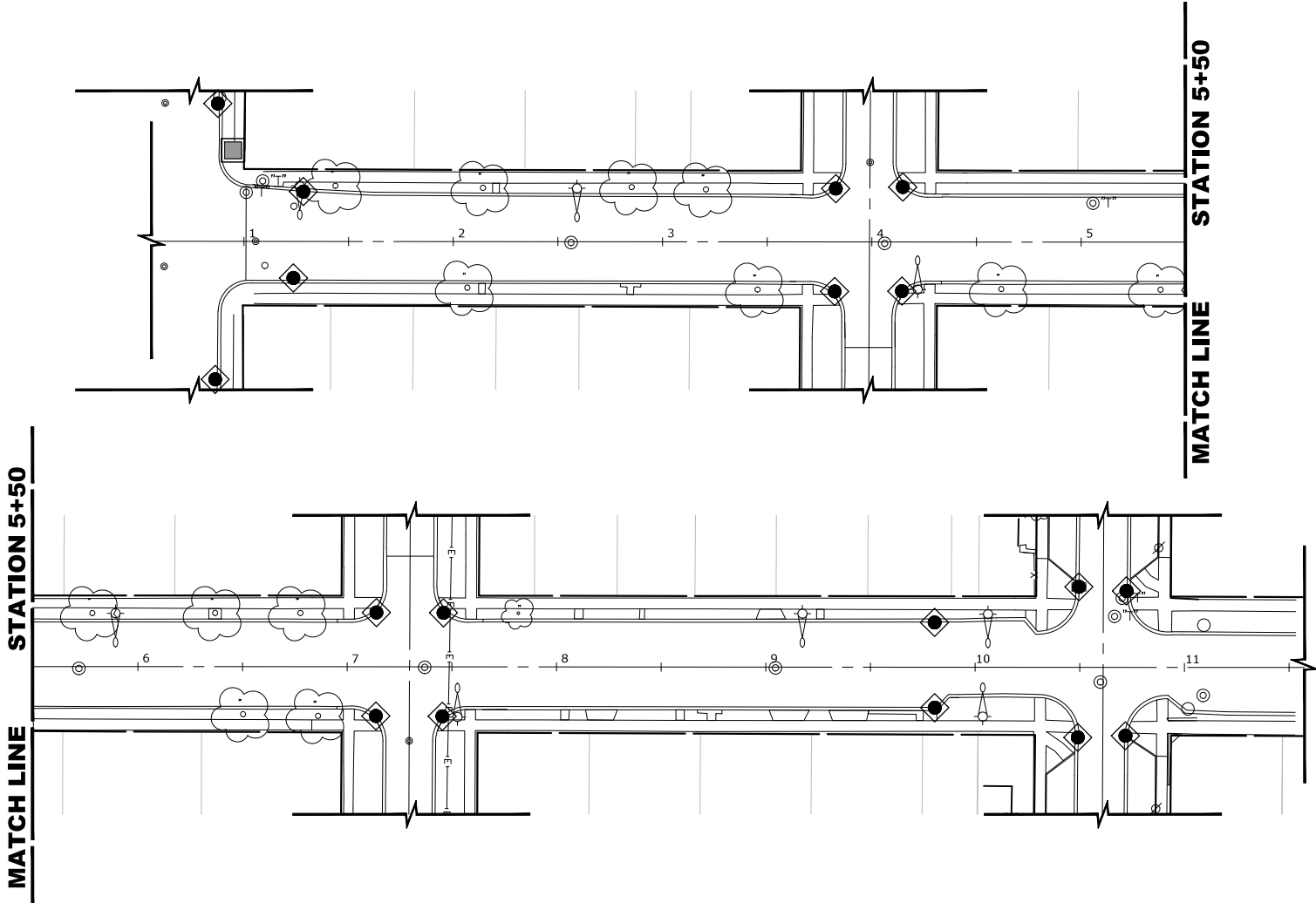

LEGEND

SYMBOL	DESCRIPTION
	INLET FILTER/SEDIMENT CONTROL, DRAINAGE STRUCTURE, INLET FILTER CLEANING
	CONCRETE WASHOUT
	TREE TRUNK PROTECTION

CONSTRUCTION SEQUENCE :

1. INSTALL EROSION CONTROL MEASURES
2. COMPLETE ALL UNDERGROUND WORK
3. PAVEMENT PATCHING
4. RESURFACE PAVEMENTS
5. RESTORE DAMAGED AREAS ADJACENT TO IMPROVEMENTS
6. REMOVE EROSION CONTROL MEASURES

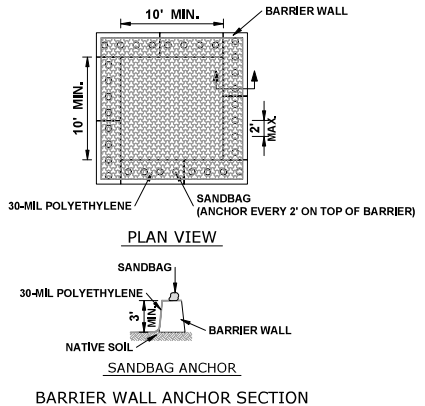
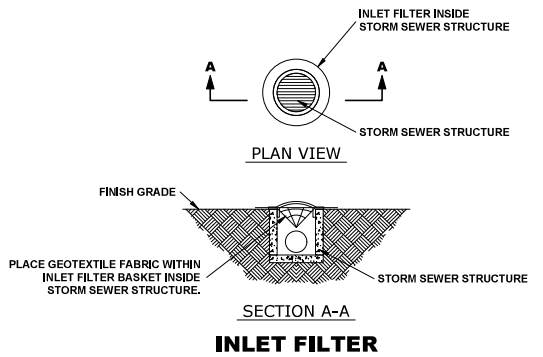

NOTES

1. MAINTAINING TEMPORARY CONCRETE FACILITIES SHALL INCLUDE REMOVING AND DISPOSING OF HARDEN CONCRETE AND/OR SLURRY AND RETURNING THE FACILITIES TO A FUNCTIONAL CONDITION.
2. FACILITY SHALL BE CLEANED OR RECONSTRUCTED IN A NEW AREA ONCE WASHOUT BECOMES TWO-THIRDS FULL.

CONCRETE WASHOUT

EROSION AND SEDIMENT CONTROL PLAN

THE EXISTING LAND COVER CONSISTS OF PAVED STREETS WITH MINOR GRASS PARKWAYS LOCATED IN A RESIDENTIAL AREA. THE AREAS ADJACENT TO THE PROJECT SITE ARE COMPRISED OF DENSE RESIDENTIAL PROPERTIES, FLOOD PROTECTION AREAS AND POINTS OF DISCHARGE TO JURISDICTIONAL WATERS OF THE U.S. DO NOT EXIST ON THIS PROJECT. WE DO NOT BELIEVE THERE ARE ANY AREAS SUSCEPTIBLE TO EROSION OR SEDIMENTATION DUE TO THESE IMPROVEMENTS. SOIL DATA IS NOT AVAILABLE BUT, PAST PROJECTS IN THE SUBJECT VILLAGE CONCLUDE THAT THE EXISTING SOIL CONSISTS OF CLAY WITH SOME MINOR SILT AND TRACES OF SAND.

PRIOR TO ANY SOIL/PAVEMENT DISTURBANCE, INLET FILTER ASSEMBLIES SHALL BE INSTALLED AS SHOWN ON PLANS.

THE INLET FILTER, PRIMARY PURPOSE IS TO TRAP SEDIMENT, REQUIRED FOR THIS PROJECT WILL BE A DROP IN INLET PROTECTION DEVICE SIMILAR TO FLEXSTORM INLET FILTERS. INLET FILTERS OF THIS TYPE HAVE BEEN USED ON PAST PROJECTS OF SIMILAR SIZE AND SCOPE AND HAVE HAD SATISFACTORY RESULTS.

THE INLET FILTER ASSEMBLY SHALL BE APPROVED BY THE ENGINEER OR VILLAGE PRIOR TO ORDERING AND INSTALLATION. THE INLET FILTER SHALL BE INSPECTED WEEKLY AND AFTER A 0.5 INCH RAIN EVENT BY THE ENGINEER. THE ENGINEER WILL REPORT ANY ISSUES, VIA VERBAL OR WRITTEN COMMUNICATION, THAT NEED TO BE ADDRESSED BY THE CONTRACTOR.

MAINTENANCE OF THE PROPOSED INLET FILTER WILL BE PER MANUFACTURE RECOMMENDATIONS AND WILL BE DONE BY THE CONTRACTOR. TYPICAL MAINTENANCE PRACTICES INCLUDE INSPECTION AFTER A RUNOFF EVENT, SEDIMENT REMOVAL AT 50% CAPACITY, AND REPAIRS/REPLACEMENT AS NEEDED.

PRIOR TO ANY PORTLAND CEMENT CONCRETE (PCC) POUR, CONCRETE WASHOUT BOXES SHALL BE INSTALLED AS SHOWN ON PLANS OR AS DIRECTED BY THE ENGINEER.

CONCRETE WASHOUT BOXES, PRIMARY PURPOSE IS TO CONTAIN CONCRETE LIQUIDS AND PREVENT CONCRETE LIQUID RUNOFF FROM ENTERING SEWERS OR WATERWAYS, REQUIRED FOR THIS PROJECT WILL CONSIST OF A BARRIER WALL LINED WITH 30-MIL POLYETHYLENE OR AN ENGINEER APPROVED EQUAL WASHOUT. CONCRETE WASHOUT BOXES OF THIS TYPE HAVE BEEN USED ON PAST PROJECTS OF SIMILAR SIZE AND SCOPE AND HAVE HAD SATISFACTORY RESULTS.

THE PLAN FOR THE CONCRETE WASHOUT BOX SHALL BE SUBMITTED AND APPROVED BY THE ENGINEER OR VILLAGE PRIOR TO INSTALLATION AND WILL BE INSPECTED AFTER INSTALLATION. THE WASHOUT BOX SHALL BE INSPECTED PRIOR TO A CONCRETE POUR AND AFTER A CONCRETE POUR BY THE ENGINEER. THE ENGINEER WILL REPORT ANY ISSUES, VIA VERBAL OR WRITTEN COMMUNICATION, THAT NEED TO BE ADDRESSED BY THE CONTRACTOR.

MAINTENANCE OF THE PROPOSED CONCRETE WASHOUT BOXES WILL BE DONE BY THE CONTRACTOR. TYPICAL MAINTENANCE PRACTICES INCLUDE REPLACING DAMAGED LINER, DISPOSING OF SOLIDIFIED CONCRETE WASHOUT, AND REMOVAL OF ANY DISCHARGES WITHIN 24 HOURS.

ALL DISPOSAL OF CONSTRUCTION MATERIAL, SEDIMENT, AND SOLIDIFIED CONCRETE SHALL BE AT A CDD FACILITY

NOTES

1. SEE IDOT STANDARD 280001-07 FOR TEMPORARY EROSION CONTROL SYSTEMS.
2. THE CONTRACTOR SHALL ENSURE THAT ADJACENT PROPERTIES REMAIN PROTECTED FROM SEDIMENT DEPOSITION.
3. SOIL STOCKPILES SHALL BE PROTECTED WITH PERIMETER EROSION BARRIER OR OTHER EROSION PROTECTION SPECIFIED BY THE RESIDENT ENGINEER. THE COST SHALL BE INCLUDED IN THE UNIT PRICE FOR THE INDIVIDUAL SOIL MATERIALS.
4. WHEREVER CONSTRUCTION VEHICLE ACCESS ROUTES INTERSECT PAVED PUBLIC ROADS, PROVISIONS SHALL BE MADE TO MINIMIZE THE TRANSPORT OF SEDIMENT BY RUNOFF OR VEHICLE TRACKING ONTO THE PAVED SURFACE. THE PROVISIONS MAY INCLUDE SPRAYING VEHICLE WHEELS TO CLEAR SEDIMENT BEFORE EXITING THE CONSTRUCTION SITE OR OTHER MEASURES APPROVED BY THE ENGINEER.
5. INLET FILTERS SHALL BE PAID FOR UNDER THE PAY ITEM FOR MAINTENANCE OF ROADWAYS. THE COST OF THE CONCRETE WASHOUTS SHALL BE INCLUDED IN THE COST OF THE CONTRACT.
6. INLET FILTER SHALL BE INSTALLED PRIOR TO CONSTRUCTION AND SHALL BE REMOVED AFTER CONSTRUCTION IS COMPLETED. FILTERS WILL BE INSPECTED WEEKLY AND THE CONTRACTOR WILL BE NOTIFIED OF ANY CORRECTIVE MEASURES THAT WILL BE REQUIRED TO BE MADE BY THE CONTRACTOR.
7. NO RUNOFF FROM CONCRETE WASHOUT BOXES SHALL BE PERMITTED TO ENTER LOCAL SEWERS OR STORMWATER MANAGEMENT FACILITIES.



◆ Civil Engineers
◆ Municipal Consultants
◆ Established 1911

9933 Roosevelt Road
Westchester, IL 60154-2780
Phone: 708-865-0300
www.hancock.com

DESIGNED -	AB	REVISED -	9-16-25
DRAWN -	DMM, SA, LW, AJ	REVISED -	8-25-25
CHECKED -	XX	REVISED -	8-15-25
DATE -	5-28-25	REVISED -	7-15-25

STATE OF ILLINOIS DEPARTMENT OF TRANSPORTATION

EROSION CONTROL PLANS

SCALE: - SHEET NO. 1 OF 1 SHEETS STA. - TO STA. -

MUN RTE.	SECTION	COUNTY	TOTAL SHEETS	SHEET NO.
2742	24-00145-00-RS	COOK	22	13
FIELD BOOK NO. :		CONTRACT NO. 61L75		
FED. ROAD DIST. NO. 1		ILLINOIS	FED. AID PROJECT	

E.H.E. PROJECT NO. 565-24-15901

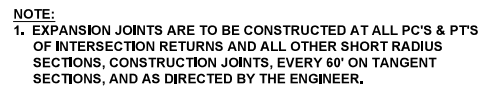

TYPICAL CURB AND GUTTER EXPANSION JOINT



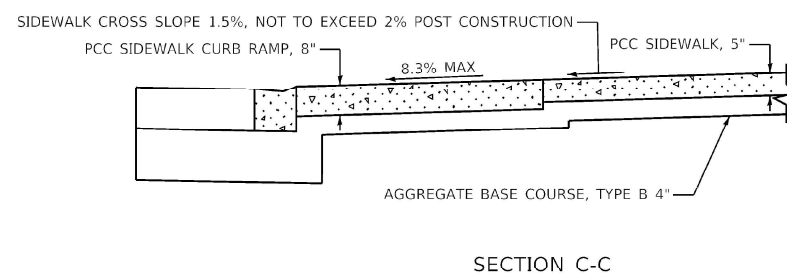
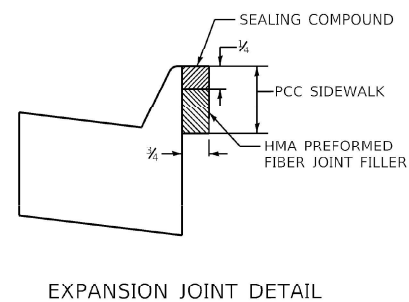
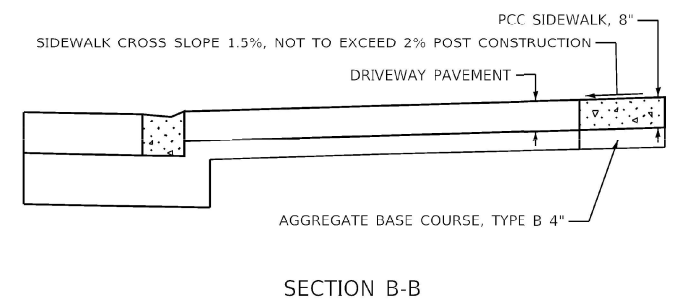

ALL DIMENSIONS ARE IN INCHES UNLESS OTHERWISE SHOWN.

C-XXX

 DRAINAGE PATH OF SURFACE WATER
 SUMMIT (CHANGE IN DRAINAGE PATH)



ADA REQUIREMENTS
DETECTABLE WARNING TILES SHALL BE OF UNIFORM QUALITY, AND FREE OF SURFACE DEFECTS.
THE DETECTABLE WARNINGS SHALL BE CONSTRUCTED WITH
CAST IRON TILE MEETING REQUIREMENTS OF ASTM A 48 CLASS 30 OR BETTER.

THE DOME SIZE AND SPACING OF THE DETECTABLE WARNINGS SHALL MEET ALL REQUIREMENTS OF SECTION R305.1.1 AND R305.1.2 OF PROWAG.

THE COLOR OF THE DETECTABLE WARNING TILES IS TO BE APPROVED BY THE ENGINEER AND COMPLY WITH THE REQUIREMENTS OF SECTION R305.1.3 OF PROWAG.

ALL SIDEWALK CROSS SLOPES AT 5TH AVENUE AND HARRISON STREET SHALL NOT EXCEED 1.5% AND PROPOSED SIDEWALK SHALL BE 8" THICK THROUGH AT CURB RAMPS. ALL PROPOSED SIDEWALKS INSTALLATION SHALL FOLLOW CCDOH GUIDELINES.

ALL DISTURBED AREAS WITHIN COUNTY R.O.W ARE TO BE RESTORED WITH 4" OF TOPSOIL AND SALT TOLERANT SOD.

NW CORNER					NE CORNER				
	STATION	OFFSET	SIDE	ELEVATION		STATION	OFFSET	SIDE	ELEVATION
A	01+00.00	48.70	L	627.36	N	01+19.70	29.80	R	626.96
B	01+00.00	48.70	L	627.30	O	01+19.70	24.80	R	626.85
C	00+90.20	32.70	L	626.68	P	00+99.70	29.70	R	626.91
D	00+91.40	33.50	L	626.70	Q	00+99.80	35.00	R	627.00
E	00+95.50	33.50	L	626.75	R	00+95.00	35.00	R	626.93
F	00+95.00	28.00	L	626.80	S	00+99.70	25.00	R	626.85
G	00+95.60	29.20	L	626.75	T	00+99.70	20.20	R	626.80
H	01+00.50	25.80	L	626.70	U	00+99.70	18.80	R	626.79
I	01+00.50	33.50	L	626.80	V	00+93.90	23.00	R	626.88
J	01+00.40	27.20	L	626.75	W	00+93.90	23.00	R	626.88
K	01+09.20	28.40	L	627.31	X	00+89.60	29.80	R	626.89
L	01+26.90	28.30	L	627.31	Y	00+95.00	29.70	R	626.92
M	01+26.90	33.50	L	627.31	Z	00+87.70	33.30	R	626.85
					AA	00+89.00	33.50	R	627.06



- ◆ Civil Engineers
- ◆ Municipal Consultants
- ◆ Established 1911

9933 Roosevelt Road
Westchester, IL 60154-2780
Phone: 708-865-0300
www.shanck.com

DESIGNED -	AB	REVISED -	9-16-25
DRAWN -	DMM, SA, LW, AJ	REVISED -	8-25-25
CHECKED -	XX	REVISED -	8-15-25
DATE -	5-28-25	REVISED -	7-15-25

STATE OF ILLINOIS
DEPARTMENT OF TRANSPORTATION

ADA RAMP DETAILS (5TH AVENUE AND HARRISON STREET)

SCALE: 1" = 5'	SHEET NO. 1 OF 1 SHEETS	STA. TO STA.
----------------	-------------------------	--------------

MUN RTE.	SECTION	COUNTY	TOTAL SHEETS	SHEET NO.
2742	24-00145-00-RS	COOK	22	16
FIELD BOOK NO. :		CONTRACT NO. 61L75		
FED. ROAD DIST. NO. 1	ILLINOIS	FED. AID PROJECT		

E.H.E. PROJECT NO. 565-24-15901

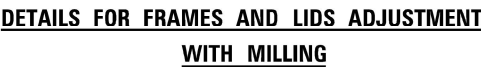

1. EXISTING BROKEN FRAMES AND LIDS SHALL BE REMOVED AND DISPOSED OF BY THE CONTRACTOR AND SHALL BE REPLACED AS DIRECTED BY THE ENGINEER. REPLACEMENT FRAMES AND LIDS WILL BE PAID FOR IN ACCORDANCE WITH ARTICLE 109.04 OF THE STANDARD SPECIFICATIONS UNLESS A SEPARATE PAY ITEM HAS BEEN PROVIDED.
2. IF THE EXISTING LIDS ARE OPEN, THE FRAME WILL BE ADJUSTED TO THE ELEVATION OF THE MILLED PAVEMENT SURFACE PRIOR TO THE MILLING OPERATION. THE FRAME WILL NOT BE REMOVED AND COVERED BY THE METAL PLATE.
3. CITY OF CHICAGO CASTINGS ARE THE PROPERTY OF THE CITY AND THE CONTRACTOR SHALL NOTIFY THE CITY FOR REMOVAL AND DISPOSITION OF THE CASTINGS.
4. THE METAL PLATE USED TO COVER THE STRUCTURE SHALL REMAIN THE PROPERTY OF THE CONTRACTOR.
5. THE CONTRACTOR SHALL REMOVE ALL TRAFFIC CONTROL DEVICES BY THE END OF EACH WORK SHIFT.

STAGE 1 (BEFORE PAVEMENT MILLING)

- A) REMOVE A MINIMUM OF 12 (300) OF THE PAVEMENT FROM AROUND THE STRUCTURE.
- B) REMOVE THE EXISTING FRAME AND LID FROM THE STRUCTURE.
- C) COVER THE STRUCTURE OPENING WITH A 36 (900) DIAMETER METAL PLATE.
- D) BACKFILL WITH CRUSHED STONE AND HMA SURFACE MIX APPROVED BY THE ENGINEER. (MIN. 3 (80) HMA TO REMAIN AFTER MILLING).

THE PROCEDURE EXPLAINED ABOVE SHALL CONFORM TO THE APPLICABLE PORTIONS OF SECTIONS 353, 406, 602, AND 603 OF THE STANDARD SPECIFICATIONS EXCEPT THAT "THE CONTRACTOR SHALL ADJUST THE STRUCTURES TO THE FINISHED PAVEMENT ELEVATION NO MORE THAN 5 CALENDAR DAYS PRIOR TO PLACEMENT OF THE FINAL LIFT OF SURFACE UNLESS APPROVED BY THE ENGINEER."

① SUB-BASE GRANULAR MATERIAL	⑥ FRAME AND LID (SEE NOTES)
② EXISTING PAVEMENT	⑦ CLASS PP-2* CONCRETE
③ 36 (900) DIAMETER METAL PLATE	⑧ PROPOSED HMA SURFACE COURSE
④ PROPOSED CRUSHED STONE AND HMA SURFACE MIX	⑨ PROPOSED HMA BINDER COURSE
⑤ EXISTING STRUCTURE	

THE CONTRACTOR WILL BE REQUIRED TO KEEP A RECORD OF THE LOCATIONS OF THE BURIED STRUCTURES ACCORDING TO THE STATION AND DISTANCE LEFT OR RIGHT OF THE CENTERLINE OF PAVEMENT. UPON COMPLETION OF THE WORK, THE CONTRACTOR WILL DELIVER THE RECORD TO THE ENGINEER.

1. REMOVING FRAMES AND LIDS ON DRAINAGE AND UTILITY STRUCTURES A IN THE PAVEMENT PRIOR TO MILLING, AND ADJUSTING TO FINAL GRADE PRIOR TO PLACING THE SURFACE COURSE, WILL BE PAID FOR AT THE CONTRACT UNIT PRICE EACH FOR "FRAMES AND LIDS TO BE ADJUSTED (SPECIAL)."
2. THIS WORK WILL NOT BE PAID FOR WHEN DRAINAGE AND UTILITY STRUCTURES ARE SPECIFIED FOR PAYMENT AS STRUCTURE RECONSTRUCTION.
3. NEW FRAMES AND LIDS, WHEN SPECIFIED, WILL BE PAID FOR SEPARATELY.
4. WHEN STRUCTURES ARE TO BE ADJUSTED OR RECONSTRUCTED, THE LOWERING AND RAISING OF THE FRAMES AND LIDS WILL NOT BE PAID FOR SEPARATELY BUT WILL BE INCLUDED IN THE COST OF THE CORRESPONDING PAY ITEM.

	USER NAME = Lawrence.DeManche	DESIGNED - R. SHAH	REVISED - R. BORO 03-09-11	<div>STATE OF ILLINOIS</div> <div>DEPARTMENT OF TRANSPORTATION</div>	DETAILS FOR				MUN. RTE.	SECTION	COUNTY	TOTAL SHEETS	SHEET NO.
		DRAWN -	REVISED - R. BORO 12-06-11		FRAMES AND LIDS ADJUSTMENT WITH MILLING				2742	24-00145-00-RS	COOK	22	17
	PLOT SCALE = 100.0000' / in.	CHECKED -	REVISED - K. SMITH 11-18-22						FIELD BOOK NO. : BD600-03 (BD-8)		CONTRACT NO. 61L75		
	PLOT DATE = 9/15/2023	DATE - 10-25-94	REVISED - K. SMITH 09-15-23		SCALE: NONE				SHEET 1	OF 1	SHEETS	STA.	TO STA.
								FED. ROAD DIST. NO. 1		ILLINOIS	FED. AID PROJECT		

Drawing file: W:\projects_by_village\Maywood\56524159 - 5th ave resurfacing\DOT Standard.dwg Sep 16, 2025 - 9:20am

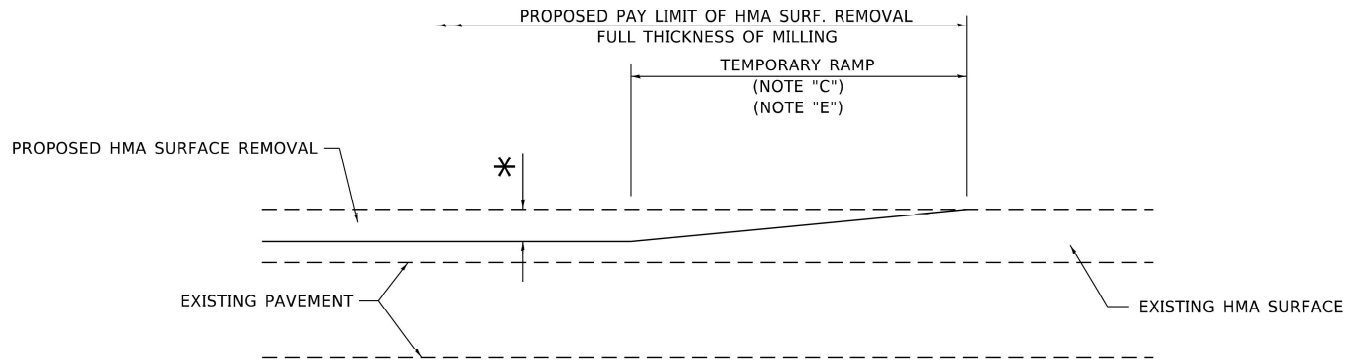

MILLED TEMPORARY RAMP

(FOR BUTT JOINT AND HMA TAPER SEE DETAIL BELOW)

OPTION 1

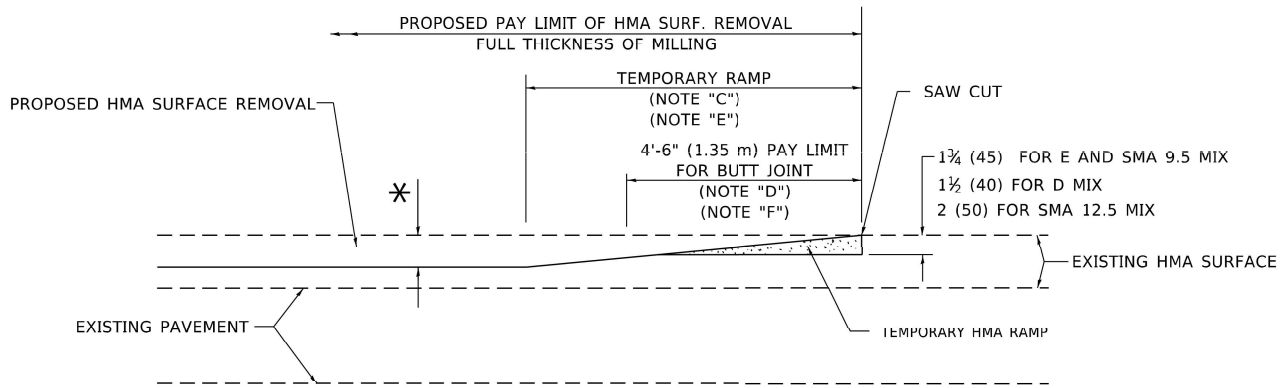

HMA CONSTRUCTED TEMPORARY RAMP

(FOR BUTT JOINT AND HMA TAPER SEE DETAIL BELOW)

OPTION 2

TYPICAL TEMPORARY RAMP

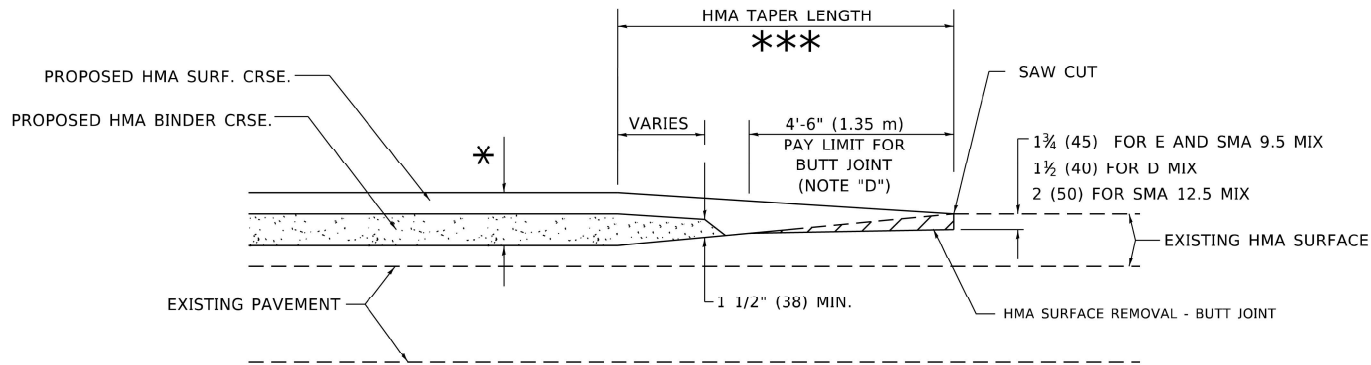

**BUTT JOINT AND
HMA TAPER**

**TYPICAL BUTT JOINT AND HMA TAPER
FOR MILLING AND RESURFACING**

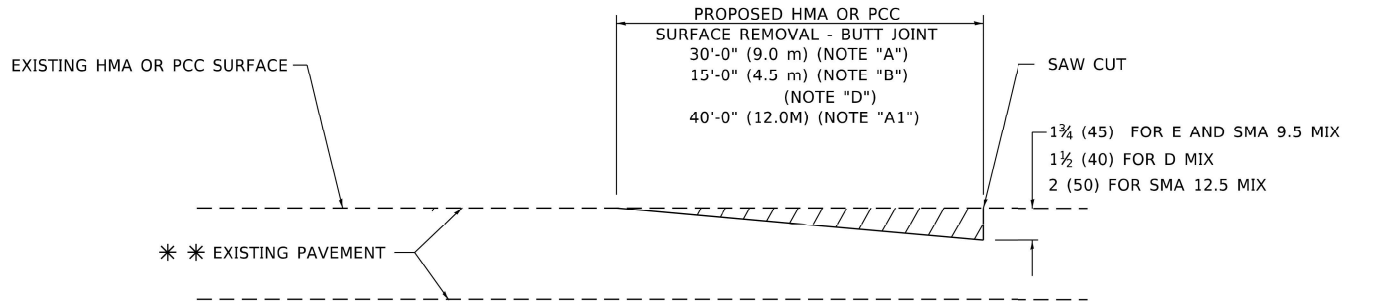

BUTT JOINT DETAIL

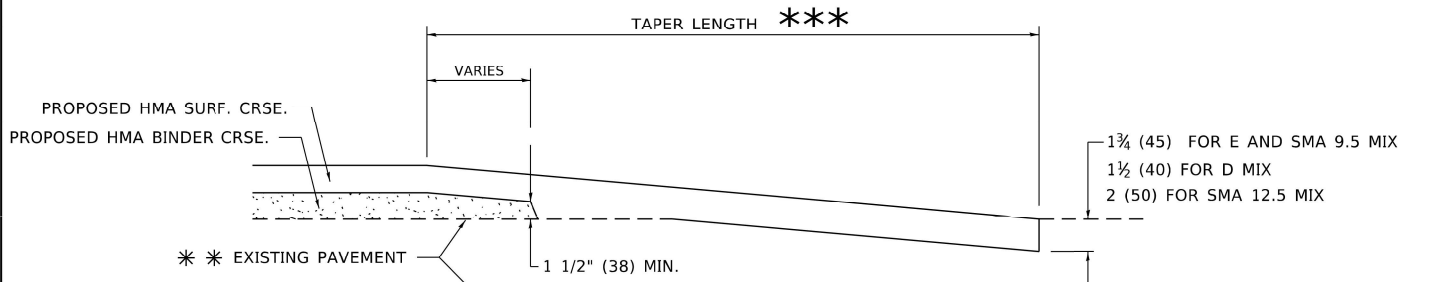

HMA TAPER DETAIL

**TYPICAL BUTT JOINT AND HMA TAPER
FOR RESURFACING ONLY**

** PC CONCRETE, HMA OR HMA RESURFACED PAVEMENT.

GENERAL NOTES

- MAINLINE ARTERIAL ROADWAYS AND MAJOR SIDE ROADS.
- INTERSTATES
- MINOR SIDE ROADS.
- THE TEMP. RAMP SHALL BE CONSTRUCTED IMMEDIATELY UPON REMOVAL OF THE EXISTING HMA SURFACE.
- THE BUTT JOINT SHALL BE CONSTRUCTED IMMEDIATELY PRIOR TO PLACING THE PROPOSED HMA COURSES.
- TAPER THE TEMP. RAMP AT A RATE OF 3' - 4" (1.02m) PER 1 INCH (25 mm) OF MILLING THICKNESS.
* SEE TYPICAL SECTIONS FOR MILLING THICKNESS.
- SEE ARTICLE 406.08 AND 406.14 OF THE STANDARD SPECIFICATIONS FOR "HMA AND/OR PCC SURFACE REMOVAL, BUTT JOINT".
*** 20'-0" (6.1 m) PER 1 (25) RESURFACING (NOTE "A")
10'-0" (3.0 m) PER 1 (25) RESURFACING (NOTE "B")

BASIS OF PAYMENT

- THE BUTT JOINT WILL BE PAID FOR AT THE CONTRACT UNIT PRICE PER SQUARE YARD (SQUARE METER) FOR "HOT-MIX ASPHALT SURFACE REMOVAL - BUTT JOINT" OR FOR "PORTLAND CEMENT CONCRETE SURFACE REMOVAL- BUTT JOINT".
- THE TEMPORARY RAMP AND SAW CUT SHALL BE INCLUDED IN THE UNIT COST FOR HMA OR PCC SURFACE REMOVAL-BUTT JOINT.

ALL DIMENSIONS ARE IN INCHES (MILLIMETERS) UNLESS OTHERWISE SHOWN.

USER NAME = Lawrence.DeManche	DESIGNED - M. DE YONG	REVISED - A. ABBAS 03-21-97
	DRAWN -	REVISED - M. GOMEZ 04-06-01
PLOT SCALE = 100.0000 ' / in.	CHECKED -	REVISED - R. BORO 01-01-07
PLOT DATE = 11/18/2022	DATE - 06-13-90	REVISED - K. SMITH 11-18-22

STATE OF ILLINOIS
DEPARTMENT OF TRANSPORTATION

**BUTT JOINT AND
HMA TAPER DETAILS**

SCALE: NONE SHEET 1 OF 1 SHEETS STA. TO STA.

MUN RTE.	SECTION	COUNTY	TOTAL SHEETS	SHEET NO.
2742	24-00145-00-RS	COOK	22	18
FIELD BOOK NO.: BD400-05 BD32		CONTRACT NO. 61L75		
FED. ROAD DIST. NO. 1		ILLINOIS	FED. AID PROJECT	

E.H.E. PROJECT NO. 565-24-15901

Drawing file: W:\projects_by_village\Maywood\56524159 - 5th ave resurfacing\DOT Standard.dwg Sep 17, 2025 - 4:19pm

FILE NAME =	USER NAME = faatemj	DESIGNED - L.H.A.	REVISED - A. HOUSEH 10-15-96
pw:\\IL084EBID\INTEG\illinois.gov\FWIDOT\Documents\DOT Offices\District 1\Projects\District 1\Projects\DOT Standard.dwg		DRAWN - T. RAMMACHER 01-06-00	REVISED - T. RAMMACHER 01-06-00
Default	PLOT SCALE = 50.000 ' / in.	CHECKED -	REVISED - A. SCHUETZE 07-01-13
	PLOT DATE = 9/15/2016	DATE - 06-89	REVISED - A. SCHUETZE 09-15-16

STATE OF ILLINOIS
DEPARTMENT OF TRANSPORTATION

TRAFFIC CONTROL AND PROTECTION FOR
SIDE ROADS, INTERSECTIONS, AND DRIVEWAYS

SCALE: NONE SHEET 1 OF 1 SHEETS STA. TO STA.

All dimensions are in inches (millimeters)
unless otherwise shown.

MUN RTE.	SECTION	COUNTY	TOTAL SHEETS	SHEET NO.
		COOK	22	19
FIELD BOOK NO.: TC-10		CONTRACT NO. 61L75		
FED. ROAD DIST. NO. 1		ILLINOIS	FED. AID PROJECT	

E.H.E. PROJECT NO. 565-24-15901

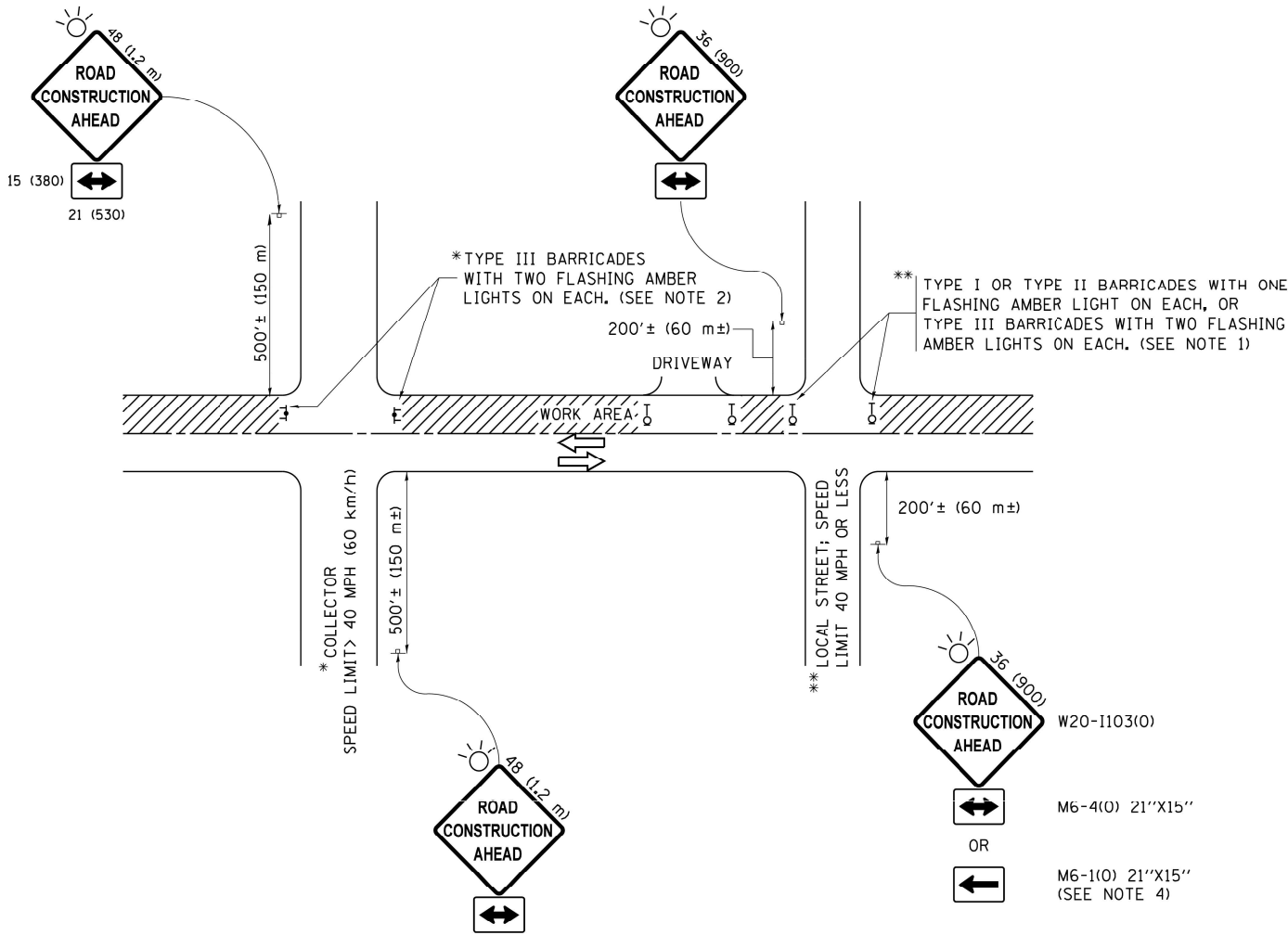

NOTES:

- SIDE ROAD WITH A SPEED LIMIT OF 40 MPH (60 km/h) OR LESS AS SHOWN ON THE DRAWING AND AS DIRECTED BY THE ENGINEER:
 - ONE "ROAD CONSTRUCTION AHEAD" SIGN 36 x 36 (900x900) WITH A FLASHER MOUNTED ON IT APPROXIMATELY 200' (60 m) IN ADVANCE OF THE MAIN ROUTE.
 - THE CLOSED PORTION OF THE MAIN ROUTE SHALL BE PROTECTED BY BLOCKING WITH TYPE I, TYPE II OR TYPE III BARRICADES, 1/3 OF THE CROSS SECTION OF THE CLOSED PORTION.
- SIDE ROAD WITH A SPEED LIMIT GREATER THAN 40 MPH (60 km/h) AS SHOWN ON THE DRAWING AND AS DIRECTED BY THE ENGINEER:
 - ONE "ROAD CONSTRUCTION AHEAD" SIGN 48 x 48 (1.2 m x 1.2 m) WITH A FLASHER MOUNTED ON IT APPROXIMATELY 500' (150 m) IN ADVANCE OF THE MAIN ROUTE.
 - THE CLOSED PORTION OF THE MAIN ROUTE SHALL BE PROTECTED BY BLOCKING WITH TYPE III BARRICADES, 1/2 OF THE CROSS SECTION OF THE CLOSED PORTION.
- CONES MAY BE SUBSTITUTED FOR BARRICADES OR DRUMS AT HALF THE SPACING DURING DAY OPERATIONS. CONES SHALL BE A MINIMUM OF 28 (710) IN HEIGHT.
- WHEN THE SIDE ROAD LIES BETWEEN THE BEGINNING OF THE MAINLINE SIGNING AND THE WORK ZONE, A SINGLE HEADED ARROW (M6-1) SHALL BE USED IN LIEU OF THE DOUBLE HEADED ARROW (M6-4).
- WHEN WORK IS BEING PERFORMED ON A SIDE ROAD OR DRIVEWAY, FOLLOW THE APPLICABLE STANDARD(S). THE DIRECTIONAL ARROW (M6-1 OR M6-4) SHALL BE COVERED OR REMOVED WHEN NO LONGER CONSISTENT WITH THE TRAFFIC CONTROL SET-UP.
- ADVANCE WARNING SIGNS ARE TO BE OMITTED ON DRIVEWAYS UNLESS OTHERWISE SPECIFIED IN THE PLANS OR BY THE ENGINEER.
- THE TRAFFIC CONTROL AND PROTECTION FOR SIDE ROADS, INTERSECTIONS, AND DRIVEWAYS SHALL BE INCLUDED IN THE COST OF SPECIFIED TRAFFIC CONTROL STANDARDS OR ITEMS.

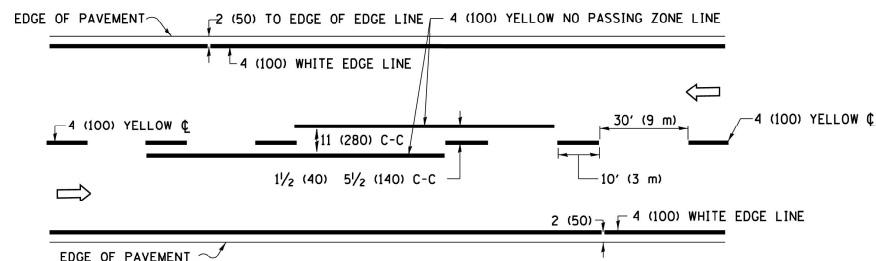

2-LANE ROADWAY

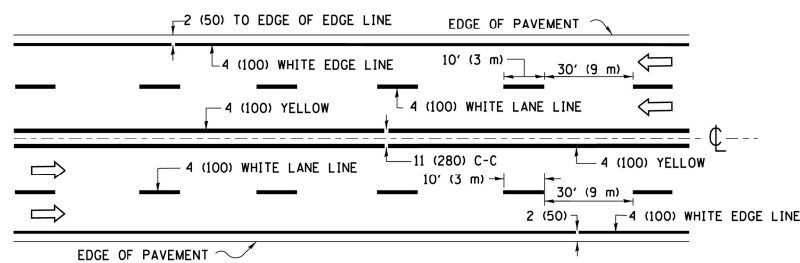

MULTI-LANE UNDIVIDED

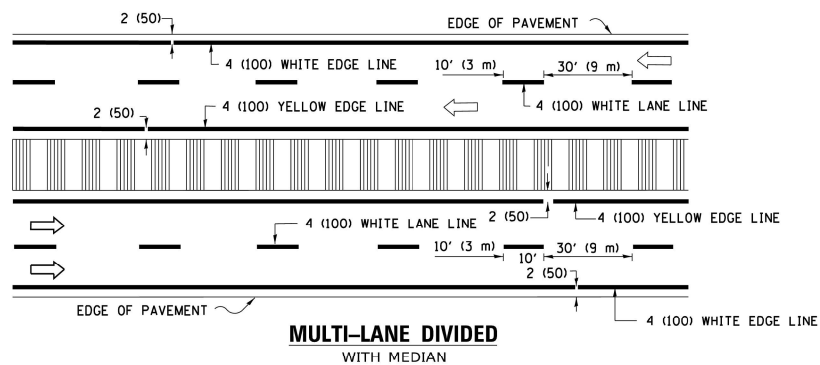

TYPICAL LANE AND EDGE LINE MARKING

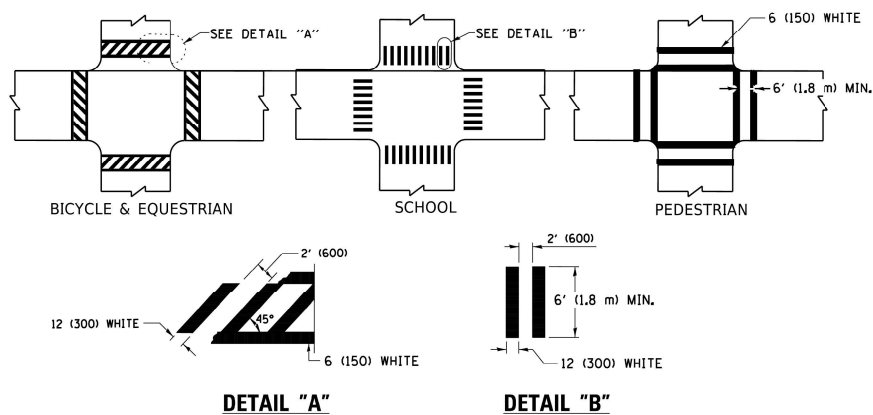

TYPICAL CROSSWALK MARKING

* MARKINGS SHALL BE INSTALLED PARALLEL TO THE CENTERLINE OF THE ROAD WHICH IT CROSSES

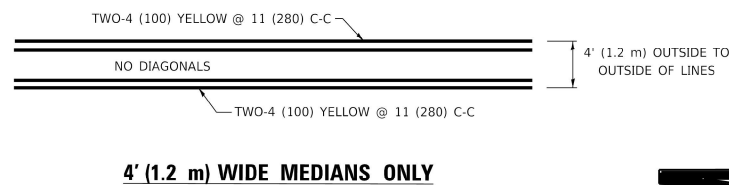

4' (1.2 m) WIDE MEDIANS ONLY

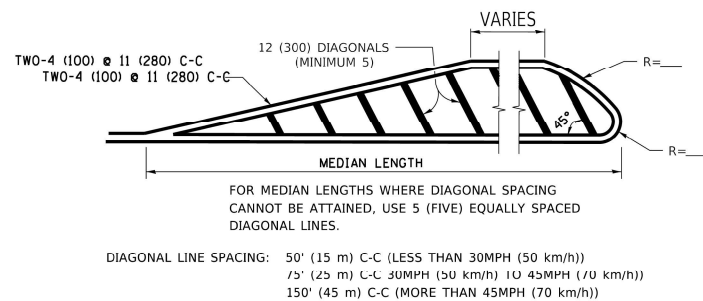

MEDIANS OVER 4' (1.2 m) WIDE

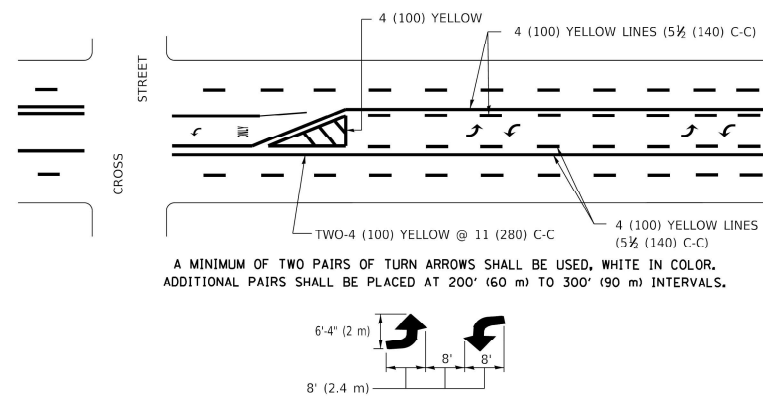

MEDIAN WITH TWO-WAY LEFT TURN LANE

TYPICAL PAINTED MEDIAN MARKING

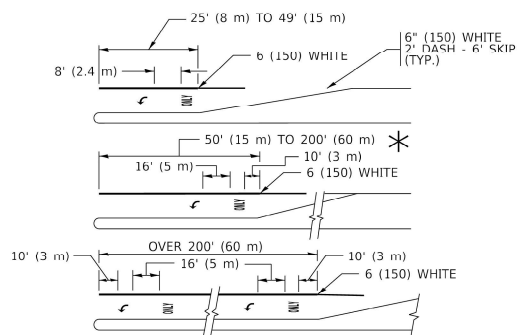

FULL SIZE LETTERS 8' (2.4 m) AND ARROWS SHALL BE USED.

* TURN LANES IN EXCESS OF 400' (120 m) IN LENGTH MAY HAVE AN ADDITIONAL SET OF ARROW - "ONLY" INSTALLED MIDWAY BETWEEN THE OTHER TWO SETS OF ARROW - "ONLY".

TYPICAL LEFT (OR RIGHT) TURN LANE

TYPICAL TURN LANE MARKING

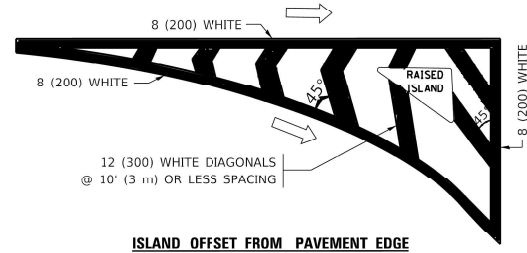

ISLAND OFFSET FROM PAVEMENT EDGE

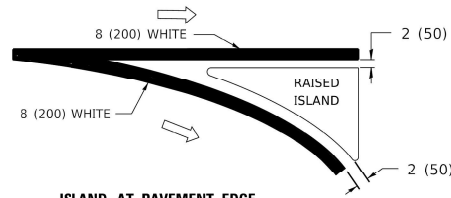

ISLAND AT PAVEMENT EDGE

TYPICAL ISLAND MARKING

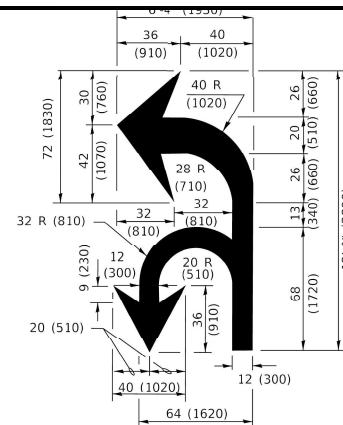

COMBINATION LEFT AND U-TURN

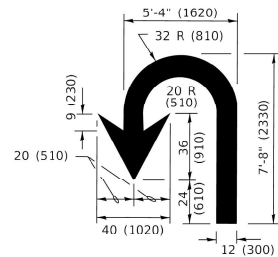

U-TURN

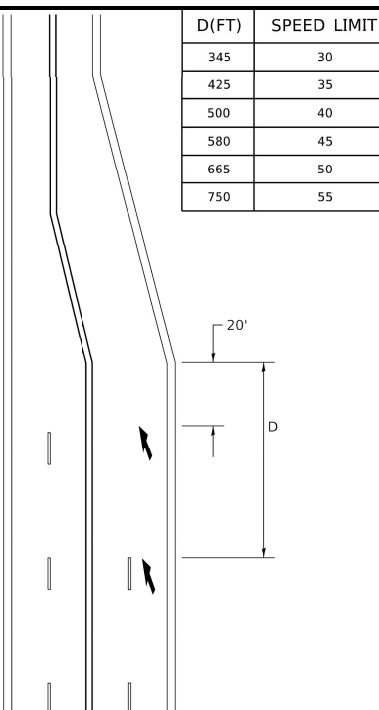

LANE REDUCTION TRANSITION

* LANE REDUCTION ARROWS REQUIRED AT SPEEDS OF 45 MPH OR GREATER OR WHEN SPECIFIED IN PLANS.

TYPE OF MARKING	WIDTH OF LINE	PATTERN	COLOR	SPACING / REMARKS
CENTERLINE ON 2 LANE PAVEMENT	4 (100)	SKIP-DASH	YELLOW	10' (3 m) LINE WITH 30' (9 m) SPACE
CENTERLINE ON MULTI-LANE UNDIVIDED PAVEMENT	2 @ 4 (100)	SOLID	YELLOW	11 (280) C-C
NO PASSING ZONE LINES: FOR ONE DIRECTION FOR BOTH DIRECTIONS	4 (100) 2 @ 4 (100)	SOLID SOLID	YELLOW YELLOW	5½ (140) C-C FROM SKIP-DASH CENTERLINE 11 (280) C-C OMIT SKIP-DASH CENTERLINE BETWEEN
LANE LINES	4 (100) 5 (125) ON FREEWAYS	SKIP-DASH SKIP-DASH	WHITE WHITE	10' (3 m) LINE WITH 30' (9 m) SPACE
DOTTED LINES (EXTENSIONS OF CENTER, LANE OR TURN LANE MARKINGS)	SAME AS LINE BEING EXTENDED	SKIP-DASH	SAME AS LINE BEING EXTENDED	2' (600) LINE WITH 6' (1.8 m) SPACE
EDGE LINES	4 (100)	SOLID	YELLOW-LEFT WHITE-RIGHT	OUTLINE MEDIANS IN YELLOW
TURN LANE MARKINGS	6 (150) LINE; FULL SIZE LETTERS & SYMBOLS (8' (2.4m))	SOLID	WHITE	SEE TYPICAL TURN LANE MARKING DETAIL
TWO WAY LEFT TURN MARKING	2 @ 4 (100) EACH DIRECTION 8' (2.4m) LEFT ARROW	SKIP-DASH AND SOLID IN PAIRS	YELLOW WHITE	10' (3 m) LINE WITH 30' (9 m) SPACE FOR SKIP-DASH; 5½ (140) C-C BETWEEN SOLID LINE AND SKIP-DASH LINE SEE TYPICAL TWO-WAY LEFT TURN MARKING DETAIL
CROSSWALK LINES (PEDESTRIAN) A. DIAGONALS (RIKE & EQUESTRIAN) B. LONGITUDINAL BARS (SCHOOL)	2 @ 6 (150) 12 (300) @ 45° 12 (300) @ 90°	SOLID SOLID SOLID	WHITE WHITE WHITE	NOT LESS THAN 6' (1.8 m) APART 2' (600) APART 2' (600) APART SEE TYPICAL CROSSWALK MARKING DETAILS.
STOP LINES	24 (600)	SOLID	WHITE	PLACE 4' (1.2 m) IN ADVANCE OF AND PARALLEL TO CROSSWALK, IF PRESENT. OTHERWISE, PLACE AT DESIRED STOPPING POINT, PARALLEL TO CROSSROAD CENTERLINE, WHERE POSSIBLE
PAINTED MEDIANS	2 @ 4 (100) WITH 12 (300) DIAGONALS @ 45° NO DIAGONALS USED FOR 4' (1.2 m) WIDE MEDIANS	SOLID	YELLOW: TWO WAY TRAFFIC WHITE: ONE WAY TRAFFIC	11 (280) C-C FOR THE DOUBLE LINE SEE TYPICAL PAINTED MEDIAN MARKING.
GORE MARKING AND CHANNELIZING LINES	8 (200) WITH 12 (300) DIAGONALS @ 45°	SOLID	WHITE	DIAGONALS: 15' (4.5 m) C-C (LESS THAN 30MPH (50 km/h)) 20' (6 m) C-C 30MPH (50 km/h) TO 45MPH (70 km/h)) 30' (9 m) C-C (OVER 45MPH (70 km/h))
RAILROAD CROSSING	24 (600) TRANSVERSE LINES; "RR" IS 6' (1.8 m) LETTERS; 16 (400) LINE FOR "X"	SOLID	WHITE	SEE STATE STANDARD 780001 AREA OF: "R"=3.6 SQ. FT. (0.33 m ²) EACH "X"=54.0 SQ. FT. (5.0 m ²)
SHOULDER DIAGONALS (REQUIRED FOR SHOULDERS ≥ 8')	12 (300) @ 45°	SOLID	WHITE - RIGHT YELLOW - LEFT	50' (15 m) C-C (LESS THAN 30MPH (50 km/h)) 150' (45 m) C-C (30 MPH (50 km/h) TO 45MPH (70 km/h)) 150' (45 m) C-C (OVER 45MPH (70 km/h))
U TURN ARROW	SEE DETAIL	SOLID	WHITE	16.3 SF
2 ARROW COMBINATION LEFT AND U TURN	SEE DETAIL	SOLID	WHITE	30.4 SF

FOR FURTHER DETAILS ON PAVEMENT MARKING REFER TO
STANDARD SPECIFICATIONS FOR ROAD AND BRIDGE
CONSTRUCTION AND STATE STANDARD 780001.

All dimensions are in inches (millimeters) unless otherwise shown.

USER NAME = footemj	DESIGNED - EVERS	REVISED - C. JUCIUS 09-09-09
	DRAWN -	REVISED - C. JUCIUS 07-01-13
PLOT SCALE = 50.0000' / in.	CHECKED -	REVISED - C. JUCIUS 12-21-15
PLOT DATE = 3/4/2019	DATE - 03-19-90	REVISED - C. JUCIUS 04-12-16

**STATE OF ILLINOIS
DEPARTMENT OF TRANSPORTATION**

DISTRICT ONE

TYPICAL PAVEMENT MARKINGS

SCALE: NONE	SHEET 1 OF 2 SHEETS	STA. TO STA.
-------------	---------------------	--------------

MUN RTE.	SECTION	COUNTY	TOTAL SHEETS	SHEET NO.
2742	24-00145-00-RS	COOK	22	20
FIELD BOOK NO. : TC-13		CONTRACT NO. 61L75		
FED. ROAD DIST. NO. 1	ILLINOIS	FED. AID PROJECT		

E.H.E. PROJECT NO. 565-24-15901

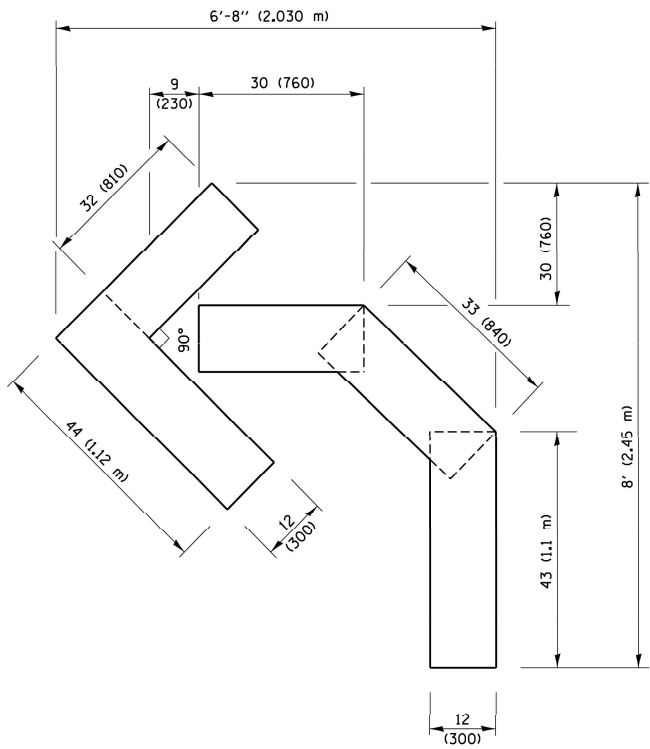

QUANTITY
4 (100) LINE = 45.5 ft. (13.9 m)
15.2 sq. ft. (1.41 sq. m)

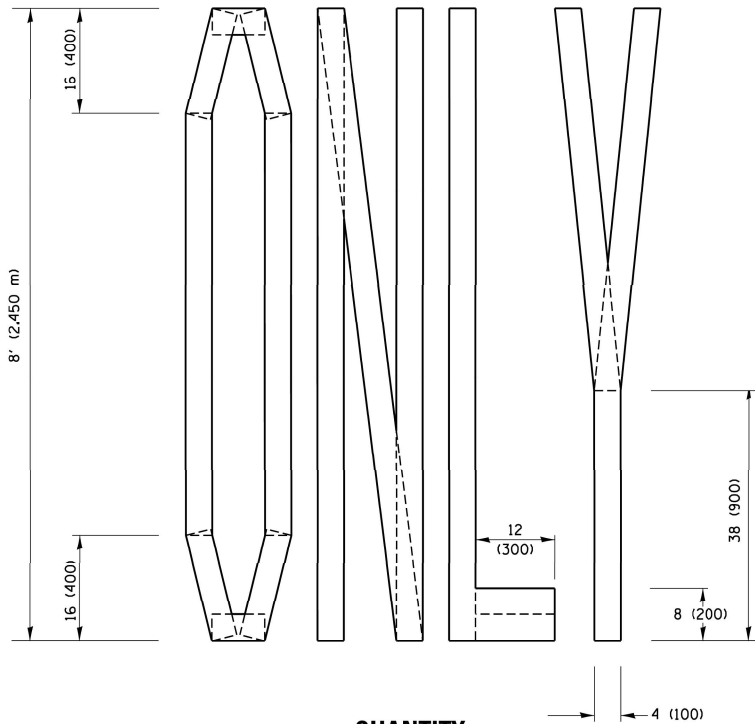
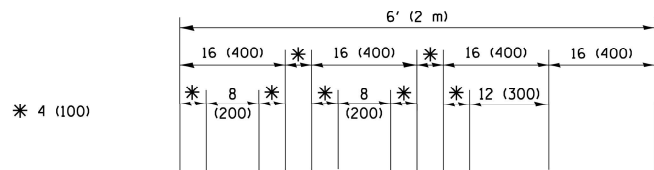

QUANTITY
4 (100) LINE = 64.1 ft. (19.5 m)
21.4 sq. ft. (1.99 sq. m)

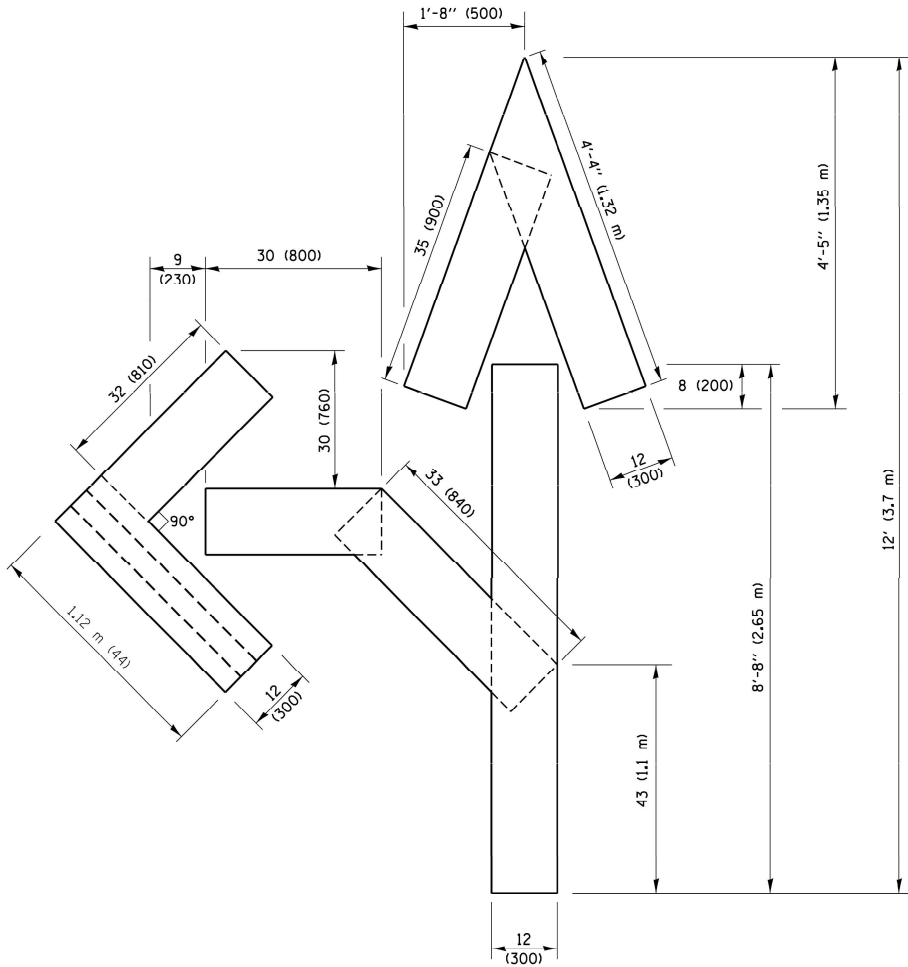

QUANTITY
4 (100) LINE = 82.5 ft. (25.1 m)
27.5 sq. ft. (2.53 sq. m)

NOTE:

ALL QUANTITIES OF PLACEMENT ARE REPRESENTED IN LINEAR FEET OF 4" LINES TO MATCH THE 4" TEMPORARY TAPE PAY ITEM AND REPRESENTS THE TOTAL QUANTITY OF 4" TAPE REQUIRED.

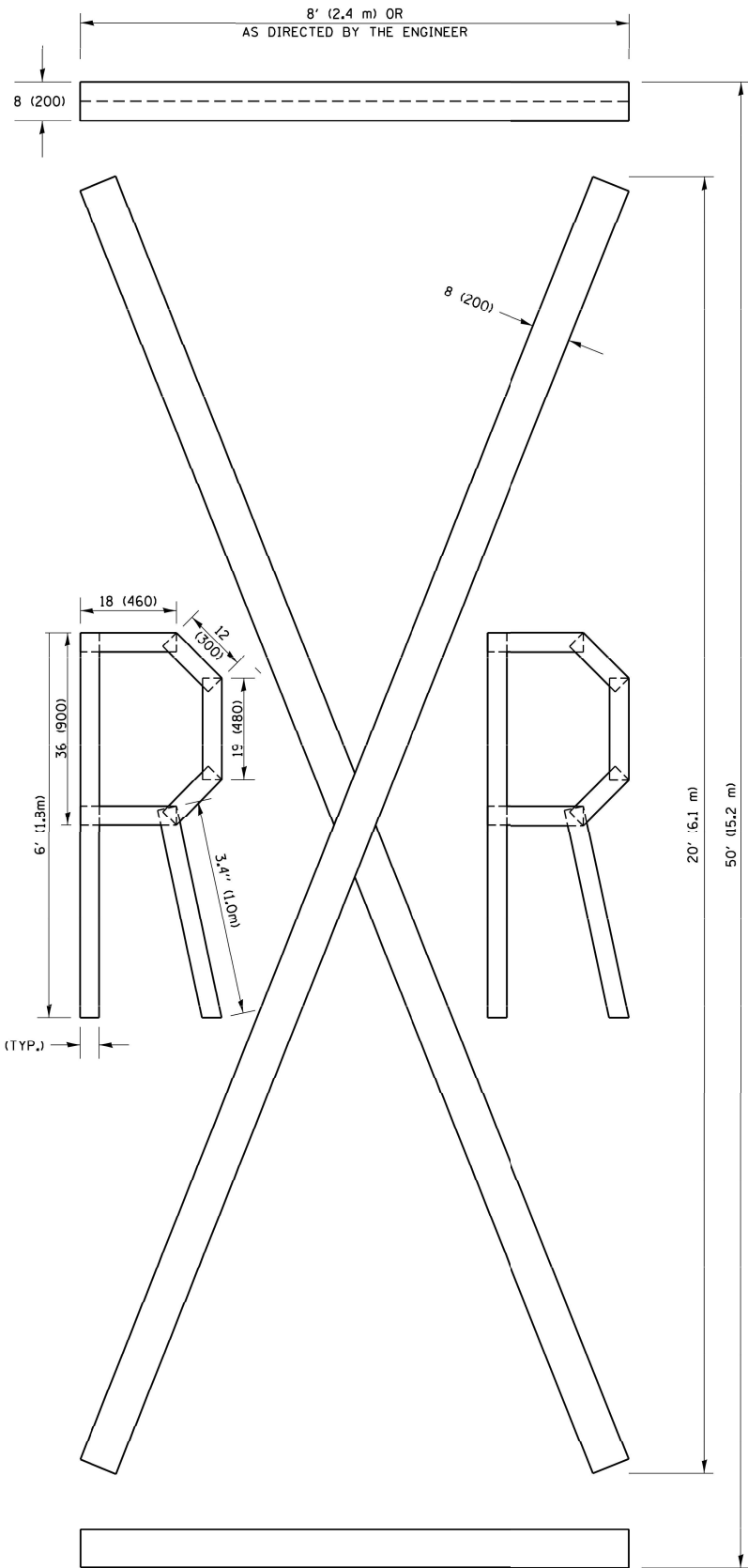

QUANTITY
4 (100) LINE = 225.9 ft. (68.9 m)
75.3 sq. ft. (6.99 sq. m)

All dimensions are in inches (millimeters) unless otherwise shown.

FILE NAME =	USER NAME = footemj	DESIGNED -	REVISED - T. RAMMACHER 03-02-98
pwt:\IL084EBIDINTEG\Illinois.gov\PI\DOT Documents\DOT Offices\District 1\Projects\District 1\CADData\CADsheets\tol6.dgn		DRAWN -	REVISED - E. GOMEZ 08-28-00
PLOT SCALE = 50,0000 ' / in.		CHECKED -	REVISED - E. GOMEZ 08-28-00
PLOT DATE = 9/15/2016		DATE - 09-18-94	REVISED - A. SCHUETZE 09-15-16

STATE OF ILLINOIS DEPARTMENT OF TRANSPORTATION				SHORT TERM PAVEMENT MARKING LETTERS AND SYMBOLS				MUN RTE.	SECTION	COUNTY	TOTAL SHEETS	SHEET NO.		
								XX	24-00144-00-MS	COOK	22	21		
				FIELD BOOK NO. : - TC-16						CONTRACT NO. 61L75				
				SCALE: NONE	SHEET NO. 1 OF 1 SHEETS	STA.	TO STA.			FED. ROAD DIST. NO. 1	ILLINOIS	FED. AID PROJECT		

