

INSTALL NEW 20A, 2-POLE, 600V, NEMA 3R DISCONNECT AND 480V-120/240V TRANSFORMER ON FRANGIBLE UNISTRUT SUPPORT. COST SHALL BE INCIDENTAL TO "VAULT MODIFICATIONS".

- NOTES:
1. REMOVE EXISTING POWER ADAPTER FOR REILS. INSTALL NEW 120/240V, 3-WIRE POWER FEED TO MASTER REIL FOR RUNWAY 18 AND RUNWAY 36. COST SHALL BE INCIDENTAL TO INSTALLATION OF CABLE AND VAULT MODIFICATIONS.
 2. CORE HOLE INTO EXISTING MANHOLE AND CONNECT NEW UNIT DUCT. COST SHALL BE INCIDENTAL TO UNIT DUCT INSTALLATION.

NEW 4,560 LF 2-#4 XLP-USE, 1-#10 GND IN 1-1/4" UD (TYP)

NEW RUNWAY 18 REIL CIRCUIT

2 #4 XLP-USE, 1 #10 GND. IN 1-1/4" UD IN EXISTING 2" CONDUIT.

SEE NOTE 2

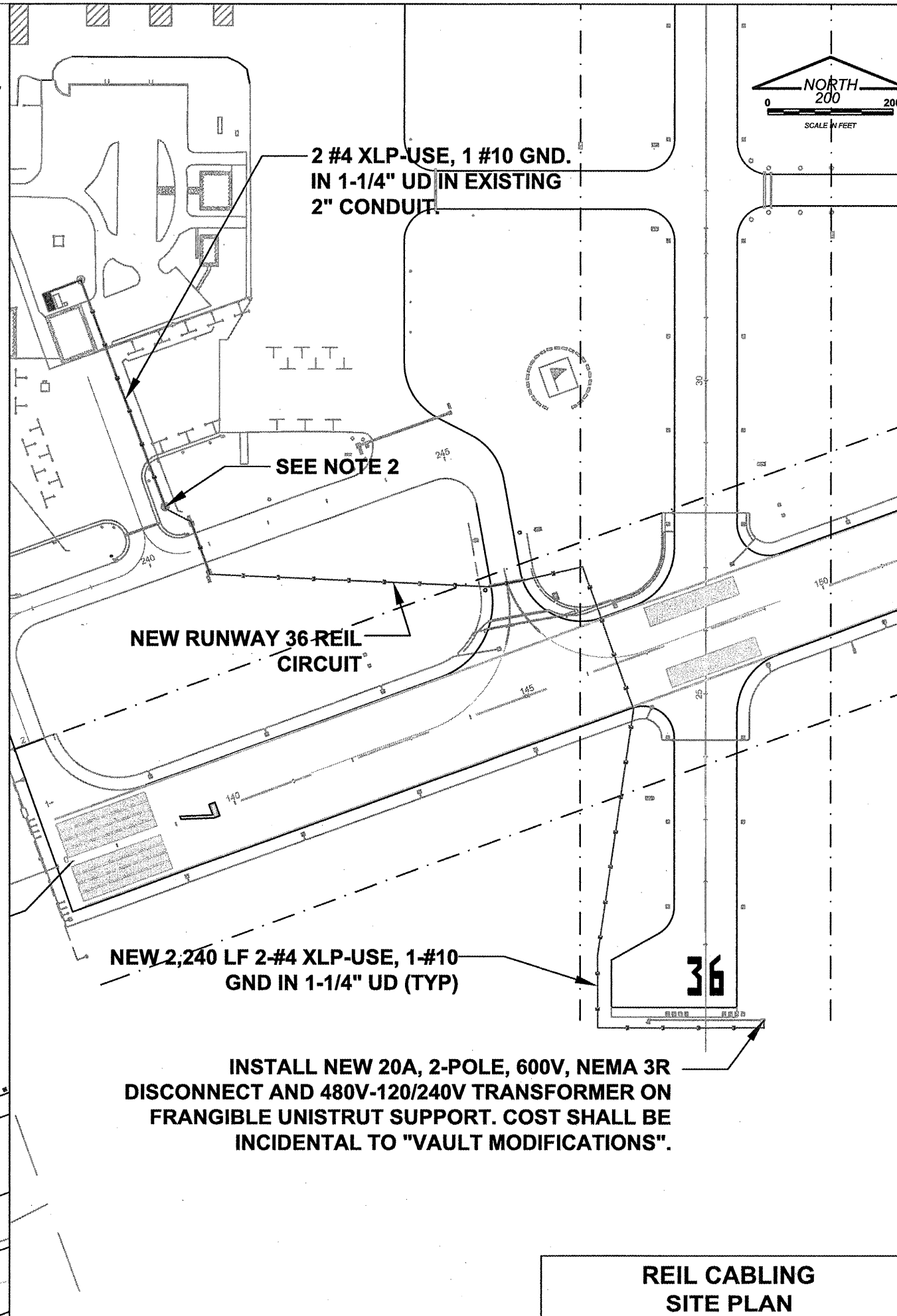

2 #4 XLP-USE, 1 #10 GND. IN 1-1/4" UD IN EXISTING 2" CONDUIT.

SEE NOTE 2

NEW RUNWAY 36-REIL CIRCUIT

NEW 2,240 LF 2-#4 XLP-USE, 1-#10 GND IN 1-1/4" UD (TYP)

INSTALL NEW 20A, 2-POLE, 600V, NEMA 3R DISCONNECT AND 480V-120/240V TRANSFORMER ON FRANGIBLE UNISTRUT SUPPORT. COST SHALL BE INCIDENTAL TO "VAULT MODIFICATIONS".

REIL CABLING SITE PLAN

WH007



CRAWFORD, MURPHY & TILLY, INC.
CONSULTING ENGINEERS
© Copyright CMT, Inc.

Whiteside County **AIRPORT**
JOSEPH H. BITTORE FIELD

Whiteside County Airport

Sterling / Rock Falls, Illinois

Whiteside County Airport

AIP: 3-17-0098-B14
SQI-3830

REHABILITATE TAXIWAY EDGE LIGHTS (PARALLEL / CONNECTING TAXIWAYS A AND E EAST OF RUNWAY 18/36)

Revisions

No.	Date	Description

0 1
THIS BAR IS EQUAL TO 1" AT FULL SCALE (17 X 11).

DESIGN BY: CMT-RFD
DRAWN BY: CMT-RFD
CHECKED BY: CMT-RFD
APPROVED BY: JGP
DATE: 7.25.2008
JOB No: 08292-04-00

REIL CABLING SITE PLAN (RSP1)

15

SHEET 15 OF 15 SHEETS