

**INDEX OF SHEETS**

SHEET NO.	DESCRIPTION
1.	COVER SHEET, INDEX OF SHEETS AND STANDARDS
2.	GENERAL NOTES
3. - 4.	SUMMARY OF QUANTITIES
5. - 6.	TYPICAL SECTIONS
7. - 8.	SCHEDULE OF QUANTITIES
9. - 10.	PLAN AND PROFILE SHEETS
11. - 13.	STAGING PLANS
14. - 15.	ROW SHEETS
16. - 31.	BRIDGE PLANS
32.	SN 047-2020 BOX CULVERT DETAILS
33. - 36.	EXISTING BRIDGE PLANS (FOR INFORMATION ONLY)
37. - 39.	DETAILS
40. - 61.	CROSS SECTIONS

**HIGHWAY STANDARDS**

00001-05	STANDARD SYMBOLS, ABBREVIATIONS AND PATTERNS
001001-01	AREAS OF REINFORCEMENT REBARS
001006	DECIMAL OF AN INCH AND OF A FOOT
515001-02	NAME PLATE FOR BRIDGES
630001-07	STEEL PLATE BEAM GUARDRAIL
630101-07	GUARDRAIL MOUNTED ON EXISTING CULVERTS
630201-05	PCC/BITUMINOUS STABILIZATION AT STEEL PLATE BEAM GUARDRAIL
630301-04	SHOULDER WIDENING FOR TYPE 1 (SPECIAL) GUARDRAIL TERMINALS
635006-02	REFLECTOR AND TERMINAL MARKER PLACEMENT
635011-01	REFLECTOR MARKER AND MOUNTING DETAILS
701006-02	OFF-RD. OPERATIONS 2L, 2W 4.5 m (15') TO PAVEMENT EDGE FOR SPEEDS ≥ 45 MPH
701201-02	LANE CLOSURE, 2L, 2W DAY ONLY ON-RD. TO 600 MM (24") FOR SPEEDS ≥ 45 MPH
701301-02	LANE CLOSURE 2L, 2W SHORT TERM OPERATIONS
701306-01	LANE CLOSURE 2L, 2W SLOW MOVING OPERATIONS - DAY ONLY FOR SPEEDS ≥ 45 MPH
701311-02	LANE CLOSURE 2L, 2W MOVING OPERATIONS - DAY ONLY
701321-09	LANE CLOSURE 2L, 2W BRIDGE REPAIR WITH BARRIER
701326-02	LANE CLOSURE 2L, 2W PAVEMENT WIDENING FOR SPEEDS ≥ 45 MPH
701901	TRAFFIC CONTROL DEVICES
704001-04	TEMPORARY CONCRETE BARRIER
780001-01	TYPICAL PAVEMENT MARKINGS

MICROFILMED \_\_\_\_\_  
 REEL NUMBER \_\_\_\_\_  
 AWARDED \_\_\_\_\_  
 RESIDENT ENGINEER \_\_\_\_\_  
 AS BUILT CHANGES WERE MADE  
 ON THE FOLLOWING SHEETS \_\_\_\_\_

JULIE 1-800-892-0123

**PROJECT ENGINEER: JOE KANNEL**  
**UNIT CHIEF: PAT BRABOY**  
**TOWNSHIP: LISBON**

**CONTRACT NO. 66667**

# STATE OF ILLINOIS DEPARTMENT OF TRANSPORTATION DIVISION OF HIGHWAYS PLANS FOR PROPOSED FEDERAL AID HIGHWAY

FAP ROUTE 607 (US 52)

SECTION 129 BR

PROJECT ACF-0607(077)

KENDALL COUNTY

C - 93 - 056 - 05

BRIDGE REPLACEMENT

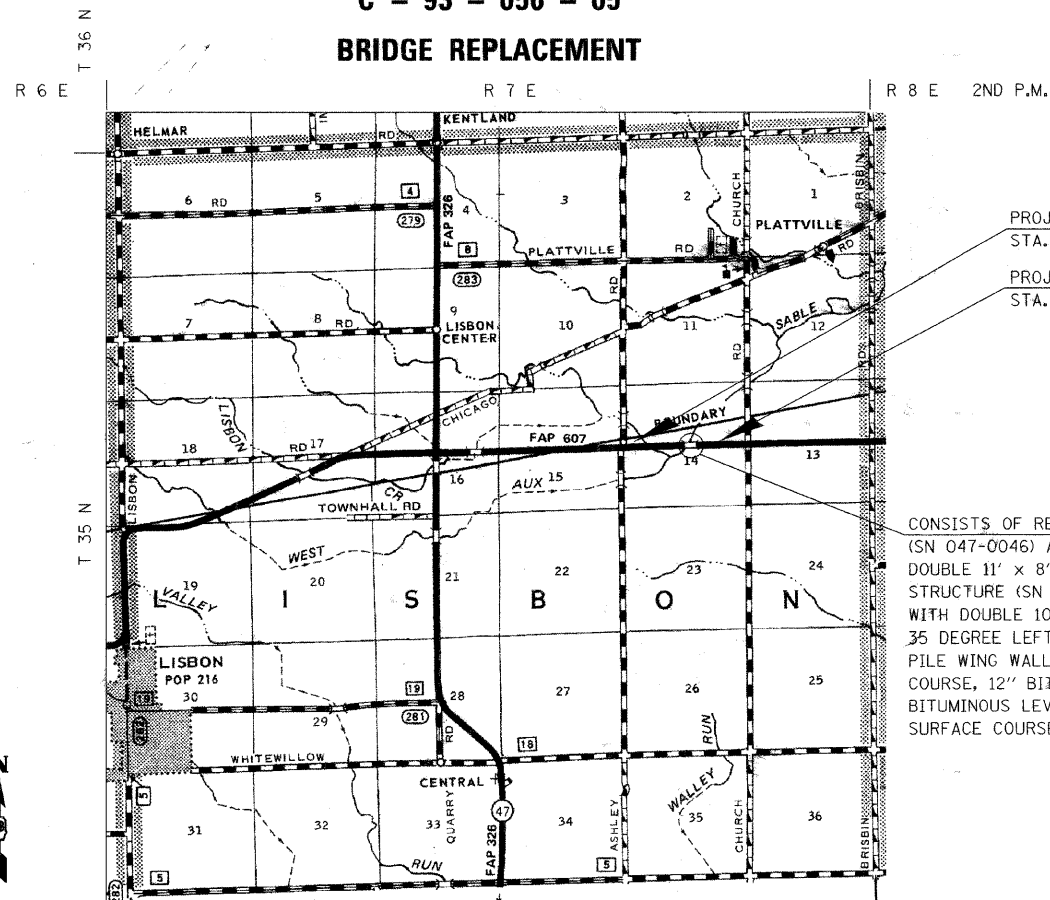

**LOCATION MAP**  
 NOT TO SCALE

GROSS LENGTH = 653.00 FT. = 0.124 MI.  
 NET LENGTH = 653.00 FT. = 0.124 MI.

**PRINTED BY THE AUTHORITY  
 OF THE STATE OF ILLINOIS**

F.A.P. RTE.	SECTION	COUNTY	TOTAL SHEETS	SHEET NO.
607	129 BR	KENDALL	61	1

P-93-029-04  
 D-93-037-05

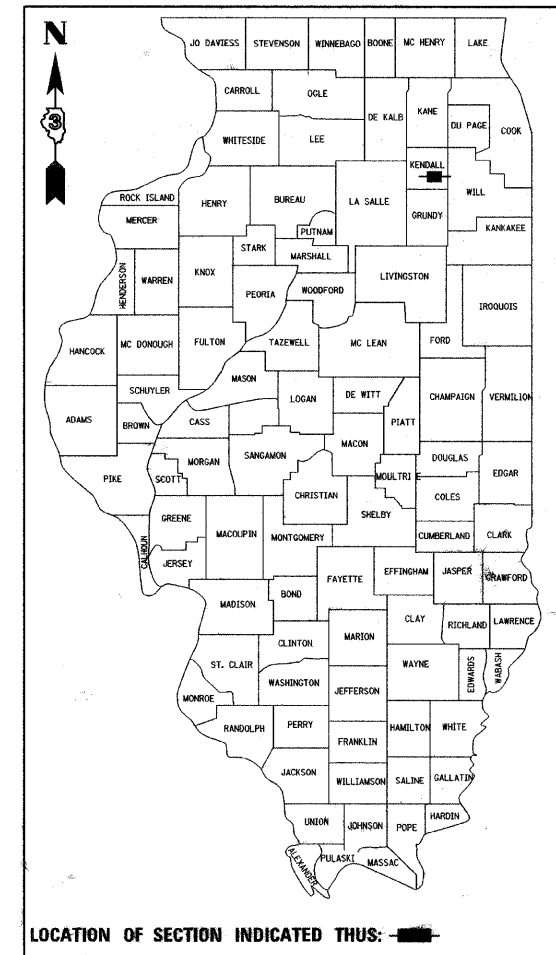

LOCATION OF SECTION INDICATED THUS: [Symbol]

**FUNCTION CLASSIFICATION**  
**RURAL MINOR ARTERIAL**

2008 ADT = 3400

P.C. = 75.9% S.U. = 13.8% M.U. = 10.3%

STATE OF ILLINOIS  
 DEPARTMENT OF TRANSPORTATION  
 DIVISION OF HIGHWAYS

SUBMITTED 20 \_\_\_\_\_

*George Pagan*  
 DEPUTY DIRECTOR OF HIGHWAYS, REGION ENGINEER

*Eric E. Harwood*  
 ENGINEER OF DESIGN AND ENVIRONMENT

*October 3, 2008*  
*Christine M. Reed*  
 DIRECTOR OF HIGHWAYS, CHIEF ENGINEER

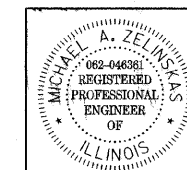

I hereby certify that this engineering document was prepared by me or under my direct personal supervision and that I am a duly Registered Professional Engineer under the laws of the State of Illinois.

*Michael A. Zelinskas*  
 Date: 11/01/2007  
 My registration expires November 30, 2007

Pages or sheets covered by this seal: 1-13; 37-61

10/17/2007  
 K:\DEPT\116691\1\From Dub 12-29-06\SN047-0016cover.sht.dgn  
 PLOT SCALE \$SCALE\$  
 REFERENCE \$REF\$  
 OPERATOR -USER-