

COUNTY HWY.	FISCAL YEAR	TOTAL SHEETS	SHEET NO.
FAU 0856	2008	25	19
SEC. 07-00232-05-TL DUPAGE CO.			

RESTORATION OF WORK AREA

RESTORATION OF THE TRAFFIC SIGNAL WORK AREA SHALL BE INCIDENTAL TO THE RELATED PAY ITEM SUCH AS FOUNDATION, CONDUIT, HANDHOLE, TRENCH AND BACKFILL, ETC., AND NO EXTRA COMPENSATION SHALL BE ALLOWED. ALL ROADWAY SURFACES SUCH AS SHOULDERS, MEDIANS, SIDEWALKS, PAVEMENT, ETC. SHALL BE REPLACED IN KIND. ALL DAMAGE TO MOWED LAWNS SHALL BE REPLACED WITH AN APPROVED SOD, AND ALL DAMAGE TO UNMOWED FIELDS SHALL BE SEEDED IN ACCORDANCE WITH STANDARD SPECIFICATIONS 252 AND 250 RESPECTIVELY.

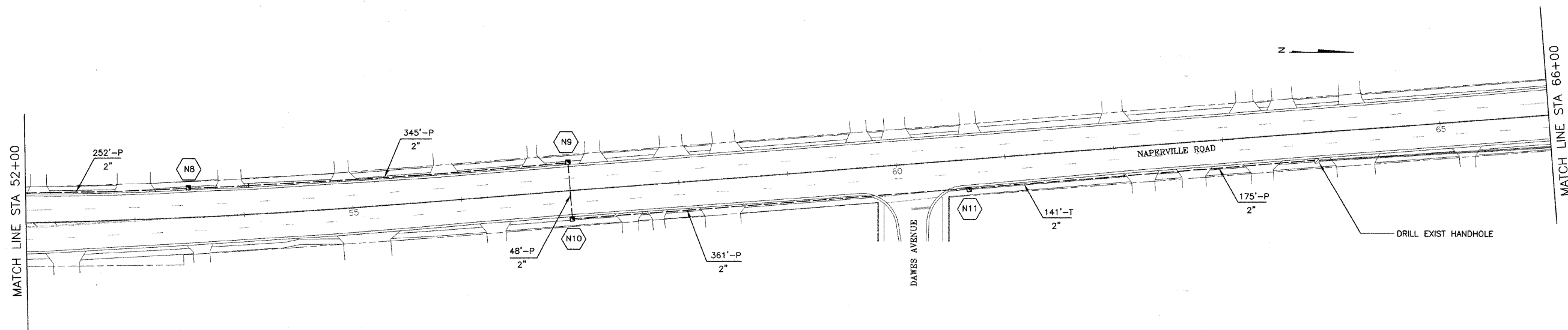
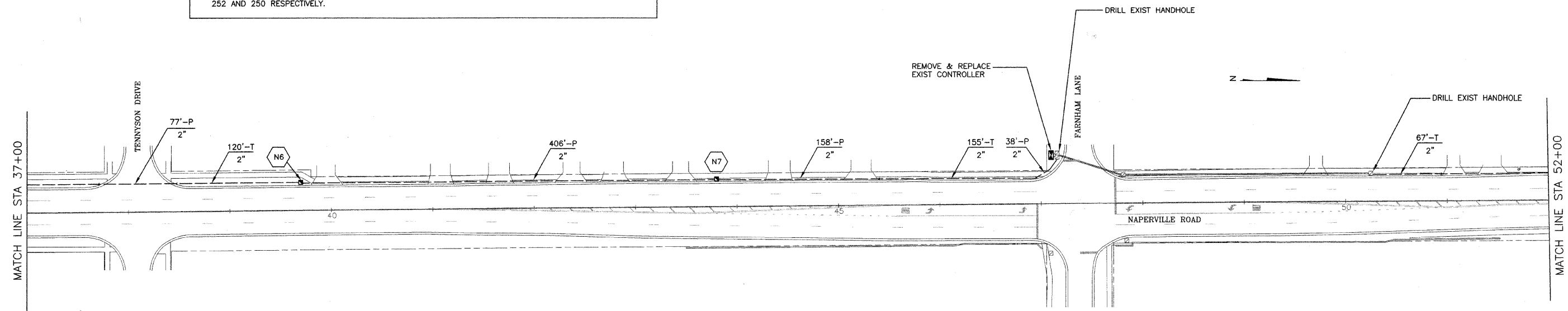

REVISIONS	
NAME	DATE

DUPAGE COUNTY DIVISION OF TRANSPORTATION

NAPERVILLE ROAD
TRAFFIC SIGNAL INTERCONNECT PLAN
DANADA DRIVE TO ELM STREET

SCALE: 1"=50'
DATE: 8/21/08

DRAWN BY: TH
DESIGNED BY: TH
CHECKED BY: DAZ