

PROFILE	SUBMITTED	BY	DATE
NOTE BOOK	PLACES CHECKED		
NO.	BLM NOTED		
	STRUCTURE NOTATIONS CHRD		

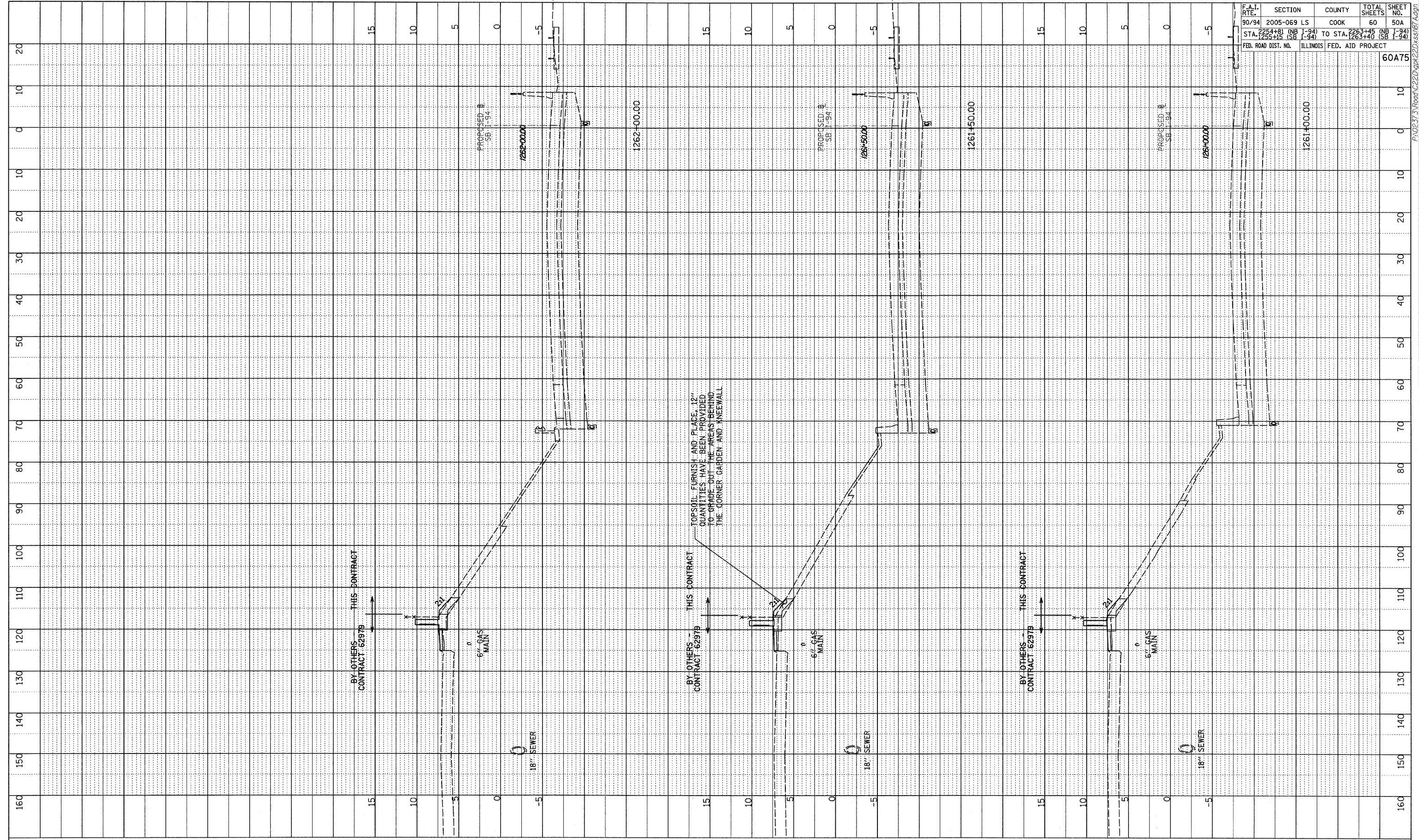

F.A.I. RTE.	SECTION	COUNTY	TOTAL SHEETS	SHEET NO.
90/94	2005-069 LS	COOK	60	50A
STA. 1265+15 (SB I-94)	TO STA. 1263+45 (NB I-94)		60A75	
FED. ROAD DIST. NO.	ILLINOIS FED. AID PROJECT			

TYLIN INTERNATIONAL

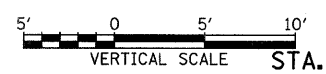
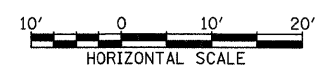

SB I-94 (DAN RYAN EXPRESSWAY)  
STA. 1261+00.00 TO STA. 1262+00.00

F:\02373\Road\222D\gpk222D\ss187.dgn