

STATE OF ILLINOIS
DEPARTMENT OF TRANSPORTATION
DIVISION OF HIGHWAYS
**PLANS FOR PROPOSED
FEDERAL AID HIGHWAY**

F. A. U. NO.	SECTION	COUNTY	TOTAL SHEETS	SHEET NO.
15-00021-00-SW	COOK	13	1	
STA.		TO STA.		
FED. ROAD DIST. NO. 1		ILLINOIS		
		FED. AID PROJECT SRTS-4009(331)		

CONTRACT #61B95

INDEX OF SHEETS

1. COVER SHEET
2. SUMMARY OF QUANTITIES
3. TYPICAL SECTIONS
- 4.-12. SIDEWALK PLAN AND PROFILE
13. IDOT DISTRICT 1 STANDARD DETAILS

**VARIOUS LOCAL ROUTES
SIDEWALK REPLACEMENT
PROJECT: SRTS-4009(331)
SECTION NO.:15-00021-00-SW
VILLAGE of PHOENIX
COOK COUNTY
C-91-273-15**

HIGHWAY STANDARDS

- | | |
|-----------|---|
| 424001-08 | PERPENDICULAR CURB RAMPS FOR SIDEWALKS |
| 606001-06 | CONCRETE CURB TYPE B AND COMBINATION CONCRETE CURB AND GUTTER |
| 701006-05 | OFF ROAD OPERATIONS, 2L, 2W, 15' TO 24" FROM PAVEMENT EDGE |
| 701801-05 | SIDEWALK, CORNER OR CROSSWALK CLOSURE |
| 701901-04 | TRAFFIC CONTROL DEVICES |

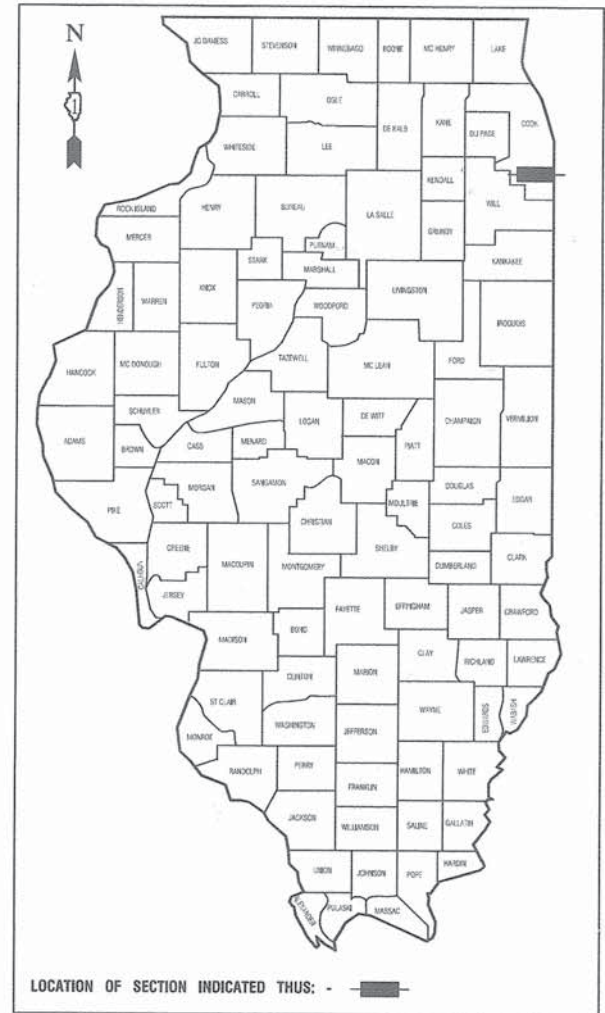

STATE OF ILLINOIS DEPARTMENT OF TRANSPORTATION
DIVISION OF HIGHWAYS

Approved: _____
[Signature] 7-30-15
President, Village of PHOENIX

Passed: _____
8-31-15
[Signature]
District 1 Engineer of Local Roads & Streets

Released for Bid Based on Limited Review: _____
September 2, 2015
[Signature]
Deputy Director of Highways, Region 1 Engineer

PRINTED BY THE AUTHORITY OF
THE STATE OF ILLINOIS

PREPARED BY OR UNDER THE DIRECT SUPERVISION OF:
[Signature] 7-30-15
TROY A. GOLEN
61-43770
LICENSED PROFESSIONAL ENGINEER
STATE OF ILLINOIS
LICENSE EXPIRES: 11/30/15

FEDERAL AID PROGRAM ENGINEER: FAWAD AQUEEL, P.E. 847-705-4021, SCHAMBOURG, IL
CONSULTANTS: ROBINSON ENGINEERING, LTD. 708-331-6700

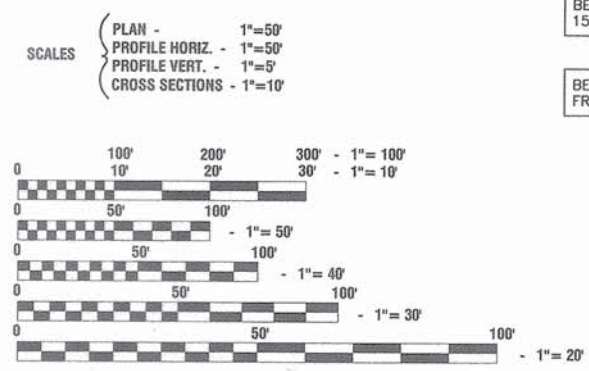

FULL SIZE PLANS HAVE BEEN PREPARED USING STANDARD ENGINEERING SCALES, REDUCED SIZED PLANS WILL NOT CONFORM TO STANDARD SCALES, IN MAKING MEASUREMENTS ON REDUCED PLANS, THE ABOVE SCALES MAY BE USED.

J. U. L. I. E.
JOINT UTILITY LOCATION INFORMATION FOR EXCAVATION
1-800-892-0123 or 811

CONTRACT NO. 61B95

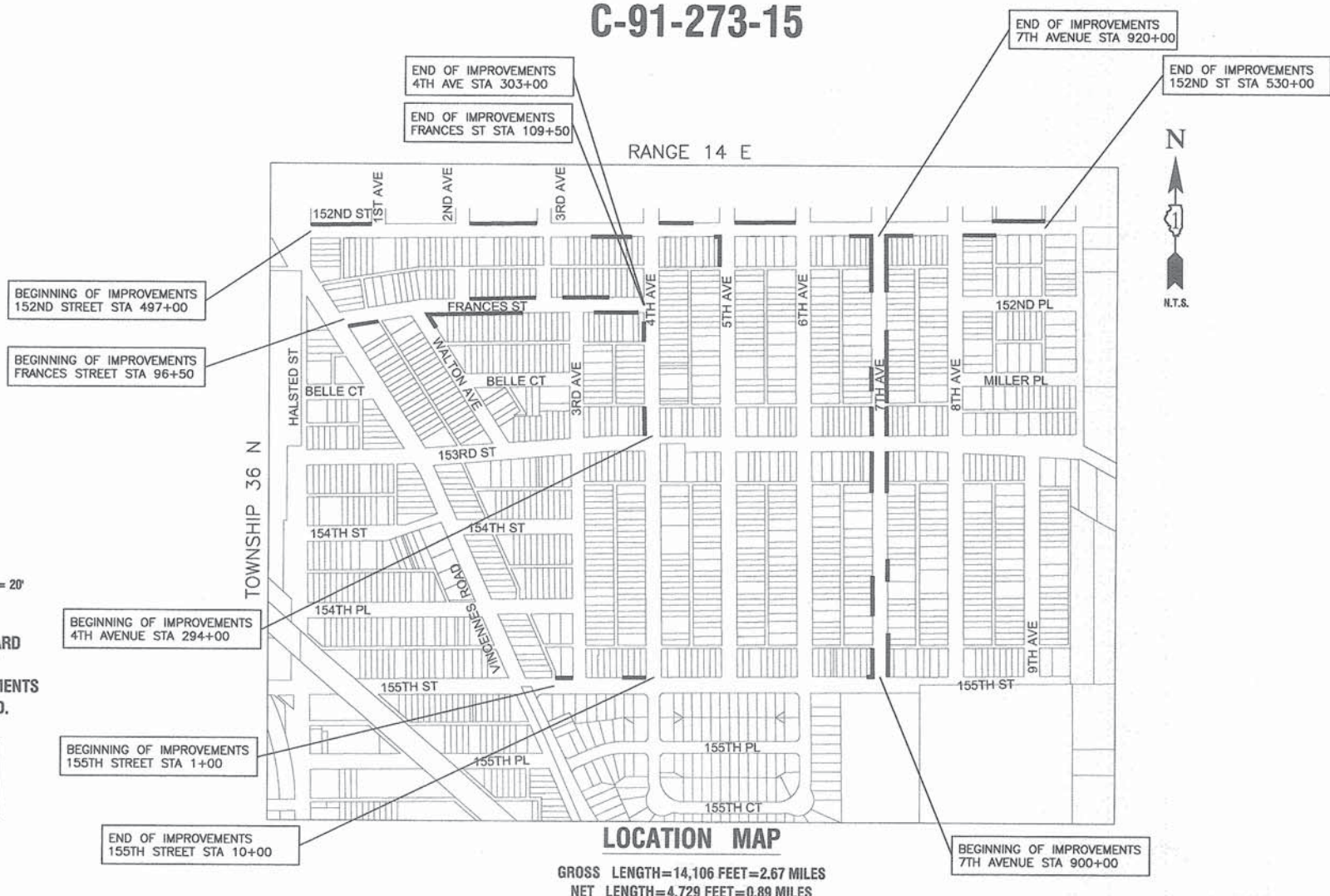

SUMMARY OF QUANTITIES					CONSTRUCTION TYPE CODE
S.I.	CODE NO.	ITEM	UNIT	QUAN	0028
	21101615	TOPSOIL FURNISH AND PLACE, 4"	SQ YD	1115	1115
	25000100	SEEDING, CLASS 1	ACRE	0.25	0.25
	35101598	AGGREGATE BASE COURSE, TYPE B 3"	SQ YD	2785	2785
	42300200	PORTLAND CEMENT CONCRETE DRIVEWAY PAVEMENT, 6 INCH	SQ YD	15	15
	42400200	PORTLAND CEMENT CONCRETE SIDEWALK 5 INCH	SQ FT	23925	23925
	42400300	PORTLAND CEMENT CONCRETE SIDEWALK 6 INCH	SQ FT	1160	1160
	42400800	DETECTABLE WARNINGS	SQ FT	130	130
	44000200	DRIVEWAY PAVEMENT REMOVAL	SQ YD	60	60
	44000600	SIDEWALK REMOVAL	SQ FT	25085	25085
	56500600	DOMESTIC WATER SERVICE BOXES TO BE ADJUSTED	EACH	1	1
	67100100	MOBILIZATION	LSUM	1	1
	70102640	TRAFFIC CONTROL AND PROTECTION, STANDARD 701801	LSUM	1	1
	Z0004562	COMBINATION CURB AND GUTTER REMOVAL AND REPLACEMENT	FOOT	20	20
	Z0066600	STABILIZED DRIVEWAYS 8"	SQ YD	45	45
	X0327545	SOIL SAMPLING AND TESTING	EACH	1	1

* - INDICATES SPECIALTY ITEMS

GENERAL NOTES

- BOTH THE ROBINSON ENGINEERING, LTD. FIELD OFFICE (708-331-6700) AND THE VILLAGE OF PHOENIX (708-331-2636) SHALL BE NOTIFIED TWO (2) WORKING DAYS BEFORE CONSTRUCTION BEGINS.
- AREAS DISTURBED BY CONSTRUCTION SHALL BE KEPT TO A MINIMUM. ALL AREAS DISTURBED UNNECESSARILY SHALL BE RESTORED AS REQUIRED IN THE SPECIAL PROVISION AT THE CONTRACTOR'S EXPENSE.
- ACCESS TO EXISTING DRIVEWAYS, AND ALL PUBLIC FACILITIES SHALL BE MAINTAINED AT ALL TIMES BY PLACEMENT OF TEMPORARY AGGREGATE. THE CONTRACTOR SHALL PERIODICALLY MONITOR ALL AFFECTED AREAS DURING THE PROJECT, AND SHALL PLACE ADDITIONAL AGGREGATE WHEN NECESSARY.
- UTILITIES INDICATED ON THE PLANS ARE PROVIDED FOR THE CONTRACTOR'S USE AND ARE BASED UPON INFORMATION AVAILABLE AT THE TIME OF THE ADVERTISEMENT FOR BIDS. THE OWNER AND ENGINEER DO NOT GUARANTEE THE ACCURACY OF UTILITIES INFORMATION. IT SHALL BE THE CONTRACTOR'S RESPONSIBILITY TO NOTIFY J.U.L.I.E. AT LEAST 48 HOURS PRIOR TO EXCAVATION TO VERIFY LOCATIONS OF ALL UTILITIES. IF DETERMINED NECESSARY UTILITY RELOCATIONS SHALL BE PERFORMED BY PRIVATE UTILITY OWNERS. NO ADDITIONAL COMPENSATION SHALL BE ALLOWED DUE TO DELAYS OR INCONVENIENCES CAUSED BY SUCH ADJUSTMENTS.
- CONTRACTOR SHALL BE RESPONSIBLE AT ALL TIMES FOR TRAFFIC CONTROL AND PROTECTION IN ACCORDANCE WITH IDOT STANDARD SPECIFICATIONS ADOPTED JANUARY 1, 2012, THE LATEST EDITION OF THE ILLINOIS MANUAL ON UNIFORM TRAFFIC CONTROL DEVICES FOR STREETS AND HIGHWAYS, AND THE STANDARD SPECIFICATIONS FOR TRAFFIC CONTROL ITEMS.
- THE TOP OF ALL STRUCTURES SHALL BE FLUSH WITH THE ADJACENT SURFACE OR THE INDICATED ELEVATION SHOWN ON THE PLANS. FRAME ELEVATIONS ARE GIVEN ONLY TO ASSIST IN DETERMINING THE OVERALL HEIGHT OF THE STRUCTURE. FRAMES ON ALL NEW STRUCTURES SHALL BE ADJUSTED TO THE FINAL SURFACE ELEVATION AS PART OF THE NEW STRUCTURE COST.
- ITEMS OF WORK LISTED IN THE SUMMARY OF QUANTITIES NOT SPECIFICALLY CALLED OUT ON THE PLANS SHALL BE PERFORMED AS DIRECTED BY THE ENGINEER.
- THE CONTRACTOR SHALL MAKE EVERY ATTEMPT NOT TO DAMAGE EXISTING TREES.
- CONTRACTOR SHALL PROVIDE THE ENGINEER WITH VIDEOTAPE DETAILING ALL SURFACE CONDITIONS WITHIN THE PROJECT AREA PRIOR TO CONSTRUCTION. ALL RESTORATION SHALL BE COMPLETED TO THE SATISFACTION OF THE OWNER AND ENGINEER.
- IT SHALL BE THE CONTRACTOR'S RESPONSIBILITY TO VERIFY ALL DIMENSIONS AND CONDITIONS EXISTING IN THE FIELD PRIOR TO CONSTRUCTION AND ORDERING OF MATERIALS.
- THE REMOVAL AND/OR REPLACEMENT OF ANY DRIVEWAYS, PAVEMENT, CURB, SIDEWALK, ECT. SHALL BE ACCOMPLISHED BY MEANS OF A SAW CUT JOINT, AT THE DIRECTION OF THE ENGINEER. THIS WORK WILL NOT BE PAID FOR SEPARATELY, BUT SHALL BE INCLUDED IN THE UNIT PRICE FOR THE VARIOUS ITEMS BEING REMOVED.
- ANY LOOSE MATERIAL DEPOSITED IN THE FLOW LINE OF DITCHES, GUTTERS OR OTHER DRAINAGE STRUCTURES SHALL BE REMOVED BY THE END OF EACH DAY BY THE CONTRACTOR AT THEIR EXPENSE.
- AN ADA ACCESSIBLE PEDESTRIAN ROUTE SHALL BE MAINTAINED THROUGHOUT THE PROJECT DURING CONSTRUCTION INCLUDING A PEDESTRIAN DETOUR ROUTE AND STAGING PLAN TO BE PROVIDED BY THE CONTRACTOR PRIOR TO THE START OF CONSTRUCTION.
- THE CONTRACTOR MAY PROSECUTE WORK BETWEEN THE HOURS OF 7:00 A.M. AND DUSK EACH WORKDAY. NO WORK WILL BE PERMITTED ON SUNDAYS, OR ON HOLIDAYS, WITHOUT PRIOR WRITTEN PERMISSION FROM THE ENGINEER.

BENCHMARK

MAG NAIL SET IN PAVEMENT EAST BOUND LANE 152ND STREET WEST OF 1ST AVENUE
EL=599.23

FILE NAME = 13676-QUAN-01 - IDOT P01

USER NAME =	DESIGNED -- TAG	REVISED --
	CHECKED --	REVISED --
PLOT SCALE =	DRAWN -- MED	REVISED --
PLOT DATE = 08-03-15	CHECKED -- AGP	REVISED --

STATE OF ILLINOIS
DEPARTMENT OF TRANSPORTATION

SIDEWALK REPLACEMENT		
SUMMARY OF QUANTITIES		
SCALE:	SHEET NO. 2 OF 13 SHEETS	STA. TO STA.

F.A. RTE.	SECTION	COUNTY	TOTAL SHEETS	SHEET NO.
	15-00021-00-SW	COOK	13	2
CONTRACT NO. 61B95				
FED. ROAD DIST. NO. 1 ILLINOIS FED. AID PROJECT SRTS-4009(331)				

PLAN	SURVEYED	DATE
	ALIGNED	BY
	RT. OF WAY CHECKED	
	NO. _____	
	OLD FILE NAME	

PROFILE	SURVEYED	DATE
	GRADES CHECKED	BY
	B.M. NOTED	
	NOTE BOOK	
	NO. _____	

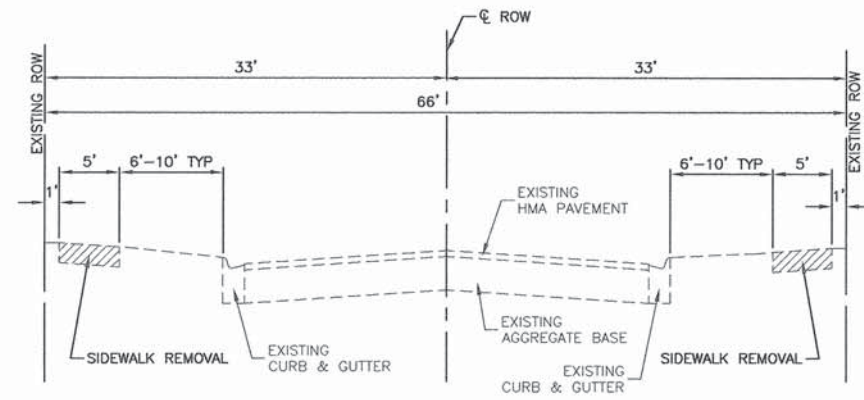

EXISTING TYPICAL SECTION

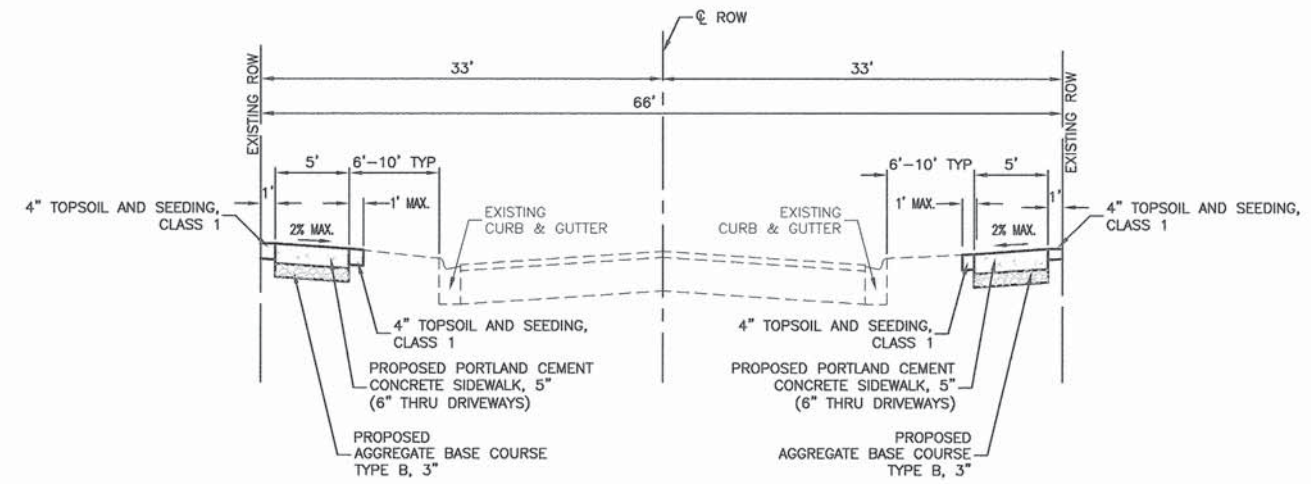

PROPOSED TYPICAL SECTION

HOT-MIX ASPHALT MIXTURE REQUIREMENTS

MIXTURE TYPE	AIR VOIDS
STABILIZED DRIVEWAY PAVEMENT	
HOT-MIX ASPHALT SURFACE COURSE, MIX "D", N50, (IL 9.5mm) 2 1/2"	4% @ 50 GYR

NOTES:

1. THE UNIT WEIGHT USED TO CALCULATE ALL HOT-MIX ASPHALT SURFACE MIXTURE QUANTITIES IS 112 LBS/SQ YD/IN.
2. THE "AC TYPE" FOR POLYMERIZED HMA MIXES SHALL BE "SBS/SBR PG 76-22" AND FOR NON-POLYMERIZED HMA THE "AC" TYPE SHALL BE "PG 64-22" UNLESS MODIFIED BY DISTRICT ONE SPECIAL PROVISIONS.
3. FOR HMA FULL DEPTH "AC TYPE" SEE SPECIAL PROVISIONS.
4. FOR USE OF RECYCLED MATERIALS SEE SPECIAL PROVISIONS.

FILE NAME = 13676-TYPX-01 P01

USER NAME =	DESIGNED -- TAG	REVISD --
	CHECKED -- PKB	REVISD --
PLOT SCALE = N.T.S.	DRAWN -- KWM	REVISD --
PLOT DATE = 08-3-15	CHECKED -- AG	REVISD --

STATE OF ILLINOIS
DEPARTMENT OF TRANSPORTATION

SIDWALK REPLACEMENT TYPICAL CROSS SECTIONS VILLAGE OF PHOENIX	
SCALE: N.T.S.	SHEET NO. 3 OF 13 SHEETS
STA.	TO STA.

F.A.U. RTE.	SECTION	COUNTY	TOTAL SHEETS	SHEET NO.
	15-00021-00-SW	COOK	13	3
CONTRACT NO. 61B95				
FED. ROAD DIST. NO. 1 ILLINOIS FED. AID PROJECT SRTS-4009(331)				

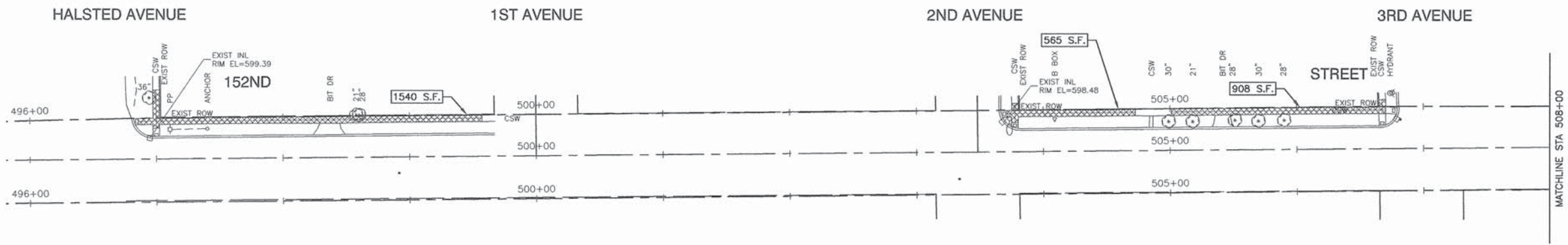

EXISTING CONDITIONS AND REMOVALS

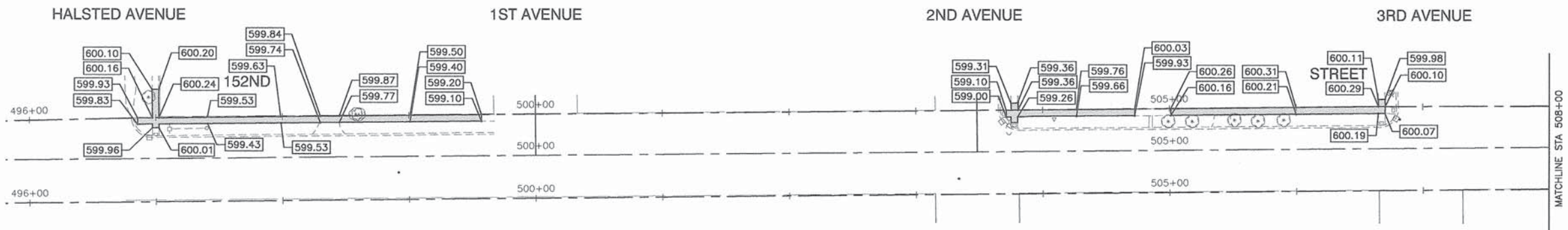

PROPOSED IMPROVEMENTS

LEGEND

- SIDEWALK REMOVAL
- DRIVEWAY PAVEMENT REMOVAL
- PORTLAND CEMENT CONCRETE SIDEWALK, 5" (6" THROUGH DRIVEWAYS) AGGREGATE BASE COURSE, TYPE B, 3"
- DETECTABLE WARNINGS
- STABILIZED DRIVEWAY PAVEMENT

NORTH SIDEWALK PROFILE

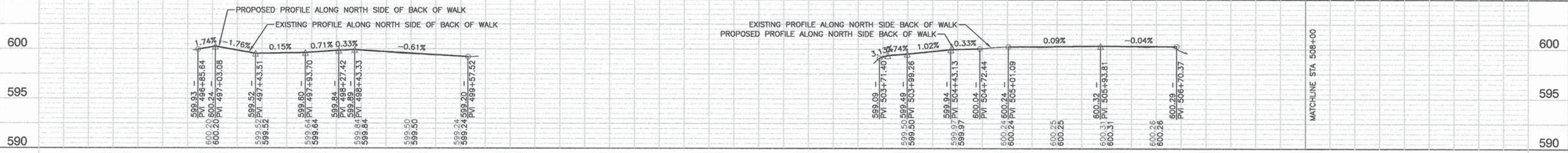

SOUTH SIDEWALK PROFILE

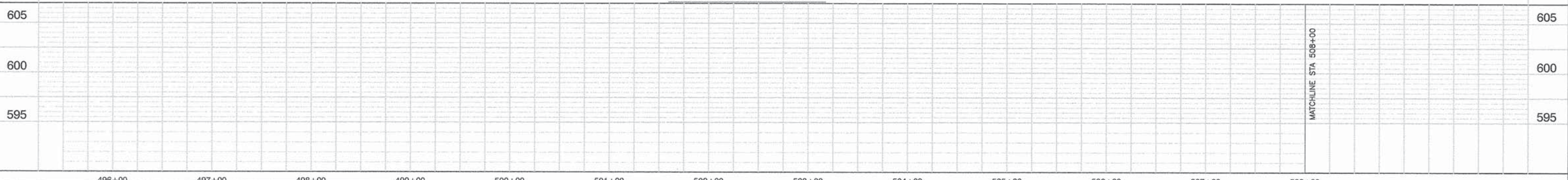

PLAN	DATE
BY	
NO.	
NOTE BOOK	
SURVEYED	
ALIGNED	
CHECKED	
RT. OF WAY CHECKED	
GRID FILE NAME	

PROFILE	DATE
BY	
NO.	
NOTE BOOK	
SURVEYED	
ALIGNED	
CHECKED	
RT. OF WAY CHECKED	
GRID FILE NAME	

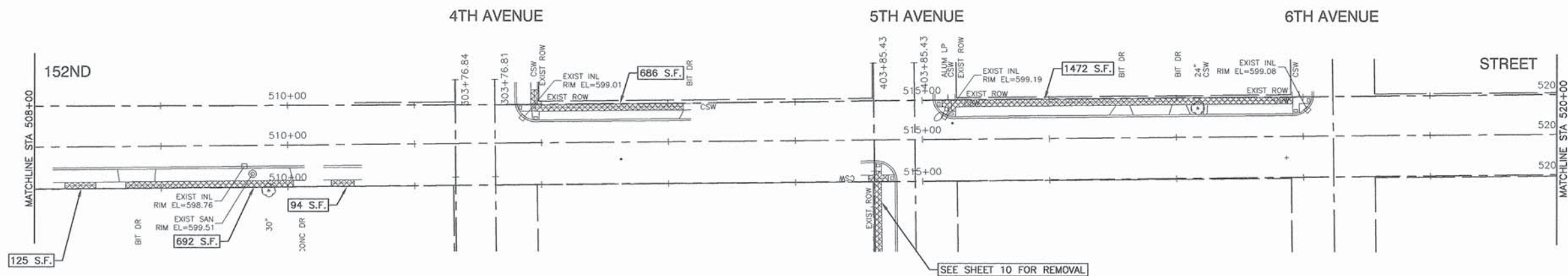

EXISTING CONDITIONS AND REMOVALS

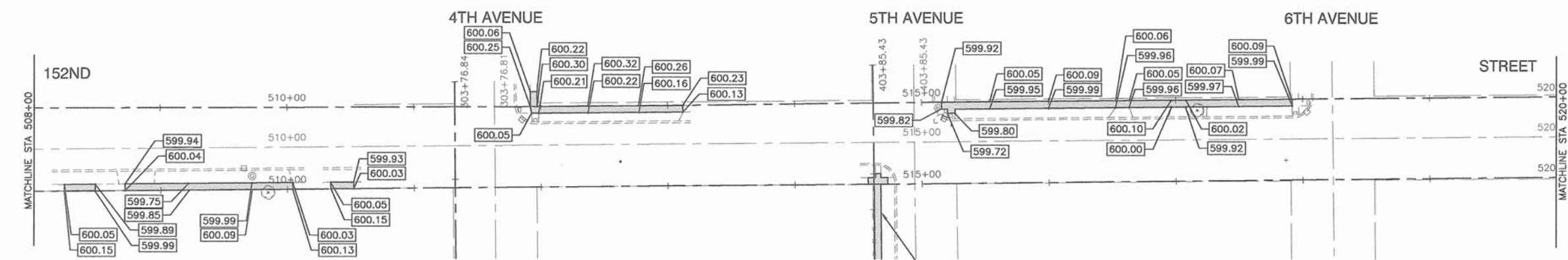

PROPOSED IMPROVEMENTS



LEGEND

- SIDEWALK REMOVAL
- DRIVEWAY PAVEMENT REMOVAL
- PORTLAND CEMENT CONCRETE SIDEWALK, 5" (6" THROUGH DRIVEWAYS) AGGREGATE BASE COURSE, TYPE B, 3"
- DETECTABLE WARNINGS
- STABILIZED DRIVEWAY PAVEMENT
- PCC DRIVEWAY PAVEMENT, 6"

NORTH SIDEWALK PROFILE

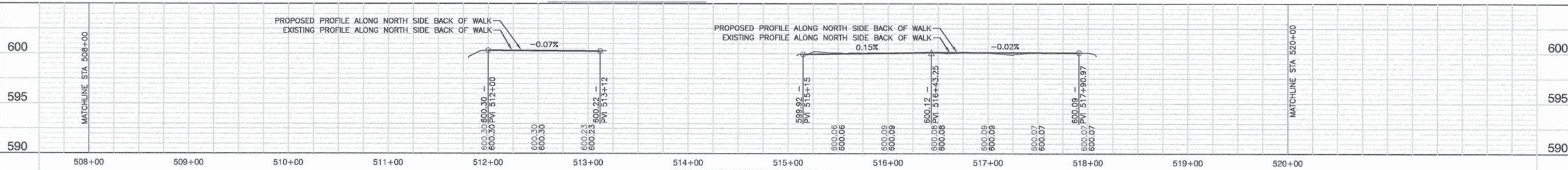

SOUTH SIDEWALK PROFILE

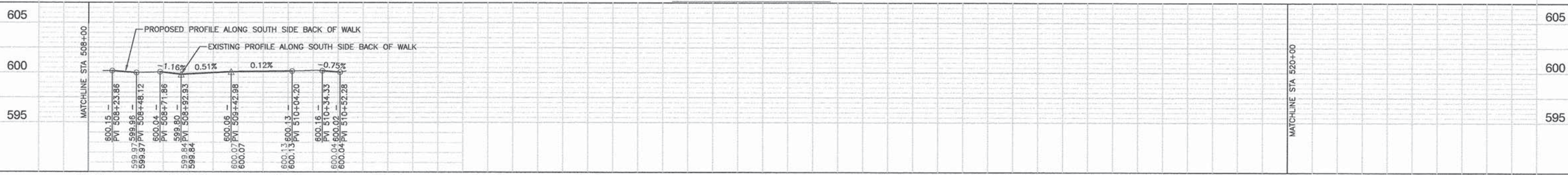

DATE	
BY	
SURVEYED	
PLANNED	
ALIGNED	
NOTED	
FILED	
RT. OF WAY CHECKED	
NO. OF WAY CHECKED	
NO.	
DATE	
BY	
FILED	
NO.	

DATE	
BY	
SURVEYED	
PLANNED	
ALIGNED	
NOTED	
FILED	
NO.	
DATE	
BY	
FILED	
NO.	



DATE	BY
SURVEYED	ALIGNED
PLANNED	DESIGNED
CHECKED	CHECKED
NO.	NO.

DATE	BY
SURVEYED	GRADES CHECKED
PLANNED	B.M. NOTED
CHECKED	CHECKED
NO.	NO.

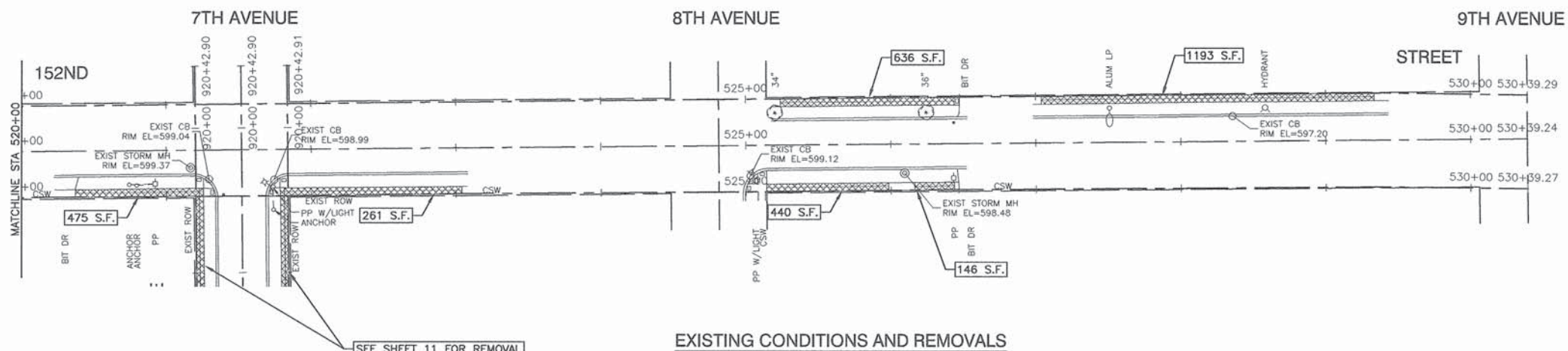

EXISTING CONDITIONS AND REMOVALS

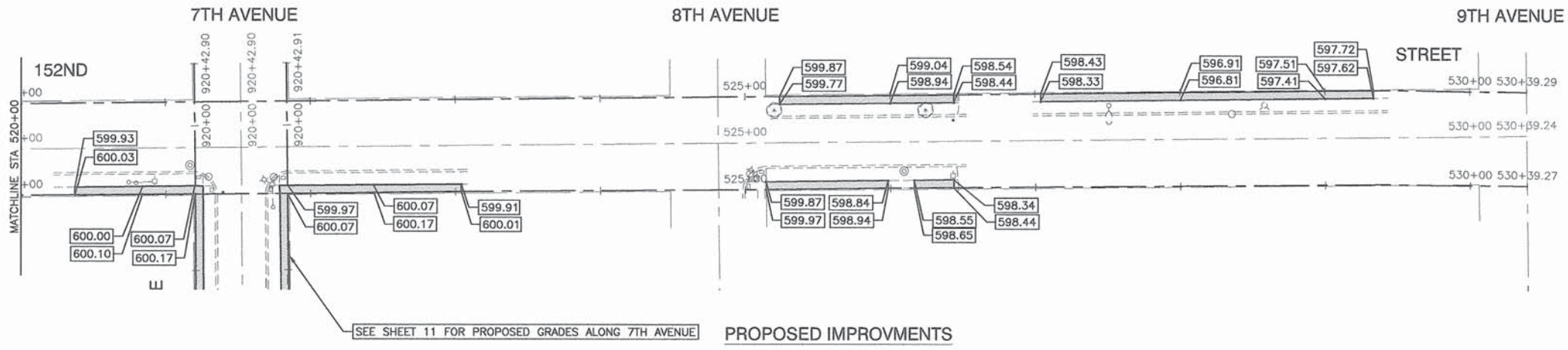

PROPOSED IMPROVEMENTS

LEGEND

- SIDEWALK REMOVAL
- DRIVEWAY PAVEMENT REMOVAL
- PORTLAND CEMENT CONCRETE SIDEWALK, 5" (6" THROUGH DRIVEWAYS) AGGREGATE BASE COURSE, TYPE B, 3"
- DETECTABLE WARNINGS
- STABILIZED DRIVEWAY PAVEMENT
- PCC DRIVEWAY PAVEMENT, 6"

NORTH SIDEWALK PROFILE

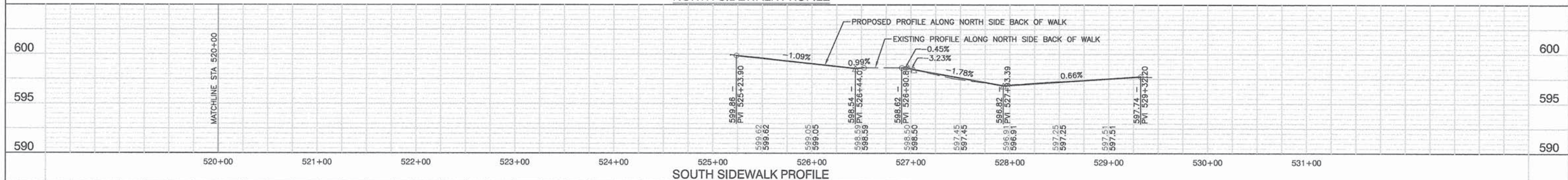

SOUTH SIDEWALK PROFILE

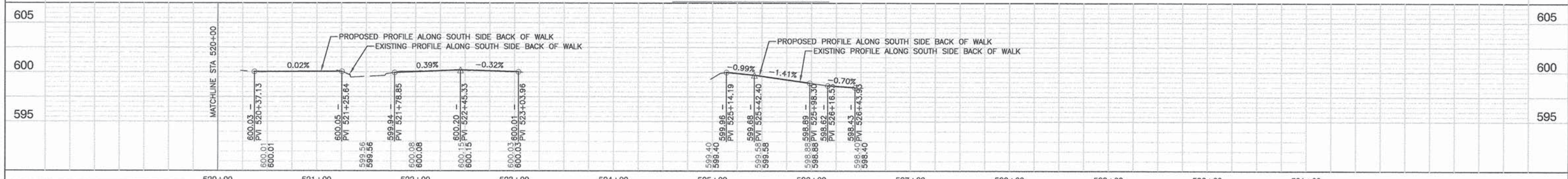

FILE NAME = 13676-PLPR-01 - IDOT PL-PR03	USER NAME =	DESIGNED -- TAG	REVISED --	STATE OF ILLINOIS DEPARTMENT OF TRANSPORTATION	SIDEWALK REPLACEMENT 152ND STREET PLAN & PROFILE	F.A. —	SECTION	COUNTY	TOTAL SHEETS	SHEET NO.
	PLOT SCALE =	CHECKED --	REVISED --			15-00021-00-SW	COOK	13	6	
	PLOT DATE = 08-03-15	DRAWN -- MED	REVISED --			CONTRACT NO. 61B95				
		CHECKED -- AP	REVISED --			FED. ROAD DIST. NO. 1 ILLINOIS FED. AID PROJECT SRTS-4009(331)				

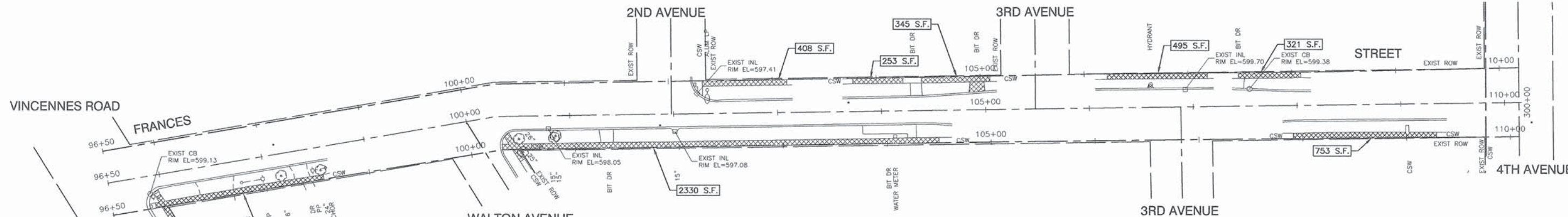

EXISTING CONDITIONS AND REMOVALS

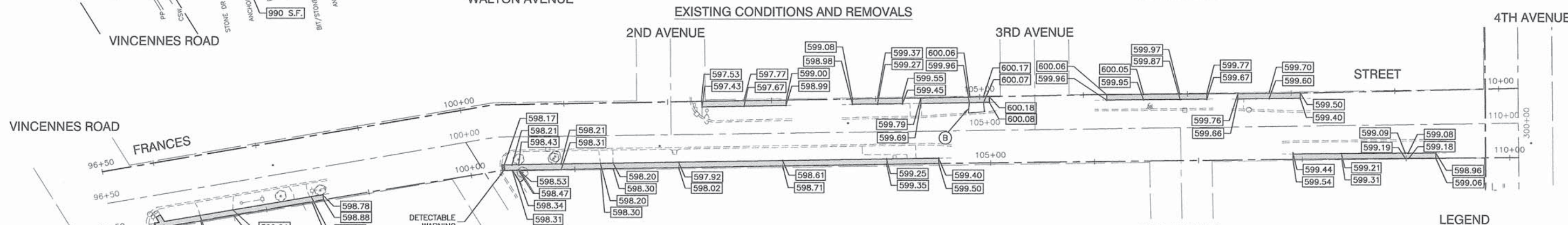

PROPOSED IMPROVEMENTS



LEGEND

NORTH SIDEWALK PROFILE

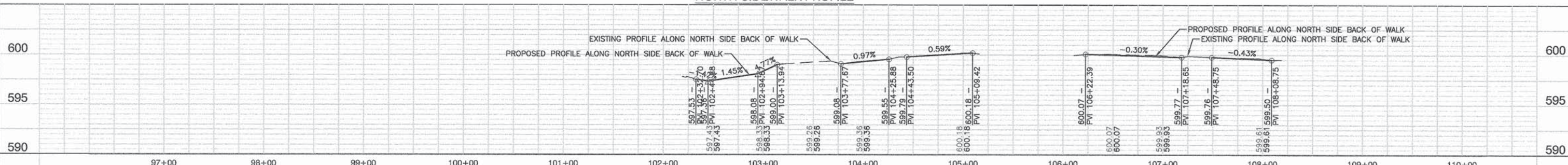

SOUTH SIDEWALK PROFILE

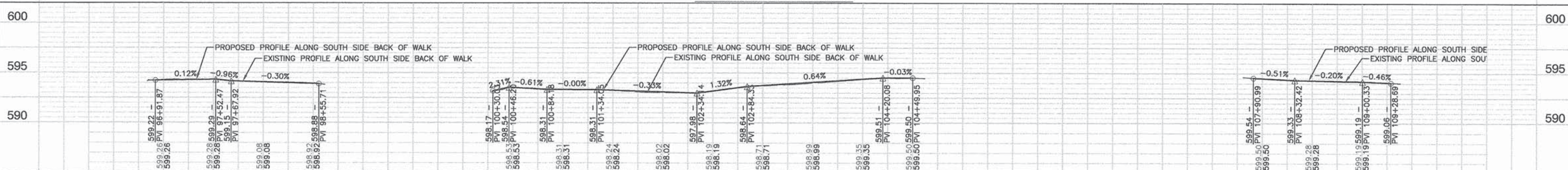

DATE	
BY	
PLANNED	
CHECKED	
RT. OF WAY CHECKED	
NO. FILE NAME	

DATE	
BY	
PLANNED	
CHECKED	
B.M. NOTED	

FILE NAME = 13676-PLPR-01 - IDOT PLPR04

USER NAME =	DESIGNED - TAG	REVISED -
CHECKED -	REVISOR -	REVISED -
PLOT SCALE =	DRAWN - MED	REVISED -
PLOT DATE = 08-03-15	CHECKED - AP	REVISED -

STATE OF ILLINOIS
DEPARTMENT OF TRANSPORTATION

SIDEWALK REPLACEMENT
FRANCES STREET
PLAN & PROFILE

F.A. RTE.	SECTION	COUNTY	TOTAL SHEETS	SHEET NO.
	15-00021-00-SW	COOK	13	7
CONTRACT NO. 61B95				
FED. ROAD DIST. NO. 1 ILLINOIS FED. AID PROJECT SRTS-4009(331)				

SCALE: SHEET NO. 7 OF 13 SHEETS STA. TO STA.

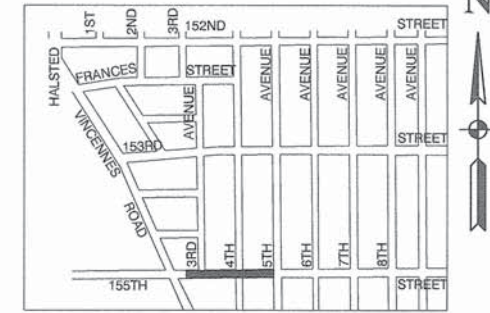
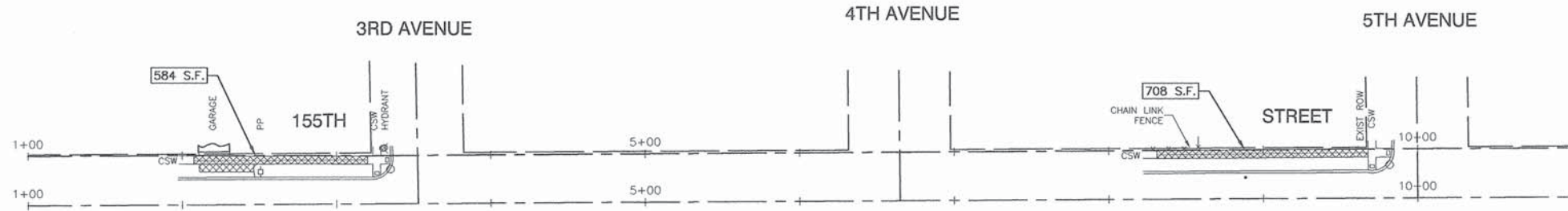

EXISTING CONDITIONS AND REMOVALS



PROPOSED IMPROVMENTS

NORTH SIDEWALK PROFILE

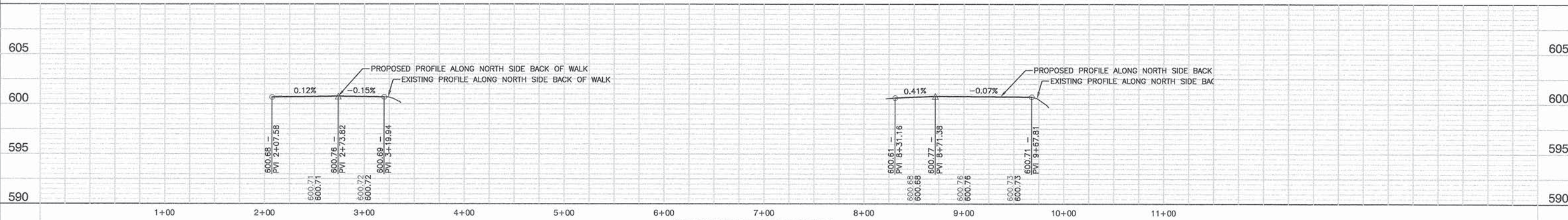

SOUTH SIDEWALK PROFILE



LEGEND

- SIDEWALK REMOVAL
- DRIVEWAY PAVEMENT REMOVAL
- PORTLAND CEMENT CONCRETE SIDEWALK, 5" (6" THROUGH DRIVEWAYS) AGGREGATE BASE COURSE, TYPE B, 3"
- DETECTABLE WARNINGS
- STABILIZED DRIVEWAY PAVEMENT
- PCC DRIVEWAY PAVEMENT, 6"

DATE	BY
DATE	BY
DATE	BY
DATE	BY
DATE	BY

DATE	BY
DATE	BY
DATE	BY
DATE	BY
DATE	BY

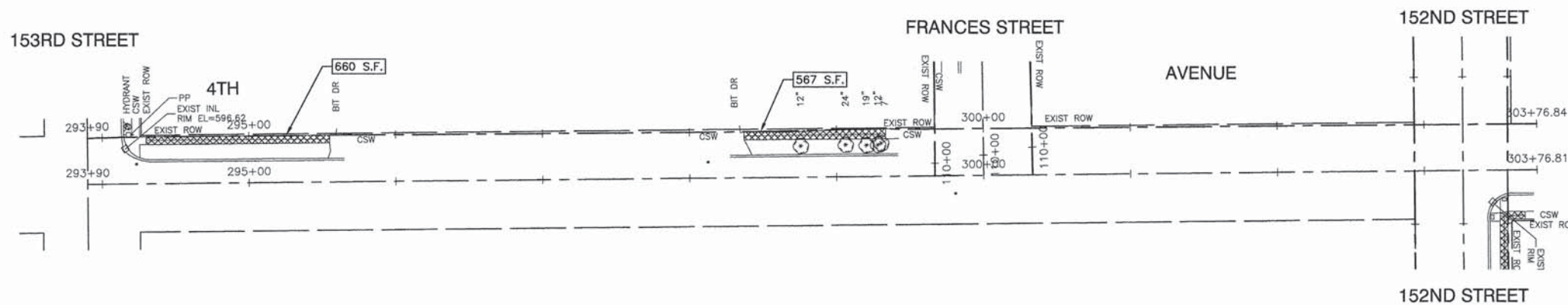

EXISTING CONDITIONS AND REMOVALS

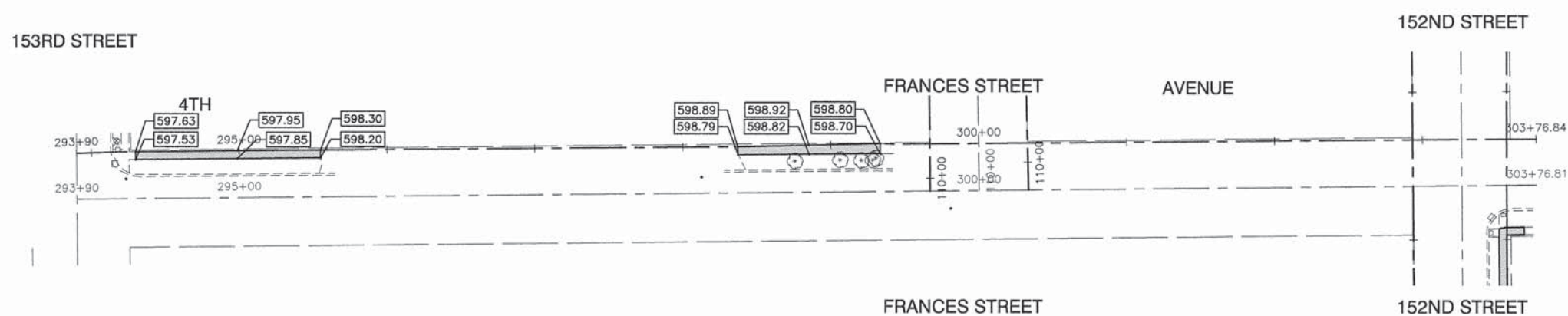

PROPOSED IMPROVMENTS

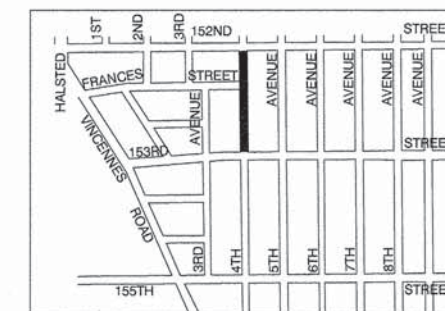

LEGEND

- SIDEWALK REMOVAL
- DRIVEWAY PAVEMENT REMOVAL
- PORTLAND CEMENT CONCRETE SIDEWALK, 5" (6" THROUGH DRIVEWAYS)
- AGGREGATE BASE COURSE, TYPE B, 3"
- DETECTABLE WARNINGS
- STABILIZED DRIVEWAY PAVEMENT

WEST SIDEWALK PROFILE

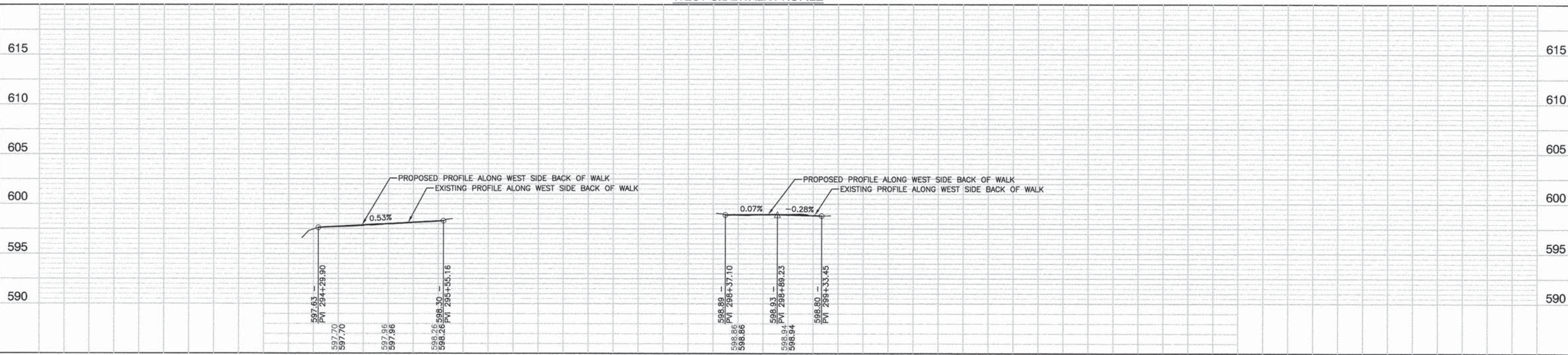

DATE	BY	SURVEYED
		PLANNED
		CHECKED
		RT. OF WAY CHECKED
		ROAD FILE NAME
PLAN	NOTE BOOK NO.	

DATE	BY	SURVEYED
		PLANNED
		CHECKED
		B.M. NOTED
PROFILE	NOTE BOOK	

FILE NAME = 13676-PLPR-01 - IDOT PLPR06	USER NAME =	DESIGNED -- TAG	REVISED --	STATE OF ILLINOIS DEPARTMENT OF TRANSPORTATION	SIDEWALK REPLACEMENT 4TH AVENUE PLAN & PROFILE			F.A. RTE. =	SECTION = 15-00021-00-SW	COUNTY = COOK	TOTAL SHEETS = 13	SHEET NO. = 9
	PLOT SCALE =	CHECKED --	REVISED --		SCALE:	SHEET NO. 9 OF 13 SHEETS	STA. TO STA.	FED. ROAD DIST. NO. 1	ILLINOIS	FED. AID PROJECT	SRTS-4009(331)	
	PLOT DATE = 08-03-15	DRAWN -- MED	REVISED --									
		CHECKED -- AP	REVISED --									



DATE	BY	SURVEYED	PLOTTED	CHECKED
PLAN	NO.	NOTE BOOK	NO.	DATE

DATE	BY	SURVEYED	PLOTTED	CHECKED
PROFILE	NO.	NOTE BOOK	NO.	DATE

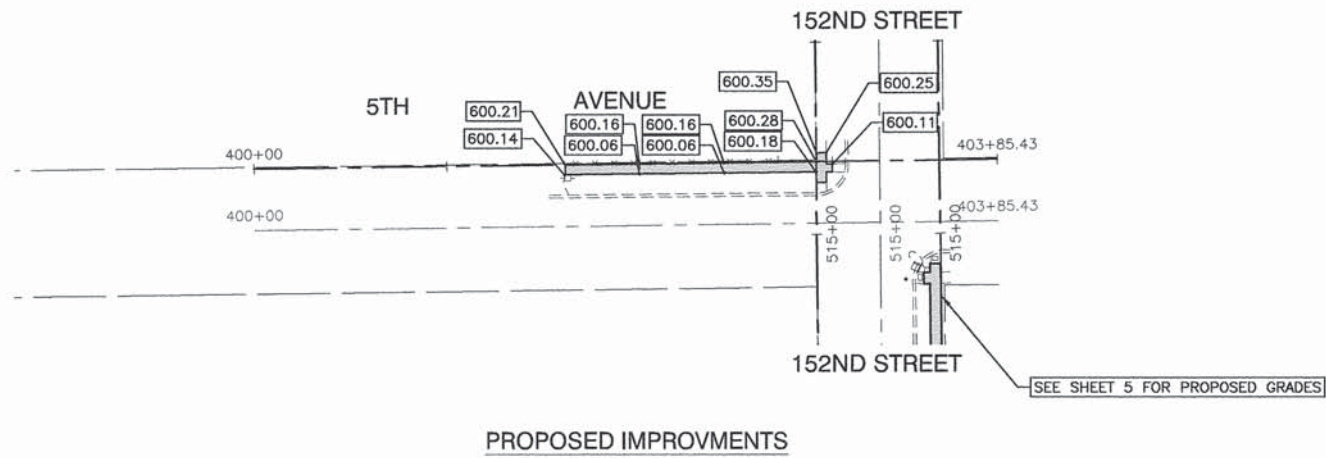
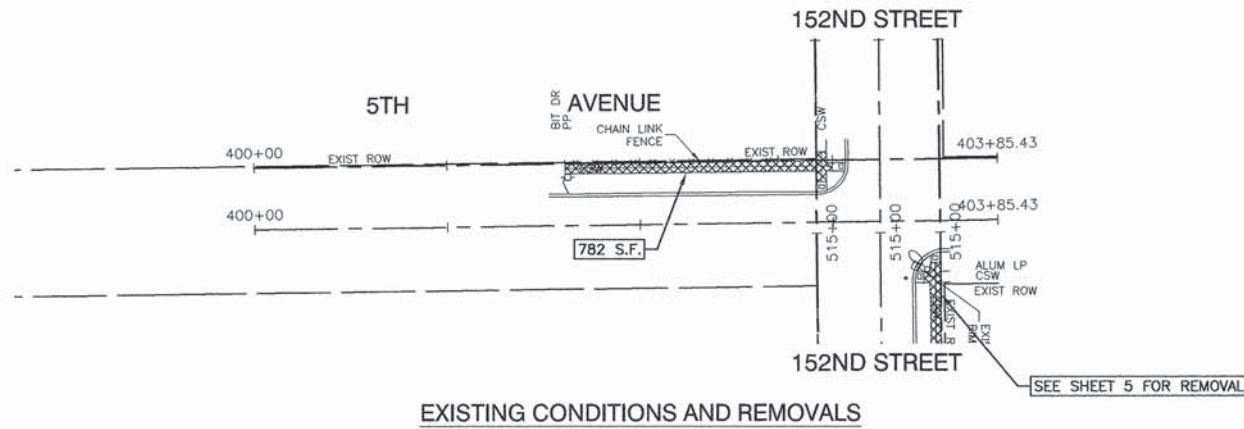

LEGEND

- SIDEWALK REMOVAL
- DRIVEWAY PAVEMENT REMOVAL
- PORTLAND CEMENT CONCRETE SIDEWALK, 5" (6" THROUGH DRIVEWAYS)
AGGREGATE BASE COURSE, TYPE B, 3"
- DETECTABLE WARNINGS
- STABILIZED DRIVEWAY PAVEMENT
- PCC DRIVEWAY PAVEMENT, 6"

WEST SIDEWALK PROFILE

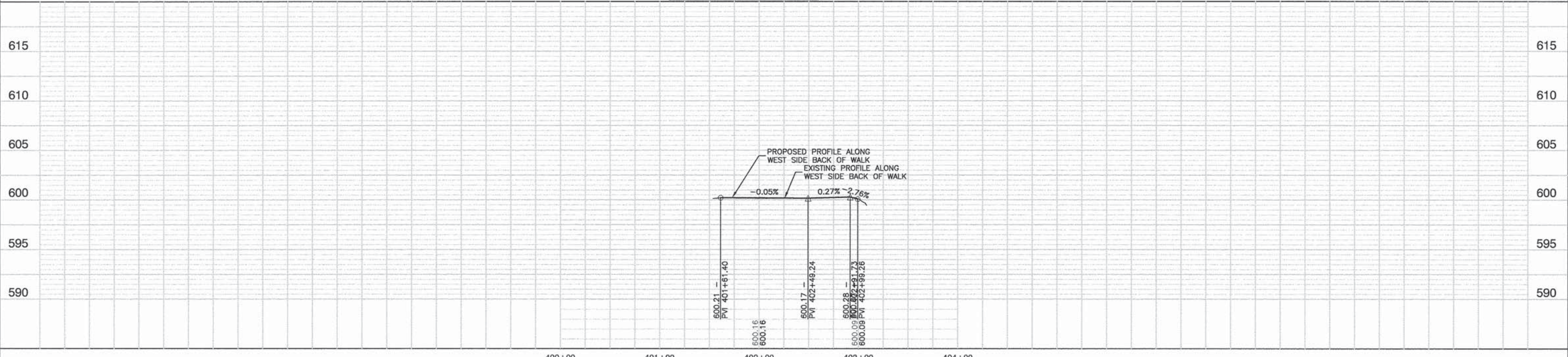

FILE NAME = 13676-PLPR-01 - IDOT PLPR07	USER NAME =	DESIGNED -- TAG	REVISD --	STATE OF ILLINOIS DEPARTMENT OF TRANSPORTATION	SIDEWALK REPLACEMENT 5TH AVENUE PLAN & PROFILE	F.A. RTE. =	SECTION = 15-00021-00-SW	COUNTY = COOK	TOTAL SHEETS = 13	SHEET NO. = 10		
	PLOT SCALE =	DRAWN -- MED	REVISD --			SCALE:	SHEET NO. 10 OF 13 SHEETS	STA. TO STA.	CONTRACT NO. 61B95			
	PLOT DATE = 08-03-15	CHECKED -- AP	REVISD --			FED. ROAD DIST. NO. 1 ILLINOIS FED. AID PROJECT SRTS-4009(331)						



DATE	BY

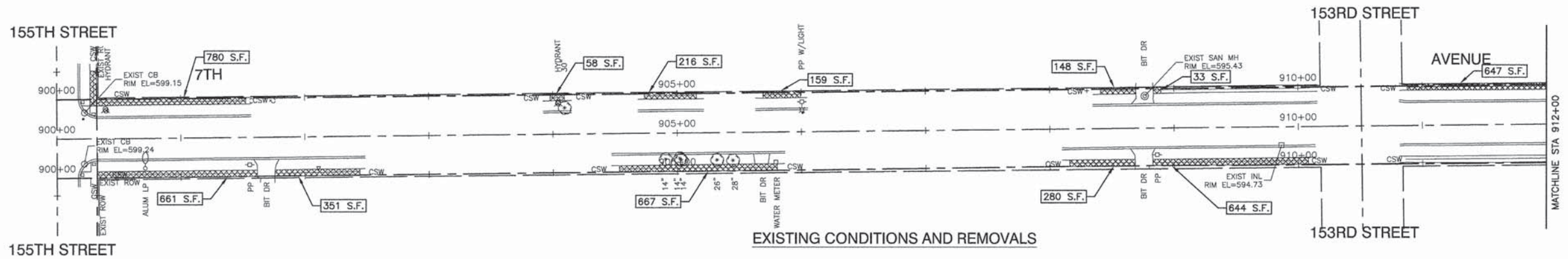

EXISTING CONDITIONS AND REMOVALS

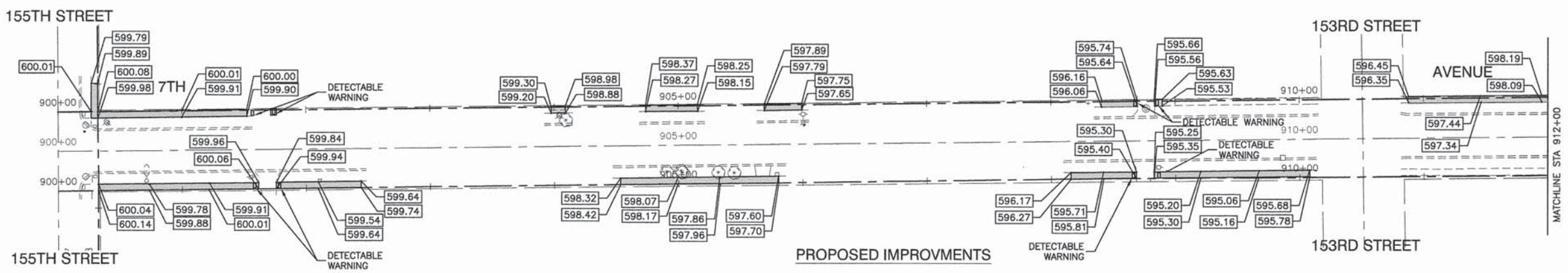

PROPOSED IMPROVMENTS

WEST SIDEWALK PROFILE

LEGEND

- SIDEWALK REMOVAL
- DRIVEWAY PAVEMENT REMOVAL
- PORTLAND CEMENT CONCRETE SIDEWALK, 5" (6" THROUGH DRIVEWAYS)
- AGGREGATE BASE COURSE, TYPE B, 3"
- DETECTABLE WARNINGS
- STABILIZED DRIVEWAY PAVEMENT

DATE	BY

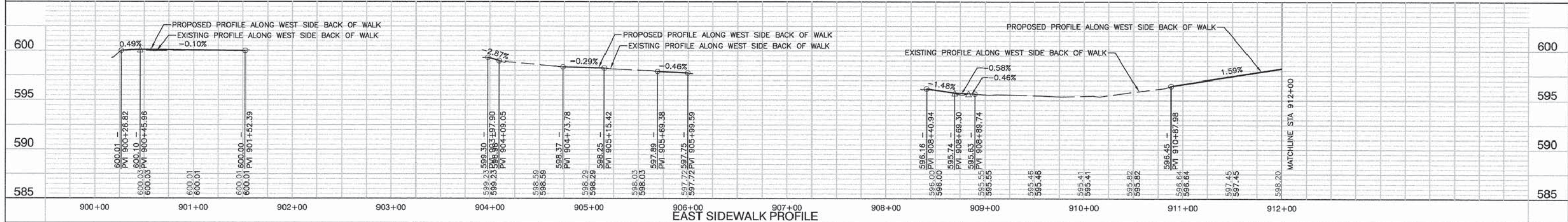

EAST SIDEWALK PROFILE

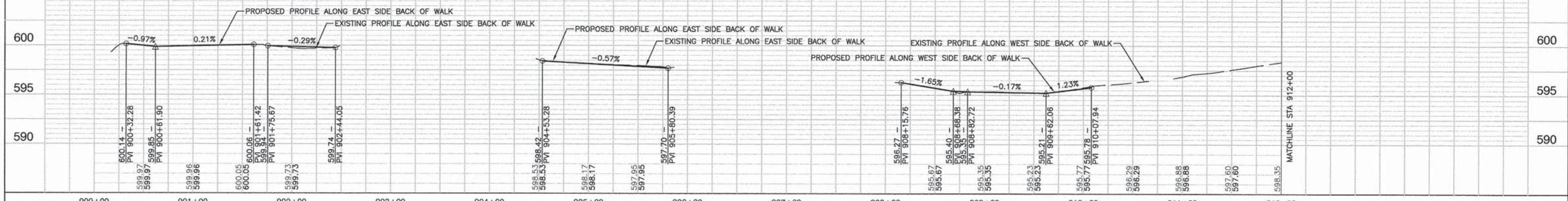

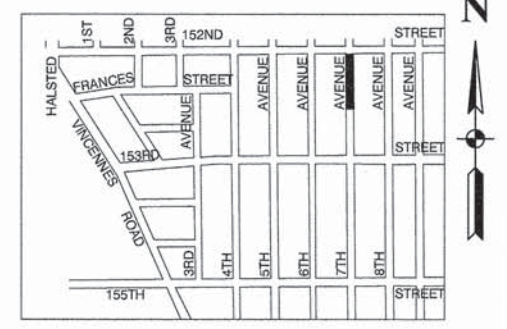
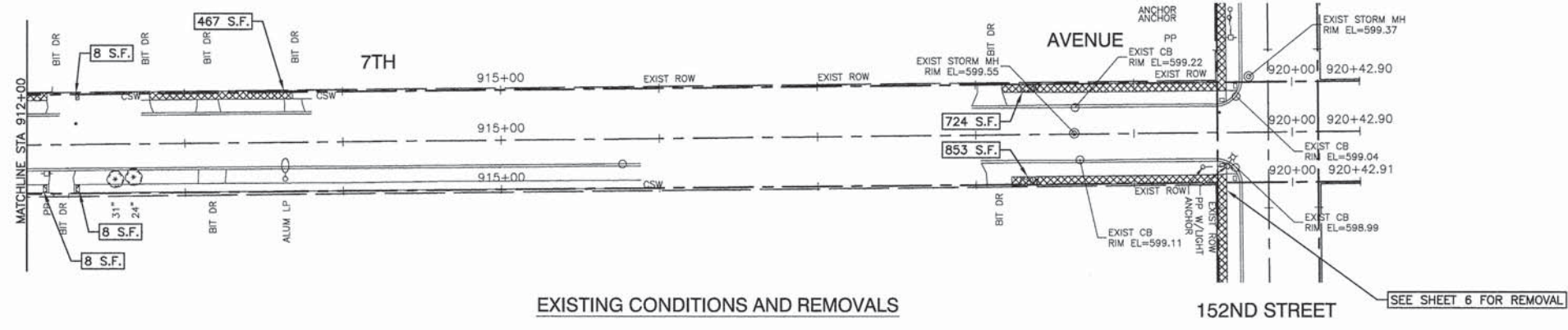

LEGEND

- SIDEWALK REMOVAL
- DRIVEWAY PAVEMENT REMOVAL
- PORTLAND CEMENT CONCRETE SIDEWALK, 5" (6" THROUGH DRIVEWAYS)
- AGGREGATE BASE COURSE, TYPE B, 3"
- DETECTABLE WARNINGS
- STABILIZED DRIVEWAY PAVEMENT

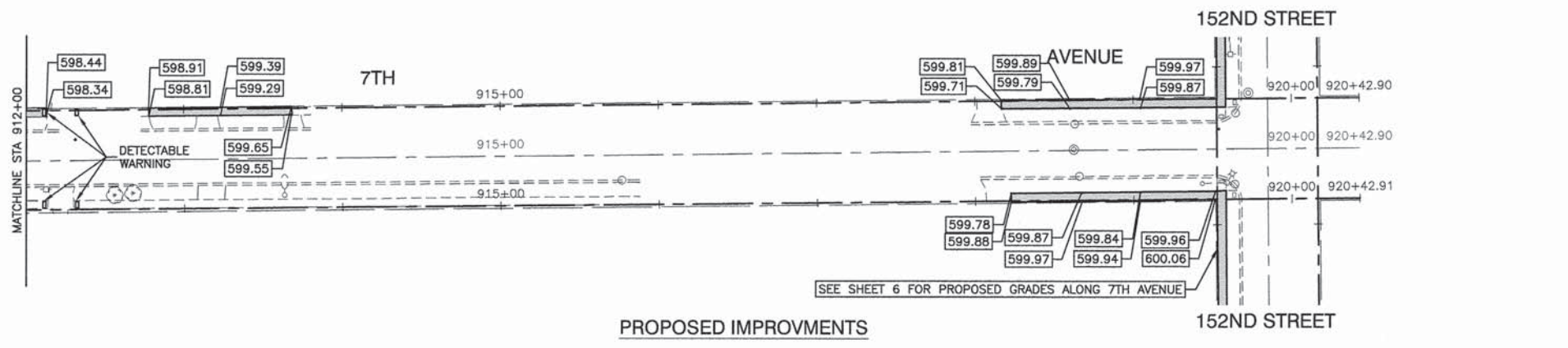

WEST SIDEWALK PROFILE

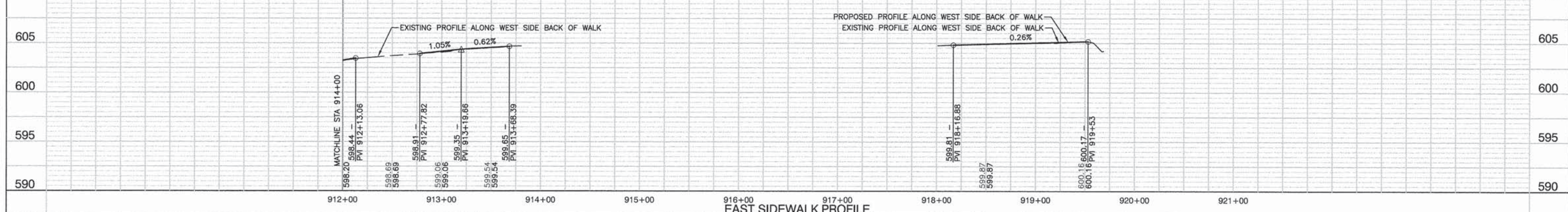

EAST SIDEWALK PROFILE

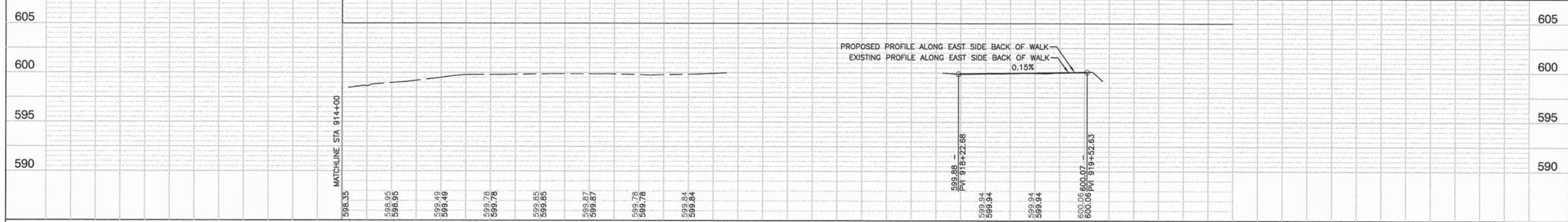

PLAN

DATE	
BY	
SURVEYED	
PLOTTED	
CHECKED	
RT. OF WAY CHECKED	
CAAD FILE NAME	
NOTE BOOK NO.	

PROFILE

DATE	
BY	
SURVEYED	
PLOTTED	
CHECKED	
S.M. NOTED	
NOTE BOOK NO.	

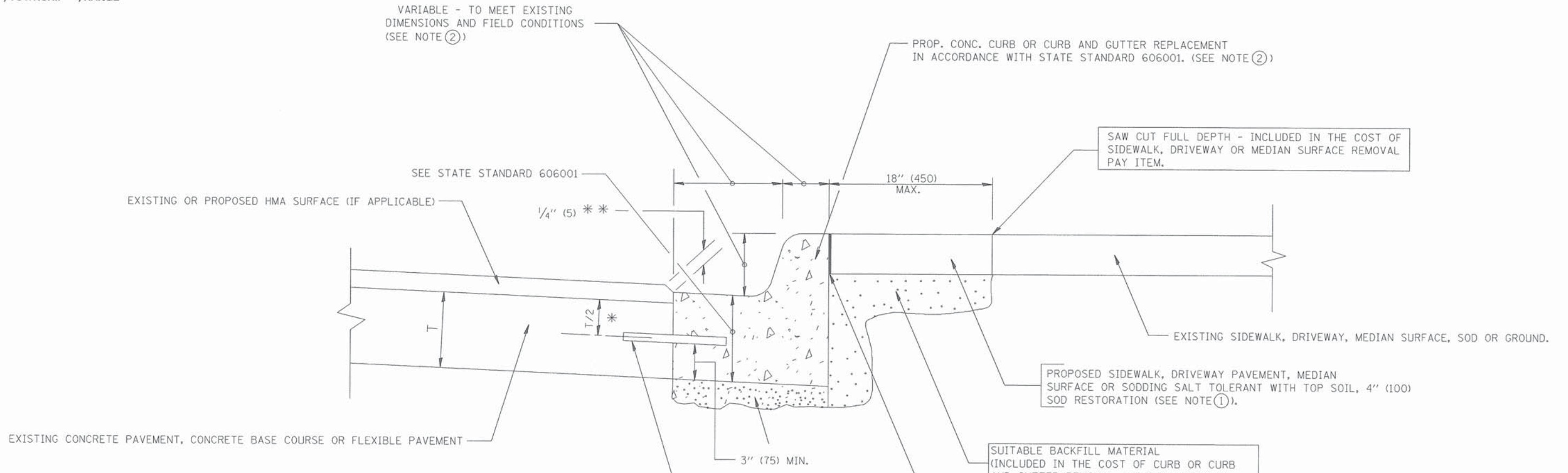

* 3" (75) MINIMUM FROM TOP AND BOTTOM OF THE CONCRETE PAVEMENT OR BASE COURSE.
 ** IF THE FINAL SURFACE OF THE PAVEMENT IS CONCRETE, THE GUTTER IS TO BE FLUSH WITH THE PAVEMENT.

- NOTE: ① SIDEWALK, DRIVEWAY PAVEMENT OR MEDIAN SURFACE SHALL BE SIMILAR TO THE MATERIAL BEING REMOVED AND WILL BE PAID FOR SEPARATELY.
 SODDING, SALT TOLERANT AND TOP SOIL, FURNISH AND PLACE 4" WILL BE PAID FOR SEPARATELY.
- ② FERTILIZER FOR THE PLACEMENT OF THE SOD IS NOT REQUIRED
- ③ CURB OR CURB AND GUTTER REPLACEMENT SHALL MATCH THE SHAPE OF THE EXISTING CURB OR CURB AND GUTTER UNLESS OTHERWISE SPECIFIED.
- ④ FOR CURB OR CURB AND GUTTER REMOVAL AND REPLACEMENT ADJACENT TO FLEXIBLE PAVEMENT DELETE EPOXY COATED TIE BARS.
- ⑤ LONGITUDINAL BARS, IF ENCOUNTERED IN THE EXISTING CURB OR CURB AND GUTTER, ARE NOT TO BE REPLACED. CUTTING AND REMOVING LONGITUDINAL BARS SHALL BE INCLUDED IN THE COST OF CURB OR CURB AND GUTTER REMOVAL AND REPLACEMENT.
- ⑥ THE COST OF HMA SURFACE REMOVAL IN THE EXISTING GUTTER FLAG SHALL BE INCLUDED IN THE COST OF THE CURB AND GUTTER REMOVAL AND REPLACEMENT.
- ⑦ THE REMOVAL AND REPLACEMENT OF THE EXISTING CURB OR CURB AND GUTTER SHALL BE DONE IN ACCORDANCE WITH THE APPLICABLE PORTIONS OF SECTION 440 AND 606 OF THE STANDARD SPECIFICATIONS.
- ⑧ THE LOCATIONS OF REMOVAL AND REPLACEMENT OF EXISTING CURB OR CURB AND GUTTER SHALL BE DETERMINED BY THE RESIDENT ENGINEER AT THE TIME OF CONSTRUCTION.

BASIS OF PAYMENT:
 THIS WORK WILL BE PAID FOR AT THE CONTRACT UNIT PRICE PER FOOT (METER) FOR "CURB REMOVAL AND REPLACEMENT" OR "COMBINATION CONCRETE CURB AND GUTTER REMOVAL AND REPLACEMENT".

CURB OR CURB AND GUTTER REMOVAL AND REPLACEMENT

ALL DIMENSIONS ARE IN INCHES (MILLIMETERS) UNLESS OTHERWISE SHOWN.

FILE NAME = 13676-DTLS-01 - IDOT P01	USER NAME =	DESIGNED -- TAG	REVISIONS	STATE OF ILLINOIS DEPARTMENT OF TRANSPORTATION	SIDEWALK REPLACEMENT IDOT DISTRICT 1 STANDARD DETAILS		F.A. RTE.	SECTION	COUNTY	TOTAL SHEETS	SHEET NO.	
	PLOT SCALE =	CHECKED --	REVISIONS		SCALE:	SHEET NO. 13 OF 13 SHEETS	STA.	15-00021-00-SW	COOK	13	13	
	PLOT DATE = 08-03-15	DRAWN -- MED	REVISIONS					BD-24				
		CHECKED -- AG	REVISIONS					CONTRACT NO. 61B95		FED. ROAD DIST. NO. 1 ILLINOIS FED. AID PROJECT SRTS-4009(331)		