

DETAILED LOCATION MAP
 STA 153+00 TO 169+86
 STA 200+00 TO STA 213+00
 NOTE STA EQ. STA. 200+00 AH - STA. 169+86 BK

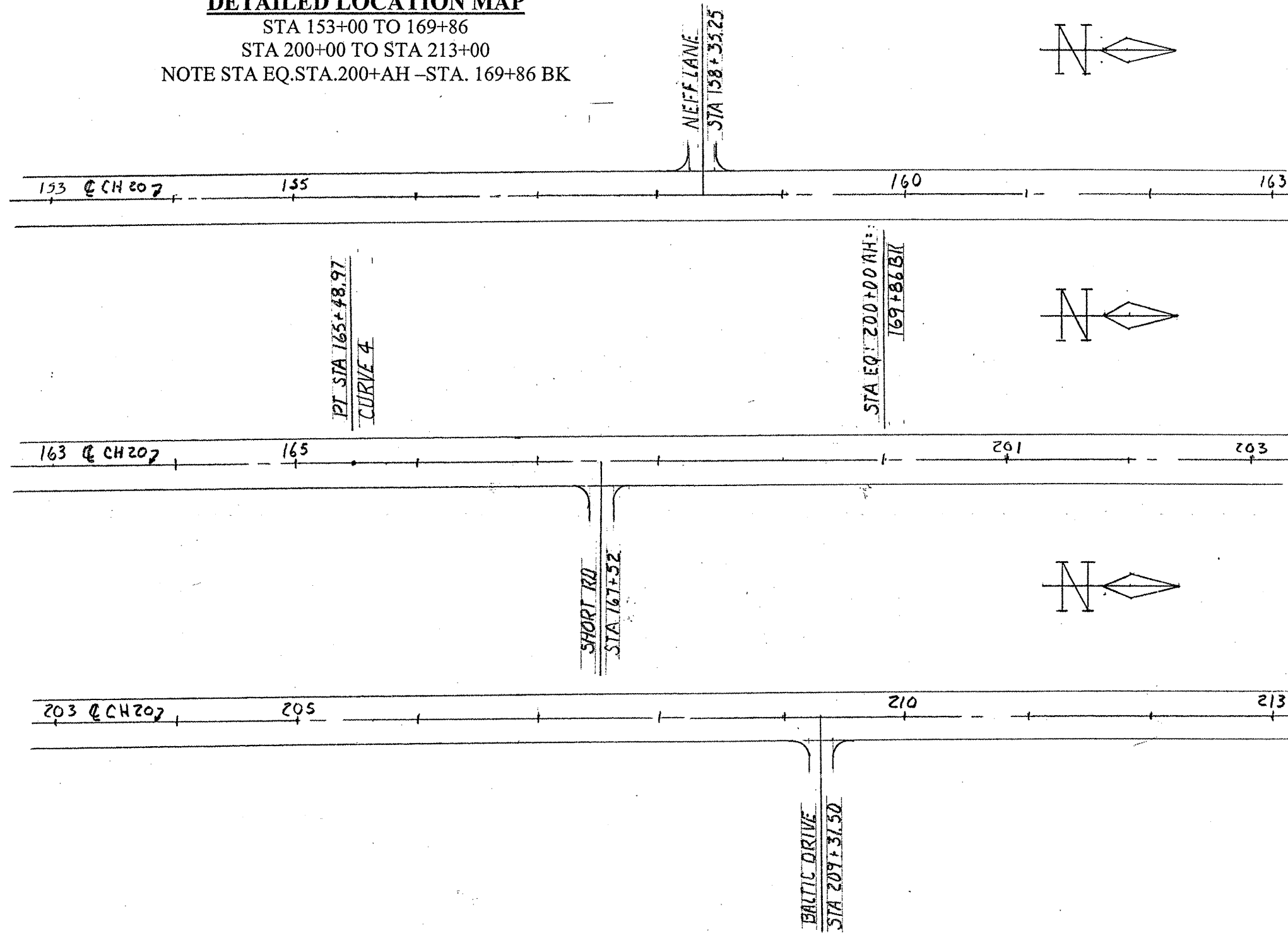

Prepared by:
 Vermilion County Highway Dept.
 2732 Batestown Road
 Oakwood, Illinois 61858

DENMARK RD. (C.H. 20)
 2009 RESURFACING
 SECTION 07-00160-00-RS

SHEET 18
OF 71
June 29, 2009