

F.A.U. RTE.	SECTION	COUNTY	TOTAL SHEETS	SHEET NO.
6371	93-00295-03-PV	MCLEAN	109	78
STA. 253+00.00 TO STA. 258+00.00				
ILLINOIS F.A. PROJ. NO. M-5227(046)				
CONTRACT NO. 91351				

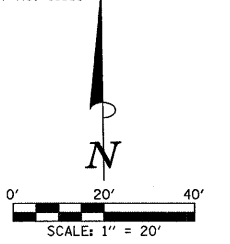

- NOTES**
1. THE EXISTING SEPTIC SYSTEM SHALL REMAIN IN SERVICE UNTIL SUCH TIME THAT THE NEW SANITARY SEWER SYSTEM HAS BEEN CONSTRUCTED AND PUT INTO SERVICE. THE EXISTING SANITARY SERVICE LINE SHALL THEN BE CONNECTED TO THE NEW SERVICE LINE AND THE SEPTIC TANK REMOVED. LEACH FIELD PIPING SHALL BE ABANDONED AND PLUGGED. THE EXCAVATION SHALL BE BACKFILLED WITH EARTH MATERIAL AND COMPACTED IN 8" LIFTS. SEE THE REMOVALS/RELOCATIONS PLANS FOR ADDITIONAL INFORMATION.
 2. EXISTING SANITARY SEWER SERVICE LOCATION, DEPTH, AND SIZE TO BE DETERMINED BY CONTRACTOR DURING CONSTRUCTION AND PRIOR TO CONSTRUCTING PROPOSED 6" SAN. SEWER SERVICE. THE ENGINEER WILL DETERMINE THE EXACT POINT OF CONNECTION TO THE EXISTING SEWER SERVICE AND THE SLOPE OF THE PROPOSED SEWER SERVICE.

PROPOSED SANITARY SEWER
TYPE 2 8" AT 0.40% = 5 FOOT
TRENCH BACKFILL = 2.4 CU YD
STUB FOR FUTURE CONNECTION. CAP OR PLUG
TO SUSTAIN AIR TEST.

MH #9
PROPOSED
MANHOLE, SANITARY
STA. 257+73.0, 33.0' RT.
RIM ELEV. = 888.52
I.E.W. = 882.10
I.E.S. = 882.20

SEE SCHEDULE OF QUANTITIES FOR
ADDITIONAL INFORMATION.

SEE SANITARY SEWER DETAILS
FOR ADDITIONAL INFORMATION.

BM 501 - TOP CAP BOLT ON FIRE HYDRANT
ON NORTH SIDE OF HAMILTON RD.
STA. 257+04, 10' LT.
ELEV. 890.74

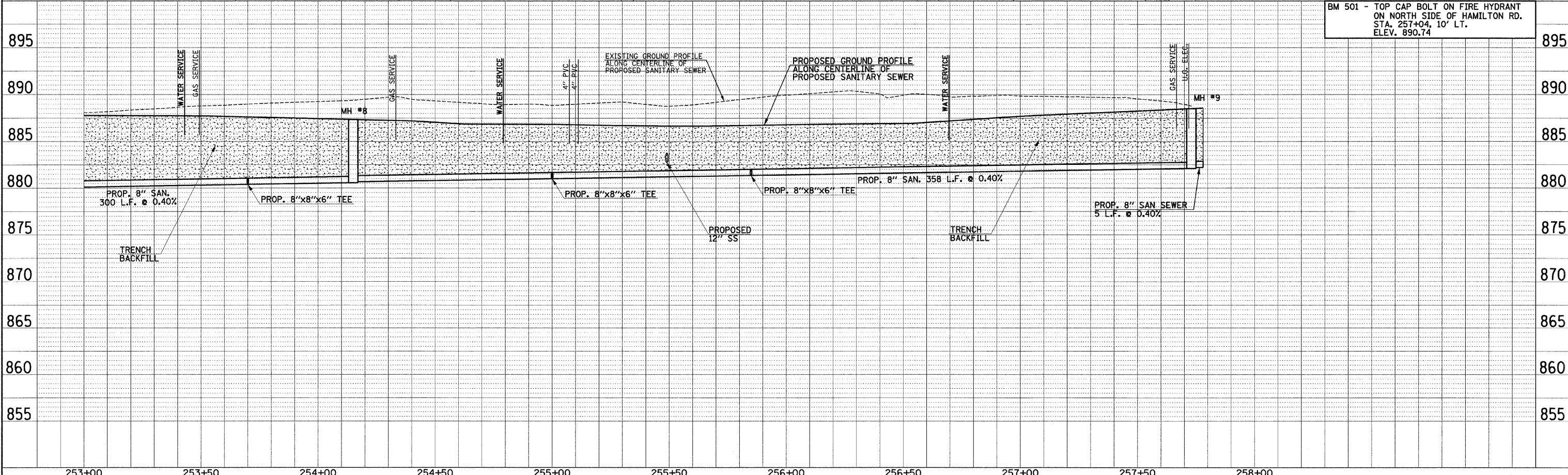
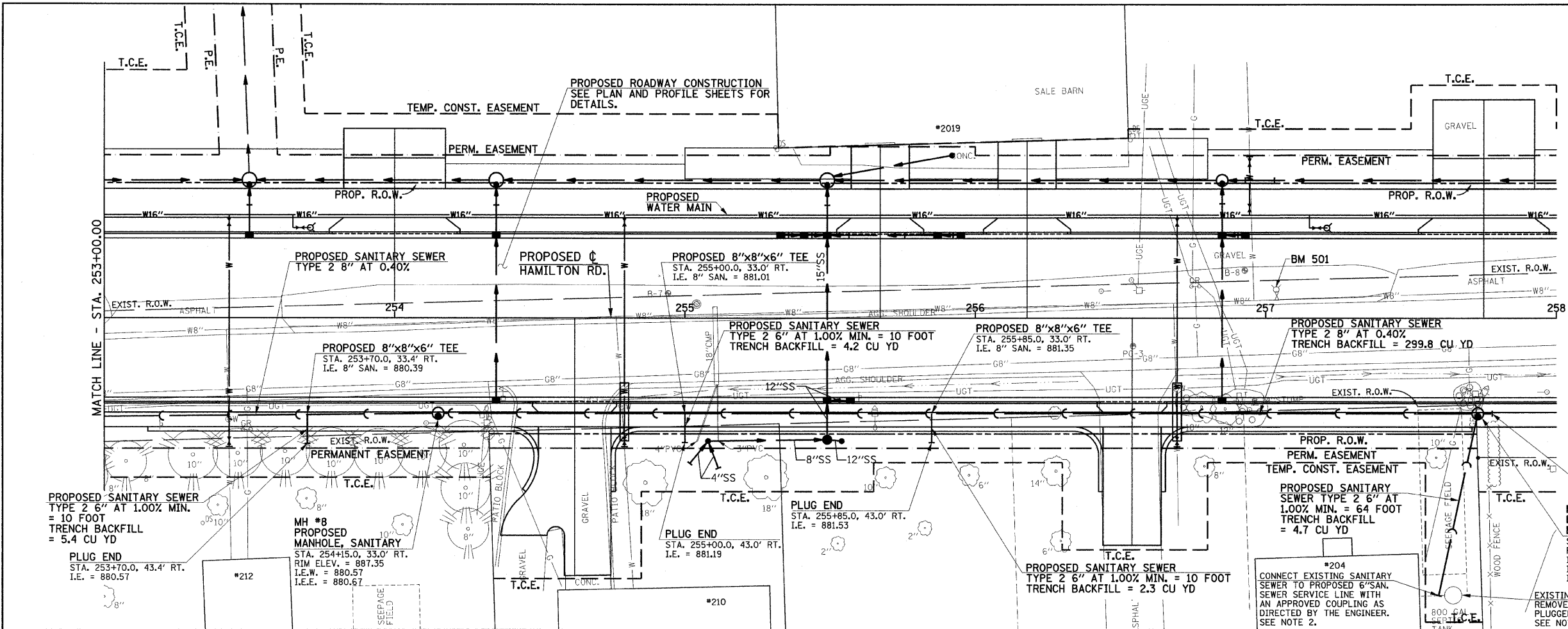

DATE: _____
BY: _____
SURVEYED: _____
PLAN: _____
NOTE BOOK: _____
NO. _____

DATE: _____
BY: _____
SURVEYED: _____
PROFILE: _____
NOTE BOOK: _____
NO. _____