

F.A.U. RTE.	SECTION	COUNTY	TOTAL SHEETS	SHEET NO.
6371	93-00295-03-PV	MCLEAN	109	48
STA.		TO STA.		
		ILLINOIS F.A. PROJ. NO. M-5227(046)		
CONTRACT NO. 91351				

- LEGEND**
- CONSTRUCTION WORK ZONE
  - LIMITS OF PROPOSED CONSTRUCTION
  - AGGREGATE FOR TEMPORARY ACCESS
  - DRUM OR BARRICADE WITH STEADY BURN LIGHTS
  - TYPE III BARRICADE WITH FLASHING LIGHTS
  - DIRECTION OF TRAFFIC
  - SIGN

**NOTE:**  
 THE ADDITIONAL TRAFFIC CONTROL DEVICES SHOWN FOR THIS STAGE SHALL BE INCLUDED IN THE CONTRACT LUMP SUM PRICE FOR TRAFFIC CONTROL AND PROTECTION, STANDARD 701606, SPECIAL UNLESS OTHERWISE NOTED. THE TRAFFIC CONTROL DEVICES AND PAVEMENT MARKINGS SHOWN FOR THIS STAGE SHALL REMAIN IN PLACE FOR THE DURATION OF THE PROJECT UNLESS OTHERWISE NOTED.

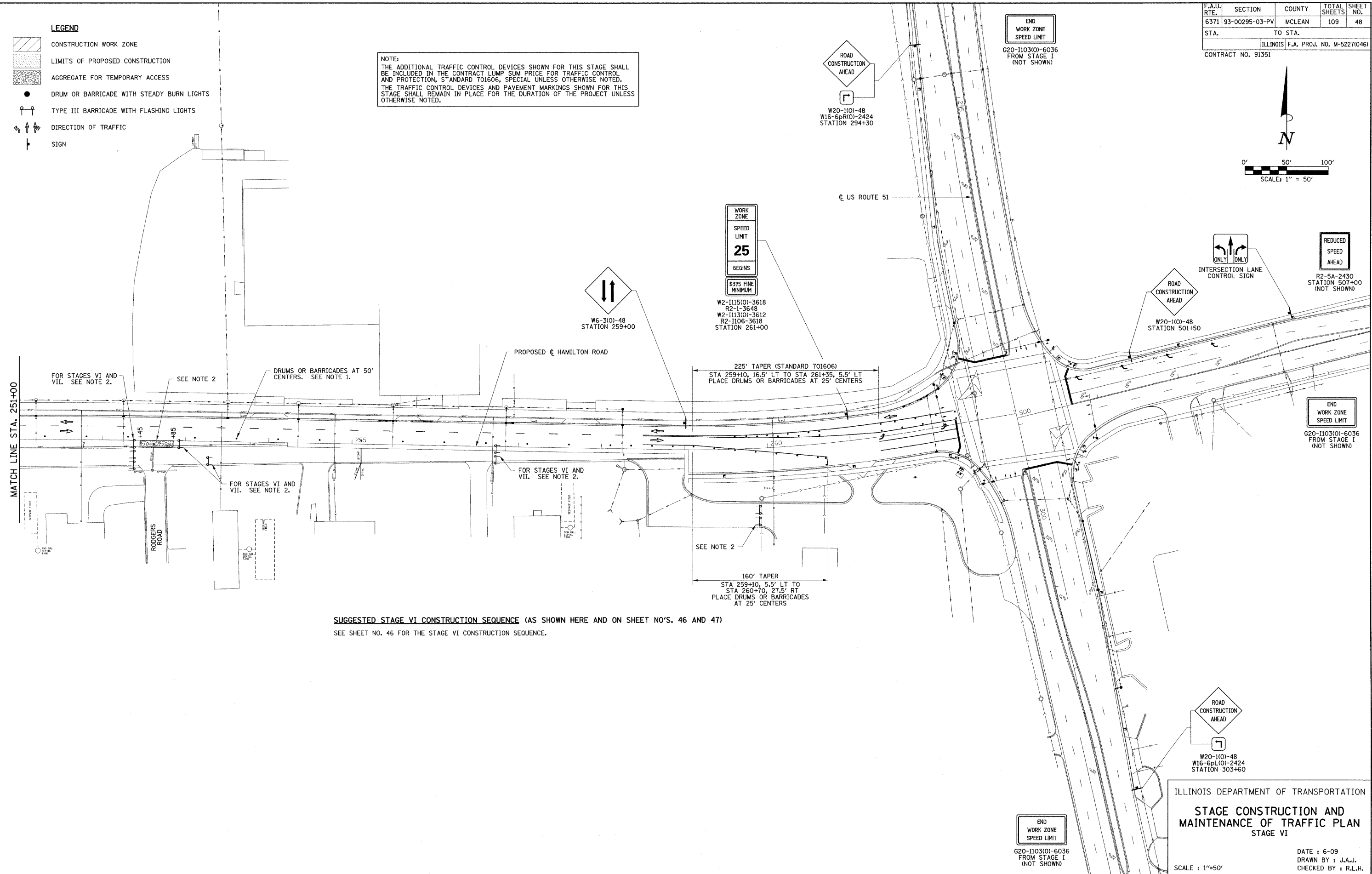

**SUGGESTED STAGE VI CONSTRUCTION SEQUENCE (AS SHOWN HERE AND ON SHEET NO'S. 46 AND 47)**  
 SEE SHEET NO. 46 FOR THE STAGE VI CONSTRUCTION SEQUENCE.

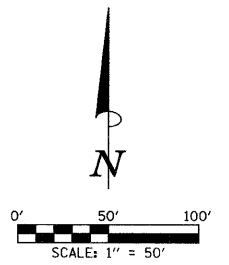

ILLINOIS DEPARTMENT OF TRANSPORTATION  
**STAGE CONSTRUCTION AND MAINTENANCE OF TRAFFIC PLAN**  
 STAGE VI

DATE : 6-09  
 DRAWN BY : J.A.J.  
 CHECKED BY : R.L.H.